

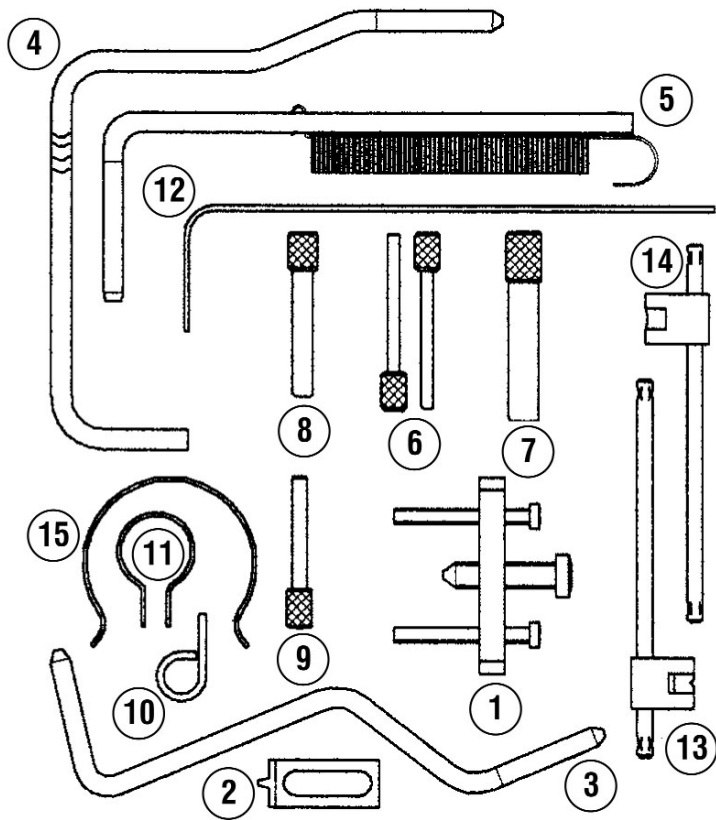

Parts Information:
Diesel Engine Setting/Locking Kit -
Citroen, Peugeot, Fiat 1.4D, 1.6D, 2.0D, 2.2D
HDi/JTD - Belt Drive
Model No: VS4820



Item	Part No.	Description
1	VS1210/01	CRANK PULLEY REMOVER
2	VS1286	FLYWHEEL HOLDING TOOL CITROEN/ PEUGEOT PE
3	VS125/C6	FLYWHEEL LOCKING PIN
4	VS125/C8	FLYWHEEL LOCKING PIN
5	VS1210/P9	FLYWHEEL TDC LOCKING PIN
6	VS4735P15	INJECTION PUMP & CRANKSHAFT LOCKING PIN
7	VS4735P16	FLYWHEEL LOCKING PIN
8	VS4735P17	CAMSHAFT LOCKING PIN

Item	Part No.	Description
9	VS125/P4	CRANK/CAM LOCKING PIN
10	VS125/T5	TENSIONER LOCKING PIN
11	VS4821	CRANK GEAR POSITIONING TOOL
12	VS4820P18	CRANK GEAR POSITIONING TOOL
13	VS1210/02	TENSIONER ADJUSTER
14	VS1210/03	TENSIONER ADJUSTER
15	VS1210/04	TIMING BELT RETAINING CLIP
--	VS4820/84	BLOW MOULD CASE (RED,W/INSERT) (NOT SHOWN)

NOTE: It is our policy to continually improve products and as such we reserve the right to alter data, specifications and component parts without prior notice.

IMPORTANT: No liability is accepted for incorrect use of product.

WARRANTY: Guarantee is 12 months from purchase date, proof of which will be required for any claim.

Sealey Group, Kempson Way, Suffolk Business Park, Bury St Edmunds, Suffolk. IP32 7AR



01284 757500



01284 703534



sales@sealey.co.uk



www.sealey.co.uk