

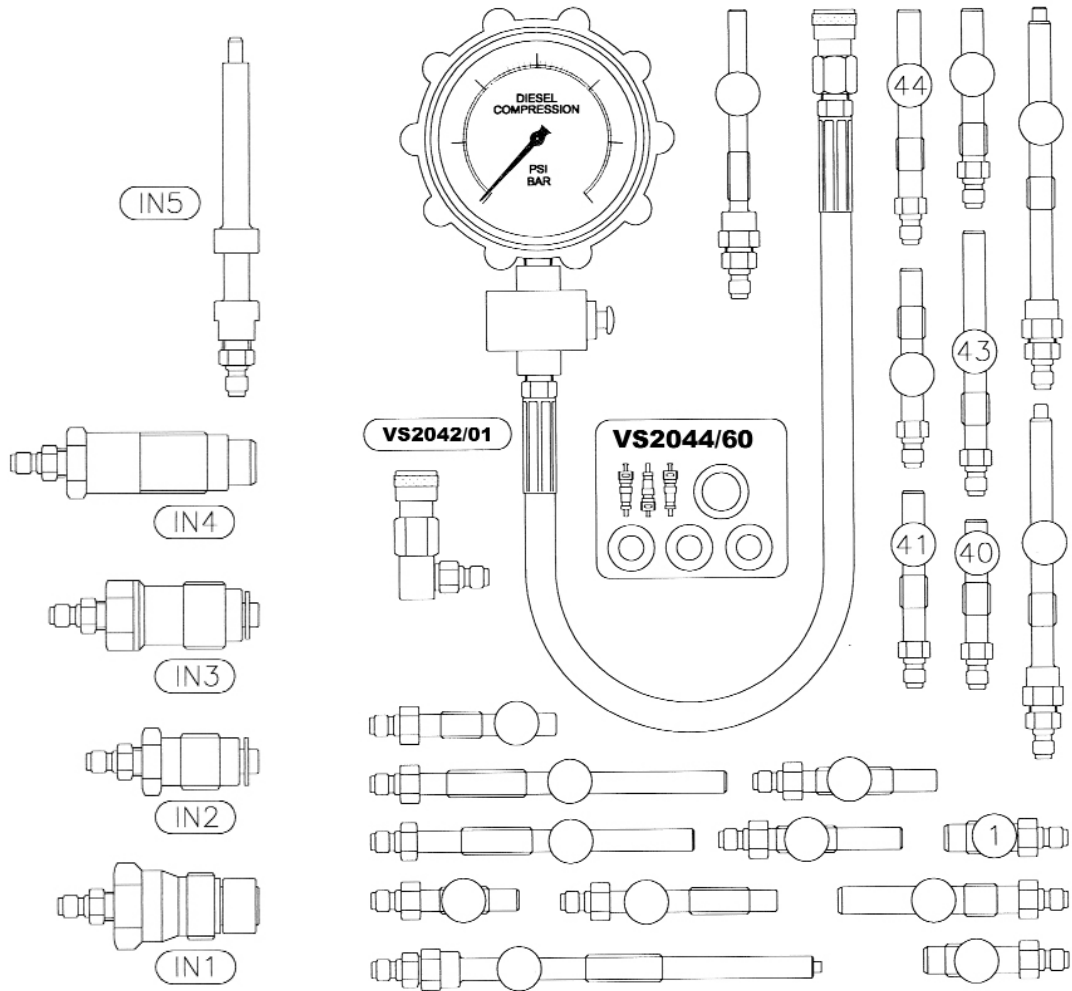

Parts Information:
Diesel Engine Compression Test Kit - Popular
Model No: VS2042



Item	Part No.	Description
--	VS2042.01	Gauge & Hose Ass'y C/W Coupler Elbow 1000psi 70Bar
--	VS2042.02	Case & Insert (NOT SHOWN)
1	VS2043.01	Dummy Glow Plug Adaptor
40	VS2043.40	Dummy Glow Plug Adaptor
41	VS2043.41	Dummy Glow Plug Adaptor
43	VS2043.43	Dummy Glow Plug Adaptor
44	VS2043.44	Dummy Glow Plug Adaptor

Item	Part No.	Description
IN1	VS2044.01	Dummy Injector Adaptor (IN1)
IN2	VS2044.02	Dummy Injector Adaptor (IN2)
IN3	VS2044.03	Dummy Injector Adaptor (IN3)
IN4	VS2044.04	Dummy Injector Adaptor (IN4)
IN5	VS2044.05	Dummy Injector Adaptor (IN5)
--	VS2044.60	Valve & Seal Set
--	VS2042.013	Hose Ass'y 15mm x450mm (NOT SHOWN)

NOTE: It is our policy to continually improve products and as such we reserve the right to alter data, specifications and component parts without prior notice.

IMPORTANT: No liability is accepted for incorrect use of product.

WARRANTY: Guarantee is 12 months from purchase date, proof of which will be required for any claim.

Sealey Group, Kempson Way, Suffolk Business Park, Bury St Edmunds, Suffolk. IP32 7AR



01284 757500



01284 703534



sales@sealey.co.uk



www.sealey.co.uk