

Parts Information: Under Vehicle Engine/Gearbox Support - Fixed Model No: VS0111

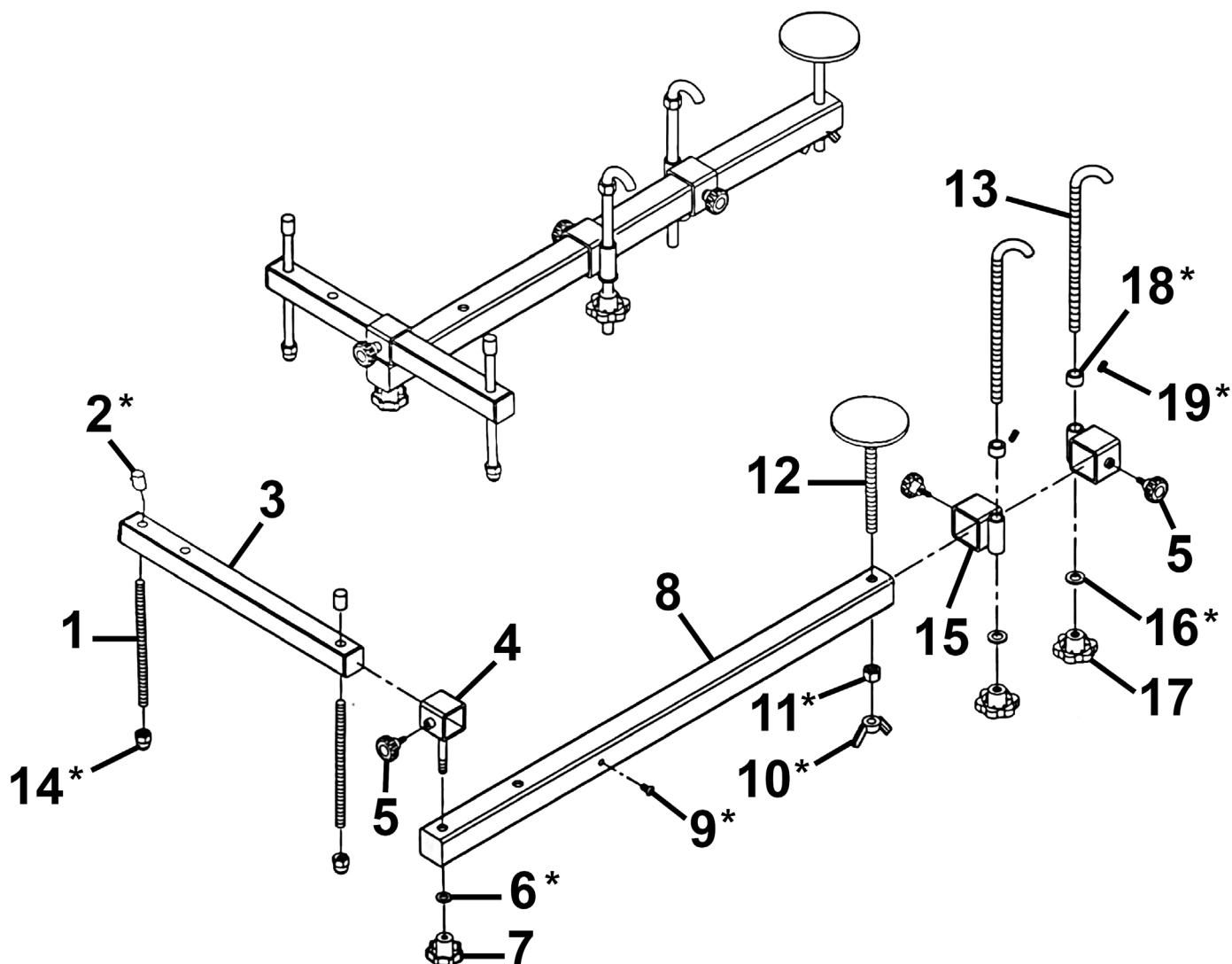

Item	Part No.	Description	Qty
1	VS0111-01	Threaded Rod	2
2	VS0111-02	Cover	2
3	VS0111-03	Short Beam	1
4	VS0111-04	Connection Tube	1
5	VS0110-V2-08	Knob, OD: 57mm, M10x27mm Threaded Male Fitting	3
6	FWM12.S	Flat Washer M12 Zinc	1
7	VS0111-07	Knob, Plastic, M12 Threaded Female Fitting	1
8	VS0111-08	Main Crossbeam (Long)	1
9	VS0111-09	Screw M6	1
10	VS0111-10	Wing Nut M16	1

Item	Part No.	Description	Qty
11	SN16.S	Steel Nut M16 Zinc	1
12	VS0110-V2-12	Support Pad	1
13	VS0110-V2-18	J-Bolt	2
14	SN14.SD	Steel Nut M14 Domed Zinc	2
15	VS0110-V2-15	Set Tube	2
16	FWM16.S	Flat Washer M16 Zinc	2
17	VS0110-V2-13	Knob, Plastic, OD: 78mm, M16 Threaded Female Fitting	2
18	VS0111-18	Collar	2
19	GSM66.S	Grub Screw M6x6 (single)	2
--	VS0111-FK	Fixing Kit (all items marked with '*')	--

NOTE: It is our policy to continually improve products and as such we reserve the right to alter data, specifications and component parts without prior notice. There may be alternative versions of this product, please contact us should you require this information.

IMPORTANT: No liability is accepted for incorrect use of product. Spare parts must be fitted by a competent person

WARRANTY: Guarantee is 12 months from purchase date, proof of which will be required for any claim.