

Item	Part No.	Description
1	120.112048	RESISTOR
2	120.112357	RECTIFIER
3	120.116320	RELAY
4	120.116839	DIODE
5	120.116959	ENCODER
6	120.116962	RESISTANCE
7	120.116966	PWM CONTROLLER
8	120.121547	POTENTIOMETER
9	120.122381	SWITCH, GREEN ROCKER
10	120.132066	MAINS CABLE
11	120.152230	TRANSFORMER
12	120.152247	RESISTANCE
13	120.152269	FAN
14	120.164741	INDUCTANCE FILTER
15	120.169665	POWER TRANSFORMER
16	120.169700	TRANSFORMER
17	120.312434	HANDLE SET
18	120.322950	FRONT PANEL
19	120.322951	BACK PANEL
20	120.712000	DINSE SOCKET SMALL

Item	Part No.	Description
21	120.980345	BOTTOM KIT
22	120.980614	KIT IGBT + DIODE
23	120.981165	COVER KIT
24	120.981104	COMPLETE PCB KIT
25	120.981105	CONTROL PCB KIT
26	120.981112	DISPLAY PCB KIT
27	120.116857	CONDENSER
28	120.169664	INDUCTANCE
29	120.123437	CABLE 16MMQ 3M
--	120.432102	BULL NOSE ADAPTOR (NOT SHOWN)
31	120.712231	WORK CLAMP
32	120.712039	DINSE PLUG SMALL (9mm PIN 10-25mm CABLE)
--	REG/MT	MIG GAS REGULATOR 2 GAUGE INDUSTRIAL (NOT SHOWN)
34	120.722563	TIG TORCH 4mtr 150A
--	REG/MT.V2-G	GAUGE 4500psi, 50mm OD, BTM FITTING (NOT SHOWN)
--	REG/MT.V2-G1	GAUGE 16l/min 50mm OD, BTM FITTING (NOT SHOWN)
--	120.432102	BULL NOSE ADAPTOR (NOT SHOWN)

NOTE: It is our policy to continually improve products and as such we reserve the right to alter data, specifications and component parts without prior notice.

IMPORTANT: No liability is accepted for incorrect use of product.

WARRANTY: Guarantee is 12 months from purchase date, proof of which will be required for any claim.

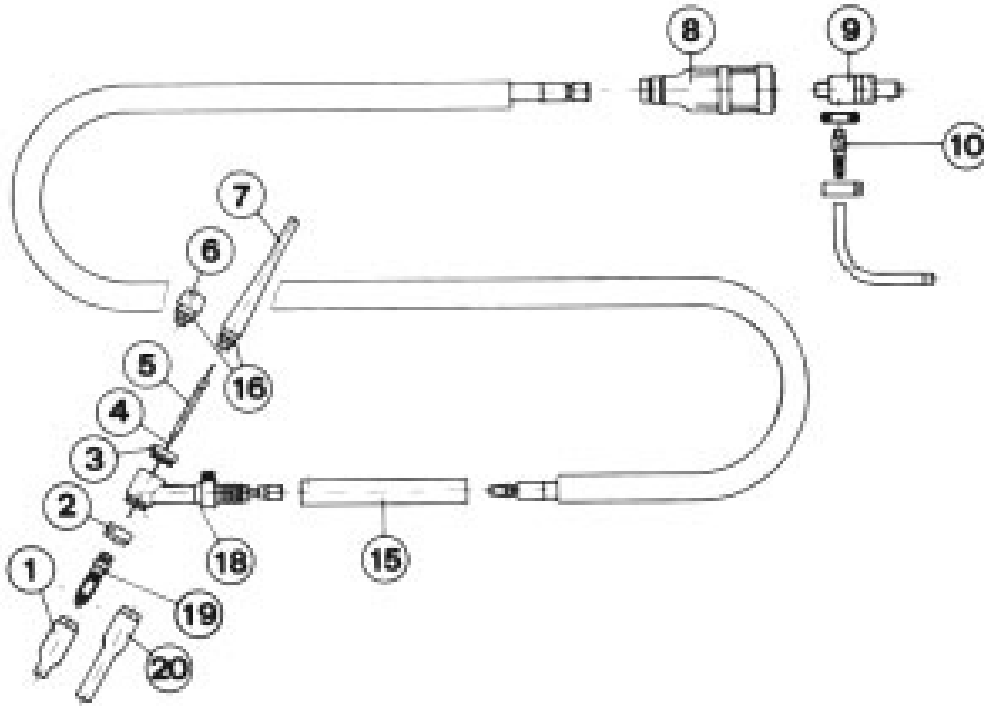

Item	Part No.	Description
1	120.802229	CERAMIC NOZZLE No.4 (KIT OF 10)
1	120.802230	CERAMIC NOZZLE No.5 (KIT OF 10)
1	120.802231	CERAMIC NOZZLE No.6 (KIT OF 10)
2	120.722984	INSULATING
3	120.722985	O-RING
4	120.802220	CERIUM-TUNGSTEN ELECTRODE 1.0mm (PACK of
4	120.802221	ELECTRODE TUNG D.1,2 (KIT OF 10)
4	120.802222	CERIUM-TUNGSTEN ELECTRODE 1.6mm (PACK of
5	120.802223	ELECTRODE HOLDER GUN D.1 (KIT OF 3)
5	120.802224	ELECTRODE HOLDER GUN
5	120.802225	ELECTRODE HOLDER GUN D.1,6 (KIT OF 3)

Item	Part No.	Description
6	120.722982	SHORT CAP
7	120.722981	LONG CAP
8	120.722950	TORCH CONNECTION COVER
9	120.722949	TORCH CONNECTION
10	120.722292	GAS CLUTCH CONNECTOR
15	120.722948	HANDLE
16	120.722983	O-RING
18	120.722947	TORCH PART
19	120.802226	DIFFUSER FOR ELECTRODE D.1 (KIT OF 3)
19	120.802227	DIFFUSER FOR ELECTRODE D.1,2
19	120.802228	DIFFUSER FOR ELECTRODE D.1,6 (KIT OF 3)
20	120.722996	LONG CERAMIC NOZZLE No.4

NOTE: It is our policy to continually improve products and as such we reserve the right to alter data, specifications and component parts without prior notice.

IMPORTANT: No liability is accepted for incorrect use of product.

WARRANTY: Guarantee is 12 months from purchase date, proof of which will be required for any claim.