

Issue Date:- 181203  
Issue No:- 2

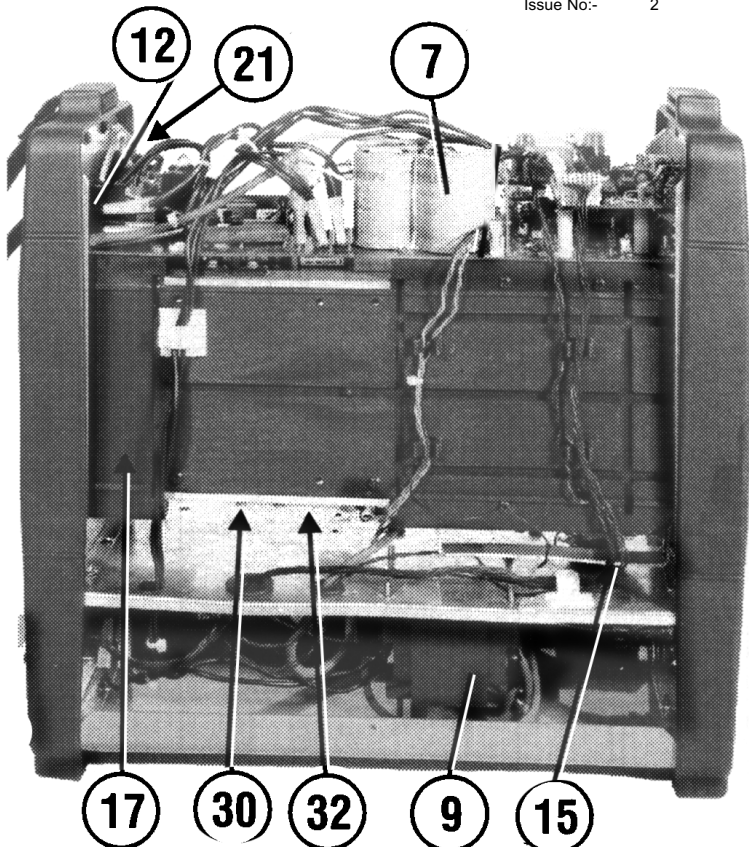

ITEM	PART NO	DESCRIPTION
1	120/112017	POTENTIOMETER
2	120/112076	POTENTIOMETER
3	120/112342	RELAY
4	120/112357	RECTIFIER
5	120/112478	FILTER CARD
6	120/112512	RESISTOR
7	120/112514	CAPACITOR
8	120/990328	KNOB
9	120/114115	H.F. GENERATOR
10	120/122035	ELECTRO - VALVE
11	120/122047	SWITCH, MINI TOGGLE
12	120/122243	SWITCH, MAINS ROCKER
14	120/123503	SOCKET WIRING
15	120/123543	CAPACITOR ASSEMBLY
17	120/152101	FAN
18	120/152231	CURRENT TRANSFORMER
20	120/164781	TRANSFORMER ASSEMBLY
21	120/322112	BUSHING,CABLE
22	120/322065	BUCKLE
23	120/322408	BELT
24	120/322449	FRAME
25	120/644951	BOTTOM (BLACK)
27	120/712035	DINSE SOCKET
28	120/990120	COUPLER, GAS HOSE
29	120/990054	KIT IGBT
30	120/990059	KIT DIODE
32	120/990056	SECONDARY PCB
34	120/990409	KNOB KIT

Parts below are not shown.

090123	ELECTRODE TUNGSTEN 1.6 GREEN
090133	ELECTRODE TUNGS/THOR 1.6 RED
090134	ELECTRODE TUNGS/THOR 2.4 RED
090163	ELECTRODE TUNGS/ZIRC 1.6 WHITE
090164	ELECTRODE TUNGS/ZIRC 2.4 WHITE
090193	ELECTRODE TUNGS/CER 1.6 GREY
090194	ELECTRODE TUNGS/CER 2.4 GREY

<b>INV/TIG/2</b>	<b>TIG WELDING ACCESSORY KIT</b> ( consists of parts below )
REG/MT	REGULATOR C02&ARGON 2 GAUGE
120/712031	EARTH CLAMP
LS/16	LEAD (SINGLE) 16MM 3M c/w EYES
120/712039	DINSE PLUG
168/70020145	TIG TORCH DWT-17 4M COMPLETE

<b>INV/16</b>	<b>ARC WELDING ACCESSORY KIT</b>
---------------	----------------------------------



01284 757500



01284 703534

**E-mail:** sales@sealey.co.uk

Issue Date:- 021001  
 Version Nbr:- 1  
 Date Modified:- N/A

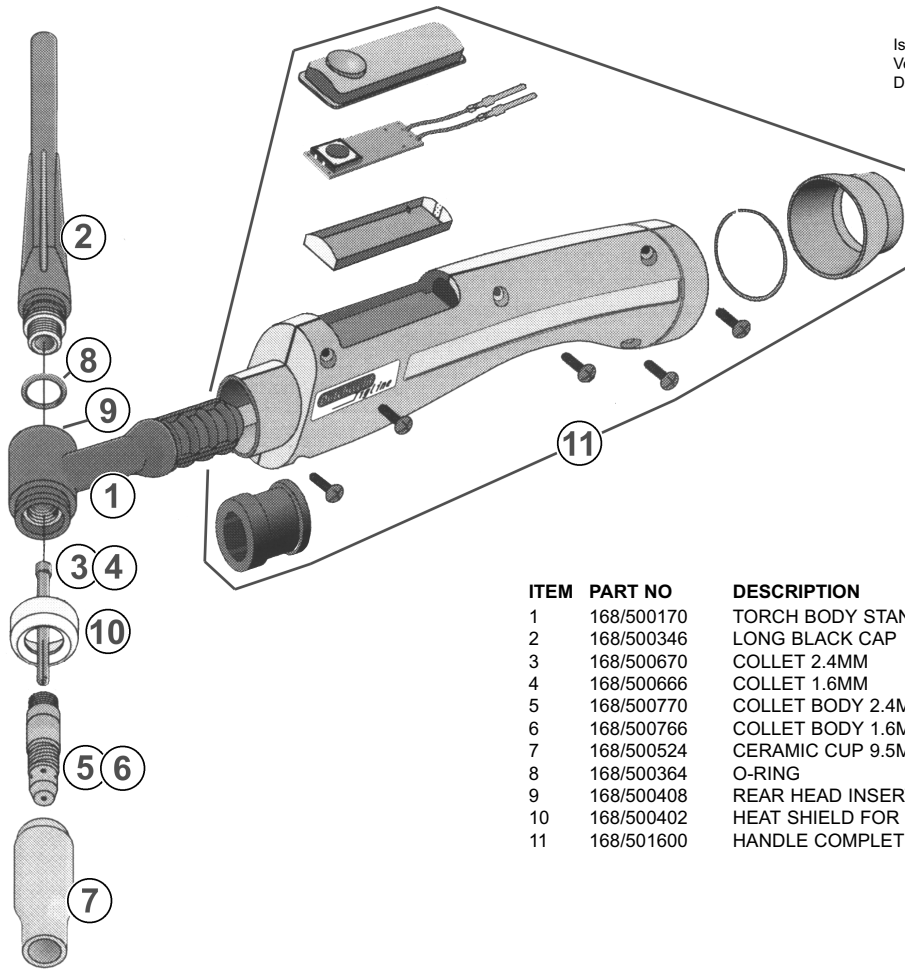

ITEM	PART NO	DESCRIPTION
1	168/500170	TORCH BODY STANDARD
2	168/500346	LONG BLACK CAP
3	168/500670	COLLET 2.4MM
4	168/500666	COLLET 1.6MM
5	168/500770	COLLET BODY 2.4MM
6	168/500766	COLLET BODY 1.6MM
7	168/500524	CERAMIC CUP 9.5MM (10N48)
8	168/500364	O-RING
9	168/500408	REAR HEAD INSERT
10	168/500402	HEAT SHIELD FOR COLLET BODY
11	168/501600	HANDLE COMPLETE SB

