

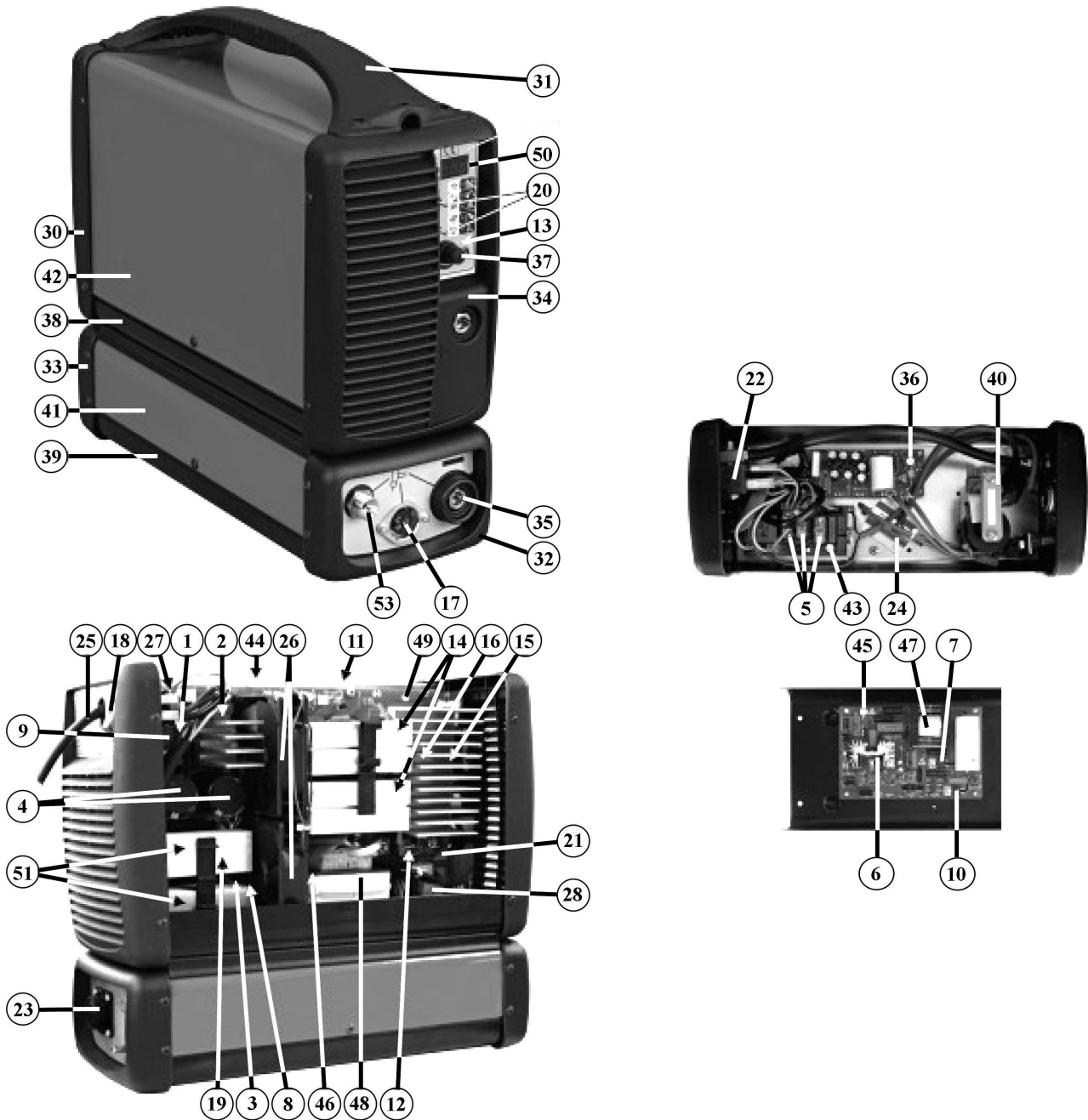

Parts Information:
TIG/MMA HF AC/DC Inverter Welder
160Amp 230V
Model No: TIG161HFACDC



NOTE: It is our policy to continually improve products and as such we reserve the right to alter data, specifications and component parts without prior notice.

IMPORTANT: No liability is accepted for incorrect use of product.

WARRANTY: Guarantee is 12 months from purchase date, proof of which will be required for any claim.

Sealey Group, Kempson Way, Suffolk Business Park, Bury St Edmunds, Suffolk. IP32 7AR



01284 757500



01284 703534



sales@sealey.co.uk



www.sealey.co.uk



Parts Information:
TIG/MMA HF AC/DC Inverter Welder
160Amp 230V
Model No: TIG161HFACDC

Item	Part No.	Description
1	120.112048	RESISTOR
2	120.112357	RECTIFIER
3	120.112633	RECTIFIER
4	120.113122	CAPACITOR 400v 680uf 50x35
5	120.113493	RELAY
6	120.113603	IGBT KIT
7	120.116146	DIODE
9	120.116320	RELAY
10	120.116442	DIODE
14	120.116643	DIODE
15	120.116644	IGBT
16	120.116733	VOLTAGE CONDENSOR
17	120.120514	SOCKET CABLE
18	120.122381	SWITCH, GREEN ROCKER
21	120.121300	THERMOSTAT
22	120.122035	ELECTRO-VALVE 230V
23	120.124105	CONTROL CABLE/C.A.D
24	120.124106	RESISTANCE CABLE
25	120.132363	MAINS CABLE
26	120.152019	FAN
27	120.164741	INDUCTANCE FILTER
28	120.169506	INDUCTANCE
30	120.322694	BACK PANEL
31	120.322695	HANDLE
32	120.322731	HF BASE FRONT PANEL
33	120.322732	HF BASE BACK PANEL
34	120.322826	FRONT PANEL
35	120.712000	DINSE SOCKET SMALL
36	120.980021	HF BOARD KIT
37	120.980520	ENCODER KNOB KIT
38	120.980584	BOTTOM KIT
39	120.980585	BOTTOM KIT

Item	Part No.	Description
40	120.980586	HF TRANSFORMER KIT
41	120.980587	COVER KIT
42	120.981163	COVER KIT
43	120.980606	PT/EV/HF CARD KIT
44	120.980607	CONTROL BOARD KIT
45	120.980608	VOLTAGE STABILIZING BOARD KIT
47	120.169595	TRANSFORMER
48	120.980611	POWER TRANSFORMER KIT
49	120.980612	POWER BOARD KIT
50	120.980613	FRONT PANEL + MODULE SET
51	120.980614	KIT IGBT + DIODE
53	120.990120	COUPLER, GAS HOSE
--	120.123443	CABLE 16MMQ 3M (NOT SHOWN)
--	120.432036	ARGON GAS BOTTLE IT ADAPTOR (NOT SHOWN)
--	120.712039	DINSE PLUG SMALL (9mm PIN 10-25mm CABLE) (NOT SHOWN)
--	120.712231	WORK CLAMP (NOT SHOWN)
--	REG/MT	MIG GAS REGULATOR 2 GAUGE INDUSTRIAL (NOT SHOWN)
--	120.742423	TIG TORCH DWT-17 4m COMPLETE (NOT SHOWN)
--	INV/TIG/7	TIG WELDER POWER CONTROL for TIG161HFACD (NOT SHOWN)
--	INV/TIG/5	TIG WELDER FOOT PEDAL POWER CONTROL (NOT SHOWN)
--	120.432102	BULL NOSE ADAPTOR (NOT SHOWN)
--	120.722352	GAUGE (NOT SHOWN)
--	120.722353	GAUGE (NOT SHOWN)
--	REG/MTV2-G	GAUGE 4500psi, 50mm OD, BTM FITTING (NOT SHOWN)
--	REG/MTV2-G1	GAUGE 16l/min 50mm OD, BTM FITTING (NOT SHOWN)
--	120.432102	BULL NOSE ADAPTOR (NOT SHOWN)

NOTE: It is our policy to continually improve products and as such we reserve the right to alter data, specifications and component parts without prior notice.

IMPORTANT: No liability is accepted for incorrect use of product.

WARRANTY: Guarantee is 12 months from purchase date, proof of which will be required for any claim.

Sealey Group, Kempson Way, Suffolk Business Park, Bury St Edmunds, Suffolk. IP32 7AR



01284 757500



01284 703534



sales@sealey.co.uk



www.sealey.co.uk



Parts Information:
TIG/MMA HF AC/DC Inverter Welder
160Amp 230V
Model No: TIG161HFACDC

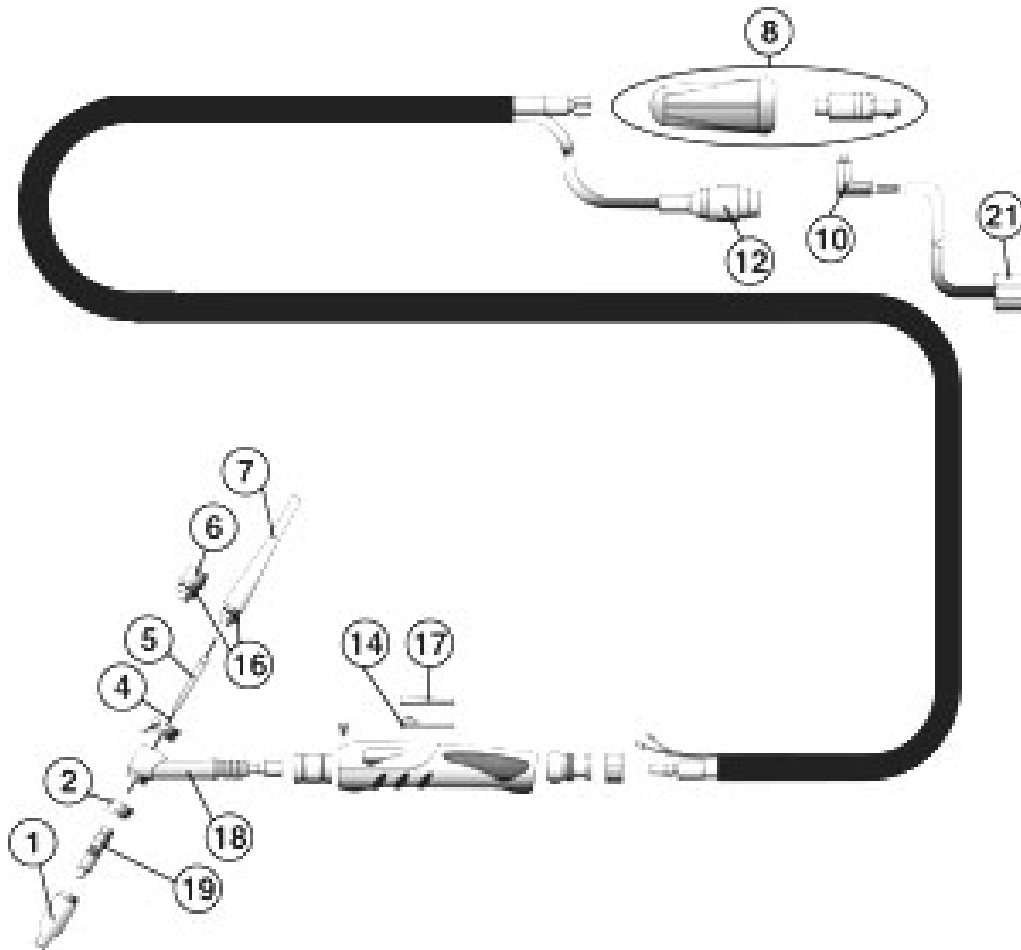

Item	Part No.	Description
1	120.802245	CERAMIC NOZZLES NO 6 (PACK of 10)
1	120.802244	CERAMIC NOZZLES NO 4 (PACK of 10)
1	120.802246	CERAMIC NOZZLES NO 7 (PACK of 10)
2	120.722248	INSULATOR
4	120.802232	CERIUM-TUNGSTEN ELECTRODE 2.4mm (PACK OF
4	120.802220	CERIUM-TUNGSTEN ELECTRODE 1.0mm (PACK of
4	120.802222	CERIUM-TUNGSTEN ELECTRODE 1.6mm (PACK of
5	120.802241	ELECTRODE HOLDER CLAMP 2.4mm (PACK of 2)
5	120.802239	ELECTRODE HOLDER CLAMP 1.0mm (PACK of 3)
5	120.802240	ELECTRODE HOLDER CLAMP 1.6mm (PACK of 3)

Item	Part No.	Description
6	120.722192	SHORT CAP
7	120.722193	LONG CAP
8	120.712046	DINSE CONNECTION 25MMQ
10	120.722292	GAS CLUTCH CONNECTOR
12	120.722999	PLUG
14	120.452089	PUSHBUTTON CONTACT
16	120.722061	O-RING
17	120.742042	PUSHBUTTON
18	120.722204	TORCH BODY
19	120.802250	ELECTRODE DIFFUSER 1.6m (PACK of 3)
19	120.802249	ELECTRODE DIFFUSER 1.0m (PACK of 3)
19	120.802251	ELECTRODE DIFFUSER 2.4mm (PACK of 3)
--	120.722194	LONG CERAMIC NOZZLE NR.6 (NOT SHOWN)
21	120.990263	3/8" CONNECTION KIT TIG TORCH

NOTE: It is our policy to continually improve products and as such we reserve the right to alter data, specifications and component parts without prior notice.

IMPORTANT: No liability is accepted for incorrect use of product.

WARRANTY: Guarantee is 12 months from purchase date, proof of which will be required for any claim.

Sealey Group, Kempson Way, Suffolk Business Park, Bury St Edmunds, Suffolk. IP32 7AR



01284 757500



01284 703534



sales@sealey.co.uk



www.sealey.co.uk