

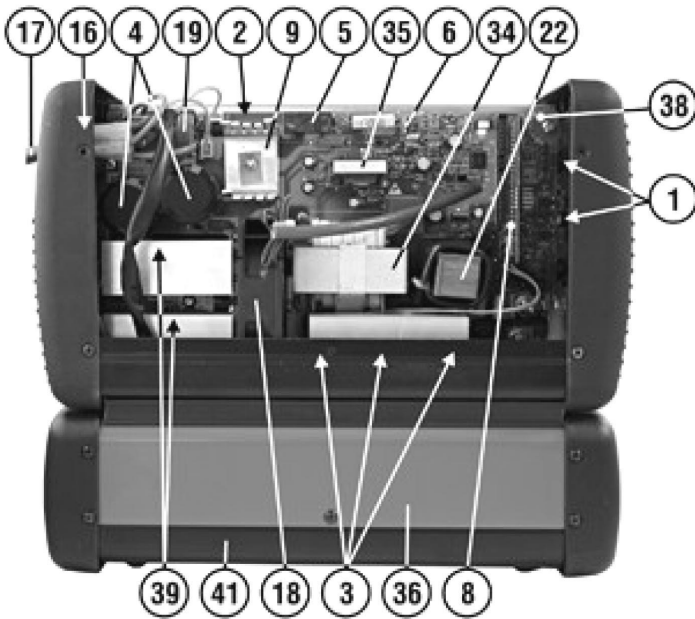

Parts Information:
**TIG/MMA HF Inverter Welder 160Amp
230V
Model No: TIG160HF**

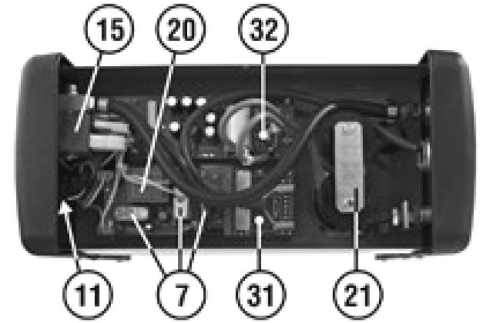
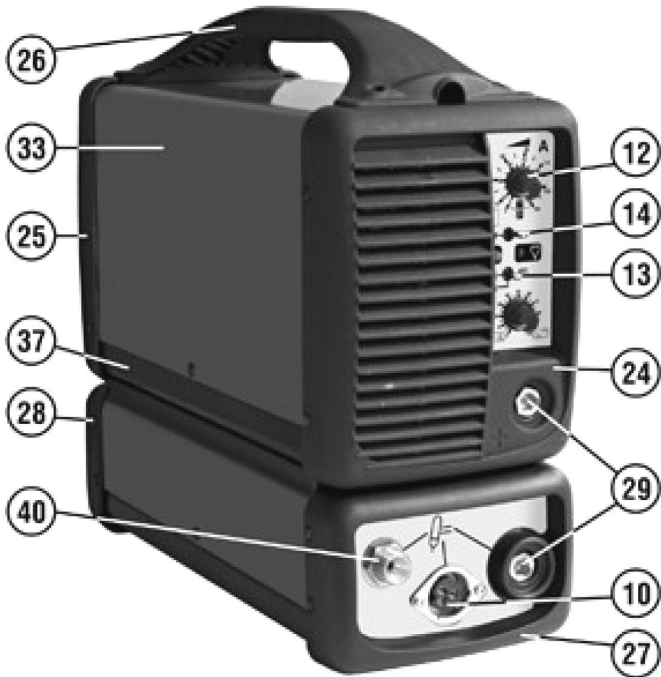

NOTE: It is our policy to continually improve products and as such we reserve the right to alter data, specifications and component parts without prior notice.

IMPORTANT: No liability is accepted for incorrect use of product.

WARRANTY: Guarantee is 12 months from purchase date, proof of which will be required for any claim.

Sealey Group, Kempson Way, Suffolk Business Park, Bury St Edmunds, Suffolk. IP32 7AR



01284 757500



01284 703534



sales@sealey.co.uk



www.sealey.co.uk



Parts Information:
**TIG/MMA HF Inverter Welder 160Amp
230V
Model No: TIG160HF**

Item	Part No.	Description
1	120/112017	POTENTIOMETER
2	120/112048	RESISTOR
3	120.112948	DIODE
4	120.113122	CAPACITOR 400v 680uf 50x35
5	120.113233	RELAY
6	120/113487	PWM CONTROLLER
7	120/113493	RELAY
8	120.98025	CONTROL BOARD KIT
9	120.116346	RECTIFIER
10	120.120514	SOCKET CABLE
11	120.120513	CONTROL CABLE
12	120.121064	KNOB FOR POTENTIOMETER
13	120.121192	SWITCH
14	120.121192	SWITCH
15	120/122035	ELECTRO-VALVE 230V
16	120/122381	SWITCH, GREEN ROCKER
17	120.132066	MAINS CABLE
18	120/152006	FAN
19	120/164741	INDUCTANCE FILTER
20	120/164932	AUXILIARY TRANSFORMER
21	120.980586	HF TRANSFORMER KIT
22	120.169506	INDUCTANCE
24	120.322688	FRONT PANEL

Item	Part No.	Description
25	120.32269	BACK PANEL
26	120.322691	HANDLE (SO)
27	120.322731	HF BASE FRONT PANEL
28	120.322732	HF BASE BACK PANEL
29	120/712000	DINSE SOCKET SMALL
31	120.98002	TORCH PUSHBUTTON CARD KIT
32	120.980021	HF BOARD KIT
33	120.981164	COVER KIT
34	120.980244	POWER TRANSFORMER KIT
35	120.980245	TRANSFORMER KIT
36	120.980246	HF BASE COVER KIT
37	120.980247	BOTTOM KIT
38	120.980248	COMPLETE CONTROL PCB KIT
39	120.980249	KIT IGBT + DIODE
40	120/990120	COUPLER, GAS HOSE
41	120.990917	BOTTOM KIT
42	120.742423	TIG TORCH DWT-17 4m COMPLETE
43	120/712039	DINSE PLUG SMALL (9mm PIN 10-25mm CABLE)
44	120.123437	CABLE 16MMQ 3M
45	120/712231	WORK CLAMP
--	REG/MT	MIG GAS REGULATOR 2 GAUGE INDUSTRIAL (NOT SHOWN)
--	120/432102	BULL NOSE ADAPTOR (NOT SHOWN)

NOTE: It is our policy to continually improve products and as such we reserve the right to alter data, specifications and component parts without prior notice.

IMPORTANT: No liability is accepted for incorrect use of product.

WARRANTY: Guarantee is 12 months from purchase date, proof of which will be required for any claim.

Sealey Group, Kempson Way, Suffolk Business Park, Bury St Edmunds, Suffolk. IP32 7AR



01284 757500



01284 703534



sales@sealey.co.uk



www.sealey.co.uk



Parts Information:
**TIG/MMA HF Inverter Welder 160Amp
 230V
 Model No: TIG160HF**

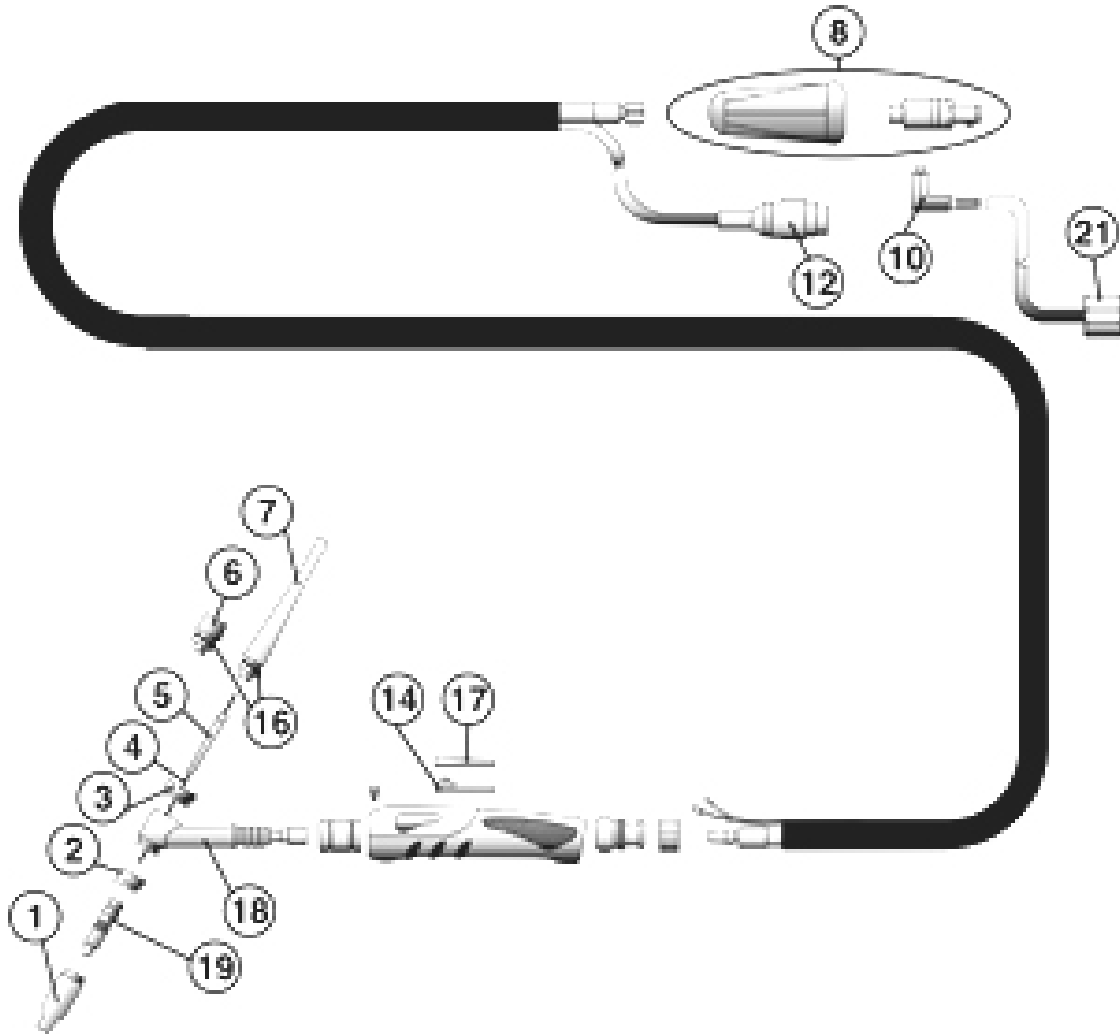

Item	Part No.	Description
1	120.802245	CERAMIC NOZZLES NO 6 (PACK of 10)
--	120.802244	CERAMIC NOZZLES NO 4 (PACK of 10) (NOT SHOWN)
--	120.802246	CERAMIC NOZZLES NO 7 (PACK of 10) (NOT SHOWN)
2	120.722248	INSULATOR
--	120.802232	CERIUM-TUNGSTEN ELECTRODE 2.4mm (NOT SHOWN)
4	120.80222	CERIUM-TUNGSTEN ELECTRODE 1.0mm
--	120.802222	CERIUM-TUNGSTEN ELECTRODE 1.6mm (NOT SHOWN)
--	120.802241	ELECTRODE HOLDER CLAMP 2.4mm (PACK of 2) (NOT SHOWN)
5	120.802239	ELECTRODE HOLDER CLAMP 1.0mm (PACK of 3)
--	120.80224	ELECTRODE HOLDER CLAMP 1.6mm (PACK of 3) (NOT SHOWN)

Item	Part No.	Description
6	120.722192	SHORT CAP
7	120.722193	LONG CAP
8	120.712046	DINSE CONNECTION 25MMQ
10	120.722292	GAS CLUTCH CONNECTOR(SO)
12	120.722999	PLUG (SO)
14	120.452089	PUSHBUTTON CONTACT
16	120.722061	O-RING(SO)
17	120.742042	PUSHBUTTON
18	120.722204	TORCH BODY
--	120.80225	ELECTRODE DIFFUSER 1.6m (PACK of 3) (NOT SHOWN)
19	120.802249	ELECTRODE DIFFUSER 1.0m (PACK of 3)
--	120.802251	ELECTRODE DIFFUSER 2.4mm (PACK of 3) (NOT SHOWN)
--	120.722194	LONG CERAMIC NOZZLE NR.6 (NOT SHOWN)
21	120.990263	3/8" CONNECTION KIT TIG TORCH

NOTE: It is our policy to continually improve products and as such we reserve the right to alter data, specifications and component parts without prior notice.

IMPORTANT: No liability is accepted for incorrect use of product.

WARRANTY: Guarantee is 12 months from purchase date, proof of which will be required for any claim.

Sealey Group, Kempson Way, Suffolk Business Park, Bury St Edmunds, Suffolk. IP32 7AR



01284 757500



01284 703534



sales@sealey.co.uk



www.sealey.co.uk