

| Item | Part No. | Description |
|------|------------|----------------------------|
| 1 | 120.112048 | RESISTOR |
| 2 | 120.113122 | CAPACITOR 400v 680uf 50x35 |
| 3 | 120.113493 | RELAY |
| 4 | 120.116346 | RECTIFIER |
| 5 | 120.116839 | DIODE |
| 6 | 120.116959 | ENCODER |
| 7 | 120.116962 | RESISTANCE |
| 8 | 120.116966 | PWM CONTROLLER |
| 9 | 120.980520 | ENCODER KNOB KIT |
| 10 | 120.122381 | SWITCH, GREEN ROCKER |
| 11 | 120.132066 | MAINS CABLE |
| 12 | 120.152006 | FAN |
| 13 | 120.152230 | TRANSFORMER |
| 14 | 120.152247 | RESISTANCE |
| 15 | 120.164741 | INDUCTANCE FILTER |
| 16 | 120.169700 | TRANSFORMER |
| 17 | 120.169711 | POWER TRANSFORMER |
| 18 | 120.322893 | FRONT PANEL |
| 19 | 120.322894 | BACK PANEL |

| Item | Part No. | Description |
|------|-------------|--|
| 20 | 120.322895 | HANDLE |
| 21 | 120.712000 | DINSE SOCKET SMALL |
| 22 | 120.980786 | BOTTOM KIT |
| 23 | 120.980788 | IGBT + DIODE KIT |
| 24 | 120.981106 | COMPLETE PCB KIT |
| 25 | 120.981107 | CONTROL PCB KIT |
| 26 | 120.981166 | COVER KIT |
| 27 | 120.981113 | PCB KIT (KEYPAD) |
| -- | 120.432102 | BULL NOSE ADAPTOR (NOT SHOWN) |
| 29 | 120.712231 | WORK CLAMP |
| -- | REG/MT | MIG GAS REGULATOR 2 GAUGE INDUSTRIAL (NOT SHOWN) |
| 31 | 120.742565 | TIG TORCH 4M |
| 32 | 120.123430 | CABLE 10MMQ 3M |
| -- | REG/MTV2-G | GAUGE 4500psi, 50mm OD, BTM FITTING (NOT SHOWN) |
| -- | REG/MTV2-G1 | GAUGE 16l/min 50mm OD, BTM FITTING (NOT SHOWN) |
| -- | 120.432102 | BULL NOSE ADAPTOR (NOT SHOWN) |

NOTE: It is our policy to continually improve products and as such we reserve the right to alter data, specifications and component parts without prior notice.

IMPORTANT: No liability is accepted for incorrect use of product.

WARRANTY: Guarantee is 12 months from purchase date, proof of which will be required for any claim.

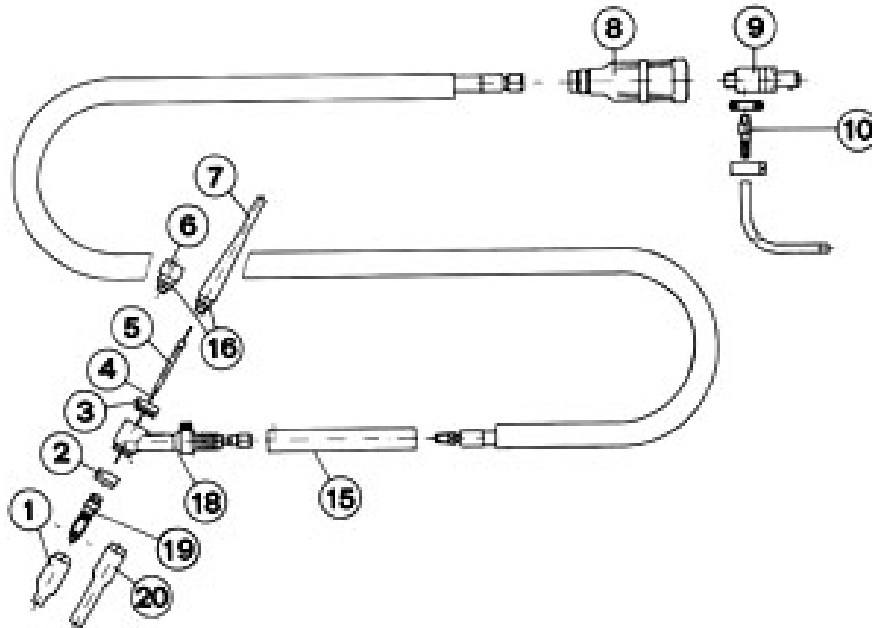

| Item | Part No. | Description |
|------|------------|---|
| 1 | 120.802229 | CERAMIC NOZZLE No.4 (KIT OF 10) |
| 1 | 120.802230 | CERAMIC NOZZLE No.5 (KIT OF 10) |
| 1 | 120.802231 | CERAMIC NOZZLE No.6 (KIT OF 10) |
| 2 | 120.722984 | INSULATING |
| 3 | 120.722985 | O-RING |
| 4 | 120.802220 | CERIUM-TUNGSTEN ELECTRODE 1.0mm (PACK of |
| 4 | 120.802221 | ELECTRODE TUNG D,1,2 (KIT OF 10) |
| 4 | 120.802222 | CERIUM-TUNGSTEN ELECTRODE 1.6mm (PACK of |
| 5 | 120.802223 | ELECTRODE HOLDER GUN D,1 (KIT OF 3) |
| 5 | 120.802224 | ELECTRODE HOLDER GUN |
| 5 | 120.802225 | ELECTRODE HOLDER GUN D,1,6 (KIT OF 3) |

| Item | Part No. | Description |
|------|------------|---|
| 6 | 120.722982 | SHORT CAP |
| 7 | 120.722981 | LONG CAP |
| 8 | 120.722950 | TORCH CONNECTION COVER |
| 9 | 120.722949 | TORCH CONNECTION |
| 10 | 120.722292 | GAS CLUTCH CONNECTOR |
| 15 | 120.722948 | HANDLE |
| 16 | 120.722983 | O-RING |
| 18 | 120.722947 | TORCH PART |
| 19 | 120.802226 | DIFFUSER FOR ELECTRODE D,1 (KIT OF 3) |
| 19 | 120.802227 | DIFFUSER FOR ELECTRODE D,1,2 |
| 19 | 120.802228 | DIFFUSER FOR ELECTRODE D,1,6 (KIT OF 3) |
| 20 | 120.722996 | LONG CERAMIC NOZZLE No.4 |

NOTE: It is our policy to continually improve products and as such we reserve the right to alter data, specifications and component parts without prior notice.

IMPORTANT: No liability is accepted for incorrect use of product.

WARRANTY: Guarantee is 12 months from purchase date, proof of which will be required for any claim.