

SM300/B120* BLADE 300 X 2.5 X 32mm 120T 8mm Tooth Pitch	SM300/B160* BLADE 300 X 2.5 X 32mm 160T 6mm Tooth Pitch
SM300/B180* BLADE 300 X 2.5 X 32mm 180T 5mm Tooth Pitch	SM300/B220* BLADE 300 X 2.5 X 32mm 220T 4mm Tooth Pitch

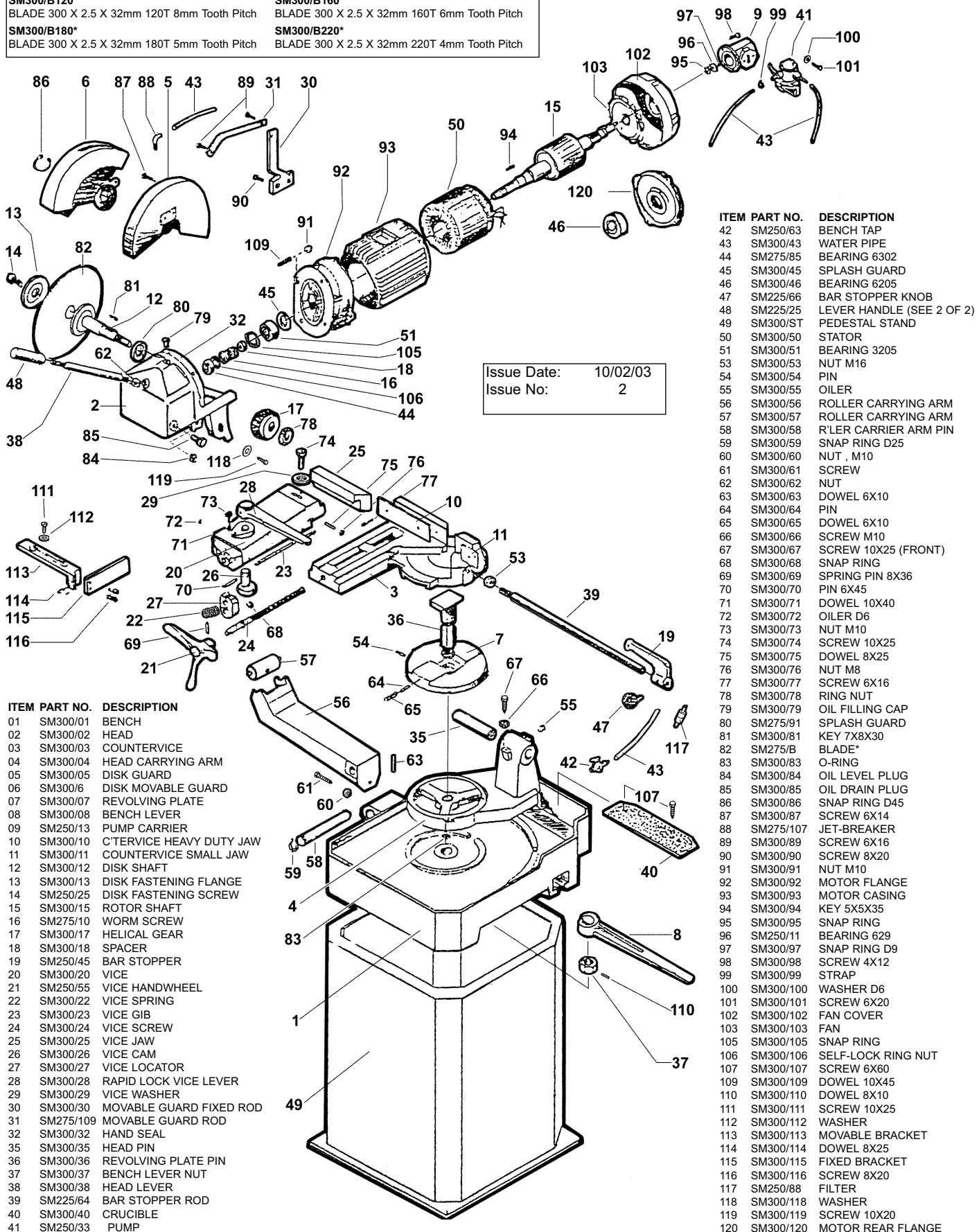

ITEM	PART NO.	DESCRIPTION
42	SM250/63	BENCH TAP
43	SM300/43	WATER PIPE
44	SM275/85	BEARING 6302
45	SM300/45	SPLASH GUARD
46	SM300/46	BEARING 6205
47	SM225/66	BAR STOPPER KNOB
48	SM225/25	LEVER HANDLE (SEE 2 OF 2)
49	SM300/ST	PEDESTAL STAND
50	SM300/50	STATOR
51	SM300/51	BEARING 3205
53	SM300/53	NUT M16
54	SM300/54	PIN
55	SM300/55	OILER
56	SM300/56	ROLLER CARRYING ARM
57	SM300/57	ROLLER CARRYING ARM
58	SM300/58	R'LER CARRIER ARM PIN
59	SM300/59	SNAP RING D25
60	SM300/60	NUT , M10
61	SM300/61	SCREW
62	SM300/62	NUT
63	SM300/63	DOWEL 6X10
64	SM300/64	PIN
65	SM300/65	DOWEL 6X10
66	SM300/66	SCREW M10
67	SM300/67	SCREW 10X25 (FRONT)
68	SM300/68	SNAP RING
69	SM300/69	SPRING PIN 8X36
70	SM300/70	PIN 6X45
71	SM300/71	DOWEL 10X40
72	SM300/72	OILER D6
73	SM300/73	NUT M10
74	SM300/74	SCREW 10X25
75	SM300/75	DOWEL 8X25
76	SM300/76	NUT M8
77	SM300/77	SCREW 6X16
78	SM300/78	RING NUT
79	SM300/79	OIL FILLING CAP
80	SM275/91	SPLASH GUARD
81	SM300/81	KEY 7X8X30
82	SM275/B	BLADE*
83	SM300/83	O-RING
84	SM300/84	OIL LEVEL PLUG
85	SM300/85	OIL DRAIN PLUG
86	SM300/86	SNAP RING D45
87	SM300/87	SCREW 6X14
88	SM275/107	JET-BREAKER
89	SM300/89	SCREW 6X16
90	SM300/90	SCREW 8X20
91	SM300/91	NUT M10
92	SM300/92	MOTOR FLANGE
93	SM300/93	MOTOR CASING
94	SM300/94	KEY 5X5X35
95	SM300/95	SNAP RING
96	SM250/11	BEARING 629
97	SM300/97	SNAP RING D9
98	SM300/98	SCREW 4X12
99	SM300/99	STRAP
100	SM300/100	WASHER D6
101	SM300/101	SCREW 6X20
102	SM300/102	FAN COVER
103	SM300/103	FAN
105	SM300/105	SNAP RING
106	SM300/106	SELF-LOCK RING NUT
107	SM300/107	SCREW 6X60
109	SM300/109	DOWEL 10X45
110	SM300/110	DOWEL 8X10
111	SM300/111	SCREW 10X25
112	SM300/112	WASHER
113	SM300/113	MOVABLE BRACKET
114	SM300/114	DOWEL 8X25
115	SM300/115	FIXED BRACKET
116	SM300/116	SCREW 8X20
117	SM250/88	FILTER
118	SM300/118	WASHER
119	SM300/119	SCREW 10X20
120	SM300/120	MOTOR REAR FLANGE

ITEM	PART NO.	DESCRIPTION
01	SM300/01	BENCH
02	SM300/02	HEAD
03	SM300/03	COUNTERVICE
04	SM300/04	HEAD CARRYING ARM
05	SM300/05	DISK GUARD
06	SM300/06	DISK MOVABLE GUARD
07	SM300/07	REVOLVING PLATE
08	SM300/08	BENCH LEVER
09	SM250/13	PUMP CARRIER
10	SM300/10	C'TERVICE HEAVY DUTY JAW
11	SM300/11	COUNTERVICE SMALL JAW
12	SM300/12	DISK SHAFT
13	SM300/13	DISK FASTENING FLANGE
14	SM250/25	DISK FASTENING SCREW
15	SM300/15	ROTOR SHAFT
16	SM275/10	WORM SCREW
17	SM300/17	HELICAL GEAR
18	SM300/18	SPACER
19	SM250/45	BAR STOPPER
20	SM300/20	VICE
21	SM250/55	VICE HANDWHEEL
22	SM300/22	VICE SPRING
23	SM300/23	VICE GIB
24	SM300/24	VICE SCREW
25	SM300/25	VICE JAW
26	SM300/26	VICE CAM
27	SM300/27	VICE LOCATOR
28	SM300/28	RAPID LOCK VICE LEVER
29	SM300/29	VICE WASHER
30	SM300/30	MOVABLE GUARD FIXED ROD
31	SM275/109	MOVABLE GUARD ROD
32	SM300/32	HAND SEAL
35	SM300/35	HEAD PIN
36	SM300/36	REVOLVING PLATE PIN
37	SM300/37	BENCH LEVER NUT
38	SM300/38	HEAD LEVER
39	SM225/64	BAR STOPPER ROD
40	SM300/40	CRUCIBLE
41	SM250/33	PUMP

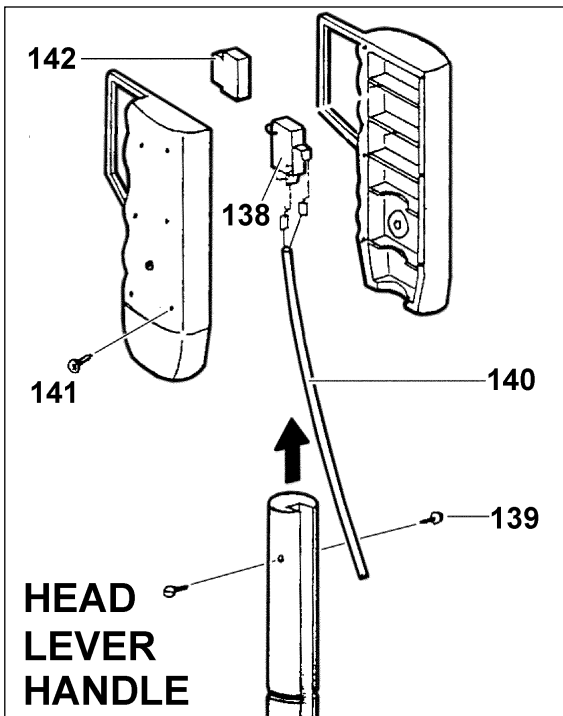
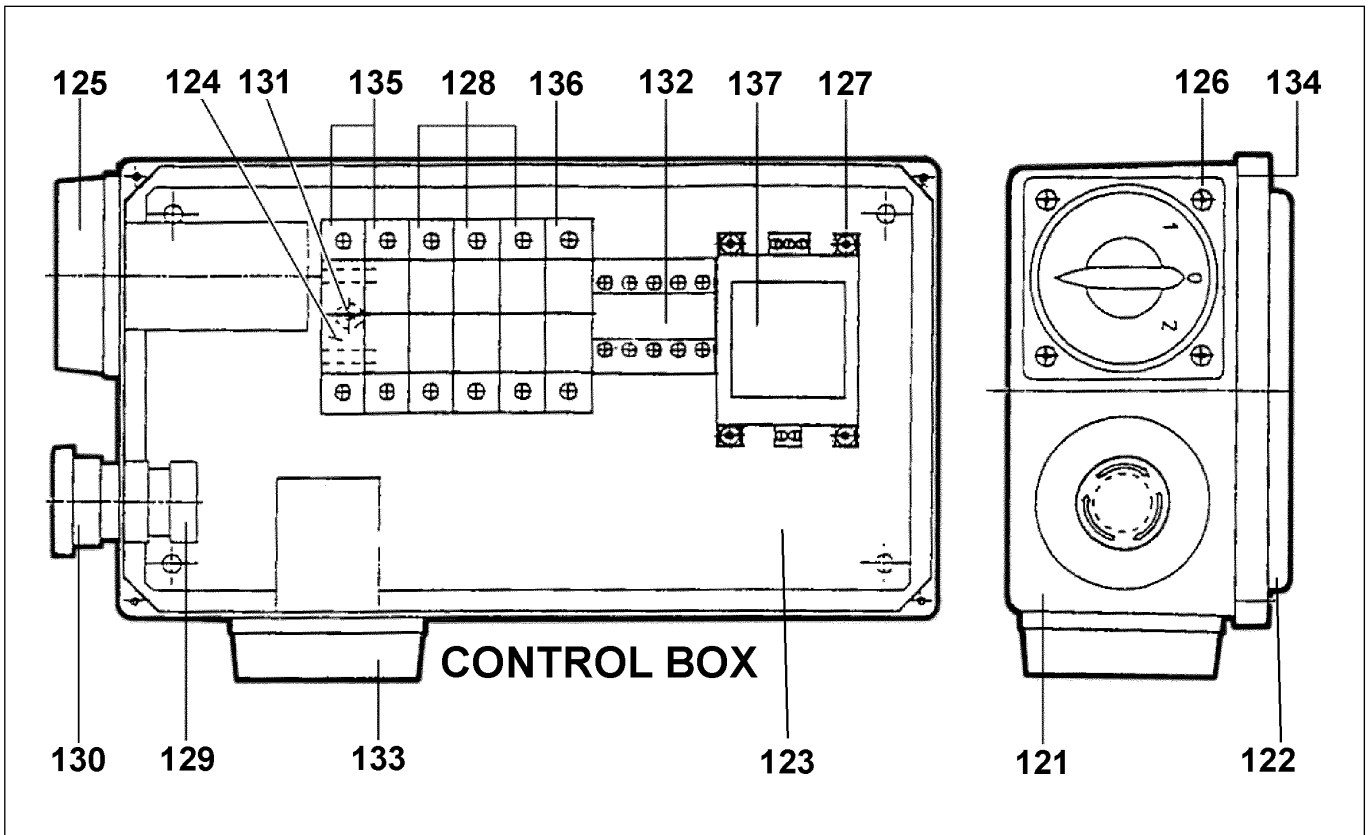

ITEM	PART NO.	DESCRIPTION
48	SM225/25	HEAD LEVER HANDLE
121	SM250/200-A	BOX
122	SM250/200-B	COVER BOX
123	SM250/201	PLATE
124	SM300/202	OMEGA RACEWAY
125	SM250/203	CHANGEOVER SWITCH
126	SM300/204	SCREW (RH) M4X14
127	SM300/205	SCREW (RH) M4X6
128	SM250/206	FUSE BLOC PCH 3X38
129	SM300/207	CONTACT
130	SM250/208	EMERGENCY BUTTON
131	SM300/209	SCREW M4X6
132	SM250/210	REMOTE CONTROLLED SWITCH
133	SM250/212	MAIN SWITCH
134	SM300/214	SCREW (RH) M4X14
135	SM250/215	FUSE FOR PRIMARY CIRCUIT
136	SM250/216	FUSE FOR SECONDARY CIRCUIT
137	SM300/217	TRANSFORMER 20VA
138	SM225/218	MICRO SWITCH OF HANDLE
139	SM300/219	SCREW M4X8 (HSFHC)
140	SM300/220	ELECTRICAL CABLE 2X1
141	SM300/221	SCREW (RH) M2,9X13
142	SM300/222	BUTTON

Issue Date: 10/02/03
Issue No: 2