

Issue Date: 05/11/02  
 Issue No: 1

ITEM	PART NO.	DESCRIPTION
1	SM250/01	WORM SCREW FASTENING
2	SM250/02	WORM SCREW
3	SM250/03	KEY 5X5X30
4	SM250/04	SPLASH GUARD 25-47-7
5	SM250/05	BEARING 6205 ZZ
6	SM250/06	ROTOR
7	SM250/07	STATOR
9	SM250/09	HEAD GEAR
10	SM250/10	BEARING 6204 ZZ
11	SM250/11	BEARING 629
12	SM250/12	SNAP RING, D9
13	SM250/13	PUMP CARRIER
14	SM250/14	MOTOR CASING
15	SM250/15	SCREW TE M8X20
16	SM250/16	NUT MEDIUM M8
17	SM250/17	HEAD CARRYING ARM
18	SM250/18	MOTOR FLANGE
19	SM250/19	KEY 7X8X30
20	SM250/20	HELICAL GEAR
21	SM250/21	HEAD
22	SM225/22	HEAD LEVER
23	SM250/23	SCREW TCEI M8X20
24	SM250/24	WASHER D8X30
25	SM250/25	DISK FASTENING SCREW
26	SM250/26	DISK SHAFT
27	SM225/28	DISK FLANGE
28	SM250/28	SPLASH GUARD 30-40-7
29	SM250/29	DISK GUARD
30	SM250/30	WATER PIPE
31	SM250/31	WASHER D 10X30
33	SM250/33	A.C PUMP
34	SM250/34	OIL LEVEL PLUG
35	SM250/35	POINTED DOWEL M6X10
36	SM250/36	PIN HEAD
37	SM250/37	GRADUATED SCALE
38	SM250/38	SCREW TCEI 6X12
39	SM250/B100	BLADE 250x2x32mm 100T 8mm TOOTH PITCH
39	SM250/B160	BLADE 250x2x32mm 160T 5mm TOOTH PITCH
39	SM250/B250	BLADE 250x2x32mm 250T 3mm TOOTH PITCH
39	SM250/B80	BLADE 250x2x32mm 80T 10mm TOOTH PITCH
40	SM250/40	SCREW M8X30
41	SM250/41	SCREW M10X40
42	SM250/42	BENCH
43	SM250/43	COUNTERVICE
44	SM225/64	BAR STOPPED ROD
45	SM250/45	BAR STOPPED
46	SM225/66	BAR STOPPER KNOB
47	SM250/47	DOWEL M6X10
48	SM250/48	COUNTERVICE PIN
49	SM250/49	BENCH LEVER NUT
50	SM250/50	BENCH LEVER
51	SM250/51	DOWEL M6X10
52	SM250/52	SCREW TCEI 6X16
53	SM250/53	SCREW M10X25
54	SM250/54	ELASTIC P IN 16X16
55	SM250/55	VICE HANDWHEEL
57	SM250/57	ELASTIC PIN 8X36
56	SM250/56	BUSH
58	SM250/58	VICE SCREW
59	SM250/59	VICE
60	SM250/60	VICE JAW
61	SM250/61	OILER D6
62	SM250/62	CRUCIBLE
63	SM250/63	BENCH TAP
64	SM250/64	SCREW TCEI M6X55
65	SM250/65	NUT, BOTTOM M16
68	SM250/68	SCREW TCEI M6X20
69	SM250/69	WASHER D6
70	SM250/70	SCREW TCEI M4X12
71	SM250/71	FAN GUARD
72	SM250/72	FAN
73	SM250/73	NUT, MEDIUM
74	SM250/74	SCREW TCEI M6X20
75	SM250/75	MOVABLE GUARD ROD
76	SM250/76	DISK MOVABLE GUARD
77	SM250/77	SNAP RING D45
78	SM225/25	HEAD, LEVER HANDLE
79	SM250/79	DOWEL M8X35
80	SM250/80	JET-BREAKER
81	SM250/81	PEDESTAL
82	SM250/82	SCREW TE M10X25
83	SM250/83	WASHER D10
84	SM250/84	MOBILE ANTIFRAZE BRAC'T
85	SM250/85	FIXED ANTIFRAZE BRAC'T
86	SM250/86	NUT MEDIUM, M14
86	SM250/C	CABLE
87	SM250/87	SCREW M6X20
88	SM250/88	FILTER, FB1
89	SM250/89	MOVABLE GUARD ROD
90	SM250/90	OIL FILING CAP
91	SM250/91	FLANGE REAR MOTOR
	SM250/M	MOTOR, 1PHASE V.230/50
	SM250/F1	FUSE AM 10X38 1A not shown
	SM250/F10	FUSE AM 10X38 10A not shown
	SM250/F2	FUSE AM 10X38 2A not shown

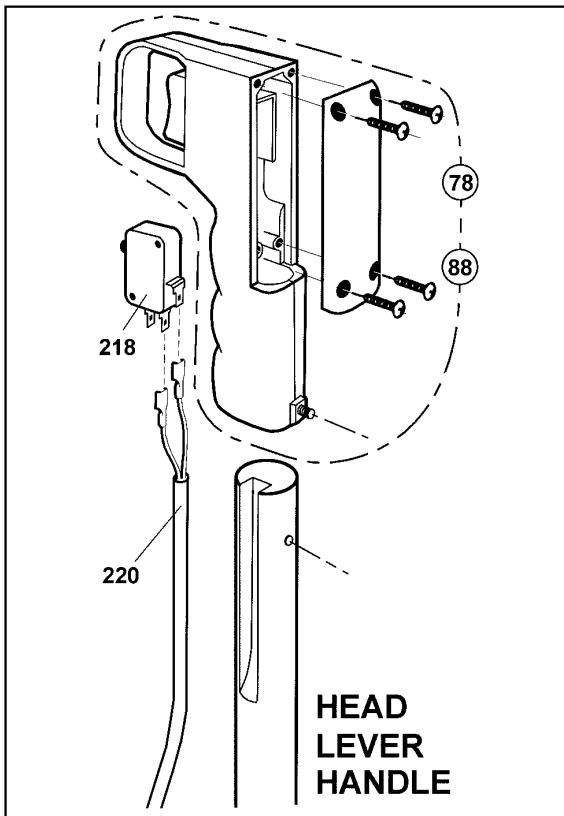

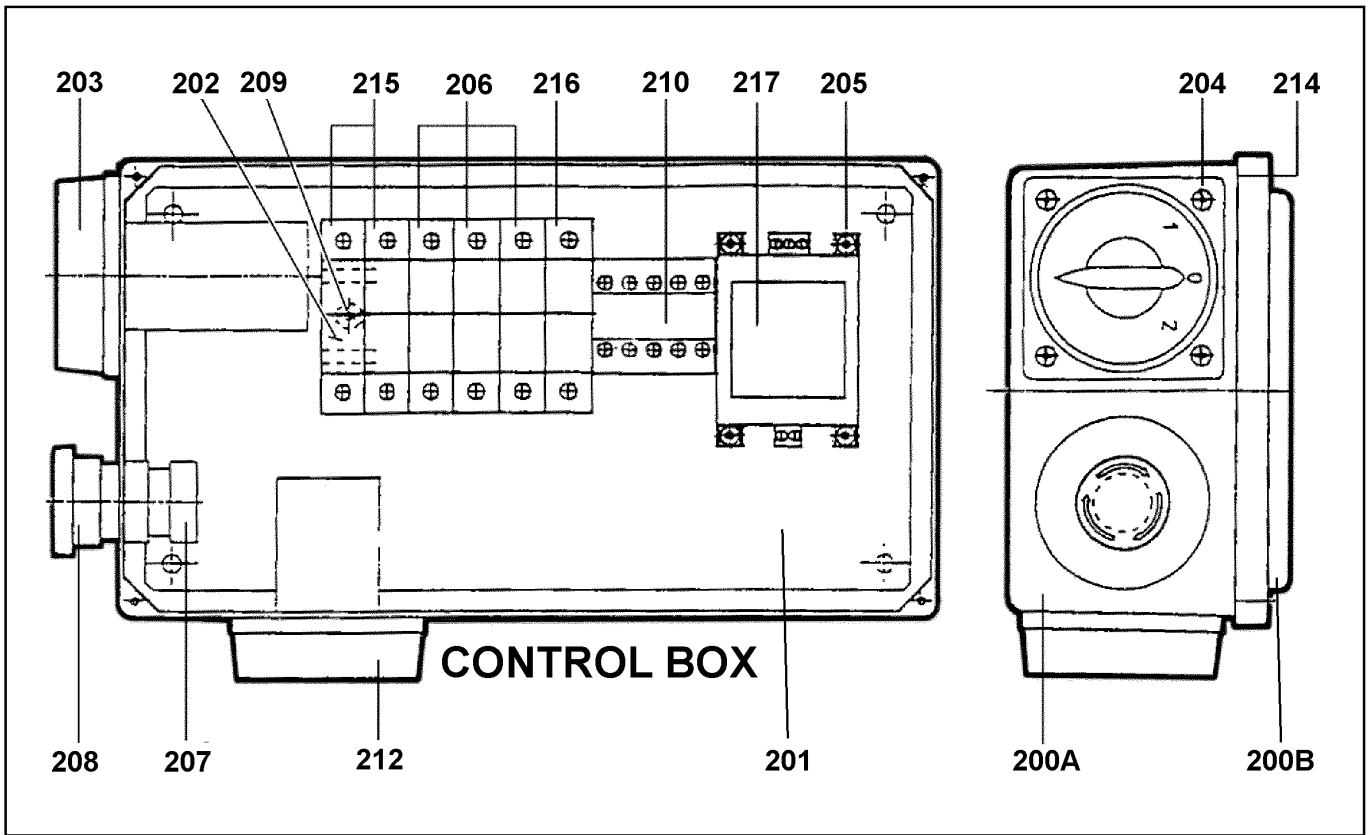

ITEM	PART NO	DESCRIPTION
200A	SM250/200-A	BOX
200B	SM250/200-B	BOX COVER
201	SM250/201	PLATE
202	SM250/202	OMEGA RACEWAY
203	SM250/203	CHANGEOVER SWITCH QS2
204	SM250/204	SCREW M4X14
205	SM250/205	SCREW M4X6
206	SM250/206	POWER FUSE PCH 3X38
207	SM250/207	CONTACT
208	SM250/208	EMERGENCY BUTTON SB 1
209	SM250/209	SCREW TBEI M4X6
210	SM250/210	R'MOTE C'TROL SWITCH KM1
212	SM250/212	MAIN SWITCH QS1
214	SM250/214	SCREW TCCC M4X14
215	SM250/215	PRIMARY FUSE PCH 2X38
216	SM250/216	SECONDARY FUSE PCH 1X38
217	SM250/217	TRANSFORMER 20VA

Issue Date: 05/11/02  
Issue No: 1

ITEM	PART NO	DESCRIPTION
78/88	SM225/25	HEAD, LEVER HANDLE INCLUDES BUTTON
218	SM225/218	MICRO SWITCH OF HANDLE
220	SM250/220	ELECTRICAL CABLE 2X1

