

FIG 1

Item	Part No.	Description
		FIG 1
1	SM223/01	BODY
2	SM223/02	COVER
3	SM223/03	SAFETY LINK
4	SM221/04	PAN SCREW 1/4" x 3/4"
5	SM223/05	RD HEAD S/T SCREW M4X10
6	SM223/03	SAFETY LINK
--	SM223/06	SAFETY PLATE (NOT SHOWN)
7	SN14.UNC	STEEL NUT 1/4" UNC (SINGLE)
8	SM30/A08	OIL DRAIN PLUG

Item	Part No.	Description
8.1	SM221/08-1	OIL SEAL
9	SM223/09	SHELF
10	SM40/10	LEG
11	SM223/11	PAN SCREW 1/4" x 3/8"
--	SM221/11-13	PAN SCREW,WASHER & HEX NUT ASSEMBLY (NOT SHOWN)
12	SM223/12	GEAR WASHER 1/4"
13	SM223/13	HEX NUT 1/4"
14	SM40.V2-06	WORK SHELF
15	SM40D.V2-11	FILTER BASKET

NOTE: It is our policy to continually improve products and as such we reserve the right to alter data, specifications and component parts without prior notice.

IMPORTANT: No liability is accepted for incorrect use of product.

WARRANTY: Guarantee is 12 months from purchase date, proof of which will be required for any claim.

FIG 2

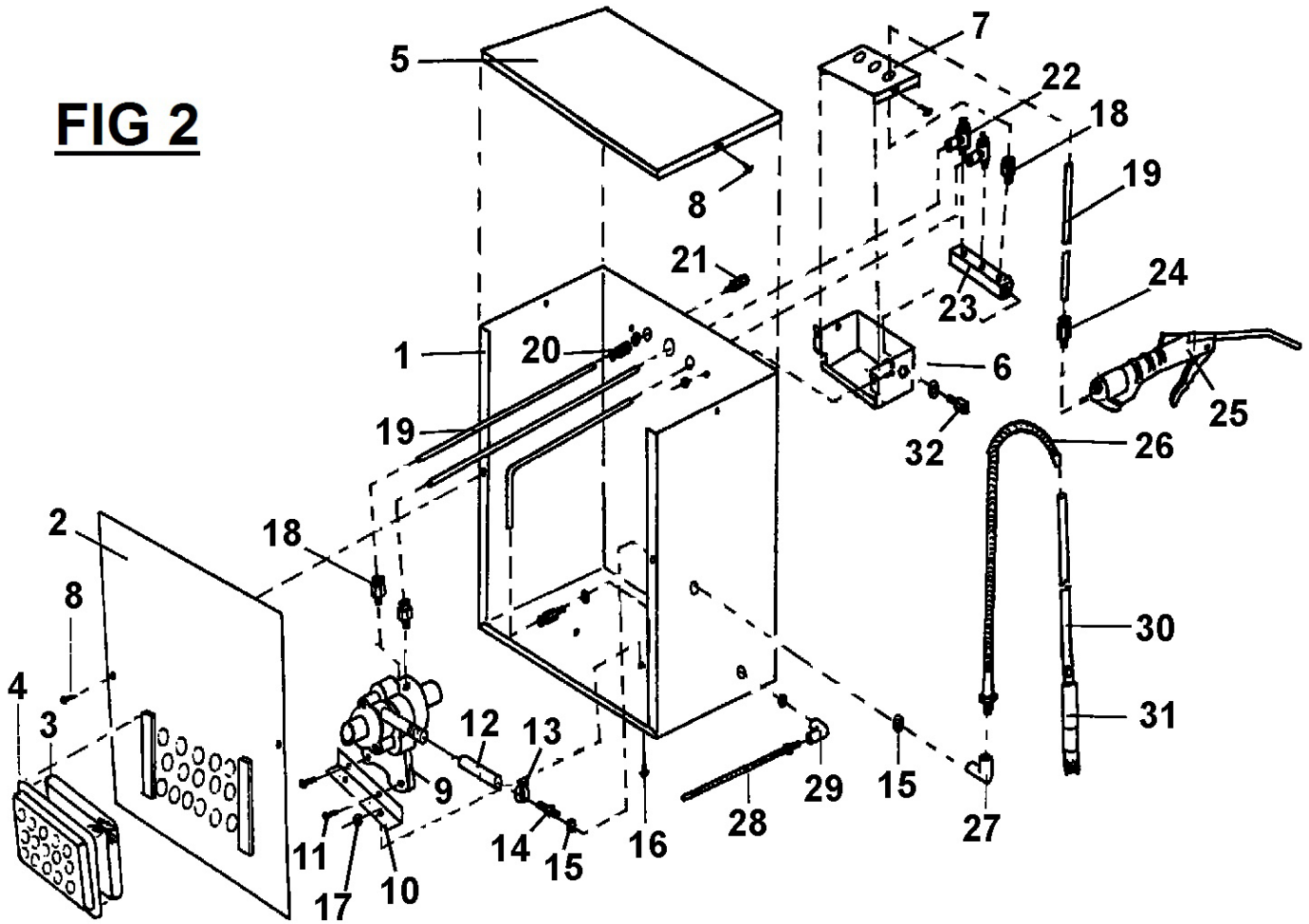

Item	Part No.	Description
		FIG 2
--	SM223/PUMP	PUMP ASSEMBLY (NOT SHOWN)
1	SM221/P-01	PUMP HOUSING
2	SM221/P-02	HOUSING FRONT COVER
3	SM30/A25	FILTER
4	SM221/P-04	FILTER BRACKET
5	SM221/P-05	HOUSING TOP
6	SM221/P-06	ADJUSTABLE SWITCH BOX
7	SM221/P-07	SWITCH BOX COVER
8	SM223/P-08	TAPPING SCREW
9	SM223/P-09	AIR PUMP
10	SM221/P-10	PUMP FIXED PLATE
11	SM223/P-11	PAN SCREW 3/16" x 5/8"
12	SM40/21	FLUID HOSE
13	SM221/P-13	HOSE CLAMP
14	SM221/P-14	CONNECTOR 1/4" x 1/4"
15	FWM12.S	FLAT WASHER M12 SINGLE

Item	Part No.	Description
16	SM223/P-16	PAN SCREW 5/32" x 3/8"
17	SM221/P-17	HEX NUT 5/32"
18	SM221/P-18	PU HOSE QUICK CONNECTOR 1/8"
19	SM223/P-19	PU HOSE 5mm x 8mm x 1040mm
20	SM221/P-20	PU HOSE QUICK CONNECTOR INSIDE THREAD
21	SM221/P-21	SILENCER 1/8"
22	SM22C.P-22	ADJUSTABLE SWITCH
23	SM221/P-23	INLET PIPE
24	SM221/P-24	PU HOSE QUICK CONNECTOR 1/4"
25	SM221/P-25	AIR BLOW GUN
26	SM40D.V2-18	FLEXIBLE PIPE
27	SM221/P-27	L CONNECTOR INSIDE THREAD 1/4"
28	SM221/P-28	TURBO SPIGOT
29	SM221/P-29	L CONNECTOR INSIDE THREAD 1/8"
30	SM221/P-30	CLEAR TUBE
31	SM221/P-31	CLEANING BRUSH
32	SM221/P-32	INLET CONNECTOR 1/4"INSIDE THREAD

NOTE: It is our policy to continually improve products and as such we reserve the right to alter data, specifications and component parts without prior notice.

IMPORTANT: No liability is accepted for incorrect use of product.

WARRANTY: Guarantee is 12 months from purchase date, proof of which will be required for any claim.