

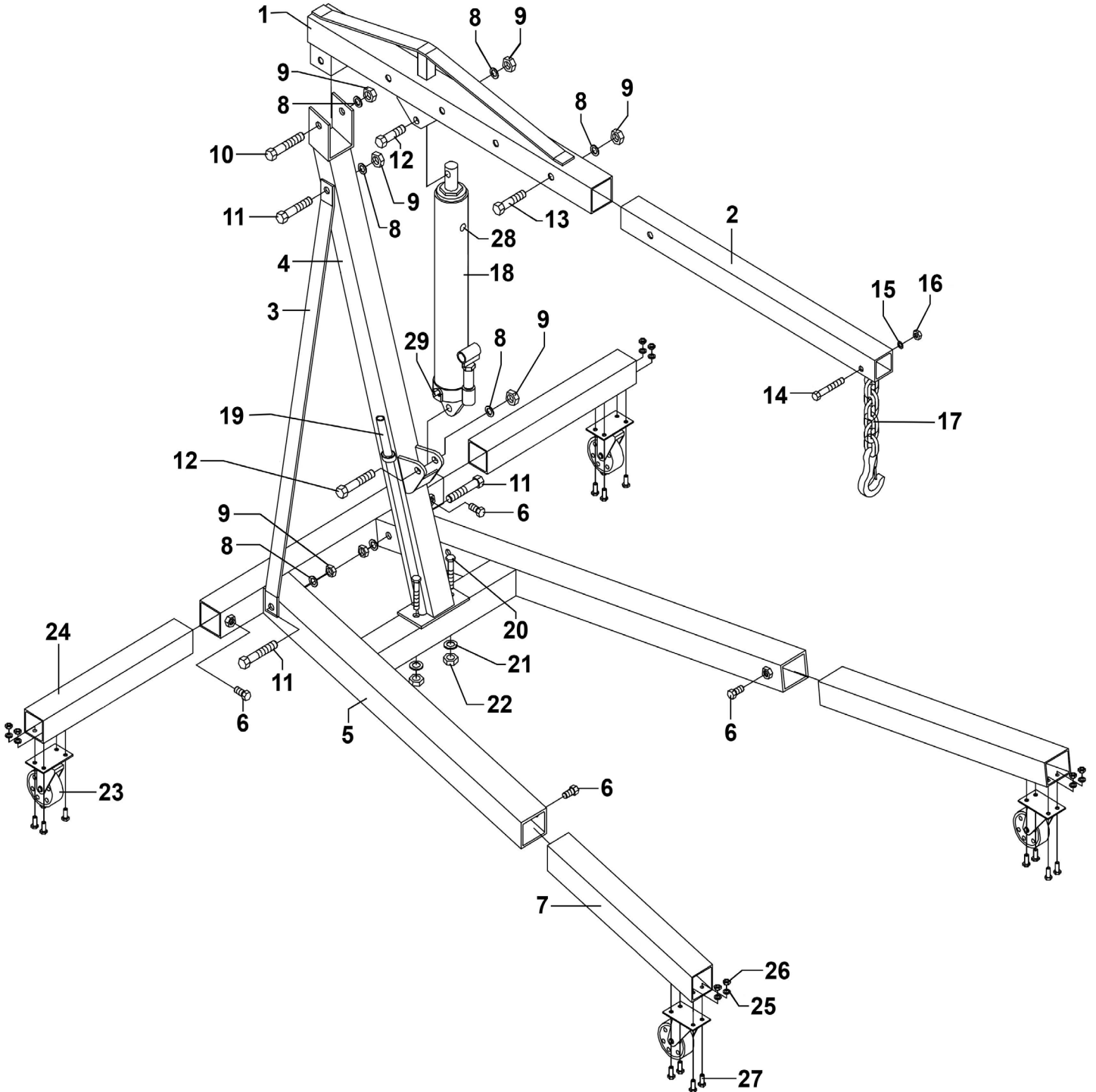

Parts Information:
Engine Crane 1 Tonne Long Reach
Extendable Legs
Model No: SC10LR.V4



NOTE: It is our policy to continually improve products and as such we reserve the right to alter data, specifications and component parts without prior notice. There may be alternative versions of this product, please contact us should you require this information.

IMPORTANT: No liability is accepted for incorrect use of product. Spare parts must be fitted by a competent person

WARRANTY: Guarantee is 12 months from purchase date, proof of which will be required for any claim.

Sealey Group, Kempson Way, Suffolk Business Park, Bury St Edmunds, Suffolk. IP32 7AR



01284 757500



sales@sealey.co.uk



www.sealey.co.uk



Parts Information:
Engine Crane 1 Tonne Long Reach
Extendable Legs
Model No: SC10LR.V4

Item	Part No.	Description	Qty
1	SC10LR-V4-01	Boom	1
2	SC10LR-V4-02	Boom Extension (Grey)	1
3	SC10LR-V4-03	Support Brace	2
4	SC10LR-V4-04	Main Post	1
5	SC10LR-V4-05	Frame Base (Grey)	1
6	SS1225.S	Hex Head Set Screw M12 X 25 Zinc	1
7	SC10LR-V4-07	Front Leg	2
8	FWM16.S	Flat Washer M16 Zinc	7
9	SN16.S	Steel Nut M16 Zinc	7
10	HHB16110.S	Hex Head Bolt M16 x 110mm	1
11	HHB16100.S	Hex Head Bolt M16 x 100mm	3
12	SC10LR-V4-12	Hex Head Bolt M16 x 85mm	2
13	HHB1690.S	Hex Head Bolt M16 x 90mm	1
14	HHB1280.S	Hex Head Bolt M12 x 80mm	1
15	FWM12.S	Flat Washer M12 Zinc	1

Item	Part No.	Description	Qty
16	SN12.S	Steel Nut M12 Zinc	1
17	SC10LR-V4-17	Chain & Hook Assembly	1
18	SC10LR.V3-18	Hydraulic Ram	1
19	SC10LR-V4-19	Pump Handle	1
20	HHB14100.S	Hex Head Bolt M14 x 100mm	2
21	FWM14.S	Flat Washer M14 Zinc	2
22	SN14.S	Steel Nut M14 Zinc	2
23	SC10LR-V4-23	Wheel, Swivel Castor, 4-Bolt Fixing	4
24	SC10LR-V4-24	Rear Leg	2
25	FWM8.S	Flat Washer M8 Zinc	16
26	SN8.S	Steel Nut M8 Zinc	16
27	SS820.S	Hex Head Set Screw M8 X 20 Zinc	16
28	SC10LR-V4-28	Oil Filler Plug	1
29	SC10LR-V4-29	Release Valve	1
--	SC10LR-V4-RK	Repair Kit	1

NOTE: It is our policy to continually improve products and as such we reserve the right to alter data, specifications and component parts without prior notice. There may be alternative versions of this product, please contact us should you require this information.

IMPORTANT: No liability is accepted for incorrect use of product. Spare parts must be fitted by a competent person

WARRANTY: Guarantee is 12 months from purchase date, proof of which will be required for any claim.

Sealey Group, Kempson Way, Suffolk Business Park, Bury St Edmunds, Suffolk. IP32 7AR



01284 757500



sales@sealey.co.uk



www.sealey.co.uk