

## Parts Information: Engine Crane 1 Tonne Long Reach Extendable Legs Model No: SC10LR.V3

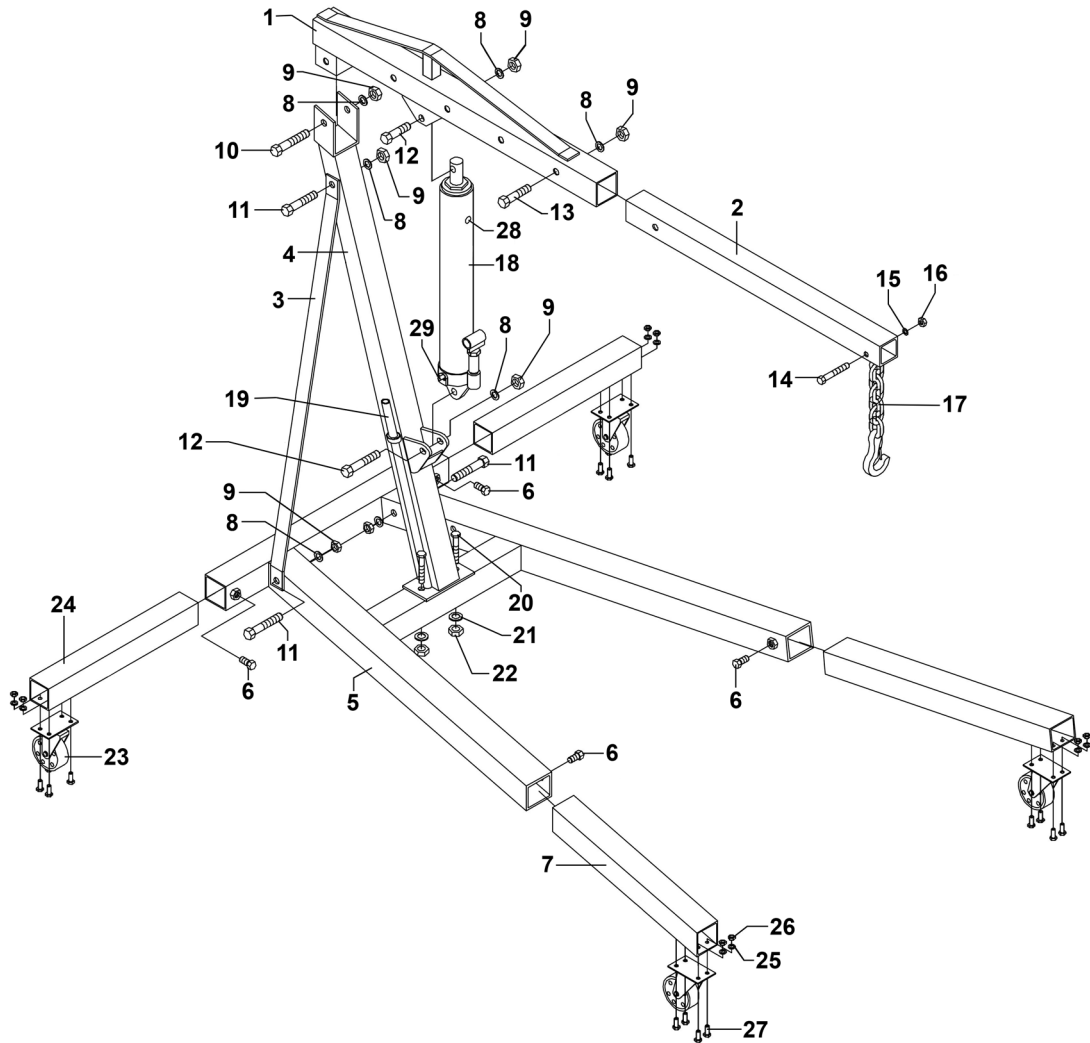

Item	Part No.	Description
1	SC10LR-V3-01	Boom
2	SC10LR-V3-02	Boom Extension
3	SC10LR-V3-03	Support Brace
4	SC10LR-V3-04	Main Post
5	SC10LR-V3-05	Frame Base
6	SS1225.S	Hex Head Set Screw M12 X 25 Zinc
7	SC10LR-V3-07	Front Leg
8	FWM16.S	Flat Washer M16 Zinc
9	SN16.S	Steel Nut M16 Zinc
10	HHB16110.S	Hex Head Bolt M16 x 110mm
11	HHB16100.S	Hex Head Bolt M16 x 100mm
12	SC10LR-V3-12	Hex Head Bolt M16 x 85mm
13	HHB1690.S	Hex Head Bolt M16 x 90mm
14	HHB1280.S	Hex Head Bolt M12 x 80mm
15	FWM12.S	Flat Washer M12 Zinc

Item	Part No.	Description
16	SN12.S	Steel Nut M12 Zinc
17	SC10LR-V3-17	Chain & Hook Assembly
18	SC10LR-V3-18	Hydraulic Ram
19	SC10LR-V3-19	Pump Handle
20	HHB14100.S	Hex Head Bolt M14 x 100mm
21	FWM14.S	Flat Washer M14 Zinc
22	SN14.S	Steel Nut M14 Zinc
23	SC10LR-V3-23	Swivel Castor Wheel
24	SC10LR-V3-24	Rear Leg
25	FWM8.S	Flat Washer M8 Zinc
26	SN8.S	Steel Nut M8 Zinc
27	SS820.S	Hex Head Set Screw M8 X 20 Zinc
28	SC10LR-V3-28	Oil Filler Plug
29	SC10LR-V3-29	Release Valve
--	SC10LR-V3-RK	Repair Kit for SC10LRV3

**NOTE:** It is our policy to continually improve products and as such we reserve the right to alter data, specifications and component parts without prior notice. There may be alternative versions of this product, please contact us should you require this information.

**IMPORTANT:** No liability is accepted for incorrect use of product. Spare parts must be fitted by a competent person

**WARRANTY:** Guarantee is 12 months from purchase date, proof of which will be required for any claim.