

Original Date: 010700
 Issue Date: 010700
 Issue No: 1
 Date Modified: 140800

Item	Model & Part No	Model & Part No	Description	Item	Model & Part No	Model & Part No	Description
1	SA680/01	SA681/01	MOTOR HOUSING	33	SA680/33	SA681/33	O-RING
2	SA680/02	SA681/02	REAR COVER	34	SA680/34	SA681/34	PIN
3	SA680/03	SA681/03	REAR GASKET	35	SA680/35	SA681/35	BALL
4	SA680/04	SA681/04	SCREW	36	SA680/36	SA681/36	SPRING
5	SA680/05	SA681/05	WASHER	37	SA680/37	SA681/37	C-RING
6	SA680/06	SA681/06	BLIND CAP	38	SA680/38	SA681/38	LEVER REVERSE
7	SA680/07	SA681/07	OIL PACKING	39	SA680/39	SA681/39	PIN
8	SA680/08	SA681/08	ANVIL BUSHING	40	SA680/40	SA681/40	BEARING
9	SA680/09	SA681/09	OIL SEAL	41	SA680/41	SA681/41	OIL SEAL
10	SA680/10	SA681/10	CLUTCH HOUSING	42	SA680/42	SA681/42	FRONT END PLATE
11	SA680/11	SA681/11	FRONT GASKET	43	SA680/43	SA681/43	O-RING
12	SA680/12	SA681/12	SCREW	44	SA680/44	SA681/44	PIN
13	SA680/13	SA681/13	SCREW	45	SA680/45	SA681/45	CYLINDER
14	SA680/14	SA681/14	HANDLE DEAD	46	SA680/46	SA681/46	ROTOR
15	SA680/15	SA681/15	SCREW	47	SA680/47	SA681/47	ROTOR BLADE
16	SA680/16	SA681/16	WASHER	48	SA680/48	SA681/48	REAR END PLATE
17	SA680/17	SA681/17	PROTECTING RUBBER	49	SA680/49	SA681/49	BEARING
18	SA680/18	SA681/18	PROTECTING RUBBER	500	SA680/50	SA681/50	PIN
19	SA680/19	SA681/19	HANDLE COVER	51	SA680/51	SA681/51	PIN
20	SA680/20	SA681/20	HANGER	52	SA680/52	SA681/52	HAMMER CAGE
21	SA680/21	SA681/21	TRIGGER	53	SA680/53	SA681/53	DRIVE CAM BASE
22	SA680/22	SA681/22	TRIGGER PIN	54	SA680/54	SA681/54	BALL
23	SA680/23	SA681/23	BUSHING	55	SA680/55	SA681/55	DRIVE CAM
24	SA680/24	SA681/24	THROTTLE PIN	56	SA680/56	SA681/56	HAMMER BAR
25	SA680/25	SA681/25	STEAL BALL	57	SA680/57	SA681/57	SPRING
26	SA680/26	SA681/26	SPRING	58	SA680/58	SA681/58	ANVIL 2"
27	SA680/27	SA681/27	HOSE FITTING	59	SA680/59	SA681/59	WASHER
28	SA680/28	SA681/28	O-RING	60	SA680/60	SA681/60	O-RING
29	SA680/29	SA681/29	DUST COVER	61	SA680/61	SA681/61	ANVIL COLLAR
30	SA680/30	SA681/30	SCREW	62	SA680/62	SA681/62	DRIVE SHAFT
31	SA680/31	SA681/31	VALVE SLEEVE	63	SA680/63	SA681/63	PIN
32	SA680/32	SA681/32	REVERSE VALVE	64	SA680/64	SA681/64	SCREEN

NOTE: It is our policy to continually improve products and as such we reserve the right to alter data, specifications and component parts without prior notice. **IMPORTANT:** No liability is accepted for incorrect use of this equipment. **WARRANTY:** Guarantee is 12 months from purchase date, proof of which will be required for any claim. **INFORMATION:** Call us for a copy of our latest catalogue and promotions on 01284 757525 and leave your full name and address including your postcode.

INSTRUCTIONS FOR
1" AIR IMPACT WRENCH
 Models: **SA680 & SA681**

Thank you for purchasing a Sealey Product. Manufactured to a high standard this product will, if used according to these instructions and properly maintained, give you years of trouble free performance.

! IMPORTANT: PLEASE READ THESE INSTRUCTIONS CAREFULLY. NOTE THE SAFE OPERATIONAL REQUIREMENTS, WARNINGS AND CAUTIONS. USE THIS PRODUCT CORRECTLY AND WITH CARE FOR THE PURPOSE FOR WHICH IT IS INTENDED. FAILURE TO DO SO MAY CAUSE DAMAGE OR PERSONAL INJURY AND WILL INVALIDATE THE WARRANTY. PLEASE KEEP INSTRUCTIONS SAFE FOR FUTURE USE.

1. SAFETY INSTRUCTIONS

- 3 Follow all workshop safety rules, regulations, and conditions when using wrench.
- p **WARNING!** Disconnect from air supply before changing accessories or servicing.
- 3 Maintain the wrench in good condition and replace any damaged or worn parts. Use genuine parts only. Non-authorized parts may be dangerous and will invalidate the warranty.
- p **WARNING!** Check correct air pressure is maintained and not exceeded. We recommend 90psi.
- 3 Keep air hose away from heat, oil and sharp edges. Check air hose for wear before each use and ensure that all connections are secure.
- 3 Only use impact sockets which are specifically designed for use with a impact wrench.
- 3 Wear approved safety eye/face shield, ear defenders, and hand protection.
- p **WARNING!** Due to the possible presence of asbestos dust from brake linings, when working around vehicle brake systems we recommend you wear suitable respiratory protection
- 3 Maintain correct balance and footing. Ensure the floor is not slippery and wear non-slip shoes.
- 3 Keep children and unauthorised persons away from the working area.
- 7 DO NOT use the wrench for a task it is not designed to perform.
- p **WARNING! DO NOT** use wrench if damaged or thought to be faulty. (Contact Service Agent).
- 7 DO NOT use wrench unless you have been instructed in its use by a qualified person.
- 7 DO NOT drop, throw or abuse the wrench as it is a precision tool.
- 7 DO NOT carry the wrench by the air hose, or yank the hose from the air supply.
- 7 DO NOT operate wrench if you are tired, under the influence of alcohol, drugs or intoxicating medication.
- 7 DO NOT carry wrench with your hand on the power trigger in order to avoid unintentional starting.
- 7 DO NOT direct air from the air hose at yourself or others.
- 3 When not in use disconnect from air supply and store in a safe, dry, childproof location.

2. INTRODUCTION & SPECIFICATIONS

Heavy duty 1" air tool suitable for commercial and agricultural vehicle use. Pin clutch mechanism gives high power:weight ratio. Straight pattern and top side exhaust allow wide variety of applications. Supplied with side handle and spring balance hoop. The SA681 has a long anvil to allow use on wheels with a deep dish.

MODEL SA680

Drive size 1" Sq
 Working/Max torque 1400/1600ft/lb
 Ultimate torque 1800ft/lb
 Air consumption 42cfm
 Operating pressure 90psi
 Air inlet size 1/2" BSP
 Weight 21.5kg

MODEL SA681

Drive size 1" Sq
 Working/Max torque 1100/1450ft/lb
 Ultimate torque 1800ft/lb
 Air consumption 42cfm
 Operating pressure 90psi
 Air inlet size 1/2" BSP
 Weight 21.5kg

3. PREPARING WRENCH FOR USE

3.1. Air Supply

- 3.1.1. Ensure wrench air valve (or trigger) is in the "off" position before connecting to the air supply.
- 3.1.2. You will require an air pressure of 90psi, and an air flow according to specification.
- 3.1.3. **WARNING!** Ensure the air supply is clean and does not exceed 90 psi while operating the wrench. Too high an air pressure and unclean air will shorten the product life due to excessive wear, and may be dangerous causing damage and/or personal injury.
- 3.1.4. Drain the air tank daily. Water in the air line will damage the wrench.
- 3.1.5. Clean air inlet filter weekly. Recommended hook-up procedure is shown in fig 1.
- 3.1.6. Line pressure should be increased to compensate for unusually long air hoses (over 8 metres). The minimum hose diameter should be 1/4" I.D. and fittings must have the same inside dimensions.
- 3.1.7. Keep hose away from heat, oil and sharp edges. Check hose for wear, and make certain that all connections are secure.

3.2. Couplings.

Vibration may cause failure if a quick change coupling is connected directly to the wrench. To overcome this, connect a leader hose to the wrench. A quick change coupling may then be used to connect the leader hose to the air line recoil hose. See fig 1 & 2.

fig 1

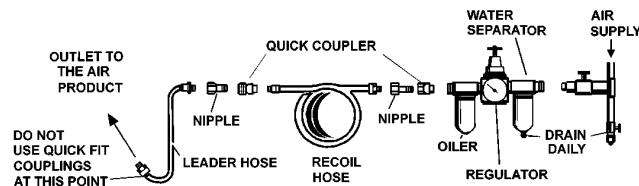

3.3. OTHER

Connect the side handle to the wrench with bolts provided.

fig 2

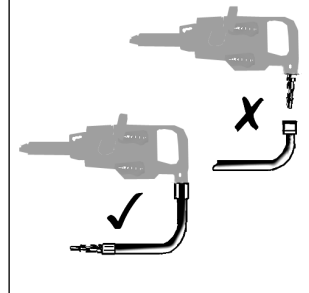

4. OPERATING INSTRUCTIONS

WARNING! Ensure you read, understand and apply safety instructions before use.

- 4.1. Only use impact sockets which are specifically designed for use with a impact wrench.
- 4.2. Connect the wrench to the air hose as in chapter 3.
- 4.3. Place the socket over the subject nut and depress the trigger to operate the wrench.
- 4.4. To change wrench direction turn the reverse lever.
- 4.5. The flow of air may be regulated by turning the screw below the trigger.

DO NOT use any additional force upon the wrench in order to remove a nut.

DO NOT allow wrench to free run for an extended period of time as this will shorten its life.

5. MAINTENANCE

- WARNING!** Disconnect wrench from air supply before changing accessories, servicing or performing maintenance. Replace or repair damaged parts. *Use genuine parts only. Non-authorized parts may be dangerous and will invalidate the warranty.*
- 5.1. Lubricate the air wrench daily with a few drops of Sealey air tool oil dripped into the air inlet to prolong its life.
 - 5.2. Clean the wrench after use. DO NOT use worn, or damaged sockets.
 - 5.3. Loss of power or erratic action may be due to the following:
 - a) Excessive drain on the air line. Moisture or restriction in the air pipe. Incorrect size or type of hose connectors. To remedy check the air supply and follow instructions in chapter 3.
 - b) Grit or gum deposits in the wrench may also reduce performance. If your model has an air strainer (located in the area of the air inlet), remove the strainer and clean it. Flush the wrench out with gum solvent oil or an equal mixture of SAE No 10 oil and paraffin. Allow to dry before use.
 - 5.4. For a full service contact your local Sealey service agent.
 - 5.5. When not in use, disconnect from air supply, clean wrench and store in a safe, dry, childproof location.

Declaration of Conformity



We, the sole importer into the UK, declare that the products listed here are in conformity with the following EEC standards and directives. The construction files for these products are held by the Manufacturer and may be inspected, by a national authority, upon request to Jack Sealey Ltd.

Air Impact Wrench
Models: SA680 & SA681
98/37/EC Machinery Directive
93/68/EEC Marking Directive

Signed by Mark Sweetman

1st July 2000

For Jack Sealey Ltd. Sole importer into the UK
of Sealey Power Tools.