

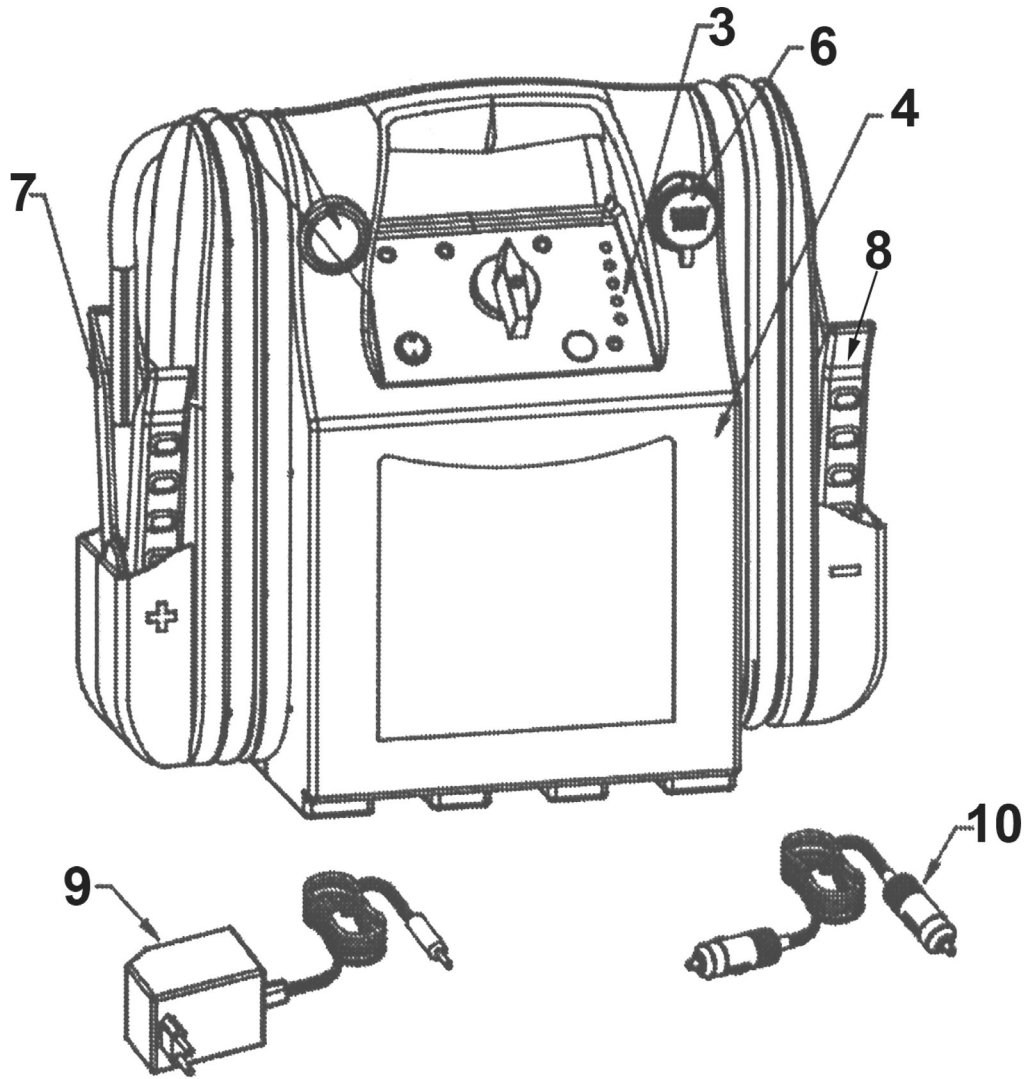

Parts Information:
RoadStart® Emergency Power Pack 24V
1600 Peak Amps
Model No: RS104.V2



Item	Part No.	Description
--	RS1/B	BATTERY 12V 17 AH (NOT SHOWN)
--	RS104.02	LED DISPLAY LABEL (NOT SHOWN)
3	RS104.V2-03	MULTIPLE LED POWER INDICATOR
4	RS103.04	COMPLETE CASE
--	RS103.04A	CASE FRONT (NOT SHOWN)
--	RS103.04B	CASE REAR (NOT SHOWN)

Item	Part No.	Description
6	RS103.06	CIGARETTE LIGHTER SOCKET(c/w CAP)
7	RS103.07	HEAVY DUTY CLAMP + CABLE (NEGATIVE)
8	RS103.08	HEAVY DUTY CLAMP + CABLE (POSITIVE)
9	RS104.09	WALL CHARGER (24V)
10	RS103.10	EXTENSION CORD
--	RS3010AUA	UNIVERSAL ADAPTOR 1.0A 30V (NOT SHOWN)

NOTE: It is our policy to continually improve products and as such we reserve the right to alter data, specifications and component parts without prior notice.

IMPORTANT: No liability is accepted for incorrect use of product.

WARRANTY: Guarantee is 12 months from purchase date, proof of which will be required for any claim.

Sealey Group, Kempson Way, Suffolk Business Park, Bury St Edmunds, Suffolk. IP32 7AR



01284 757500



01284 703534



sales@sealey.co.uk



www.sealey.co.uk