

HYDRAULIC PULLER SET

MODEL NO: **PS982**

1. INTRODUCTION

1.1. INTRODUCTION

PS982 consists of a set of gear pullers and a forged steel bearing separator, all operated by a 10 ton hydraulic ram. The ram is also compatible with sets PS981 and PS983.

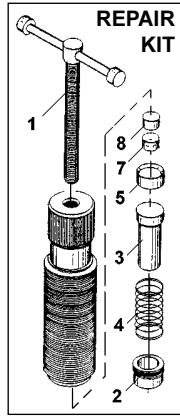
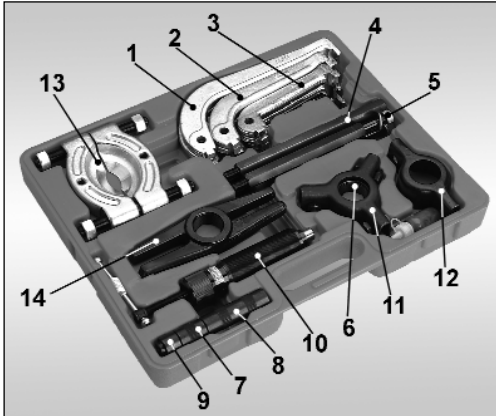

2. CONTENTS & PARTS

Item	Part No.	Description	PARTS LIST	Issue Date:-	Issue No.:-
1	PS982/8004	Leg, 200mm, 3 off		12/05/05	3
2	PS982/8006	Leg, 150mm, 3 off			
3	PS982/8008	Leg, 100mm, 3 off			
4	PS982/9016	Rod, Main, 2 off			
5	PS982/9017	Rod, Extension, 2 off			
6	PS982/8011	Ring, Ram			
7	PS982/8014	Rod, Ram Extension, 50mm			
8	PS982/8015	Rod, Ram Extension, 100mm			
9	PS982/8013	Centre Adaptor, 1 1/4"			
10	PS990	Ram, Hydraulic, 10 ton			
11	PS982/9013	Head, Triple			
12	PS982/9012	Head, Twin			
13	PS988	Separator, 105mm			
14	PS982/9014	Beam			
	PS982/OIL	15grms of oil for a single refill (not supplied)			
	PS982/8002	Repair Kit for PS990 Ram (not supplied)			

3. SAFETY INSTRUCTIONS

- ❑ **WARNING!** Ensure all Health and Safety, local authority, and general workshop practice regulations are strictly adhered to when using tools.
- x **DO NOT** use tools if damaged or worn.
- ✓ Maintain the tools in good and clean condition for best and safest performance.
- ✓ Ensure all threads are clean and well lubricated.
- ✓ Always check that puller is correctly assembled and is square with the workpiece.
- ✓ If vehicle is raised, ensure it is adequately supported with axle stands, ramps, etc. as appropriate.
- ✓ Wear suitable clothing to avoid snagging. Do not wear jewellery. Tie back long hair.
- ✓ Wear approved eye protection. A full range of personal safety equipment is available from your Sealey dealer.
- ✓ Where possible shield workpiece with canvas or similar to provide protection against failed parts.
- x **DO NOT** heat puller jaws when heating a gear or bearing as this will affect the temper and, therefore, the strength of the material.
- x **DO NOT** use any tool or lever to turn the ram tommy bar, use hand effort only.
- x **DO NOT** hit workpiece, or ram, with a hammer if workpiece has not moved with maximum puller force applied. Use a larger capacity puller.
- ✓ Account for all tools and parts being used and do not leave them in or on the vehicle.

IMPORTANT: Always refer to the vehicle manufacturer's service instructions, or proprietary manual, to establish the correct procedure and data. These instructions for use are provided as a guide only.

4. INSTRUCTIONS FOR USE

- ❑ **WARNING! Ensure that you read, understand and apply the safety instructions in Section 3.**
- 4.1. Confirm that the workpiece is retained by interference fit (parallel or taper) only.
- 4.2. Assemble the appropriate puller, see fig.1, and adjust T-handle (Fig. 2.A) so that tommy bar (fig.2.B) is approximately 80mm (3") above top of ram, see fig.2.
- 4.3. Fit the puller claws behind the workpiece and then screw ram body down, with centre adaptor (item 10) over piston end, until centre adaptor point locates in end of shaft from which workpiece is to be pulled. If necessary use ram extension(s) (items 8 & 9) to achieve this.
- 4.4. Turn T-handle clockwise, by hand only, to pull workpiece from shaft.
- 4.5. Do not screw T-handle in further than 25mm (1") from end of the ram (see fig.2). If workpiece requires additional movement then unscrew T-handle to 80mm from end of ram, screw ram body down so that centre adaptor again contacts shaft and then continue to draw workpiece up shaft.

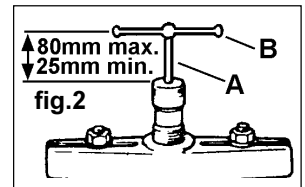

IMPORTANT: The maximum safe load for the puller can be achieved by hand effort alone. **The use of tools or levers on the tommy bar to increase the load will damage the puller and may result in injury.** Such misuse will also invalidate the warranty. If the workpiece does not move, with maximum puller force applied, **DO NOT** hit it, or the puller, in an attempt to jar it free. Damage to puller/workpiece and personal injury may result. Use a larger capacity puller.

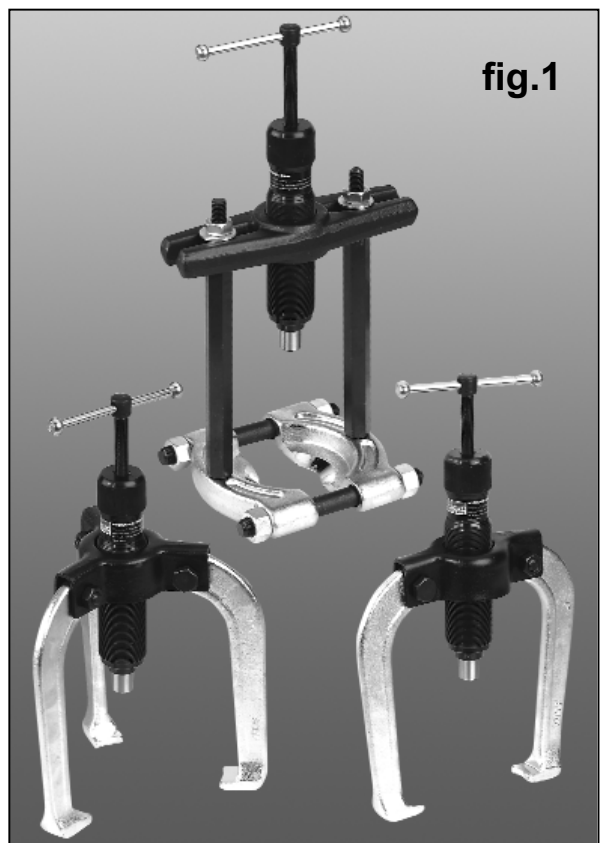

fig.1