

NOTE: It is our policy to continually improve products and as such we reserve the right to alter data, specifications and component parts without prior notice.

IMPORTANT: No liability is accepted for incorrect use of product.

WARRANTY: Guarantee is 12 months from purchase date, proof of which will be required for any claim.



Parts Information:
Inverter Plasma 40Amp 230V
Model No: PP40.V3

| Item | Part No. | Description |
|------|------------|----------------------------|
| 1 | 120/112017 | Potentiometer |
| 2 | 120/112342 | Relay |
| 3 | 120/112357 | Rectifier |
| 4 | 120/990606 | Control Card |
| 5 | 120/990607 | Auxiliary Control Card |
| 6 | 120/112459 | Filter Card |
| 7 | 120/112048 | Resistor |
| 8 | 120/112514 | Capacitor 470UF 400V 50x35 |
| 9 | 120/990409 | Knob Kit |
| 10 | 120/990148 | Microcontroller |
| 11 | 120.980732 | H.F Card |
| 12 | 120/122144 | Air Switch |
| 13 | 120/122154 | Electro Valve |
| 14 | 120/122155 | Electro Valve 230V |
| 15 | 120.121007 | Switch |
| 16 | 120/122508 | Thermal Switch 10,0A |
| 17 | 120/122599 | Switch |
| 18 | 120/122626 | Thermal Switch |
| 21 | 120/152101 | Fan |

| Item | Part No. | Description |
|------|------------|---|
| 22 | 120/152231 | Current Transformer |
| 23 | 120.990622 | Kit Transformer + Reactance |
| 24 | 120.169157 | HF Transformer |
| 25 | 120.322112 | Bushing |
| 26 | 120/322065 | Buckle |
| 27 | 120/322408 | Belt |
| 28 | 120/322449 | Frame |
| 29 | 120.602326 | Manometer |
| 30 | 120.644951 | Bottom (Black) |
| 31 | 120/655010 | Cover |
| 32 | 120/712231 | Work Clamp |
| 33 | 120/712035 | Dinse Socket |
| 34 | 120/722439 | Torch Connection |
| 35 | 120/742040 | Plasma Torch (Marked CB50) |
| 36 | 120/990613 | Kit Diode-IGBT-Resistance |
| 37 | 120/990614 | Kit Primary PCB |
| 38 | 120/990615 | Kit Secondary PCB |
| 39 | 120/120203 | Gas Regulator |
| -- | 120/712039 | Dinse Plug Small (9mm Pin 10-25mm Cable) (NOT SHOWN) |

NOTE: It is our policy to continually improve products and as such we reserve the right to alter data, specifications and component parts without prior notice.

IMPORTANT: No liability is accepted for incorrect use of product.

WARRANTY: Guarantee is 12 months from purchase date, proof of which will be required for any claim.

Sealey Group, Kempson Way, Suffolk Business Park, Bury St Edmunds, Suffolk. IP32 7AR



01284 757500



01284 703534



sales@sealey.co.uk



www.sealey.co.uk

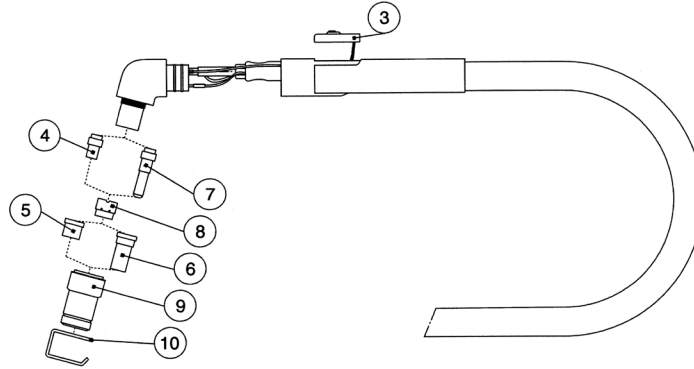

| Item | Part No. | Description |
|------|------------|----------------------------|
| 3 | 120.742349 | Torch Ass'y & Push Button |
| -- | 168.305375 | Switch Red (NOT SHOWN) |
| 4 | 120/802076 | Electrodes (Kit Of 5) |
| 5 | 120/802077 | Nozzles (Kit Of 5) |
| 6 | 120/802078 | Long Electrodes (Kit Of 5) |

| Item | Part No. | Description |
|------|------------|--|
| 7 | 120/802079 | Long Nozzles (Kit Of 5) |
| 8 | 120/802080 | Insulating Diffusers (Kit Of 2) |
| 9 | 120/802081 | Nozzle-Holders (Kit Of 2) |
| 10 | 120/802128 | Spacer Pack Of 5 |
| -- | 120.742041 | Torch Connection "Euro Type" (NOT SHOWN) |

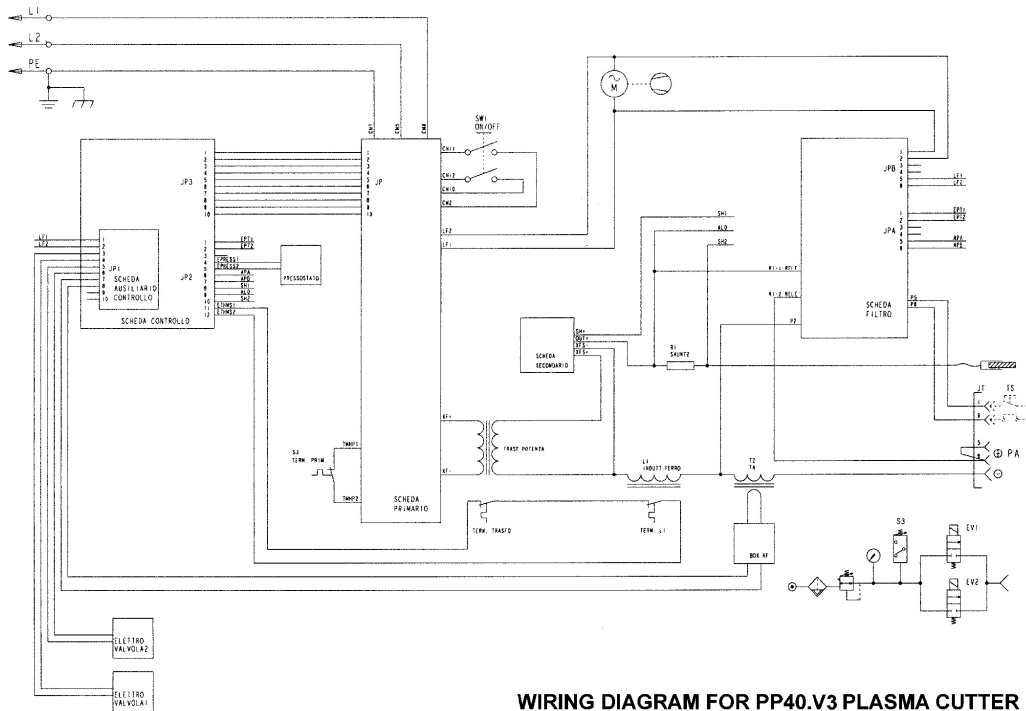

WIRING DIAGRAM FOR PP40.V3 PLASMA CUTTER

NOTE: It is our policy to continually improve products and as such we reserve the right to alter data, specifications and component parts without prior notice.

IMPORTANT: No liability is accepted for incorrect use of product.

WARRANTY: Guarantee is 12 months from purchase date, proof of which will be required for any claim.