



Parts Information:
**Pressure Washer 3200psi with TSS &
 Rotablast Nozzle® 6.3ltr/Min 230V
 Model No: PC2950.V4**

Item	Part No.	Description
	PC2950.V4.KI	MOTOR/PUMP ASSEMBLY
1	FNA.I10002300	MOTOR
2	FNA.43012600	CAM
3	FNA.21006500	WOBBLE PLATE SCREW (LEFT)
4	FNA.43009800	SHEET METAL
5	FNA.23000900	ROLLER
6	FNA.43009900	HEAVY PLATE
7	FNA.43009100	PISTON SPRING SEAT
8	FNA.43010000	PISTON
9	FNA.43010500	PISTON SPRING
10	FNA.26001300	RUBBER SEAL
11	FNA.43008800	PISTON BODY
12	FNA.41003400	PISTON SEAL
13	FNA.22005200	SMALL O-RING
14	FNA.42020800	PILOT SHEATH
15	FNA.42021200	GRAPHITE RING
16	FNA.22005100	PISTON O-RING
17	FNA.22004300	O-RING PILOT SHEATH
18	FNA.22004200	O-RING
19	FNA.42020900	CHECK VALVE COUPLING
20	FNA.42021100	CHECK VALVE PEDESTAL
21	FNA.43010300	CHECK VALVE SPRING
22	FNA.43009200	CHECK VALVE
23	FNA.42021000	CHECK VALVE COVER
24	FNA.22004400	CHECK VALVE O-RING
25	FNA.43016800	PUMP BODY
27	FNA.21006400	CAP SCREW
28	FNA.41003200	INLET PIPE SEAL RING
29	FNA.42043800	INLET PIPE
30	SCB416.S	SOCKET CAP BOLT ZINC M4X16
30-1	FWM5.S	FLAT WASHER M5 SINGLE
35	FNA.42000300	INLET FILTER
58	FNA.22005400	O-RING
59	FNA.22004800	O-RING
60	FNA.43010200	SCREW
61	FNA.43009300	U-PIN
62	SCB535.S	SOCKET HEAD CAP SCREW M5x35
64	FNA.43014400	OUTLET BODY
--	FNA.43013800	OUTLET BODY (TYPE C) (NOT SHOWN)
65	FNA.22004500	O-RING

Item	Part No.	Description
66	FNA.42021700	VALVE CORE
67	FNA.43010400	VALVE CORE SPRING
68	FNA.43010100	PLUG SCREW
69	FNA.42021900	STEEL BALL COVER
70	SB-70	STEEL BALL 7.0mm
71	FNA.22004600	O-RING
72	FNA.42022000	SPILL VALVE SHELL
73	FNA.41003000	CLOSING RING
74	FNA.22004600	O-RING
75	FNA.43008200	SPILL VALVE CORE
76	FNA.22006900	PADESTAL SMALL O-RING
77	FNA.41009300	CLOSING RING
78	FNA.22003700	O-RING
79	FNA.42021800	SPILL VALVE JACKET
80	FNA.22004700	O-RING
81	FNA.43009400	CLOSING RING
82	FNA.43009700	SPILL VALVE SPRING
83	FNA.43044300	FEELER LEVER
84	FNA.43012900	CONNECTING ROD
85	SN5.S	STEEL NUT M5 ZINC DIN934 (SINGLE)
86	FNA.25000300	NUT
88	FNA.42057100	PIN
89	FNA.41003500	FEELER LEVER JACKET
90	FNA.21031800	PAD
91	FNA.43044000	ROCKER SWITCH PIN
92	FNA.43043900	VALVE CORE
93	FNA.21033200	SCREW
93-1	FNA.21009700	RD HEAD S/T SCREW M3.5 X 12 BLACK
94	FNA.33000800	MAIN SWITCH
95	FNA.22006400	RUBBER STOP
96	FNA.22006300	CAPACITOR O-RING
97	FNA.37009600	CAPACITOR 25uf 450v 50/60hz 80x45
103	FNA.42027000	SWITCH COVER
104	FNA.22006200	COVER GASKET
105	FNA.21035300	SCREW
106	FNA.21031600	PLAIN PAD
107	FNA.22006900	PADESTAL SMALL O-RING
108	FNA.42027600	SWITCH PEDESTAL
109	FNA.22007100	PEDESTAL BIG O-RING

NOTE: It is our policy to continually improve products and as such we reserve the right to alter data, specifications and component parts without prior notice.

IMPORTANT: No liability is accepted for incorrect use of product.

WARRANTY: Guarantee is 12 months from purchase date, proof of which will be required for any claim.

Sealey Group, Kempson Way, Suffolk Business Park, Bury St Edmunds, Suffolk. IP32 7AR



01284 757500



01284 703534



sales@sealey.co.uk



www.sealey.co.uk



Parts Information:
**Pressure Washer 3200psi with TSS &
 Rotablast Nozzle® 6.3ltr/Min 230V
 Model No: PC2950.V4**

Item	Part No.	Description
	PC2950.V4.K2	MOTOR ASSEMBLY
1	FNA.I10002300	MOTOR
2	FNA.43012600	CAM
3	FNA.21006500	WOBBLE PLATE SCREW (LEFT)
	PC2950.V4.K3	BEARING ASSEMBLY
4	FNA.43009800	SHEET METAL
5	FNA.23000900	ROLLER
6	FNA.43009900	HEAVY PLATE
	PC2950.V4.K4	PISTON BODY ASS'Y
9	FNA.43010500	PISTON SPRING
10	FNA.26001300	RUBBER SEAL
11	FNA.43008800	PISTON BODY
12	FNA.41003400	PISTON SEAL
13	FNA.22005200	SMALL O-RING
	PC2950.V4.K5	PISTON ASS'Y
7	FNA.43009100	PISTON SPRING SEAT
8	FNA.43010000	PISTON
	PC2950.V4.K6	PILOT SHEATH ASS'Y
14	FNA.42020800	PILOT SHEATH
15	FNA.42021200	GRAPHITE RING
16	FNA.22005100	PISTON O-RING
	PC2950.V4.K7	PUMP BODY ASS'Y
17	FNA.22004300	O-RING PILOT SHEATH
18	FNA.22004200	O-RING
19	FNA.42020900	CHECK VALVE COUPLING
25	FNA.43016800	PUMP BODY
	PC2950.V4.K8	ONE WAY VALVE ASS'Y
20	FNA.42021100	CHECK VALVE PEDESTAL
21	FNA.43010300	CHECK VALVE SPRING
22	FNA.43009200	CHECK VALVE
23	FNA.42021000	CHECK VALVE COVER
24	FNA.22004400	CHECK VALVE O-RING
	PC2950.V4.K9	INLET PIPE ASS'Y

Item	Part No.	Description
28	FNA.41003200	INLET PIPE SEAL RING
29	FNA.42043800	INLET PIPE
35	FNA.42000300	INLET FILTER
	PC2950.V4.K10	INLET CONNECTOR ASS'Y
32	FNA.22005300	WATER INLET O-RING
33	FNA.42044000	WATER INLET CONNECTION
34	FNA.41003300	WATER INLET CONNECTION FILTER PAD
	PC2950.V4.K11	OUTLET BODY ASS'Y
58	FNA.22005400	O-RING
59	FNA.22004800	O-RING
60	FNA.43010200	SCREW
61	FNA.43009300	U-PIN
64	FNA.43014400	OUTLET BODY
65	FNA.22004500	O-RING
66	FNA.42021700	VALVE CORE
67	FNA.43010400	VALVE CORE SPRING
68	FNA.43010100	PLUG SCREW
69	FNA.42021900	STEEL BALL COVER
70	SB-70	STEEL BALL 7.0mm
71	FNA.22004600	O-RING
72	FNA.42022000	SPILL VALVE SHELL
	PC2950.V4.K12	VALVE SHEATH ASS'Y
73	FNA.41003000	CLOSING RING
74	FNA.22004600	O-RING
75	FNA.43008200	SPILL VALVE CORE
76	FNA.22006900	PADESTAL SMALL O-RING
77	FNA.41009300	CLOSING RING
78	FNA.22003700	O-RING
79	FNA.42021800	SPILL VALVE JACKET
80	FNA.22004700	O-RING
81	FNA.43009400	CLOSING RING
82	FNA.43009700	SPILL VALVE SPRING
83	FNA.43044300	FEELER LEVER
84	FNA.43012900	CONNECTING ROD
85	SN5.S	STEEL NUT M5 ZINC DIN934 (SINGLE)
86	FNA.25000300	NUT

NOTE: It is our policy to continually improve products and as such we reserve the right to alter data, specifications and component parts without prior notice.

IMPORTANT: No liability is accepted for incorrect use of product.

WARRANTY: Guarantee is 12 months from purchase date, proof of which will be required for any claim.

Sealey Group, Kempson Way, Suffolk Business Park, Bury St Edmunds, Suffolk. IP32 7AR



01284 757500



01284 703534



sales@sealey.co.uk



www.sealey.co.uk



Parts Information:
Pressure Washer 3200psi with TSS & Rotablast Nozzle® 6.3ltr/Min 230V
Model No: PC2950.V4

Item	Part No.	Description
	PC2950.V4.K13	SWITCH PEDESTAL ASS'Y
88	FNA.42057100	PIN
89	FNA.41003500	FEELER LEVER JACKET
90	FNA.21031800	PAD
91	FNA.43044000	ROCKER SWITCH PIN
92	FNA.43043900	VALVE CORE
93	FNA.21033200	SCREW
93-1	FNA.21009700	RD HEAD S/T SCREW M3.5 X 12 BLACK
94	FNA.33000800	MAIN SWITCH
95	FNA.22006400	RUBBER STOP
96	FNA.22006300	CAPACITOR O-RING
97	FNA.37009600	CAPACITOR 25uf 450v 50/60hz 80x45
103	FNA.42027000	SWITCH COVER
104	FNA.22006200	COVER GASKET
105	FNA.21035300	SCREW
106	FNA.21031600	PLAIN PAD
107	FNA.22006900	PADESTAL SMALL O-RING
108	FNA.42027600	SWITCH PEDESTAL
109	FNA.22007100	PEDESTAL BIG O-RING
	PC2950.V4.K14	MICRO SWITCH ASS'Y
87	FNA.33000700	MICRO SWITCH
98	FNA.37000100	SLOT
--	FNA.37009200	SHORT STRAIGHT INSERT (NOT SHOWN)
99	FNA.37000200	SLEEVE
--	FNA.37007900	SLEEVE (NOT SHOWN)
	PC2950.V4.K15	HANDLE ASS'Y
110	FNA.41005600	HANDLE FRAME BAND
111	FNA.42027800	HANDLE SHELF
112	FNA.42027400	HANDLE
113	FNA.42027500	CABLE HOOKING
114	FNA.21011700	RD HEAD S/T SCREW M4.8 X 18 BLACK

Item	Part No.	Description
115	FNA.21011700	RD HEAD S/T SCREW M4.8 X 18 BLACK
123	PCAK05	DETERGENT BOTTLE LANCE
	PC2950.V4.K20	HOUSING ASS'Y
31	FNA.42021600	INLET COVER
36	FNA.42044500	INLET NUT
37	MSC835.SB	CSK PHILLIPS MACHINE SCREW M8x35 BLACK
38	FNA.21011700	RD HEAD S/T SCREW M4.8 X 18 BLACK
39	FNA.41005100	BACK-UP PAD
39-1	FNA.43064800	BACK PAD
40	FNA.41005200	MOTOR FOOT
41	FNA.61004100	BAFFLE
42	FNA.42027200	BACK CASE
43	FNA.42023100	CLAMPING PLATE
44	FNA.21009700	RD HEAD S/T SCREW M3.5 X 12 BLACK
48	FNA.43012700	BUCKLE
49	FNA.21011700	RD HEAD S/T SCREW M4.8 X 18 BLACK
50	FNA.41005400	FOOT
51	FNA.21035600	RD HEAD S/T SCREW M5X25 BLACK
52	FNA.42027100	FRONT CASE
53	FNA.42027700	WHEEL COVER (HUB CAP)
54	FNA.21032600	C-RING
55	FNA.42027300	WHEEL, FIXED (148x8x29)
56	FNA.43012800	WHEEL SHAFT
57	FNA.42045300	OUTLET COVER
110	FNA.41005600	HANDLE FRAME BAND
111	FNA.42027800	HANDLE SHELF
112	FNA.42027400	HANDLE
113	FNA.42027500	CABLE HOOKING
114	FNA.21011700	RD HEAD S/T SCREW M4.8 X 18 BLACK
115	FNA.21011700	RD HEAD S/T SCREW M4.8 X 18 BLACK
123	PCAK05	DETERGENT BOTTLE LANCE
--	FNA.81001700	NEEDLE PROBE (NOT SHOWN)

NOTE: It is our policy to continually improve products and as such we reserve the right to alter data, specifications and component parts without prior notice.

IMPORTANT: No liability is accepted for incorrect use of product.

WARRANTY: Guarantee is 12 months from purchase date, proof of which will be required for any claim.

Sealey Group, Kempson Way, Suffolk Business Park, Bury St Edmunds, Suffolk. IP32 7AR



01284 757500



01284 703534



sales@sealey.co.uk



www.sealey.co.uk



Parts Information:
**Pressure Washer 3200psi with TSS &
 Rotablast Nozzle® 6.3ltr/Min 230V
 Model No: PC2950.V4**

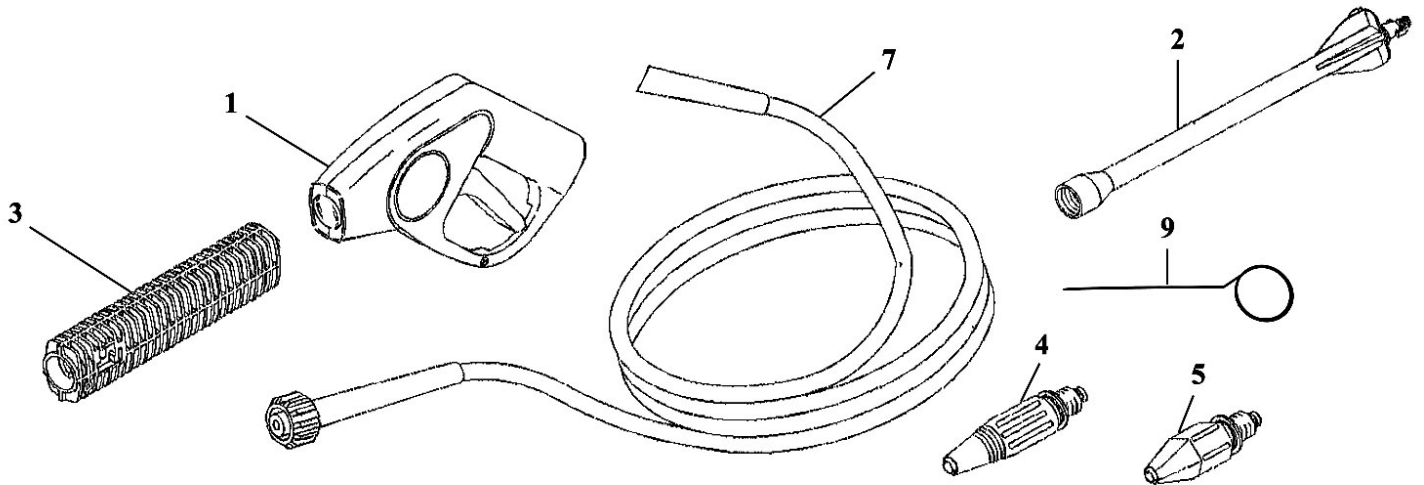

Item	Part No.	Description
		ACCESSORIES
1	FNA.10009502	GUN
2	FNA.10011200	LANCE FOR PC2950 & PC2700
3	FNA.10009400	HALF LANCE
4	PCAK04	VARIABLE SPRAY JET NOZZLE

Item	Part No.	Description
5	PCAK03	TURBO ROTABLAST NOZZLE
7	FNA.42031101	HOSE FOR PC2950.V4
9	FNA.81001700	NEEDLE PROBE
--	PC2950.SK	SEAL KIT (NOT SHOWN)

NOTE: It is our policy to continually improve products and as such we reserve the right to alter data, specifications and component parts without prior notice.

IMPORTANT: No liability is accepted for incorrect use of product.

WARRANTY: Guarantee is 12 months from purchase date, proof of which will be required for any claim.

Sealey Group, Kempson Way, Suffolk Business Park, Bury St Edmunds, Suffolk. IP32 7AR



01284 757500



01284 703534



sales@sealey.co.uk



www.sealey.co.uk