



Sole U.K. Distributor,
Sealey Group,
Bury St. Edmunds,
Suffolk.

PARTS LIST & DIAGRAM FOR:

PRESSURE WASHER

Model No: PC2950

| Item | Part No. | Description |
|------|-----------------------|------------------------|
| 1 | Part of Kits A & Q | Screw, M5 x 25 |
| 2 | Part of Kits A & Q | Foot |
| 3 | Part of Kits A, C & Q | Screw, M4.8 x 22 |
| 4 | Part of Kit A | Plate |
| 5 | Part of Kit A | Screw, M4.8 x 16 |
| 6 | Part of Kit A | Hood |
| 7 | Part of Kit P | Wheel Axle |
| 8 | Part of Kit B | Screw |
| 9 | Part of Kit B | O-Ring, 15 x 2 |
| 10 | Part of Kit B | Spring, 9.2 x 10 x 0.8 |
| 11 | Part of Kit B | Valve |
| 12 | Part of Kit B | O-Ring, 5 x 2 |
| 13 | Part of Kit P | Wheel |
| 14 | Part of Kit P | Circlip |
| 15 | Part of Kit P | Hub Cap |
| 16 | Part of Kit B | Manifold |
| 17 | Part of Kit B | Plug |
| 18 | Part of Kit B | Cap |
| 19 | Part of Kit B | Ball |
| 20 | Part of Kit B | Spring |
| 21 | Part of Kit B | O-Ring, 9.25 x 1.78 |
| 22 | Part of Kit B | Valve Seat |
| 23 | Part of Kit B | Anti-Extr. Ring |
| 24 | Part of Kits B & E | O-Ring, 8.73 x 1.78 |
| 25 | Part of Kit B | Small Piston Bypass |
| 26 | Part of Kit B | O-Ring, 4.48 x 1.78 |
| 27 | Part of Kit B | Anti-Extr. Ring |
| 28 | Part of Kit G | Oil Seal |
| 29 | Part of Kit G | Packing Retain |
| 30 | Part of Kit G | O-Ring, 23.52 x 1.78 |
| 31 | Part of Kit G | O-Ring, 11.11 x 1.78 |
| 32 | Part of Kit E | Packing |
| 33 | Part of Kit O | O-Ring, 12 x 2 |
| 34 | Part of Kit D & O | Valve Unit |
| 35 | Part of Kit B | O-Ring, 15 x 2 |
| 36 | Part of Kit D | Valve Guide |
| 37 | Part of Kit D | Spring |
| 38 | Part of Kit D | Cap |
| 39 | Part of Kit D | Valve Seat |
| 40 | Part of Kit D | O-Ring, 12.42 x 1.78 |
| 41 | Part of Kit E | Pump Head |
| 42 | Part of Kit E | Screw, M6 x 35 |
| 43 | Part of Kit F | Socket |
| 44 | Part of Kit F | Gasket |
| 45 | PC2950/45 | Screw |
| 46 | Part of Kit G | Screw, M6 x 30 |
| 47 | Part of Kit G | Crank Case |
| 48 | Part of Kit G | Connector |
| 49 | Part of Kit G | Washer |
| 50 | Part of Kit G | Cap |
| 51 | Part of Kit G | Oil Cap |
| 52 | Part of Kit G | Spring |
| 53 | Part of Kit G | Piston |
| 54 | Part of Kit G | Retainer Ring |
| 55 | Part of Kit L | Screw, M6 x 22 |
| 56 | PC2950/56 | Support |
| 57 | Part of Kit L | Washer, M4 |
| 58 | Part of Kit L | Ball Bearing |
| 59 | PC2950/08 | Clamp |
| 60 | Part of Kit A | Rubber |

| Item | Part No. | Description |
|------|----------------------|----------------------|
| 61 | Part of Kit A | Bush |
| 62 | Part of Kit A | Frame |
| 63 | Part of Kit A & Q | Screw, M5 x 20 |
| 64 | Part of Kit A | Screw, M8 x 35 |
| 65 | Part of Kit A, C & Q | Hose Reel |
| 66 | Part of Kit A | Lock Nut, 3/4 |
| 67 | Part of Kit A | Separator |
| 68 | Part of Kit B | Nipple |
| 69 | Part of Kit N | Fair Lead |
| 70 | Part of Kit Q | Handle |
| 71 | Part of Kit Q | Support |
| 72 | Part of Kit Q | Elastic Strap |
| 74 | Part of Kit N | Cable |
| 75 | Part of Kit M | Conveyor |
| 76 | Part of Kit M | Screw |
| 77 | Part of Kit M | Washer |
| 78 | Part of Kit M | Motor Fan |
| 79 | Part of Kit L | Stator, 230/50 |
| 80 | Part of Kit L | Rotor |
| 81 | Part of Kit L | Screw, M4 x 12 |
| 82 | Part of Kit L | Cable |
| 83 | Part of Kit L | Shield |
| 84 | Part of Kit L | Packing |
| 85 | Part of Kit L | Ball Bearing |
| 86 | Part of Kit L | Cap |
| 87 | Part of Kit H | Flange |
| 88 | Part of Kit H | Roller Bearing |
| 89 | Part of Kit H | Flange |
| 90 | Part of Kit G | O-Ring, 80.6 x 2.62 |
| 91 | Part of Kit B | Screw |
| 92 | Part of Kit B | O-Ring, 12.42 x 1.78 |
| 93 | Part of Kit B | O-Ring, 14.00 x 1.78 |
| 94 | Part of Kit B | Valve Body By-pass |
| 95 | Part of Kit B | Spacer |
| 96 | Part of Kit B | Spring |
| 97 | Part of Kit B | Blade |
| 98 | Part of Kit B | Screw, M5 x 16 |
| 99 | Part of Kit B | Nut |
| 100 | Part of Kit B | Nut |
| 101 | Part of Kit I | O-Ring |
| 102 | Part of Kit I | Label |
| 103 | Part of Kit I | Control Box |
| 104 | Part of Kit I | O-Ring 5.28 x 1.78 |
| 105 | Part of Kit I | Microswitch |
| 106 | Part of Kit I | Joint |
| 107 | Part of Kit I | Washer |
| 108 | Part of Kit I | Screw, M5 x 20 |
| 109 | Part of Kit I | Box Cover |
| 110 | Part of Kit I | Switch |
| 111 | Part of Kit I | Gasket |

| Item | Part No. | Description | Item | Part No. | Description |
|------|---------------|---------------------|------|---------------|------------------|
| 112 | Part of Kit I | O-Ring 37.82 x 1.78 | 119 | Part of Kit I | Bushing |
| 113 | Part of Kit I | Capacitor | 120 | Part of Kit I | Screw, M3.9 x 16 |
| 114 | Part of Kit I | Protector | 121 | Part of Kit I | Screw |
| 115 | Part of Kit I | Faston Cover | 125 | Part of Kit B | O-Ring |
| 116 | Part of Kit I | Gludgeon | 129 | Part of Kit I | Fair Lead |
| 117 | Part of Kit I | Washer | 130 | Part of Kit I | Cable |
| 118 | Part of Kit I | Trigger | | | |

| Kit Part No. | Description | Contents |
|--------------|--------------------|---|
| PC2950/KIT A | Cover Kit | 1, 2, 3, 4, 5, 6, 60, 61, 62, 63, 64, 65, 66 & 67 |
| PC2950/KIT B | Manifold Kit | 8, 9, 10, 11, 12, 16, 17, 18, 19, 20, 21, 22, 23, 24, 25, 26, 27, 35, 68, 91, 92, 93, 94, 95, 96, 97, 98, 99, 100 & 125 |
| PC2950/KIT C | Cable Support Kit | 3 & 65 |
| PC2950/KIT D | Small Valve Kit | 34, 36, 37, 38, 39, & 40 |
| PC2950/KIT E | Head Kit | 24, 32, 41 & 42 |
| PC2950/KIT F | Quick Socket Kit | 43 & 44 |
| PC2950/KIT G | Crankcase Kit | 28, 29, 30, 31, 46, 47, 48, 49, 50, 51, 52, 53, 54 & 90 |
| PC2950/KIT H | Roller Bearing Kit | 87, 88 & 89 |
| PC2950/KIT I | Control Board Kit | 101, 102, 103, 104, 105, 106, 107, 108, 109, 110, 111, 112, 113, 114, 115, 116, 117, 118, 119, 120, 121, 129 & 130 |
| PC2950/KIT L | Motor Kit | 55, 57, 58, 79, 80, 81, 82, 83, 84, 85 & 86 |
| PC2950/KIT M | Conveyor Kit | 75, 76, 77 & 78 |
| PC2950/KIT N | Cable Kit | 69 & 74 |
| PC2950/KIT O | Small Valve Kit | 33 & 34 |
| PC2950/KIT P | Wheel Kit | 7, 13, 14 & 15 |
| PC2950/KIT Q | Handle Kit | 1, 2, 3, 63, 65, 70, 71 & 72 |

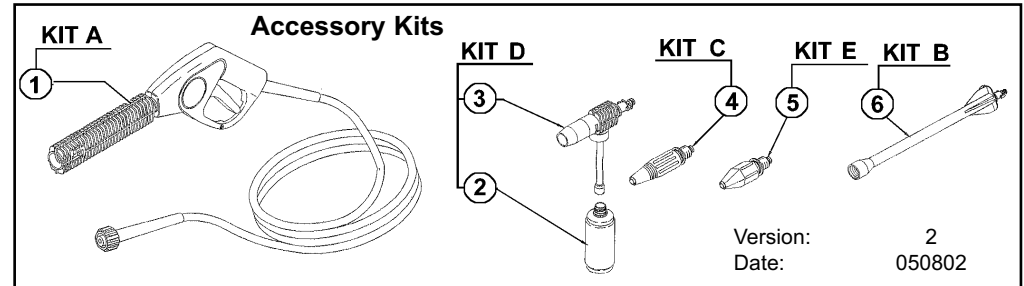

| Kit Part No. | Description | Contents |
|--------------|-----------------|-------------------|
| PC2950/120 | Accessory Kit A | Gun with Hose |
| PC2950/121B | Accessory Kit B | Extension Lance |
| PC2950/129 | Accessory Kit C | Fan Nozzle |
| PC2950/AK-D | Accessory Kit D | Nozzle and Bottle |
| PC2950/121A | Accessory Kit E | Rotary Nozzle |