

Parts Information:  
**Panel Stand - Door, Wing, Bonnet & Bumper**  
**Model No: MK51.V2**

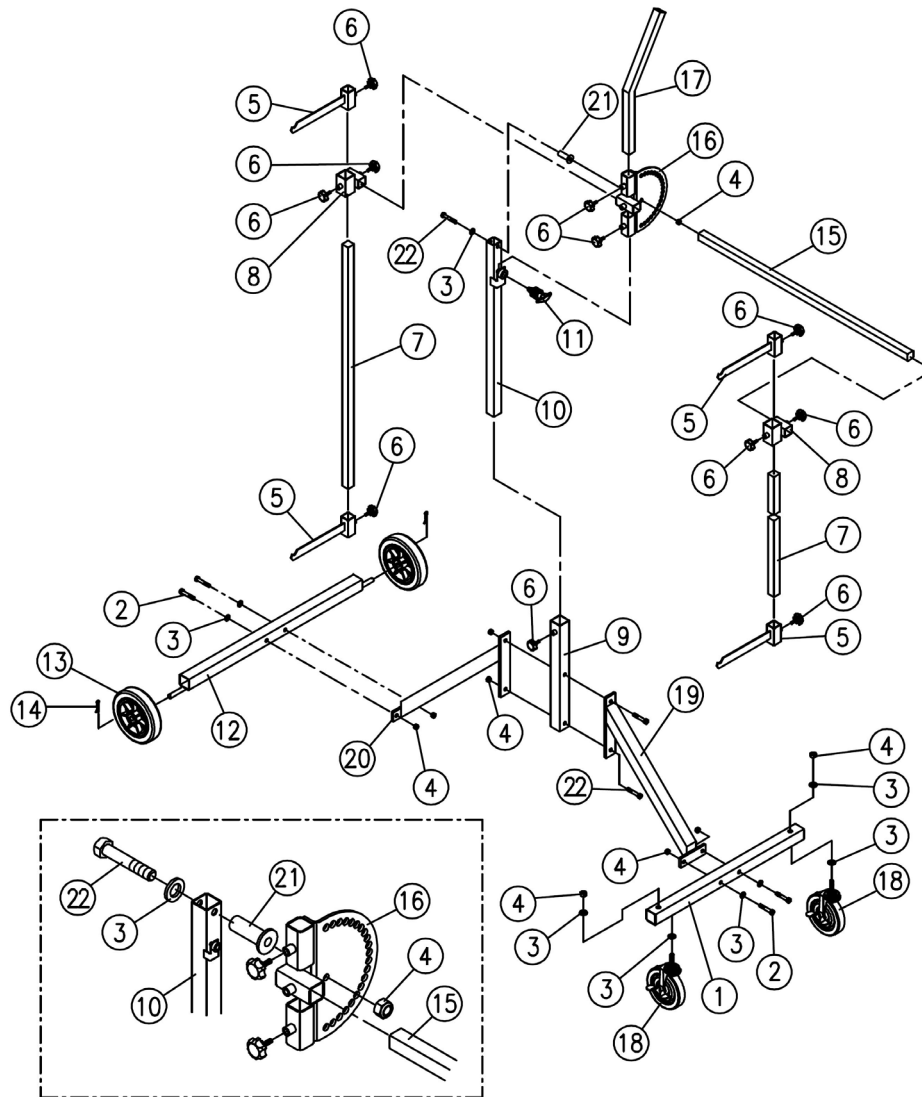

Item	Part No.	Description
1	MK51.V2-01	SIDE LEG (BASE TUBE)
2	MK51.V2-02	SCREW
3	MK51.V2-03	WASHER
4	MK51.V2-04	LOCK NUT
5	MK51.V2-05	SUPPORT FOR UPRIGHT (SET TUBE)
6	MK51.V2-06	KNOB
7	MK51.V2-07	UPRIGHT FRAME,SIDE (ERECT TUBE)
8	MK51.V2-08	SUPPORT FOR UPRIGHT (SET TUBE)
9	MK51.V2-09	UPRIGHT FRAME SUPPORT (BOTTOM ERECT TUBE)
10	MK51.V2-10	UPRIGHT FRAME (TOP ERECT TUBE)
11	MK51.V2-11	LOCK PIN
12	MK51.V2-12	SIDE LEG (BASE TUBE)

Item	Part No.	Description
13	MK51.V2-13	WHEEL, FIXED (175x13x37)
14	MK51.V2-14	SNAP RING
15	MK51.V2-15	EXTENSION FRAME (CROSS TUBE)
16	MK51.V2-16	ADJUSTABLE ANGLE BRACKET (ANGULAR DISC)
17	MK51.V2-17	EXTENSION FRAME
18	MK51.V2-18	WHEEL, CASTOR (W/BRAKE)(125x7x25x146)
19	MK51.V2-19	BASE SUPPORT (OBLIGUE TUBE)
20	MK51.V2-20	BASE SUPPORT (OBLIGUE TUBE)
21	MK51.V2-21	BUSHING
22	MK51.V2-22	SCREW (3/8x2-1/2")
--	MK51.V2-S	SPANNER (NOT SHOWN)

**NOTE:** It is our policy to continually improve products and as such we reserve the right to alter data, specifications and component parts without prior notice.

**IMPORTANT:** No liability is accepted for incorrect use of product.

**WARRANTY:** Guarantee is 12 months from purchase date, proof of which will be required for any claim.