

SEALEY

Quality MACHINERY

PARTS LIST FOR: FORKLIFT/TRACTOR JACK

Model: FJ40

Issue No: 1
Date Issued: 190302

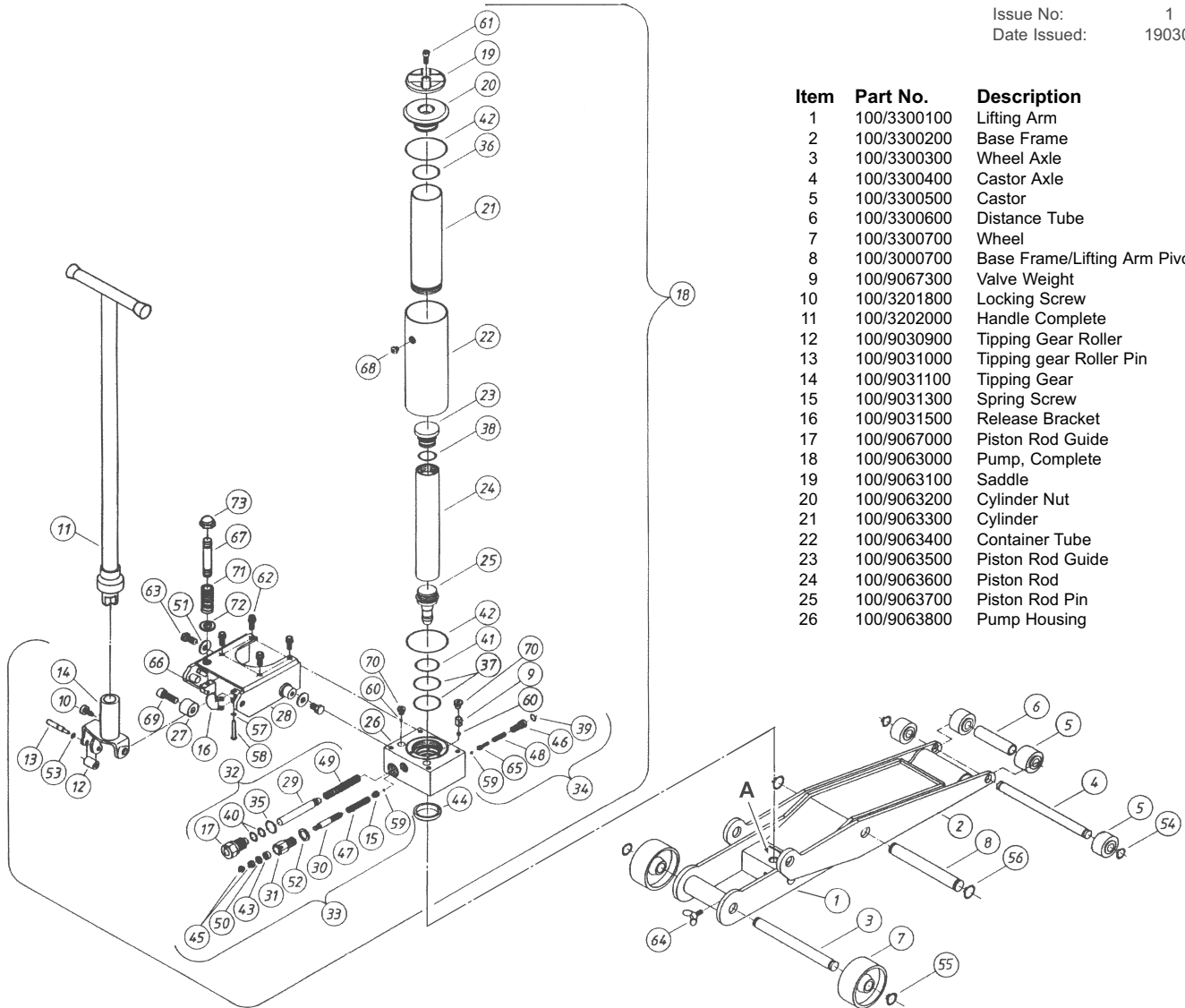

Item	Part No.	Description
1	100/3300100	Lifting Arm
2	100/3300200	Base Frame
3	100/3300300	Wheel Axle
4	100/3300400	Castor Axle
5	100/3300500	Castor
6	100/3300600	Distance Tube
7	100/3300700	Wheel
8	100/3000700	Base Frame/Lifting Arm Pivot
9	100/9067300	Valve Weight
10	100/3201800	Locking Screw
11	100/3202000	Handle Complete
12	100/9030900	Tipping Gear Roller
13	100/9031000	Tipping gear Roller Pin
14	100/9031100	Tipping Gear
15	100/9031300	Spring Screw
16	100/9031500	Release Bracket
17	100/9067000	Piston Rod Guide
18	100/9063000	Pump, Complete
19	100/9063100	Saddle
20	100/9063200	Cylinder Nut
21	100/9063300	Cylinder
22	100/9063400	Container Tube
23	100/9063500	Piston Rod Guide
24	100/9063600	Piston Rod
25	100/9063700	Piston Rod Pin
26	100/9063800	Pump Housing

Item	Part No.	Description	Item	Part No.	Description	Item	Part No.	Description
27	100/9063900	Tipping Gear Sleeve	44 *	100/01270	Scraper Ring	61	100/02306	Screw
28	100/9064000	Tipping Gear Housing	45	100/02014	Nut	62	100/02320	Screw
29	100/9067100	Pump Piston	46	100/02025	Screw	63	100/02328	Screw
30	100/9064200	Release Shaft	47	100/02032	Spring	64	100/02336	Wing Screw
31	100/9064300	Release Cover	48	100/02038	Spring	65	100/02340	Screw
32	100/9067200	Pump Piston, Complete	49	100/020390	Spring	66	100/9064700	Stop Block
33	100/9064500	Release Shaft, Complete	50	100/02115	Washer	67	100/9064800	Axle
34	100/9064600	Safety Valve	51	100/02118	Washer	68	100/02448	Filler Plug
35 *	100/01004	O-ring	52 *	100/02124	Copper Washer	69	100/02482	Bolt
36 *	100/01019	O-ring	53	100/02202	Circlip	70	100/02483	Valve Plug
37 *	100/01024	O-ring	54	100/02204	Circlip	71	100/9064900	Lock Spring
38 *	100/01037	O-ring	55	100/02205	Circlip	72	100/0211600	Washer
39 *	100/0204000	O-ring	56	100/02206	Circlip	73	100/0249700	Nut
40 *	100/0103200	O-ring	57	100/02223	Locking Washer	-	FJ40/RK	Repair Kit
41 *	100/01075	O-ring	58	100/02229	Rivet			
42 *	100/01076	O-ring	59 *	100/02290	Ball, 4.5mm			
43 *	100/01151	Seal	60 *	100/02292	Ball, 6.5mm			

* Items marked with an asterisk are part of the repair kit.

SEALEY

Quality MACHINERY

Sole U.K. Distributor,
Sealey Group,
Bury St. Edmunds, Suffolk.

☎ 01284 757500

✉ 01284 703534 E-mail: sales@sealey.co.uk