

Parts Information:
Modular Floor Cabinet 2 Door Full Height 915mm
Model No: APMS56

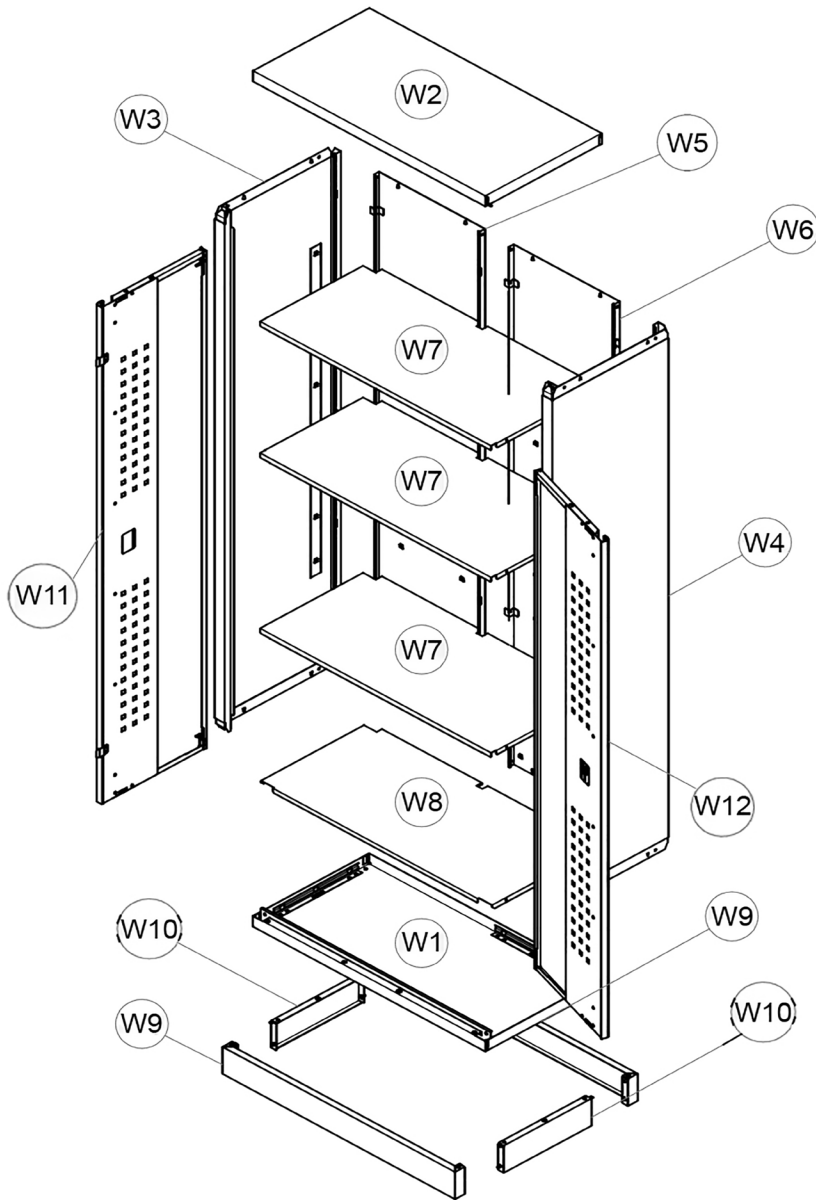

Item	Part No.	Description
W1	APMS56.W1	Bottom Panel
W2	APMS56.W2	Top Panel
W3	APMS56.W3	Side Panel, Left
W4	APMS56.W4	Side Panel, Right
W5	APMS56.W5	Rear Panel, Left
W6	APMS56.W6	Rear Panel, Right
W7	APMS56.W7	Adjustable Shelf 910 x 435 x 20mm
W8	APMS56.W8	Bottom Shelf 910 x 435 x 20mm
W9	APMS56.W9	Base Front Panel
W10	APMS56.W10	Base Side Panel

Item	Part No.	Description
W11	APMS56.W11	Door, Left
W12	APMS56.W12	Door, Right
--	APMS57.01	Door Latch (Not Shown)
--	APMS56.02	Door Pull 1812mm (Not Shown)
--	APMS56.03	Lock & Key (Not Shown)
--	APMS56.04	Door Magnet (Not Shown)
--	APMS56.05	Door Hinge (Not Shown)
--	APMS55.FK	Fixing Kit (Not Shown)
--	AP-BADGE1	Superline Pro Badge 111 x 25mm (Not Shown)
--	AP-BADGE2	Sealey Badge 70 x 25mm (Not Shown)

NOTE: It is our policy to continually improve products and as such we reserve the right to alter data, specifications and component parts without prior notice. There may be alternative versions of this product, please contact us should you require this information.

IMPORTANT: No liability is accepted for incorrect use of product. Spare parts must be fitted by a competent person

WARRANTY: Guarantee is 12 months from purchase date, proof of which will be required for any claim.