



ELECTRIC WHEELBARROW 150KG CAPACITY

MODEL NO: **WBR150E**

Thank you for purchasing a Sealey product. Manufactured to a high standard, this product will, if used according to these instructions, and properly maintained, give you years of trouble free performance.

IMPORTANT: PLEASE READ THESE INSTRUCTIONS CAREFULLY. NOTE THE SAFE OPERATIONAL REQUIREMENTS, WARNINGS & CAUTIONS. USE THE PRODUCT CORRECTLY AND WITH CARE FOR THE PURPOSE FOR WHICH IT IS INTENDED. FAILURE TO DO SO MAY CAUSE DAMAGE AND/OR PERSONAL INJURY AND WILL INVALIDATE THE WARRANTY. KEEP THESE INSTRUCTIONS SAFE FOR FUTURE USE.

Warning!

Refer to
instruction
manual

Warning! Wear
protective
gloves

Wear eye
protection

Wear safety
footwear



Charger:
Indoor use only

Corrosive
(battery acid)

Explosive gas

Keep a safe
distance from
the wheel

DO NOT use in
the rain.
Protect from
splashing

No smoking, no
naked flames,
no sparks

1. SAFETY

1.1. GENERAL POWER TOOL SAFETY WARNINGS

- ☐ **WARNING!** Read all safety warnings, instructions, illustrations and specifications provided with this power tool. Failure to follow all instructions listed below may result in electric shock, fire and/or serious injury.
- ✓ Save all warning and instructions for future reference.

1.1.1. WORK AREA SAFETY

- ☐ **WARNING!** Read all safety warnings, instructions, illustrations and specifications provided with this power tool. Save all warning and instructions for future reference.

1.1.2. ELECTRICAL SAFETY: CHARGER

- ☐ **WARNING!** It is the user's responsibility to check the following:
 - ✓ Check all electrical equipment and appliances to ensure that they are safe before using.
 - ✓ Inspect power supply leads, plugs and all electrical connections for wear and damage.
 - ✓ Ensure that the insulation on all cables and on the appliance is safe before connecting it to the power supply.
 - ✗ **DO NOT** use worn or damaged cables, plugs or connectors. **DO NOT** abuse the cord. Never use the cord for carrying, pulling, or unplugging the power tool. Keep cord away from the heat, oil, sharp edges or moving parts. Damaged or entangled cords increase the risk of electric shock.
 - ✓ Ensure that any faulty item is repaired or replaced immediately by a Sealey qualified technician.
 - ✓ If the cable or plug is damaged during use, switch off the electricity supply and remove from use.
 - ✓ Sealey recommend that an RCD (Residual Current Device) is used with all electrical products.
- Important:** Ensure that the voltage rating on the appliance suits the mains power supply.
- ✗ **DO NOT** pull or carry the appliance by the power cable.
- ✗ **DO NOT** pull the plug from the socket by the cable.
- ✓ Power tool plugs must match the outlet. Never modify the plug in any way. Do not use any adaptor plugs with earthed (grounded) power tools. Unmodified plugs and matching outlets will reduce risk of electric shock.
- ✓ Avoid body contact with earthed or grounded surfaces, such as pipes, radiators, ranges and refrigerators. There is an increased risk of electric shock if your body is earthed or grounded.
- ✗ **DO NOT** expose power tools to rain or wet conditions. Water entering a power tool will increase the risk of electric shock.
- ✓ If operating a power tool in a damp location is unavoidable, use a residual current device (RCD) protected supply. Use of an RCD reduces the risk of electric shock.
- ✓ The charger is designed exclusively to charge the battery of this machine. Charging other batteries is not permitted.
- ✓ Never use the charger in a damp or wet environment
- ✓ Disconnect cable connections only by pulling the plug. Pulling on the cable could damage the cable and plug and electrical safety would no longer be guaranteed.
- ✓ Never use the charger if the cord, plug or the appliance itself is damaged by external influences.
- ✗ **DO NOT** use the unit near heat sources.
- ✗ **DO NOT** use extension cord to supply power to charger.
- ✗ **DO NOT** place metal objects in the area of the charging contacts of the charger.
- ✗ **DO NOT** open the charger. In case of failure, contact an electrician.
- ✓ Use to recharge your battery only with the original charger. Use of other chargers defects may occur or fire hazard.

1.1.3. BATTERY SAFETY

- ✓ Under abusive conditions, liquid may be ejected from the battery; avoid contact. If contact accidentally occurs, flush with water.

Seek medical help. Liquid ejected from the battery may cause irritation or burns.

- ✗ **DO NOT** use a battery pack or tool that is damaged or modified. Damaged or modified batteries may exhibit unpredictable behaviour resulting in fire, explosion or risk of injury.
- ✗ **DO NOT** expose a battery or tool to fire or excessive temperature. Exposure to fire or temperature above 130°C may cause explosion.
- ✓ Follow all charging instructions and do not charge the battery or tool outside the temperature range specified in the instructions. Charging improperly or at temperatures outside the specified range may damage the battery and increase the risk of fire.
- ✓ **FIRE HAZARD!** Never charge batteries near acids and flammable materials.
- ✓ Charge the battery only in an ambient temperature between 0°C to +40°C.
- ✓ Leave to cool down after heavy load.
- EXPLOSIVE!** Protect the battery from heat and fire. Use the battery only in an ambient temperature between 0°C to +45 °C.
- SHORT CIRCUIT!** For disposal, transport or storage, the battery must be wrapped (plastic bag, box) or the contacts must be taped.
- ✗ Never open the battery.
- ✓ Irrespective of all safety regulations, your common sense and your corresponding technical suitability/training are and will remain the most important safety factor for error-free operation of the machine. Safe working depends first and foremost on the end user.

1.2. PERSONAL SAFETY

- ✓ Stay alert, watch what you are doing and use common sense when operating a power tool.
- ✗ **DO NOT** use a power tool whilst you are tired or under the influence of drugs, alcohol, or medication. A moment inattention whilst operating power tools may result in serious injury.
- ✓ Use personal protective equipment. Always wear eye protection. Protective equipment such as dust mask, non-skid safety shoes, hard hat or hearing protection use for appropriate conditions will reduce personal injuries.
- ✓ Prevent unintentional starting. Ensure the switch is in the off position before connecting to power source, moving, picking up or carrying the tool.
- ✗ **DO NOT** overreach. Keep proper footing and balance at all times. This enables better control of the power tool in unexpected situations.
- ✓ Dress properly. Do not wear loose clothing or jewellery. Keep your hair and clothing away from moving parts. Loose clothes, jewellery or long hair can be caught in moving parts.
- ✗ **DO NOT** let familiarity from frequent use of tools allow you to become complacent and ignore tool safety principles. A careless action can cause severe injury within a fraction of a second.

1.3. POWER TOOL USE AND CARE

- ✗ **DO NOT** force the power tool. Use the correct power tool for your application. The correct power tool will do the job better and safer at the rate for which it was designed.
- ✗ **DO NOT** use the power tool if the switch does not turn it on and off. Any power tool that cannot be controlled with the switch is dangerous and must be repaired.
- ✓ Turn off the power tool before making any adjustments, changing accessories, or storing power tools. Such preventive safety measures reduce the risk of starting the power tool accidentally.
- ✓ Store idle power tools out of the reach of children and do not allow persons unfamiliar with these power tools or these instructions to operate the power tool. Power tools are dangerous in the hands of untrained users.
- ✓ Maintain power tools and accessories. Check for misalignment or binding of the moving parts, breakage of parts and any other condition that may affect the power tool's operation. If damages, have the power tool repaired before use. Many accidents are caused by poorly maintained power tools.
- ✓ Use the power tool, accessories and tool bits etc, in accordance with these instructions, taking into account the working conditions and the work to be performed. Use of the power tool for operations different from those intended could result in a hazardous situation.
- ✓ Keep handles and grasping surfaces dry, clean and free from oil and grease. Slippery handles and grasping surfaces do not allow for safe handling and control of the tool in unexpected situation.

1.4. SERVICE

- ✓ Have your power tool serviced by a qualified repair person using only identical replacement parts. This will ensure that the safety of the power tool is maintained. Never service a damaged battery. Service of batteries should only be performed by the manufacturer or authorised service providers.

1.5. SPECIFIC ELECTRIC WHEELBARROW SAFETY

1.5.1. INTENDED USE

- ✓ The machine must only be used for its intended purpose! Any other use is deemed to be a case of misuse.
- ✓ To use the machine properly you must also observe and follow all safety regulations, the assembly instructions, operating and maintenance instructions lay down in this manual.
- All people who use and service the machine have to be acquainted with this manual and must be informed about the machine's potential hazards.
- ✓ The machine is used for: Transportation of goods within the maximum permissible load capacity.
- ✓ Any manipulation of the machine or its parts is a misuse. The removal or modification of the safety components may result in damage to equipment and serious injury!

1.5.2. AMBIENT CONDITIONS

The machine may be operated:
humidity max. 70% Temperature +5°C to +40°C (+41°F to +104°F) The machine, especially the battery; MUST not be exposed to a temperature of about 80° C.

- ✗ **DO NOT** store in the blazing sun or a long time in the boot of a car.

1.5.3. PROHIBITED USE

- ✓ The operation of the machine outside the stated technical limits described in this manual is forbidden.
- ✓ The operation of the machine without provided protective devices is prohibited.
- ✓ The use of the machine not according with the required specifications in this manual is forbidden.
- ✓ Any manipulation of the machine and parts is forbidden.
- ✓ The use of the machine for any purposes other than described in this user manual is forbidden.
- ✓ It is not allowed to leave the immediate work area during the work is being performed.

1.5.4. GENERAL SAFETY RULES

- ✓ Use the machine only in good enough light to allow a safe operation can be guaranteed.
- ✓ Caution in slippery conditions - slip hazard - risk of injury. When working, robust and nonslip footwear. Slides / stumble / trips are a major cause of serious injury or death.
- ✓ The machine must be operated only by trained persons (knowledge and understanding of this manual), which have no limitations of motor skills compared with conventional workers.
- ✓ Use both hands
- ✓ Unauthorized persons, especially children and not trained personnel must be kept away from the running machine!
- ✓ Before use, after any failure or shock, be sure to check the device and make sure that it is in good condition
- ✓ Take special care when working near swimming pools or garden ponds.
- ✓ Never use the machine when it is raining or in damp, wet areas

2. INTRODUCTION

Ideal for transporting loads across rugged terrain, such as construction sites, farms and garden landscaping. Stable and balanced due to motor and battery positioning.

3. SPECIFICATION

Model No:	WBR150E
Weight:.....	34.2kg
Voltage:.....	24V DC
Power Output:.....	500W
Maximum Weight Capacity:.....	150kg
Bucket Capacity:.....	75L
Maximum Speed:.....	7kmh
Maximum Operating Time (Per Charge:.....	8hr
Full Charge Time:.....	4.5hr

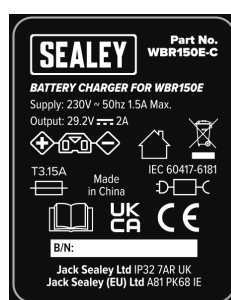

Charger Specification



4. FEATURES/CONTENTS

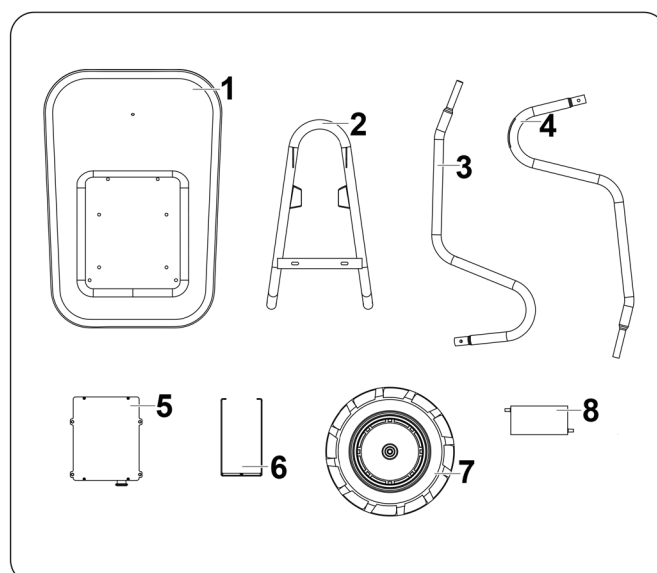
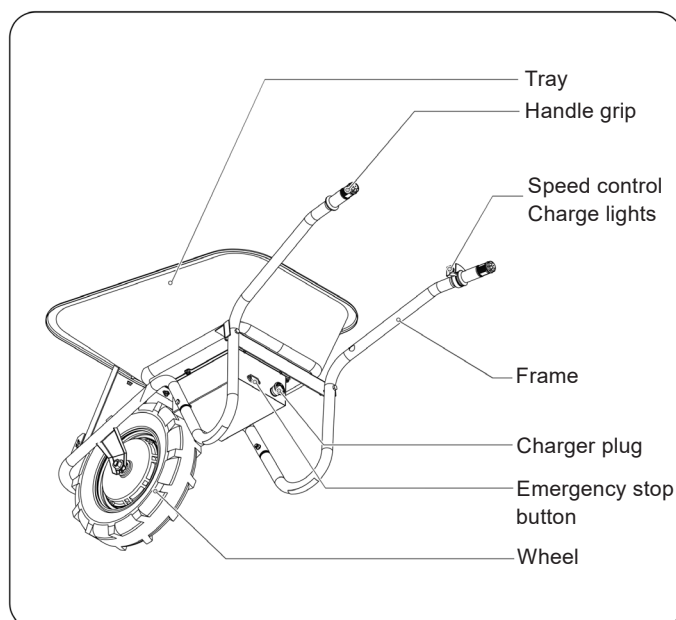

- | | |
|-----------------|------------------|
| 1. Tray | 2. Frame |
| 3. Right handle | 4. Left handle |
| 5. Battery box | 6. Front support |
| 7. Motor wheel | 8. Charger |

5. ASSEMBLY

Refer to attached Parts Information.

STEP:1 FRAME ASSEMBLY

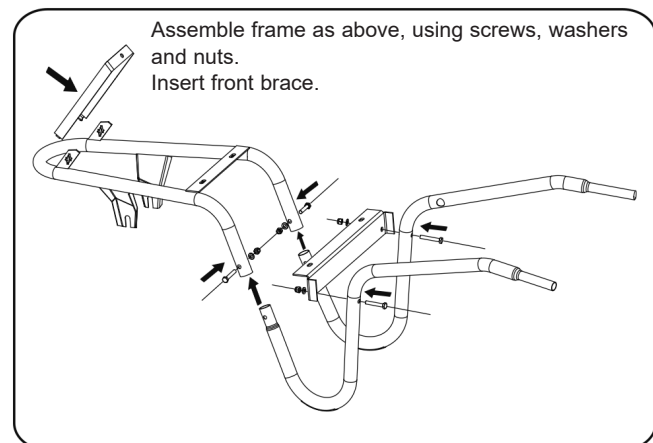

M8x45



M8x50

STEP:3 BATTERY BOX ASSEMBLY

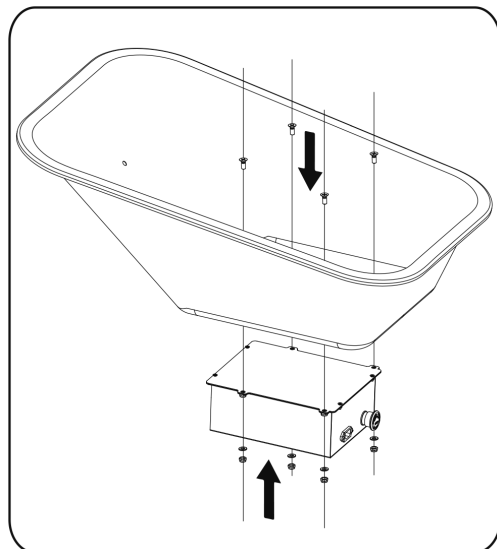

Connect the battery box onto the tray, use 4 x screws, nut and 2 x washers.

STEP: 2 WHEEL

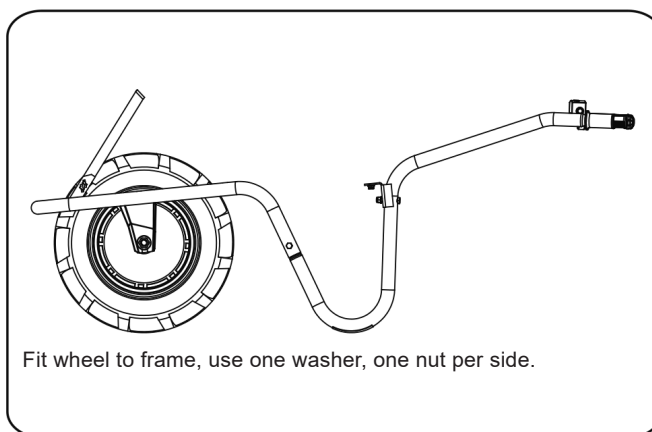

STEP:4 FIT TRAY TO FRAME

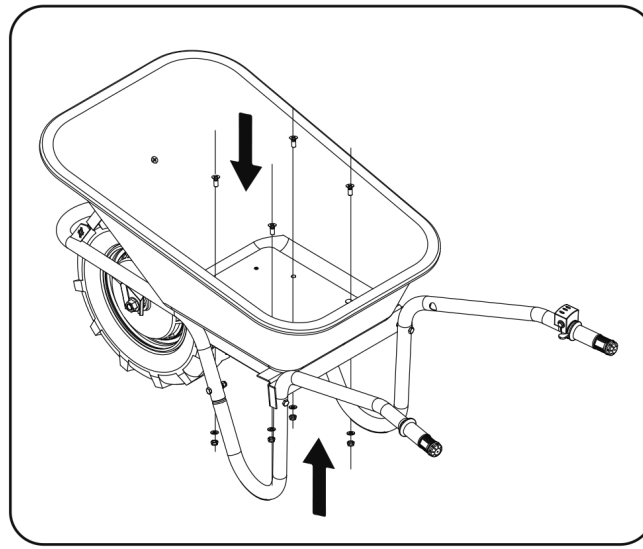

Connect tray to frame with 5 x screws, nuts and washers, onto the frame.

STEP: 5 CABLES



Plug in cables: From left to right 6 pin 3 pin 5 pin.
Cables need to be cable tied to the frame, in such a way to protect wiring when barrow is being used.

6. OPERATION

- 6.1. Wheelbarrow **MUST** only be used in perfect working order. Inspect wheelbarrow every time it is to be used.
- Check:**
Safety equipment, electrical controls, electric cables and structural fixings for damage and that they are correctly fastened.
Replace/repair any damage before use.
- 6.2. **CHARGING**
- 6.2.1. Battery is fixed into the battery box.
- 6.2.2. Only use the wheelbarrow when the battery is sufficiently charged.
- 6.2.3. Connect charger lead into the charger plug beside the emergency stop button. Connect charger to mains supply.
- 6.2.4. Charge status is indicated by the lights on the right hand handle when the charger is connected: All 3 led: 100-51%, Red & orange: 50-10%, Red led only: Charge battery
- 6.3. **OPERATION**
Turn emergency stop button clockwise to unlock.

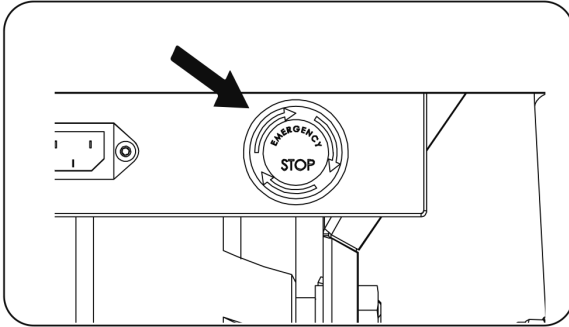

Press RED button:

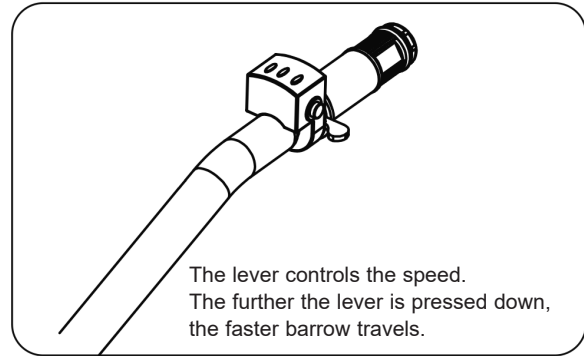
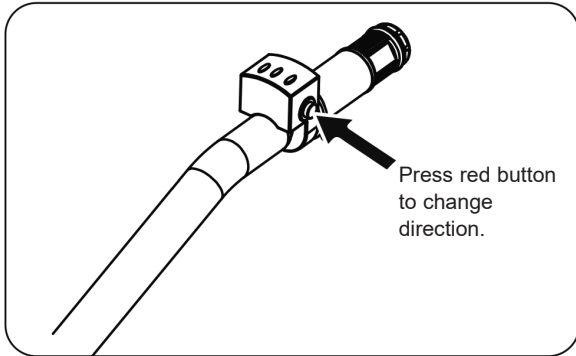

- 6.4. **LIFTING AND TRANSPORTATION**
- 6.4.1. Wheelbarrow is heavy with a relatively high centre of gravity. Seek the assistance of another person or use a ramp to unload from the back of a vehicle.
- 6.4.2. Wheelbarrow must be transported in a secure way to prevent transit damage. Ensure it is correctly secured in a vehicle to prevent damage from falling onto its side during transportation.

7. MAINTENANCE

- ☐ **WARNING!** Press emergency stop button to prevent unintentional starting before performing maintenance or making adjustments.
- 7.1. Wheelbarrow does not require extensive Maintenance. If malfunction or defects occur wheelbarrow must be repaired by trained personnel only.
- 7.2. Regularly check the condition of the wheelbarrow.
- 7.3. Check the condition of the warning stickers. Replace if damaged.
- 7.4. **MAINTENANCE PLAN:**
- 7.4.1. Check cables for damage and that they are still secured to the structure of the wheelbarrow.
- 7.4.2. **CLEANING:** Avoid the use of solutions containing ingredients damaging to metal surfaces (solvents) as well as the use of abrasive agents, as these will damage the painted surfaces.
Clean the machine surface with a wet cloth soaked in a mild solution. Never use running water or a high pressure cleaner to clean the wheelbarrow. Clean the outer parts with a damp sponge. Never clean the electronic parts with water!
Check the machine and remove the deposits and / or residues with a brush.
- 7.5. **STORAGE**
- 7.5.1. Store the machine in a closed, dry location.
- 7.5.2. If the wheelbarrow is not going to be used for at least a month: charge the battery.

8. END OF LIFE

- 8.1. Dismantle product, (perform reverse of Assembly section). Battery must be recycled. Remove battery box, remove the battery cables and cover the terminal posts with insulation tape for transport to Recycle Centre.
- 8.2. Contact local authority for information regarding safe disposal of battery.

9. TROUBLESHOOTING

❑ **WARNING!** Disable battery before Troubleshooting.

Problem	Cause	Solution
No electrical assistance	Battery not charged	Recharge battery
	Motor stuck	Check motor
	Power switch damaged	Check switch
	Broken or loose cables	Check cables
Battery will not charge	Loose battery cable	Check cable connection



WEEE REGULATIONS

Dispose of this product at the end of its working life in compliance with the EU Directive on Waste Electrical and Electronic Equipment (WEEE). When the product is no longer required, it must be disposed of in an environmentally protective way. Contact your local solid waste authority for recycling information.



ENVIRONMENT PROTECTION

Recycle unwanted materials instead of disposing of them as waste. All tools, accessories and packaging should be sorted, taken to a recycling centre and disposed of in a manner which is compatible with the environment. When the product becomes completely unserviceable and requires disposal, drain any fluids (if applicable) into approved containers and dispose of the product and fluids according to local regulations.

Note: It is our policy to continually improve products and as such we reserve the right to alter data, specifications and component parts without prior notice.

Important: No Liability is accepted for incorrect use of this product.

Warranty: Guarantee is 12 months from purchase date, proof of which is required for any claim.



REGISTER YOUR
PURCHASE HERE

Jack Sealey Ltd t/a Sealey Group, Kempson Way, Suffolk Business Park, Bury St Edmunds, Suffolk, IP32 7AR UK
Jack Sealey (EU) Ltd t/a Sealey Group, Farney Street, Carrickmacross, Co. Monaghan, A81 PK68 Ireland
Tel: 01284 757500 • **Email:** sales@sealey.co.uk • **Web:** www.sealey.co.uk