

Thank you for purchasing a Sealey Product. Manufactured to a high standard this product will, if used according to these instructions and properly maintained, give you years of trouble free performance.



IMPORTANT: PLEASE READ THESE INSTRUCTIONS CAREFULLY. NOTE THE SAFE OPERATIONAL REQUIREMENTS, WARNINGS AND CAUTIONS. USE THIS PRODUCT CORRECTLY AND WITH CARE FOR THE PURPOSE FOR WHICH IT IS INTENDED. FAILURE TO DO SO MAY CAUSE DAMAGE AND/OR PERSONAL INJURY AND WILL INVALIDATE THE WARRANTY. PLEASE KEEP INSTRUCTIONS SAFE FOR FUTURE USE.

1. SAFETY INSTRUCTIONS

1.1. GENERAL SAFETY

- X **DO NOT** use the bore scope if dropped and/or damaged
 - X **DO NOT** operate near live electrical wires.
 - X **DO NOT** operate near moving parts such as pulleys, motors, gears or fans etc.
 - X **DO NOT** bend the bore scope shaft tighter than 2.5 inch radius (5 inch diameter).
 - X **DO NOT** expose the bore scope housing to water or other liquids.
 - X **DO NOT** insert the bore scope shaft into locations whose temperature is greater than 45°C.
 - ✓ Maintain the bore scope in good and clean condition for best and safest performance.
 - ✓ A full range of personal safety equipment is available from your Sealey dealer.
 - ✓ Wear suitable clothing to avoid snagging. Do not wear jewellery and tie back long hair.
 - ✓ Account for all tools and parts being used and do not leave any in, or near, the engine.
 - ✓ Be alert to your surrounding environment while using the bore scope.
- Note the location of the object to be inspected and determine a route to it. Bend the bore scope shaft to follow the route.

1.2. MAINS POWER ELECTRICAL SAFETY (In relation to the battery charger)

- **WARNING! It is the owner's responsibility to check the following: You must** check all electrical equipment and appliances to ensure they are safe before using. **You must** inspect power supply leads, plugs and all electrical connections for wear and damage. **You must** ensure that the risk of electric shock is minimised by the installation of appropriate safety devices. An RCCB (Residual Current Circuit Breaker) should be incorporated in the main distribution board. We recommend that an RCD (Residual Current Device) is used with all electrical products. It is particularly important to use an RCD with portable products that are plugged into a supply not protected by an RCCB. If in doubt consult a qualified electrician. You may obtain an RCD by contacting your dealer. **You must** also read and understand the following instructions concerning electrical safety.
- 1.1.1. The **Electricity At Work Act 1989** requires all portable electrical appliances, if used on business premises, to be tested by a qualified person, using a Portable Appliance Tester (PAT), at least once a year.
- 1.1.2. The **Health & Safety at Work Act 1974** makes owners of electrical appliances responsible for the safe condition of the appliance and the safety of the appliance operator. **If in any doubt about electrical safety, contact a qualified electrician.**
- 1.1.3. Ensure that the insulation on all cables and the product itself is safe before connecting to the mains power supply. See 1.3.1. above and use a Portable Appliance Tester (PAT).
- 1.1.4. Ensure that cables are always protected against short circuit and overload.
- 1.1.5. Regularly inspect power supply leads, plugs and sockets for wear, damage or loose connections.
- 1.1.6. Check that the voltage marked on the product is the same as the power supply to be used and check that the plug is fitted with the correct capacity fuse.
- 1.1.7. **DO NOT** pull or carry the appliance by attached leads.
- 1.1.8. **DO NOT** pull plug from socket by the power cable.
- 1.1.9. **DO NOT** use worn or damaged cables, plugs or connectors. Immediately have any faulty item repaired or replaced by a qualified electrician.

1.3. BATTERY CHARGER SAFETY INSTRUCTIONS

- **WARNING! DO NOT** attempt to charge any battery other than that supplied for the bore scope. Other types of batteries may explode!
- ✓ All mains electrical supply safety features must be followed as described in Section 1.1.
- ✓ Disconnect the charger from the mains power supply when not in use.
- X **DO NOT** expose the charger to damp or wet conditions.
- X **DO NOT** pull or carry the charger by the power lead.
- X **DO NOT** operate the charger if it has been dropped, received a sharp knock, or is damaged. Take charger to an authorised agent.
- X **DO NOT** dismantle the charger as this may cause damage or personal injury and will invalidate your warranty.

2. INTRODUCTION

Suitable for internal inspection of cylinder head bores, engine compartments and other machinery/industrial applications. Flexible shaft diameter is small enough to fit through most spark/glow plug and injector apertures. Features three tip mounted mirrors 30°, 45° and 60° allowing a clear view in confined spaces. A magnetic attachment is also included. Capable of taking photos/videos which can be viewed on a computer via the SD card. Ideal for warranty authorisation. Supplied with SD card, AV cable, battery charger and comprehensive instructions in carry-case.

3. SPECIFICATION

Probe Diameter	6mm
Probe Length	1000mm
Minimum Bend Radius	2.5"/64mm
Camera	Automatic exposure
Camera viewing Angle	67°
Light source	4 x LEDs
Screen	3.5" LCD Monitor
Screen resolution	320 x 240 pixels
LCD	Colour
Video Format	NTSC & PAL
Battery	3.7V Rechargeable
Charger	110V - 230V(LI)
Flash memory storage	2GB SD Card
Compression Format	MPEG4

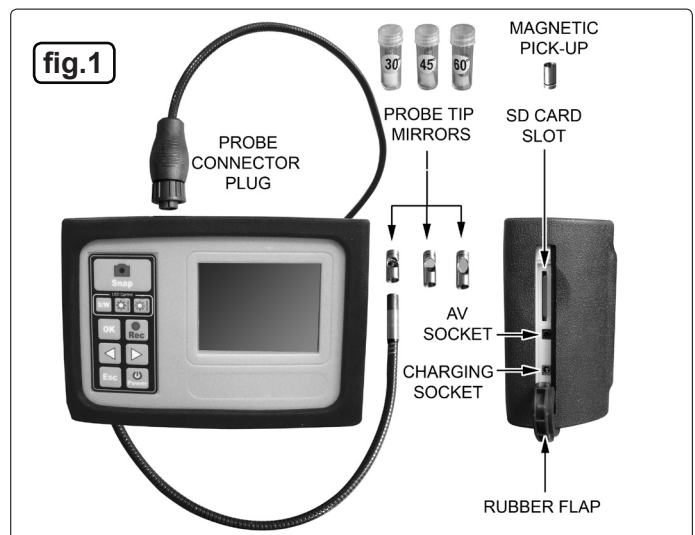

4. SET UP MENU

4.1. **Set Up Menu.** Prior to operation the set up menu can be used to adjust the basic functions such as the **date and time** and **auto power off**. To access the main menu hold down the power button for 5 seconds and then press "OK". Use the left and right arrow keys to move through the menu options and confirm your choice by pressing "OK". A sub menu will appear. Follow the directions indicated on the schematic below to make the required adjustment and confirm your adjustment by pressing the "OK" button which will also take you back to the main menu. Press "Esc" to exit the main menu.

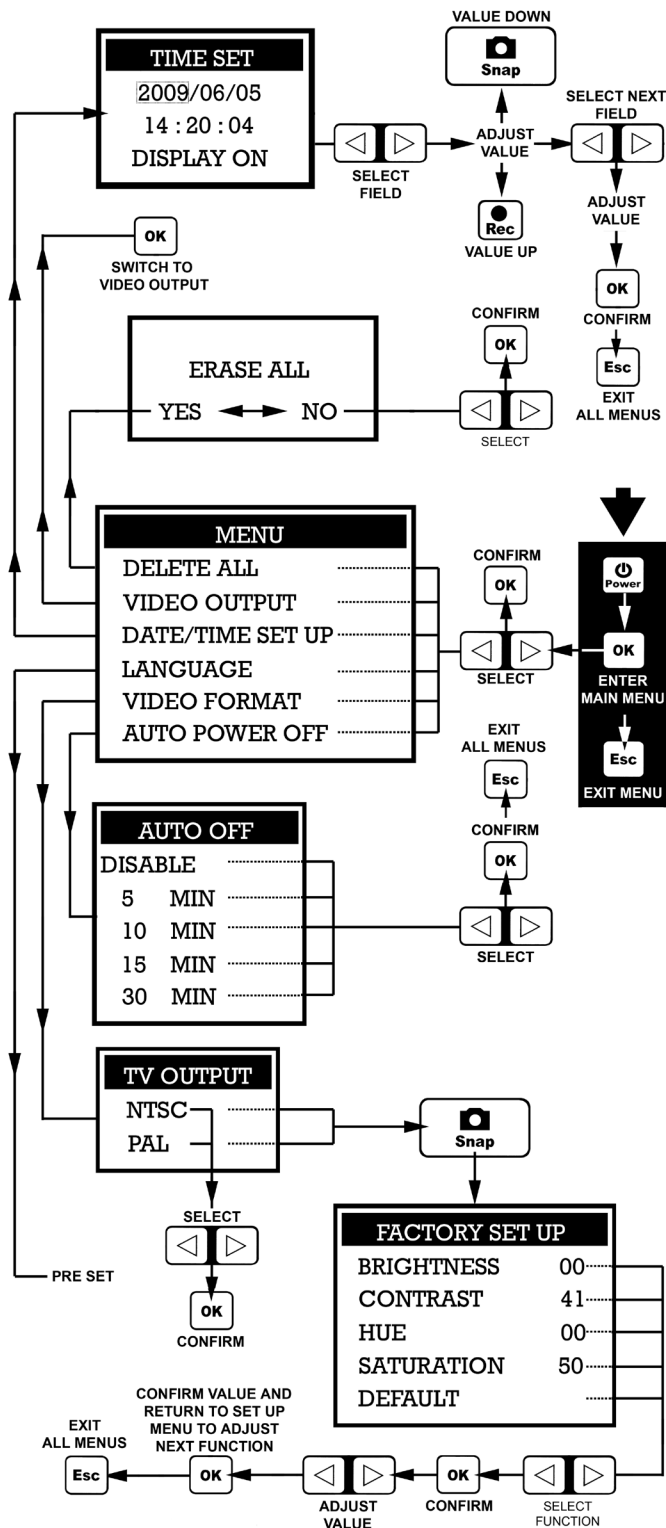

4.2. **Video functions.** The output can be fed to an external screen using the supplied AV cable. Comprehensive functions are available via the main menu to match the output to the screen available. See schematic above.

5. CONTROL PANEL KEY

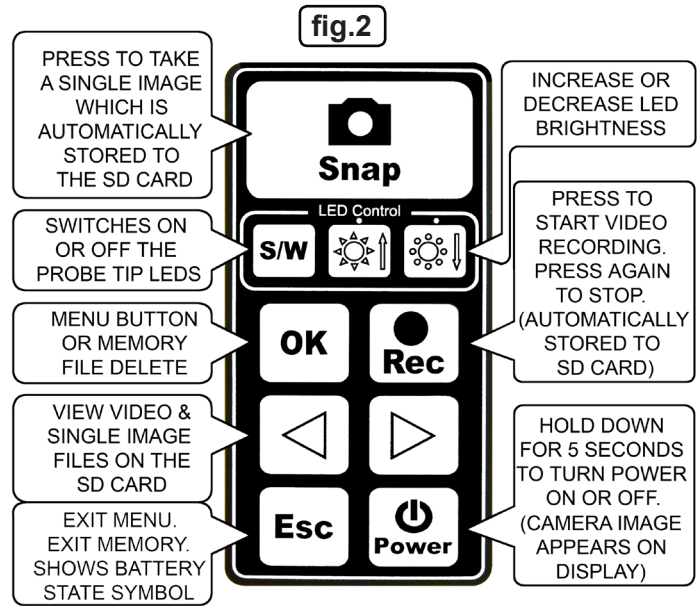

6. PREPARATION

- 6.1 **Insert the SD memory card.** Open the rubber flap on the right hand side of the casing and identify the SD memory card slot as shown in fig.1. Insert the card with the terminals facing towards the front of the unit. Push the card in until it latches in place. Do not force it if it will not insert but recheck that the orientation of the card is correct.
- 6.2 **Charging the unit.** Plug the charger into the mains power supply. Open the rubber flap on the right hand side of the casing and identify the charging socket as shown in fig.1. Plug the charging cable into the charging socket and switch on the mains supply. Turn the unit on by holding down the "Power" button for 5 seconds. The battery charging symbol will appear for approximately 3 seconds. Leave the battery on charge for 3 to 4 hours. Periodically press the "Esc" button to see the state of charge symbol. When the symbol has a solid centre bar the unit is fully charged. Unplug the charger from the mains power supply and disconnect the charger cable from the unit.
- 6.3 **Attaching the probe.** Plug the probe connector into the socket in the top of the unit. Rotate the locking ring so that it engages with the thread on the outside of the socket and draws the connector fully into the socket. See fig.1.
- 6.4 **Attaching mirrors.** To see into otherwise inaccessible areas a small mirror fitting can be screwed onto the probe tip. See fig.1. Three mirror fittings are provided giving viewing angles of 30°, 45° & 60°.

7. OPERATION

- 7.1 **Switch on unit.** Turn the unit on by holding down the "Power" button for 5 seconds. The date and time will be displayed at the top of the screen and the word "CAMERA" and the battery symbol will appear briefly towards the bottom of the screen. Whatever the probe tip is pointing at will be displayed on the screen.
- 7.2 **Positioning the probe tip.** Manipulate the probe tip into the area under investigation whilst viewing the display. The probe can be manoeuvred and manipulated into more complex paths but the following points should be borne in mind.
 - X **DO NOT** bend any part of the flexible probe tighter than a 2.5 inch radius (5 inch diameter).
 - X **DO NOT** use excessive force to insert or retrieve probe from the equipment or areas under inspection.
 - X **DO NOT** use the probe tip to push against objects or to clear a path. This instrument is for remote viewing only.
 - X **DO NOT** insert the probe into locations where the temperature is greater than 113 deg F (45 deg C).
 - X **DO NOT** vibrate, bang, or drop your bore scope. It is not shock resistant.

- 7.3 Probe Tip LED Control.** Where there is no light available (such as inside an engine cylinder accessed through the spark plug hole) the probe tip LEDs should be turned on by pressing the "SW" button within the LED Control area on the control panel. See fig.2. The brightness of the LEDs can be adjusted up or down by using the two buttons to the right of the "SW" button. To increase the brightness repeatedly press the button with the "up" arrow. When a red LED illuminates directly above the button maximum brightness has been achieved. To decrease the brightness repeatedly press the button with the "down" arrow. When a green LED illuminates directly above the button minimum brightness has been achieved.
- 7.4 Taking a photograph.** Press the "Snap" button at the top of the control panel to record a single image of whatever the camera is viewing. The image will automatically be saved to the SD card as a JPG file.
- 7.5 Video recording.** Press the "Rec" button to start video recording. A red video camera symbol will appear on the display. To stop video recording press the button again. The video information will automatically be saved to the SD card as an AFS file which can be viewed using Windows Media Player.
- 7.6 Viewing recorded files.** Pressing either the left or right arrow button (see fig.2) takes you into memory mode where the contents of the SD flash memory card can be viewed. The files will be viewed in the sequence that they were recorded in. Step through them forwards or backwards using either of the arrow buttons. A green video camera symbol will appear when you have selected a video file accompanied by a red arrow which remains on screen whilst the sequence plays.
- 7.7 Deleting recorded files.** To delete any file press the "OK" button whilst viewing the file. A box will appear in the middle of the screen containing the word DELETE below which will be a flashing "NO". Use the left hand arrow key to toggle across to a flashing "YES". To delete the file press "OK" again. To abort deletion press the "Esc" button.
- 7.8 External viewing of files.** The files can be viewed on an external computer by removing the SD card from the unit when it is off and plugging the card into a suitable reader connected to the computer.
- 7.9 Viewing on external monitor.** Using the AV cable provided, plugged

into the AV socket in the side of the unit (see fig.1), the files can be viewed on a compatible external monitor. To obtain the best picture access the **video format** sub menus from the set up menu. To switch to an external screen select **video output** from the set up menu.

8. MAINTENANCE

8.1 Cleaning and Storage

- 8.1.1 Wipe the bore scope tip, shaft and housing with a clean, soft cloth to remove residue and moisture.
- 8.1.2 Wash the bore scope tip and shaft with a cleaning liquid and rinse with water, then dry.

X DO NOT submerge the bore scope in water .

NOTE: The bore scope MUST be completely dry prior to returning it to the storage case.

Environmental Protection.



Recycle unwanted materials instead of disposing of them as waste. All tools, accessories and packaging should be sorted, taken to a recycle centre and disposed of in a manner which is compatible with the environment.



When the product is no longer required, it must be disposed of in an environmentally protective way.

Battery removal.

Rechargeable battery contains Lithium polymer (LI).



1. Remove the four screws from the back of the unit and remove the back.
2. Undo the two screws that fix the battery cover plate and lift it off.
3. Disconnect the battery lead plug from the PCB and lift out the battery.
4. Recycle or dispose of used battery as stipulated by local regulation.

Battery Safety



WARNING! To reduce the risk of burns or fire:

- X DO NOT Attempt to open, disassemble, modify or service the battery pack.
- X DO NOT Crush, puncture, short external contacts or dispose of in fire or water.
- X DO NOT Expose to temperatures above 60°C (140°).
- ✓ Replace only with the battery pack designated for this product.
- ✓ If the electrolyte in the cells gets on your skin, thoroughly wash with soap and water. If it gets in your eyes, rinse thoroughly with cool water and seek immediate medical attention.

Declaration of Conformity

We, the sole importer into the UK, declare that the product listed here is in conformity with the following standards and directives.

**Video Bore Scope
Model: VS8195**

2002/95/EC RoHS Directive
2002/96/EC WEEE Directive
93/68/EEC CE Marking Directive



The construction files for this product is held by the Manufacturer and may be inspected, by a national authority, upon request to Jack Sealey Ltd.

Signed by Tim Thompson

1st June 2009

For Jack Sealey Ltd. Sole importer into the UK of Sealey Power Products.

Parts support is available for this product. To obtain a parts listing and/or diagram, please log on to www.sealey.co.uk, email sales@sealey.co.uk or phone 01284 757500.

NOTE: It is our policy to continually improve products and as such we reserve the right to alter data, specifications and component parts without prior notice.

IMPORTANT: No liability is accepted for incorrect use of this product.

WARRANTY: Guarantee is 12 months from purchase date, proof of which will be required for any claim.

INFORMATION: For a copy of our catalogue and latest promotions call us on 01284 757525 and leave your full name, address and postcode.



Sole UK Distributor
Sealey Group,
Bury St. Edmunds, Suffolk.



01284 757500



01284 703534



www.sealey.co.uk



sales@sealey.co.uk