

Thank you for purchasing a Sealey product. Manufactured to a high standard this product will, if used according to these instructions and properly maintained, give you years of trouble free performance.



**IMPORTANT:** PLEASE READ THESE INSTRUCTIONS CAREFULLY. NOTE THE SAFE OPERATIONAL REQUIREMENTS, WARNINGS AND CAUTIONS. USE THE PRODUCT CORRECTLY AND WITH CARE FOR THE PURPOSE FOR WHICH IT IS INTENDED. FAILURE TO DO SO MAY CAUSE DAMAGE AND/OR PERSONAL INJURY AND WILL INVALIDATE THE WARRANTY. PLEASE KEEP INSTRUCTIONS SAFE FOR FUTURE USE.

### 1. SAFETY INSTRUCTIONS

- ❑ **WARNING!** Ensure Health and Safety, local authority and general workshop practice regulations are adhered to when using tools.
- ✗ **DO NOT** use tools if damaged.
- ✓ Maintain tools in good and clean condition for best and safest performance.
- ✓ Ensure that a vehicle which has been jacked up is adequately supported with axle stands and that the wheels are chocked.
- ✓ Wear approved eye protection. A full range of personal safety equipment is available from your Sealey dealer.
- ✓ Wear suitable clothing to avoid snagging. Do not wear jewellery and tie back long hair.
- ✗ **DO NOT** use air tools to operate the force nut.

**IMPORTANT:** The force screw must be kept well lubricated

**IMPORTANT:** These instructions are provided as a guide only. Always refer to the vehicle manufacturer's service instructions, or a proprietary manual, to establish the current procedure and data.

### 2. INTRODUCTION & APPLICATIONS

#### 2.1 Introduction

VS4464 removes and installs the bush on the rear trailing arm of BMW 3 Series as detailed under Applications. The design of the bush has changed, and this tool will remove both "old style" bushes and new "slotted" bushes, and will install the "slotted" bushes.

#### 2.2 Applications:

BMW:  
3 Series - E36 and E46 including E46 Compact.

### 3. CONTENTS

1	VS4464.01	Force Screw
2	VS4464.02	Force Nut Assembly
3	VS4464.03	Bridge Piece
4	VS4464.04	Thrust Plate
5	VS4464.05	Lock Nut
6	VS4464.06	Compressor Sleeve
7	VS4464.07	Removal/Installer Plate
8	VS4460.07	Flange Nut

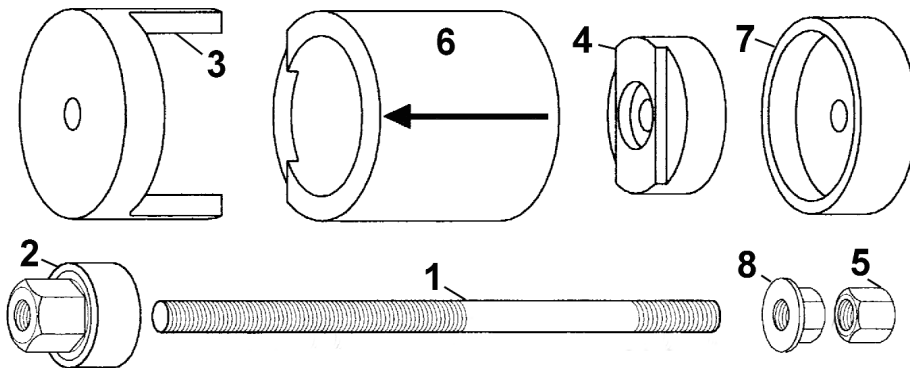

Issue: 01  
Issue Date: 050506

ITEM	PART NO.	DESCRIPTION
1	VS4464.01	Force Screw
2	VS4464.02	Force Nut Assembly
3	VS4464.03	Bridge Piece
4	VS4464.04	Thrust Plate
5	VS4464.05	Lock Nut
6	VS4464.06	Compressor Sleeve
7	VS4464.07	Removal/Installer Plate
8	VS4460.07	Flange Nut

**NOTE:** It is our policy to continually improve products and as such we reserve the right to alter data, specifications and component parts without prior notice.

**IMPORTANT:** No liability is accepted for incorrect use of this product.

**WARRANTY:** Guarantee is 12 months from purchase date, proof of which will be required for any claim.

**INFORMATION:** For a copy of our latest catalogue and promotions call us on 01284 757525 and leave your full name and address, including postcode.

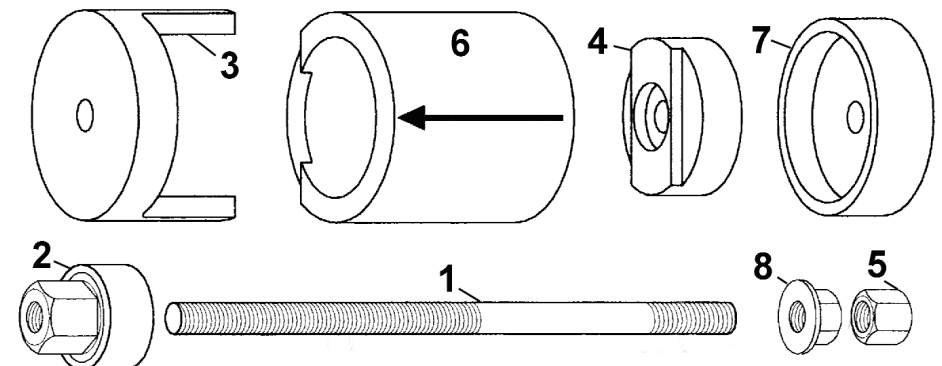

## 4. INSTRUCTIONS

### 4.1 Trailing Arm - 'Old Style' bush and new 'Slotted' bush (Fig.1).

With Kit VS4464 the old style bush can be removed from the trailing arm and the new specification 'slotted' bush installed 'on-car', without the need to remove the trailing arm. By selecting and assembling the relevant parts in the specific order required, bushes are removed and installed by turning the force nut whilst counter-holding the 'locking' nuts.

The replacement 'slotted' bush must be compressed in order for it to be installed into the trailing arm and a Compressor Sleeve is included in the kit for this purpose. **NOTE:** The Compressor Sleeve has a cut-away section at one end, and when installing a new bush, this cut-away is positioned at the bottom part of the face of the trailing arm, to accommodate any raised area of casting, and to ensure the Compressor Sleeve fits squarely and flush to the face of the trailing arm.

**ALWAYS KEEP FORCE SCREW WELL LUBRICATED**

**DO NOT USE AIR TOOLS**

4.2 The sleeves / plates are marked / identified as Nos 3,4,6 and 7 in (Fig.2).

4.3 **IMPORTANT:** Prior to undoing the bolts securing the trailing arm bracket to the vehicle, mark the position of the bolts with paint so that the bracket can be re-positioned in the same place when re-assembling, in order to maintain rear tracking (Fig.3). Undo the trailing arm bracket bolts, release the brake pipe clamp off the arm and pull down the arm to expose bush/bracket. Remove the bracket.

4.4 **IMPORTANT:** Paint a mark on the trailing arm, to ensure the replacement bush can be aligned correctly during installation (Fig.4).

Fig.3

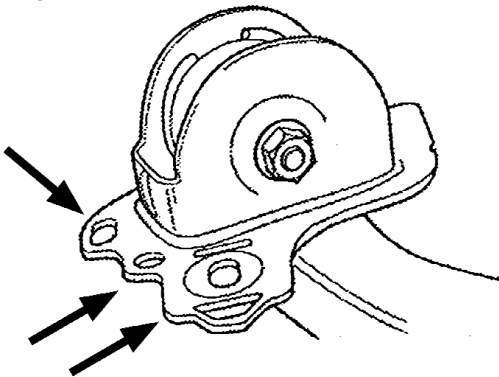

Fig.1

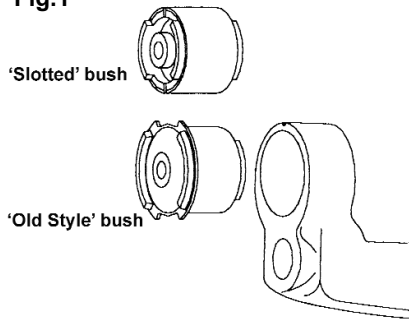

Fig.2

Sleeves / Parts Identification Guide.

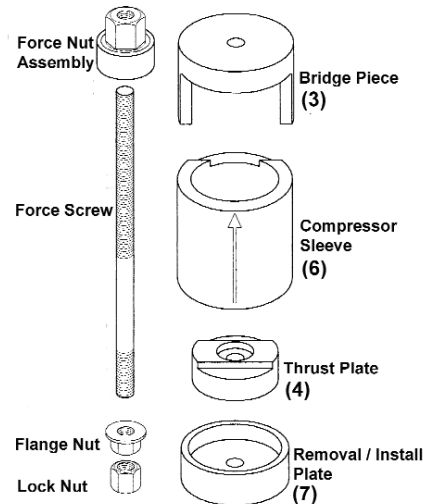
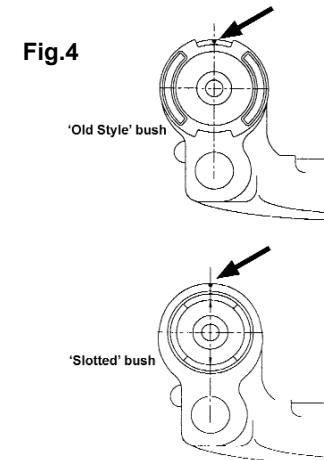

Fig.4



### 4.5 Removing the old bush

The old bush is extracted out of the trailing arm in a direction from the inside to the outside of the vehicle. Assemble and fit all required parts from VS4464 Kit, depending upon 'Old Style' or new 'Slotted' bushes being removed, as shown in the removal assembly sequence diagrams (Figs 5 and 6).

**IMPORTANT:** Turn the Force Nut Assembly by hand, to take up any adjustment and to 'lock' the assembly onto the bush ensuring the assembly is squarely aligned in position on the trailing arm. Check that the feet of Bridge Piece (3) are located through the bush and resting on the arm. Counter-hold Lock Nut whilst turning the Force Nut Assembly to extract old bush.

### 4.6 Installing a new bush

BMW have replaced the existing design of bush with a 'slotted' version. This bush requires to be pre-compressed as it is installed into the arm. The new bush is installed in a direction from outside towards inside of the vehicle (Fig.7). **IMPORTANT:** The cut-away on the face of the Compressor Sleeve (6) is positioned towards the bottom part of the trailing arm face to accommodate any raised area of casting. The Compressor Sleeve MUST fit squarely and flush to the arm face and align centrally to the bore of the arm, to ensure the new bush is not over-compressed when entering the arm. Slide Compressor Sleeve (6) over the bush with the arrow on top and with the direction of the arrow pointing away from Thrust Plate (4).

**IMPORTANT:** Ensure the 'slot' of the bush (Fig.8) aligns exactly under the arrow on Compressor Sleeve (6). The bush is not visible during initial installation and the arrow must act as your indicator for the correct positioning of the bush. Align the complete assembly via the arrow ON TOP of the Compressor Sleeve (6) with the paint mark made earlier on the arm. Ensure the 'Slot' of the bush also aligns under the arrow.

Assemble and fit all required parts as shown in the Installation assembly sequence diagram (Fig.7). Counter-hold the Flange/Lock Nut combination whilst turning the Force Nut Assembly to push the new bush through Compressor Sleeve (6) and into its housing. **IMPORTANT:** Check 'Slot' of bush aligns with paint mark made earlier on the arm. Continue to tighten the Force Nut until the bush is correctly installed with its metal portion protruding 2.5mm from the face of the arm (Fig.9).

Fig.5  
Removal 'Old Style' Bush

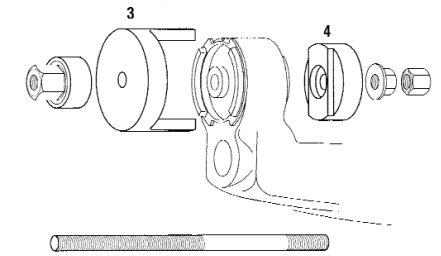

Fig.6

Removal New 'Slotted' Bush

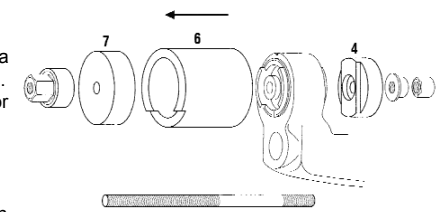

Fig.7

Installation

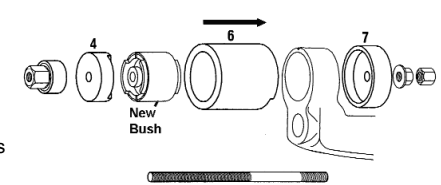

Fig.8

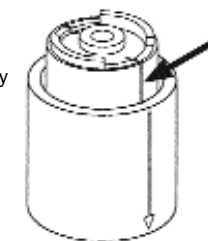
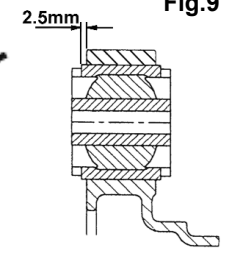

Fig.9



**NOTE:** It is our policy to continually improve products and as such we reserve the right to alter data, specifications and component parts without prior notice.

**IMPORTANT:** No liability is accepted for incorrect use of this product.

**WARRANTY:** Guarantee is 12 months from purchase date, proof of which will be required for any claim.

**INFORMATION:** For a copy of our latest catalogue and promotions call us on 01284 757525 and leave your full name and address, including postcode.

**SEALEY** Professional TOOLS  
AUTO SERVICE LINE

Sole UK Distributor  
Sealey Group,  
Bury St. Edmunds, Suffolk.

01284 757500  
01284 703534

www.sealey.co.uk  
sales@sealey.co.uk