



INSTRUCTIONS FOR: VECTRA TRAILING ARM BUSH TOOL MODEL NO: VS4460

Thank you for purchasing a Sealey product. Manufactured to a high standard this product will, if used according to these instructions and properly maintained, give you years of trouble free performance.



IMPORTANT: PLEASE READ THESE INSTRUCTIONS CAREFULLY. NOTE THE SAFE OPERATIONAL REQUIREMENTS, WARNINGS AND CAUTIONS. USE THE PRODUCT CORRECTLY AND WITH CARE FOR THE PURPOSE FOR WHICH IT IS INTENDED. FAILURE TO DO SO MAY CAUSE DAMAGE AND/OR PERSONAL INJURY AND WILL INVALIDATE THE WARRANTY. PLEASE KEEP INSTRUCTIONS SAFE FOR FUTURE USE.

1. SAFETY INSTRUCTIONS

- WARNING!** Ensure Health and Safety, local authority and general workshop practice regulations are adhered to when using tools.
- DO NOT** use the kit if any parts are missing or damaged.
- DO NOT** use the subframe bush replacement tool for any purpose other than that for which it is designed.
- Maintain the tool components in good and clean condition for best and safest performance.
- Ensure that a vehicle which has been jacked up is adequately supported with axle stands.
- Wear approved eye protection. A full range of personal safety equipment is available from your Sealey dealer.
- Wear suitable clothing to avoid snagging. Do not wear jewellery and tie back long hair.
- Keep children and other unauthorised persons away from the working area.
- Ensure there is adequate lighting prior to using the subframe bush replacement tool.

IMPORTANT: These instructions are provided as a guide only. Always refer to the vehicle manufacturer's service instructions, or a proprietary manual, to establish the current procedure and data.

2. INTRODUCTION & APPLICATIONS

2.1 Introduction

With Kit VS4460 the upper and lower damping bushes in the trailing arm can be removed and new bushes installed in-situ, ON CAR, without removing the trailing arm from the car.

2.2 Applications

VAUXHALL/OPEL Upper and Lower Damping Bushes of the trailing arm on Vectra-B (-02)

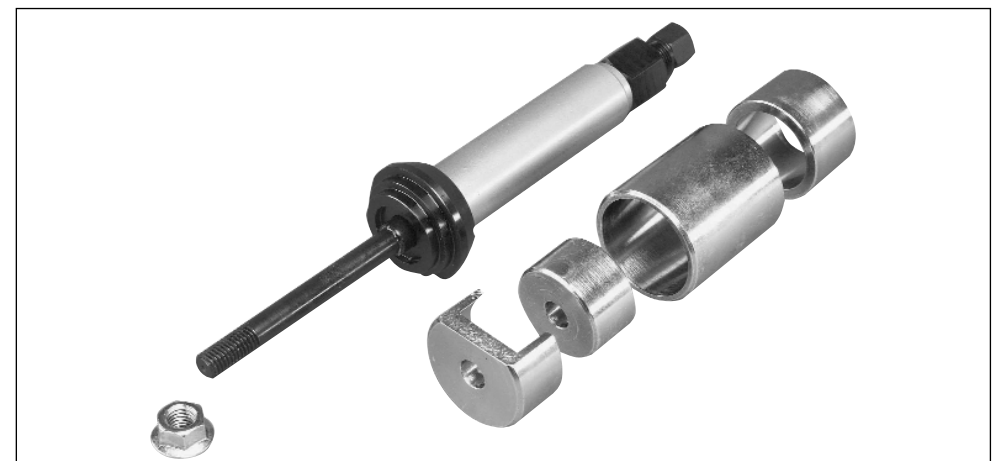

NOTE: It is our policy to continually improve products and as such we reserve the right to alter data, specifications and component parts without prior notice.

IMPORTANT: No liability is accepted for incorrect use of this product.

WARRANTY: Guarantee is 12 months from purchase date, proof of which will be required for any claim.

INFORMATION: For a copy of our latest catalogue and promotions call us on 01284 757525 and leave your full name and address, including postcode.

3. CONTENTS/PARTS LIST

1	VS4460.01	Force Screw
2	VS4460.02	Force Nut
3	VS4460.03	Spacer Tube
4	VS4460.04	Bearing Assembly
5	VS4460.05	Support Sleeve
6	VS4460.06	Removal Sleeve
7	VS4460.07	Retaining Nut
8	VS4460.08	Installer Sleeve
9	VS4460.09	Retaining Sleeve

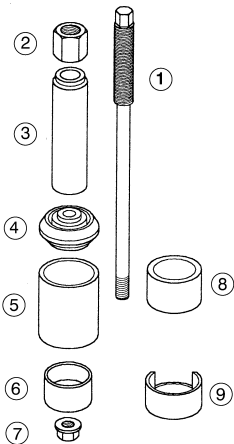

4. INSTRUCTIONS

The kit includes all the removal and installation sleeves required for the upper and lower damping bushes of the trailing arm and features bearing assisted force to provide the smooth but powerful action needed to remove and replace these bushes. The sleeves are marked/identified with numbers 3, 5, 6, 8 and 9. It will save time, and make the assembling of the correct configuration for removal or installation easier, if the operator reads and becomes familiar with the assembly sequence beforehand.

ALWAYS KEEP FORCE SCREW WELL LUBRICATED

DO NOT USE AIR TOOLS

4.1 Preparation
Position the vehicle on a suitable lift at an appropriate working height.
Remove rear road wheel according to side being worked on.
Release the nut and bolt securing the control arm, upper or lower, at the point it connects to the trailing arm and slacken the inner bolt to allow the control arm to be moved up or down to expose the bush to be removed.

4.2 Removing the old bush
Sub-assemble the Force Screw, Force Nut, Spacer Tube 3, Bearing Assembly and Support Sleeve 5, off the vehicle.
NOTE: The Force Nut should be threaded up to a position close to the force screw hexagon.

Place Removal Sleeve 6, onto the back of the bush - the side facing towards the rear of the vehicle. Position the removal assembly at the front face of the bush, (opposite side to Removal Sleeve 6), and push the force screw through the hole in the centre of the bush and through the hole in Removal Sleeve 6. The complete removal assembly is then secured in place, positioned both sides of the bush, by screwing the Retaining Nut onto the end of the force screw.
WARNING: The Retaining Nut MUST be screwed fully on to the force screw thread. Failure to screw the Nut down the full length of the thread could cause the thread to strip and the nut to fly off.

IMPORTANT: Turn the Force Nut, by hand, to take up any adjustment and 'lock' the assembly onto the bush ensuring the assembly is squarely aligned so that the Removal Sleeve 6 locates onto the metal outer of the bush and will withdraw the bush from its housing horizontally.

Counter-hold the force screw with a suitable spanner on its hexagon and with a second spanner turn the Force Nut to pull the old bush into Support Sleeve 5, and out of the trailing arm.

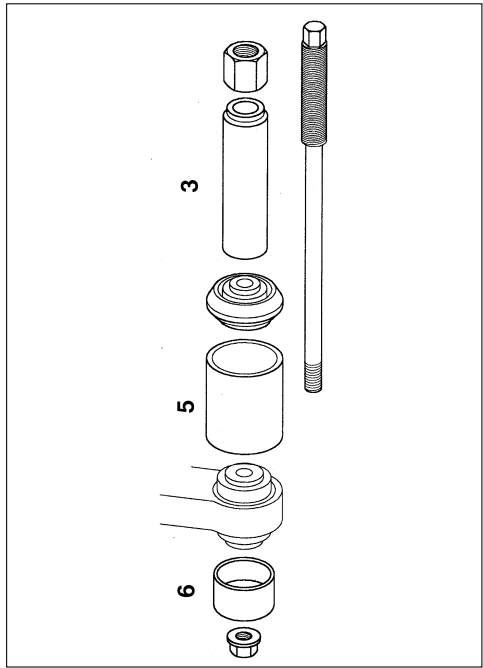

Assembly for removing old bush
VS4460 - 1 - 280606

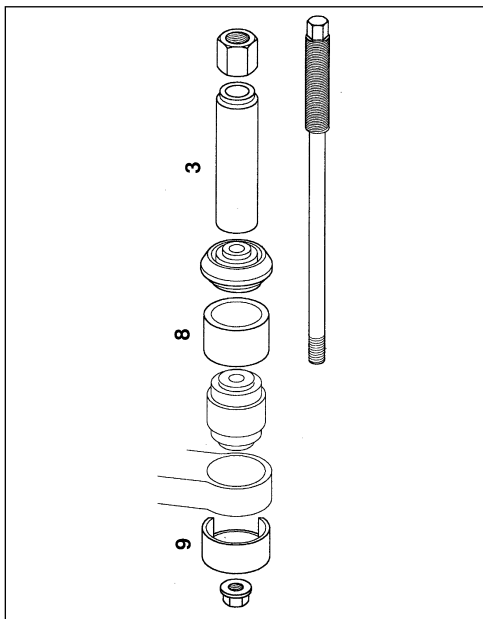

Assembly for installing a new bush

4.3 Installing a new bush
Sub-assemble the Force Screw, Force Nut, Spacer Tube 3, Bearing Assembly and Installer Sleeve 8, off the vehicle.
NOTE: The Force Nut should be threaded up to a position close to the force screw hexagon.

Fit the new bush into Installer Sleeve 8 with the Force Screw passing through the hole in the centre of the bush. Position the installation assembly, complete with the new bush, at the front face of the bush housing (the side facing the front of the vehicle), so the bush partially enters into its housing. Place Retaining Sleeve 9 in line on the back face of the housing and over the protruding end of the force screw.
NOTE: Retaining Sleeve 9 has a cut-away to allow it to sit correctly onto the rear face of the trailing arm. The complete assembly is then secured in place by screwing the Retaining Nut onto the end of the force screw.
WARNING: The Retaining Nut MUST be screwed fully on to the force screw thread. Failure to screw the Nut down the full length of the thread could cause the thread to strip and the nut to fly off.

IMPORTANT: Turn the Force Nut, by hand, to take up any adjustment and 'lock' the assembly onto the trailing arm ensuring the installation assembly and new bush are squarely aligned with the bush housing hole.

Counter-hold the force screw with a suitable spanner whilst turning the Force Nut with a second spanner to push the new bush into the housing.

IMPORTANT: As the Force Nut is being turned you will feel the bush cleanly entering its housing. If the bush 'binds', release the pressure immediately, remove the bush and start again. Ensure the assembly is horizontal and aligned squarely to the housing.

Continue to tighten the Force Nut until Installer Sleeve 8, fully touches the face of the trailing arm. The bush is then completely inserted. Remove the installation assembly and check the final position of the new bush. It should protrude equally from both sides of the trailing arm.

		Sole UK Distributor Sealey Group, Bury St. Edmunds, Suffolk.	01284 757500 01284 703534	www.sealey.co.uk sales@sealey.co.uk
	AUTO SERVICE LINE			