

**FLYWHEEL HOLDING TOOLS FOR:  
Citroen, Peugeot, Renault, Fiat, LDV, Vauxhall/Opel & Rover.**

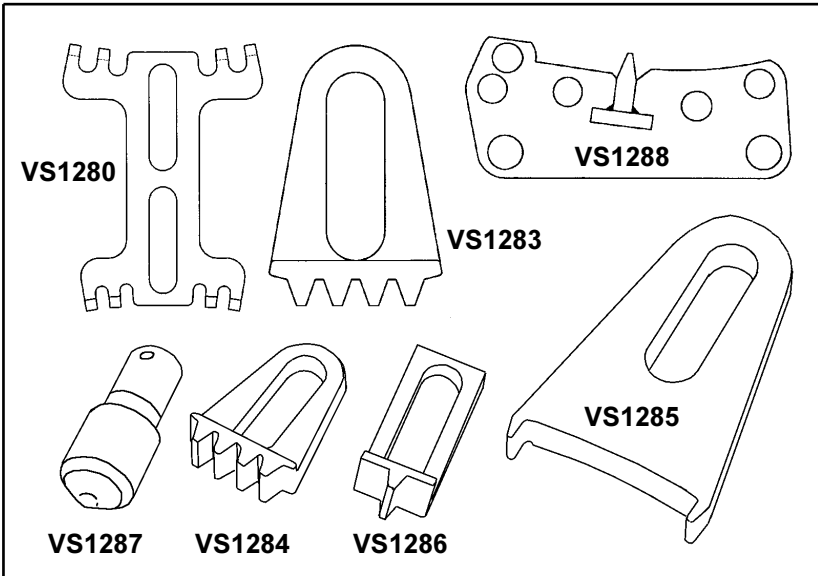

**1. INTRODUCTION**

**VS1280, VS1283, VS1284, VS1285, VS1286, VS1287, VS1288 and VS4738** Holding Tools lock into the flywheel teeth and are used to ensure positive engine 'lock' during clutch/engine overhaul and in particular to lock the crankshaft to facilitate removal of the crank pulley during timing belt renewal applications. Locking Pins are for timing position retention only and must not be used to lock the engine to release the crank pulley nut/bolt. All too often, a make-do method of 'jamming' the flywheel results in damage to gears and housing. The crank pulley bolt has a high torque specification and use of the correct Holding Tool completes the job quickly and most importantly, safely.

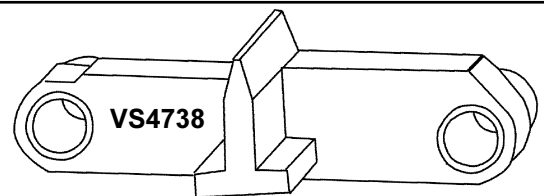

**2. APPLICATION**

**VS1280 VAUXHALL/OPEL:**  
1.2, 1.4, 1.6, 1.8, 2.0 OHC Petrol engines. 1.6 & 1.7 OHC Diesel engines. 1.5 & 1.7 OHC Diesel (Isuzu) engines.

**VS1283 CITROEN:** Synergie 2.0/Turbo, ZX 1.9D/TD, Xantia 1.9D/TD, Berlingo 1.9D, Dispatch 1.9D/TD, Synergie 1.9D, Relay 1.9D/TD.  
**FIAT:** Ulysse 2.0/Turbo, Ducato 2.0.  
**FSO** 1.9D.  
**LDV:** 200 1.9D, Pilot 1.9D.  
**PEUGEOT:**  
205 1.6/1.9, 305 1.6/1.9, 309 1.6/1.9,  
405 1.6/1.9, 405 1.8/2.0 (92-), 605 2.0, Boxer 2.0, c205 1.8/1.9D, 305 1.8/1.9D, 306 1.8/1.9D/TD,  
309 1.8/1.9D/1.8TD, 405 1.8TD, 405 1.9D, 406 1.9D, Partner 1.9D, Talbot/Horizon/Solara 1.9D, J5/Talbot Express 1.9D,  
605D/TD, 806 1.9TD, Expert 1.9D, Boxer 1.9D/TD.  
**RENAULT:**  
R5 1.6D, R9 1.6D, 411 1.6D Express/Extra 1.6D - F8M Diesel engines.  
Clio, Express/Extra, R19 1.9D - early F8Q Diesel engines.  
Espace 2.1D, R21 2.1D, R25 2.1D, Trafic/Master 2.1D - J8S Diesel engines  
Clio 1.2/1.4, Express/Extra, R19 1.4, Megane/Scenic 1.4/1.6-E7F/E7J/ Petrol engines.  
R5, 1.7, Clio 1.7/1.8, R19 1.7, R21 1.7, Megane/Scenic 2.0, Laguna 1.8/2.0, Trafic 1.7 - F3N/F3P/F2R Petrol engines.  
Clio Williams, R19, Megane 2.0 16V Twin cam F7P/F7R engines  
Laguna/Safrane 2.0 16V Twin cam N7Q/N7U engines.

**VS1284 RENAULT:**  
Clio, Twingo, Kangoo, Megane/Scenic, 1.2/1.6 D7F and K7M Petrol engines.  
Megane/Scenic, Kangoo 1.9D F8Q and F9Q (direct injection) Diesel engines.

**VS1285 RENAULT:** Laguna, Safrane, Espace 2.2D/TD G8T Diesel engines.

**VS1286 CITROEN**  
Xsara, Xantia 1.8/2.0 XU7 JP/JB Petrol engines.  
Xsara 1.8 16v XU7JP4 Twin Cams.  
XZ, Xantia, XM2.0 16v XU10J4 Twin Cams.  
Xantia 1.9D/TD XUD9BTF Diesel engines.  
Xantia, XM2.1TD XUD11BTE Diesel engines.

**VS1286** PEUGEOT  
406, 1.8/2.0 XU7JP/JB Petrol engines.  
406 1.8 16v XU7JP4 Twin Cams.  
306, 405, 605 2.0 16v XU10J4 Twin Cams.  
406, 1.9D/TD XUD9BTF Diesel engines.  
406, 605 2.1TD XUD11BTE Diesel engines.

**VS1287** CITROEN AX, Saxo 1.5D TUD5 Diesel engines.  
PEUGEOT 106 1.5D TUD5 Diesel engines.  
ROVER 115D 1.5D TUD5 Diesel engines.

**VS1288** ROVER  
111, 114, 214-K8 (SOHC) 95-. 214, 414-K16 (DOHC) 89-95.  
200Vi, 214.216 16v, 218 16v, 414/416 16v - K16 (DOHC) 95-.

**VS4738** ROVER 75 1.8/1.8T (K18) Engines. (99-)

### 3. SAFETY INSTRUCTIONS

- WARNING!** Ensure all health and safety, local authority and general workshop practice regulations are strictly adhered to when using tools.
  - DO NOT use tools if damaged.
  - Maintain tools in good and clean condition for best and safest performance.
  - If required, ensure the vehicle to be worked on is adequately supported with axle stands, ramps and chocks.
  - Wear approved eye protection. A full range of personal safety equipment is available from your Sealey dealer.
  - Wear suitable clothing to avoid snagging. Do not wear jewellery and tie back long hair.
  - Account for all tools, locking bolts, pins and parts being used and do not leave them in or near the engine.
  - WARNING!** Timing pins are for retention of timing position only, NOT for counter-holding the flywheel. Use the correct Flywheel Holding Tool to 'lock' the engine when releasing or tightening the crankshaft pulley bolt, for secure and safe operation.
- IMPORTANT: Always refer to the vehicle manufacturer's service instructions, or proprietary manual to establish the current procedure and data. These instructions for use are provided as a guide only.*

### 4. INSTRUCTIONS FOR USE

**VS1280, VS1283, VS1284, VS1285, VS1286, VS1288** and **VS4738** are used to prevent the crankshaft from rotating when removing the crankshaft pulley for timing belt replacement. Teeth on the tool engage the flywheel teeth and the tool is bolted to the transmission housing to prevent movement of the flywheel.

It is often necessary to remove the crankshaft pulley when replacing the timing belt. The pulley bolt has a high torque loading in which case the engine must be 'locked' securely when releasing and when tightening the bolt.

**VS1287 Holding Tool** 'locks' the flywheel in the same way but enters through a datum hole in the engine casing instead of being bolted to the housing.

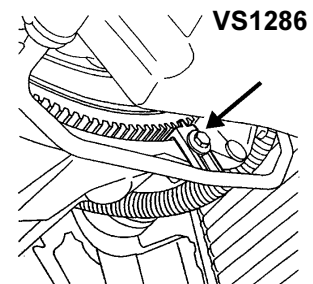
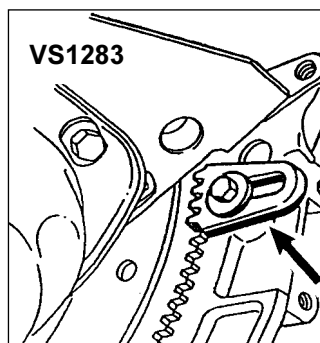
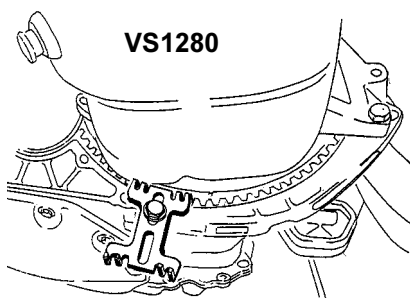

**NOTE:** It is our policy to continually improve products and as such we reserve the right to alter data, specifications and component parts without prior notice.

**IMPORTANT:** No liability is accepted for incorrect use of product.

**WARRANTY:** Guarantee is 12 months from purchase date, proof of which will be required for any claim.

**INFORMATION:** For a copy of our latest catalogue call us on 01284 757525 and leave your full name and address, including postcode.



Sole UK Distributor,  
Sealey Group,  
Bury St. Edmunds, Suffolk.

 01284 757500

 01284 703534

**E-mail:** [sales@sealey.co.uk](mailto:sales@sealey.co.uk)