

1. INTRODUCTION & APPLICATION

1.1. INTRODUCTION

Combination diesel injection pump timing tool suitable for Bosch rotary VE pumps with M8, M10 and M12 threaded service ports. Main bodies maybe threaded together for a long adaptor or used individually for a short adaptor depending on accessibility of pump service port. Adaptor set is also suitable for Nippondenso and Diesel Kiki pumps. Includes M10 adaptor suitable for Audi, Ford Transit, Renault and VW.

1.2. APPLICATION

Diesel Injection Pump Timing Tool - Bosch Rotary VE Pumps, M8/M10/M12 service ports.
 VS1079 must be used with the Dial Test Indicator AK9634M

2. SAFETY INSTRUCTIONS

WARNING! Ensure Health and Safety, local authority, and general workshop practice regulations are adhered to when using tools.

DO NOT use tools if damaged.

Maintain tools in good and clean condition for best and safest performance.

If required, ensure the vehicle to be worked on is adequately supported with axle stands, ramps and chocks.

Wear approved eye protection. A full range of personal safety equipment is available from your Sealey dealer.

Wear suitable clothing to avoid snagging. Do not wear jewellery and tie back long hair.

Account for all tools, locking bolts, pins and parts being used and do not leave them in or near the engine.

WARNING! Incorrect or out of phase camshaft timing can result in contact between the valve head and the piston crown causing damage to the engine. Incorrect injection pump timing may cause excessive smoke emissions, poor starting and low power output.

IMPORTANT: Always refer to the vehicle manufacturer's service instructions, or proprietary manual, to establish the current procedure and data. These instructions for use are provided as a guide only.

3. CONTENTS

PARTS LIST

1	VSE1079/01	Adaptor, M8
2	VSE1079/02	Extension Adaptor
3	VSE1079/03	Thread Adaptor, M12
4	VSE1079/04	Thumbscrew
5	VSE1259	Thread Adaptor, M10
6	VSE107/3	Gauge Rod - Short
7	VSE108/3	Gauge Rod - Long

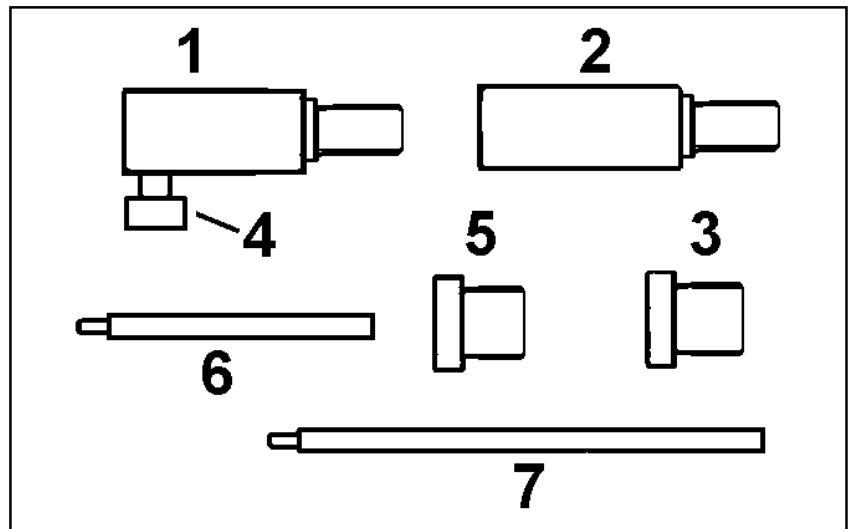

4. INSTRUCTIONS FOR USE

VS1079 is a Pump Timing Kit which connects to the service port of Bosch VE rotary injection pumps to set the pump static timing position. VSE1079/01 Adaptor can be used as a short reach adaptor or extended by adding VSE1079/02 according to accessibility around the service port area. The M8 thread screws directly into an M8 service port or Thread Adaptors VSE1259 or VSE1079/03 can be fitted to allow connection into M10 and M12 service ports, respectively. VS1079 is used with AK9634M Dial Test Indicator.

1. Locate diesel fuel injection pump. Clean and remove the service port access cover.
2. Unscrew the pointed tip of the plunger of the AK9634M dial test indicator and screw into place the long or short gauge rod - depending upon the configuration of adaptors being used.
3. Ensure the extension pin is screwed firmly home.
4. Insert dial test indicator and extension into the adaptor(s) and retain with the thumbscrew. Screw into the service port of the pump.
5. Follow manufacturer's instructions for timing fuel injection pump.

NOTE: It is our policy to continually improve products and as such we reserve the right to alter data, specifications and component parts without prior notice.

IMPORTANT: No responsibility is accepted for incorrect use of this equipment.

WARRANTY: Guarantee is 12 months from purchase, proof of which will be required for any claim.

INFORMATION: For a copy of our latest catalogue and promotions call us on 01284 757525 and leave your full name and address, including postcode.