



## INSTRUCTIONS FOR

# VALET MACHINE WET & DRY 30LTR STAINLESS BIN

MODEL NO: **VMA915-O**

**IMPORTANT:** PLEASE READ THESE INSTRUCTIONS CAREFULLY. NOTE THE SAFE OPERATIONAL REQUIREMENTS, WARNINGS & CAUTIONS. USE THE PRODUCT CORRECTLY AND WITH CARE FOR THE PURPOSE FOR WHICH IT IS INTENDED. FAILURE TO DO SO MAY CAUSE DAMAGE AND/OR PERSONAL INJURY AND WILL INVALIDATE THE WARRANTY. KEEP THESE INSTRUCTIONS SAFE FOR FUTURE USE.



Refer to  
Instruction  
manual



Wear  
protective  
gloves



Wear  
protective  
clothing

## 1. SAFETY

### 1.1. Electrical Safety

- WARNING!** It is the user's responsibility to check the following:

Check all electrical equipment and appliances to ensure that they are safe before using. Inspect power supply leads, plugs and all electrical connections for wear and damage. Ensure the risk of electric shock is minimised by the installation of appropriate safety devices. An RCCB (Residual Current Circuit Breaker) should be incorporated in the main distribution board. We recommend that an RCD (Residual Current Device) is used with all electrical products. It is particularly important to use an RCD with portable products that are plugged into a supply not protected by an RCCB. If in doubt consult a qualified electrician. You may obtain an RCD by contacting your local dealer. Electrical safety information, it is important that the following information is read and understood.

- The Electricity at Work Act 1989 requires that all portable electrical appliances, if used on business premises, are tested by a qualified electrician, using a Portable Appliance Tester (PAT), at least once a year.
  - The Health & Safety at Work Act 1974 makes owners of electrical appliances responsible for the safe condition of those appliances and the safety of the appliance operators. If in any doubt about electrical safety, contact a qualified electrician.
  - Ensure that the insulation on all cables and on the appliance is safe before connecting it to the power supply. See 1.1.1. and use a Portable Appliance Tester.
  - Ensure that cables are always protected against short circuit and overload.
  - Regularly inspect power supply cables and plugs for wear or damage and check all connections to ensure that they are secure.
  - Important:** Ensure that the voltage rating on the appliance suits the power supply to be used and that the plug is fitted with the correct fuse - see fuse rating in these instructions.
- DO NOT** pull or carry the appliance by the power cable.
  - DO NOT** pull the plug from the socket by the cable. Remove the plug from the socket by maintaining a firm grip on the plug.
  - DO NOT** use worn or damaged cables, plugs or connectors. Ensure that any faulty item is repaired or replaced immediately by a qualified electrician.
- This product is fitted with a BS1363/A 13 Amp 3 pin plug.

If the cable or plug is damaged, remove from use and ensure that repairs are carried out by a qualified electrician. Replace a damaged plug with a BS1363/A 13A 3 pin plug. If in doubt contact a qualified electrician.

- Connect the GREEN/YELLOW earth wire to the earth terminal 'E'.
- Connect the BROWN live wire to the live terminal 'L'.
- Connect the BLUE neutral wire to the neutral terminal 'N'.
- After wiring, check that there are no bare wires and ensure that all wires have been correctly connected. Ensure that the cable outer sheath extends beyond the cable restraint and that the restraint is tight. Double insulated products are marked with the Class II symbol;  Class II products are wired with live (brown) and neutral (blue) only.

To rewire, connect the wires as indicated in diagram. **DO NOT** connect either wire to the earth terminal.

- Products which require more than 13 amps are supplied without a plug. Contact a qualified electrician to ensure that a suitably rated
- Supply is available. Ensure that an industrial round pin plug and socket are fitted by a qualified electrician.
- If an extension cable reel is used, ensure that it is fully unwound before connection. Use a reel that includes an RCD, an appliance will be protected by the RCD. The cable core section is important and should be at least 1.5mm<sup>2</sup>. Ensure that the cable of the reel is appropriate for this product. We recommend the use of 2.5mm<sup>2</sup> core section cable.

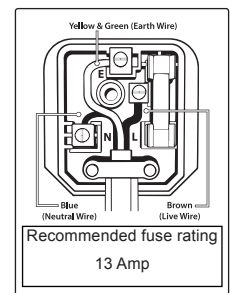

**GENERAL SAFETY**

Disconnect the machine from the power supply before servicing, changing accessories, or performing any maintenance.

- ✓ Use only genuine parts and accessories. Unauthorised parts and accessories may be dangerous and will invalidate your warranty
- ✓ Maintain the machine in good condition. Use an authorised agent for servicing. Keep machine clean, but **DO NOT** use solvents. Ensure the correct Sealey cartridge filter is firmly in place before operating the machine. Wrong cartridge filter may cause machine faults and will invalidate your warranty.
- ✗ **DO NOT** allow children or untrained persons to operate the machine.
- ✗ **DO NOT** place attachments close to your face (especially eyes, ears, etc). Do not point the hose end at other persons or animals.
- ▲ **DANGER! DO NOT** vacuum hot or glowing ash, cigarette ends, inflammable, explosive, corrosive or other dangerous substances.
- ✗ **DO NOT** operate the unit without the cartridge filter in place. (See section 6 regarding cartridge filters)
- ✗ **DO NOT** leave machine running unattended. Turn power supply OFF, and **DO NOT** leave the vicinity until motor has come to a complete stop.
- ✗ **DO NOT** operate the cleaner when you are tired or under the influence of alcohol, drugs or intoxicating medicines.
- ✗ **DO NOT** use the cleaner in the rain or in very damp conditions.
- ✓ When not in use, store the cleaner in a safe, dry, childproof location.
- ✗ **DO NOT** use the cleaner for a task it is not designed to perform.
- ✓ **Wear protective clothing and gloves. A full range of personal safety equipment is available from your Sealey dealer.**

**NOTE:** This appliance can be used by children aged from 8 years and above and persons with reduced physical, sensory or mental capabilities or lack of experience and knowledge if they have been given supervision or instruction concerning use of the appliance in a safe way and understand the hazards involved. Children shall not play with the appliance. Cleaning and user maintenance shall not be made by children without supervision.

**2. INTRODUCTION**

High powered unit ideal for cleaning carpets, car interiors, fabrics and upholstery. Supplied with carpet lance, hand held lance, full wet and dry vacuum accessory kit including stainless steel rigid extension tube, cartridge filter and foam filter. Large capacity drum with external detergent tank for easy filling. Features remote operation controls on nozzle enabling switching between vacuum and detergent modes uninterrupted. Fitted with two fixed wheels and two castors, cable storage hooks and accessory storage slots..

**3. CONTENTS AND SPECIFICATION**

Model No: .....	<b>VMA915-O</b>	Replacement Foam Filters: (Pack of 10) .....	PC200FF10
Motor: .....	1300W	Replacement Cartridge Filter:.....	PC310CF
Supply: .....	230V	Valeting Detergents .....	VMR921S 1Ltr or VMR925S 5Ltr
Drum Size:.....	30ltr		
Weight: .....	15kg		

Fig 1



**ITEM DESCRIPTION**

1. Main switch.
2. Mode selection buttons
3. Detergent pipe coupling.
4. Suction hose inlet.
5. Detergent tank connecting hose.
6. Detergent tank.
7. Drainage outlet.
8. Cartridge filter and lid.
9. Foam filter.
10. Nozzle.
11. Hand held lance.
12. Stainless steel extension tube.
13. Suction hose.
14. Crevice tool.
15. Round brush.
16. Combination floor brush.
17. Carpet lance.
18. Top section
19. Main drum



## 4. ASSEMBLY

- 4.1. Do not connect the mains plug yet.
- 4.2. Undo main drum clasps and lift off the top section (18).
- 4.3. Remove contents from inside the tank. Check and identify each component as listed in fig.1. If anything is missing or damaged please contact your supplier immediately.
- 4.4. Insert a large wheel on each side of the rear basket and ensure they are pushed all the way in.
- 4.5. Turn the main drum (19) upside down and insert the moulded castor mountings into their positions in the black base until they lock into position.
- 4.6. For dry suction fit the cartridge filter (8).
- 4.7. For carpet washing or wet suction fit the foam filter (9).
- 4.8. Re-assemble the top section (18) to the main drum (19).
- 4.9. Fasten the 2 clasps.
- 4.10. Attach the suction hose (13) to the suction inlet (4) on the front of the main drum.
- 4.11. Twist and lock the end of the suction hose (13) into the nozzle (10). Push the end of the nozzle (10) into the stainless steel extension tube (12). Fit the required accessory to the base of the stainless steel extension tube (12) or directly to the nozzle (10) if the stainless steel extension tube (12) is not required.

## 5. PROGRAMMING REMOTE CONTROL

- 5.1. Ensure the machine is plugged into the power supply with the power on.
- 5.2. Set the main switch (1) to the ('I') position.
- 5.3. Locate the detergent mode selection button (2) on the top section (18) indicated by the following symbol. 
- 5.4. Press and hold the detergent mode button until the indicator light above the mode selection buttons (2) illuminates.
- 5.5. With the light still illuminated, press and hold the detergent mode button on the nozzle (10).
- 5.6. When the light starts to flash the nozzle (10) is programmed to the machine. You should now be able to operate the detergent and vacuum modes using the nozzle (10).
- 5.7. If the light does not flash go back to step 5.4 and start again.

## 6. USING A CARTRIDGE FILTER

- WARNING!** Always disconnect the plug from the mains supply before removing the top section (18).
  - IMPORTANT:** The filter is made of high quality paper designed to filter small particles of dust. We recommend that this filter be used for dry vacuuming only.
- 6.1. The cartridge filter (8) must be completely dry when used to collect dry dust as a wet or damp filter will clog quickly and be very difficult to clean.
  - 6.2. Check the cartridge filter (8) carefully and regularly for tears or small holes. Even a small hole can cause dust to be exhausted. Never use a cartridge filter with holes or tears as this may cause damage to the motor and invalidate warranty. Replace it immediately.
- INSTALLING & CLEANING**
- 6.3. Slide cartridge filter (8) down over filter cage on the top section (18).
  - 6.4. Apply gentle pressure to the cartridge filter until it is fully located over the filter cage. Place the lid over the end of the cartridge filter, ensuring that the locking device on the lid locates into the hole in the filter cage. Turn the locking device on the lid clockwise until the lid and filter are locked on to the filter cage.
  - 6.5. To remove cartridge filter for cleaning, turn the locking device on the lid anti-clockwise to unlock the filter. Remove the lid, hold the base of the filter and gently pull it off the cage.
  - 6.6. Clean the filter by tapping it on the inside of a waste bin

## 7. DRY VACUUM CLEANING

- WARNING!** Ensure you read, understand and apply Sections 1 and 2 'Safety Instructions'.
  - Reminder: DO NOT** vacuum hazardous substances. Use of an incorrect cartridge filter will invalidate your warranty.
- 7.1. Ensure the machine is unplugged from the power supply.
  - 7.2. Fit the cartridge filter and lid (8) over the basket and lock in place. Attach a dust collection bag over the hose attachment on the inside of the main drum (19) if desired.
  - 7.3. Re-position the top section (18) onto the main drum (19), and clip in place.
  - 7.4. Insert the larger end of the suction hose (13) into the suction hose inlet (4) on the main drum (19) and screw in place.
  - 7.5. Twist and lock the nozzle (10) onto the free end of the flexible hose (13).
  - 7.6. Push the required attachment onto the free end of the nozzle (10).
  - 7.7. Plug into the power supply and set the main switch (1) to the 'I' position.
  - 7.8. Switch the motor to vacuum only mode, indicated by the following symbol,  using either the button (2) on the top section of the cleaner or the button on the nozzle (10).
  - 7.9. When you have completed vacuuming, switch off the cleaner by pressing either the vacuum button on the nozzle (10) or the button on the top section of the cleaner (2).
  - 7.10. Set the main switch (1) to the 'O' position and unplug machine from the power supply.

## 8. WET VACUUM CLEANING

- ❑ **WARNING!** Ensure you read, understand and apply Sections 1 and 2 'Safety Instructions'. Reminder: Remove plug from power supply before opening unit. **DO NOT** vacuum solvents, explosives, inflammable and/or hazardous liquids such as petrol, oil, spirits, paint, thinners, acids etc. Use of an incorrect filter will invalidate your warranty.
- 8.1. Ensure the machine is unplugged from the power supply. Make sure the main drum (19) is clean and free from dust and dirt.
- 8.2. For wet vacuum cleaning the foam filter (9) must be used.
- 8.3. When using the foam filter (9) first remove any cartridge filter (8) fitted. Ensure the foam filter (9) is clean and dry. Place the foam filter (9) over the filter cage and adjust carefully.
- 8.4. Fit the required accessories or tubes to the suction hose (13).
- 8.5. Ensure the main switch (1) is 'Off' (position 'O') before plugging into the power supply.
- 8.6. Set the main switch (1) to the 'I'. Press the vacuum selection mode button, indicated by the following symbol,  on either the nozzle (10) or the top section (2) and operate the machine.
- 8.7. When you have completed vacuuming, switch off the machine using either of the vacuum mode buttons. Set the main switch (1) to 'O', and unplug from power supply.
- 8.8. After use, empty the main drum (19) and dry.
  - ❑ **WARNING!** The main drum (19) is not designed for liquid storage. Always empty liquids after use. Never store the cleaner with liquid in the main drum (19).
- 8.9. To vacuum large quantities of liquid, from a sink or tank etc., do not immerse the nozzle completely in the liquid; leave a gap at the top of the nozzle opening to allow an air inflow. The machine is fitted with a float valve which blocks the suction action when the tank has reached its maximum capacity. The user will notice an increase in motor noise. When this happens, turn off the machine, disconnect from power supply, remove cap from the drainage outlet (7) on the main drum and empty the liquid into a suitable receptacle or drain. To continue vacuuming, refit the drainage outlet cap (7) and proceed. After wet vacuuming, turn the machine off and remove plug from power supply. Empty the main drum (19) from the drainage outlet (7) and clean/dry the inside and outside before storage.

## 9. CARPET/UPHOLSTERY CLEANING

### SET-UP

- 9.1. Water, mixed with a suitable carpet detergent solution, is pumped deep into the fibres of the carpet via the detergent application nozzle. The dirty liquid is then sucked back into the main drum (19) along with the dirt and grime dislodged by the cleaning solution. Water can be pumped up to 2 metres above the machine so that stairs may also be cleaned.
  - ❑ **WARNING!** Ensure you read, understand and apply Sections 1 and 2 'Safety Instructions'.
- 9.2. Reminder: **DO NOT** vacuum hazardous substances.
- 9.3. Ensure the machine is unplugged from the power supply.
- 9.4. Fit the foam filter (9).
- 9.5. Reposition the top section (18) onto the main drum (19) and clip in place.
- 9.6. Ensure that the detergent solution has been mixed with the recommended proportion of water and pour it into the detergent tank (6).
- 9.7. Plug the connector on the end of the detergent tank connecting hose (5) into the detergent inlet coupling on the rear of the top section (18).
- 9.8. Ensure that the transparent detergent delivery tube is fitted around the suction hose (13).
- 9.9. Screw the large threaded connector on the end of the suction hose (13) to the suction hose inlet (4).
- 9.10. Push the connector on the end of the detergent delivery tube into the detergent pipe coupling (3) on the front of the top section (18).
- 9.11. Twist and lock the nozzle (10) onto the free end of the suction hose (13). Twist and lock the detergent delivery tube to the nozzle (10). Fit the carpet lance (17) to the stainless steel extension tube (12) and attach the stainless steel extension tube (12) to the nozzle (10). Connect the detergent delivery tube from the carpet lance (17) to the nozzle (10). The grey fitting is a push and twist fit.
- 9.12. The spraying nozzle at the other end of the delivery tube is a push fit into the mounting on the underside of the carpet lance. There is a notch in the nozzle which must fit onto a spigot in the lance mounting to ensure that the nozzle outlet is the right way round. To clean fabrics and upholstery clip the spray nozzle with the short tube into the underside of the hand held lance (11). Push the assembled hand held lance (11) onto the nozzle (10). Note: The stainless steel extension tube (12) is not used.
- 9.13. Select the detergent mode, indicated by the following symbol,  to operate the machine for detergent application only.
- 9.14. Select both the detergent mode and vacuum mode for simultaneous detergent application and dirty liquid suction.

### CARPET/UPHOLSTERY CLEANING

- 9.15. Vacuum the carpet/upholstery thoroughly before washing it. For carpet cleaning we recommend you first remove all furniture from the room to be cleaned, or move it away from the cleaning area. Clean the whole carpet systematically in squares of approximately 1.5m each. This avoids walking over the cleaned carpet until it is completely dry.
- 9.16. Start furthest away from the doorway to the room, extend the hose and work backwards.
- 9.17. Select detergent mode, indicated by the following symbol,  to spray detergent into the area to be cleaned.
- 9.18. Pull the carpet lance (17) back towards you, in lengths of approx 1.5m. Refill the detergent tank (6) if the fluid spray stops.
- 9.19. Switch off and return to where you started.

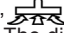
- 9.20. Select the vacuum mode, indicated by the following symbol,  to suck up the dirty solution and repeat the previous pattern of strokes. Apply more detergent in any particularly dirty area. The dirty solution is visible as it is sucked up through the carpet lance (17). Stop vacuuming when there is no more dirty fluid visible. Do not walk over any newly cleaned area until it is completely dry.
- 9.21. The hand held lance (11) is ideal for cleaning sofas, chairs, stairs and car interiors.
- WARNING! DO NOT** replace furniture until the carpet is completely dry!
  - WARNING! DO NOT** run the pump when there is no detergent in the detergent tank (6).
  - WARNING!** The motor noise changes to a higher pitch when the main drum (19) is full or blocked. Stop the machine immediately and empty the main drum (19).
  - WARNING!** Always use a low foam detergent (Sealey part no: VMR921S) or use a de-foaming agent (Sealey part no: VMR922S).
- STORAGE:**
- 9.22. Prior to storage, following steps should be taken:
- 9.23. Remove the carpet lance (17) and use the end of the stainless steel extension tube (12) to suck up any remaining liquid. Run the machine until the tubes and suction hose (13) are clean and dry.
- 9.24. Switch off the machine and unplug from the power supply. Empty the main drum (19) using the drainage outlet (7) and empty the detergent tank (6).
- 9.25. Remove the foam filter (9) to dry. Refit for further wet suction. For dry vacuuming, fit a dry cartridge filter (8).
- WARNING!** Always use low foaming shampoo VMR921S 1 litre or VMR925S 5 litre .

## 10. MAINTENANCE

### 10.1. GENERAL MAINTENANCE.

- 10.2. Ensure the machine is unplugged from the power supply.
- 10.3. Disconnect the suction hose (13) from the main drum (19).
- 10.4. Undo the clasps and remove top section (18) from the main drum (19).
- 10.5. Clear out any dirt or debris from the main drum (19) and hose (13).
- 10.6. Clean the foam filter (9) by washing it in a mild soapy solution.
- 10.7. Check that the stainless telescopic tube (12) operates smoothly, and check the power cable to make sure it has not received any damage.

### CARTRIDGE FILTER MAINTENANCE. (SEE ALSO SECTION 7)

- 10.8. Handle the cartridge filter carefully (8) when cleaning or installing.
- 10.9. Carefully remove the cartridge filter (8) and inspect it for damage. A filter that has small holes or tears in it will not perform efficiently and should be replaced.
- 10.10. Trouble
- 10.11. To clean a dry filter, tap it inside a waste bin.
- 10.12. Do not use a wet cartridge filter for dry vacuuming as the filter will clog quickly. To clean a wet cartridge filter it should be rinsed from the inside and allowed to air dry for 24 hours.
- 10.13. To fit a new/cleaned filter, slide it over the filter basket, push it fully home and lock in place with the lid.

### REPLACING REMOTE CONTROL BATTERY. (SEE FIG.2)

- 10.14. Carefully push the hook at the front of the battery cover and lift until the battery cover is released.
- 10.15. Remove the old battery.
- 10.16. Insert the new battery with the terminals in the direction shown inside the battery compartment.
- 10.17. Replace the battery cover.

- ▲ **IMPORTANT:** Only replace the battery with a 23AE 12V Alkaline battery.

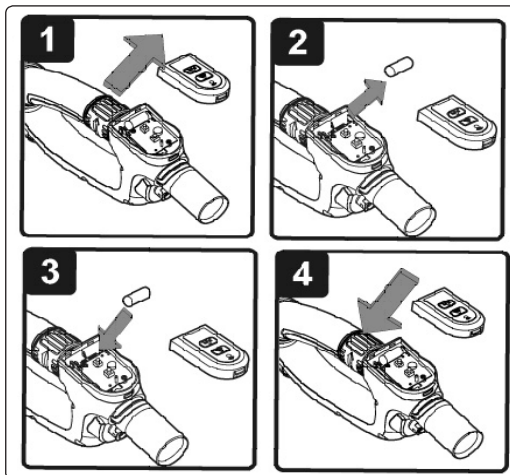

Fig 2

## 11. TROUBLESHOOTING

Machine will not operate.	No power supply. Faulty power cable, switch or motor. Main drum full of liquid.	Check supply. Check and repair or replace Empty main drum.
Dust comes from the motor cover.	Filter missing or damaged.	Fit or replace dust filter.
Reduced efficiency and increased motor speed/vibration.	Filter clogged. Nozzle, hose or tank inlet blocked.	Clean or replace filter. Check nozzle, hose and tank inlet for blockage.
No solution spraying out.	Detergent mode not selected. Detergent tank is empty. Incorrectly fitted pipes.	Press the detergent mode button. Add more detergent. Check fittings and connections. Ensure there are no kinks in tubes.

## 12. CONSUMABLES

Cartridge Filter (Must be used for dry vacuuming) .....Model No. PC310CF

Foam Filter (Pack of 10).....Model No. PC200FF10

**▲ IMPORTANT! IF THE MACHINE IS USED WITHOUT A CARTRIDGE FILTER FITTED THE MOTOR WILL BURN OUT**

**EVENTUALLY AND YOUR GUARANTEE WILL BE INVALIDATED. ALWAYS KEEP A SPARE CARTRIDGE FILTER HANDY.**

Dust Bags (Pack of 5) Optional Extra.....Model No. PC300PB5



### Environmental Protection

Recycle unwanted materials instead of disposing of them as waste. All tools, accessories and packaging should be sorted, taken to a recycling centre and disposed of in a manner which is compatible with the environment.



### WEEE Regulations

Dispose of this product at the end of its working life in compliance with the EU Directive on Waste Electrical and Electronic Equipment (WEEE). When the product is no longer required, it must be disposed of in an environmentally protective way. Contact your local solid waste authority for recycling information.



### Battery Regulations

For battery removal, see section 10.13 - 10.14

**NOTE:** It is our policy to continually improve products and as such we reserve the right to alter data, specifications and component parts without prior notice.

**IMPORTANT:** No liability is accepted for incorrect use of this product.

**WARRANTY:** Guarantee is 12 months from purchase date, proof of which will be required for any claim.



Unit 43 Churchill Way  
Lomeshaye Industrial Estate  
Nelson  
Lancashire  
BB9 6RT