

6. PARTS LIST & ASSEMBLY

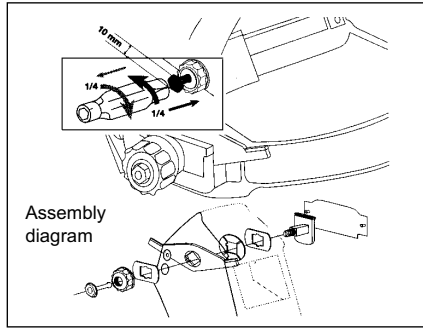

SWH599 PARTS DIAGRAM

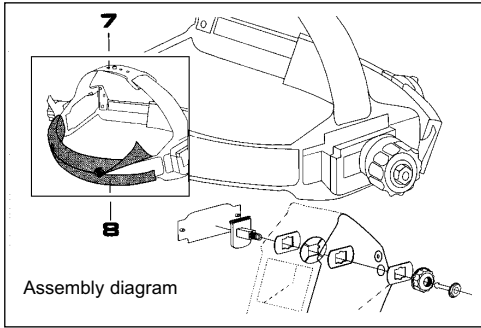
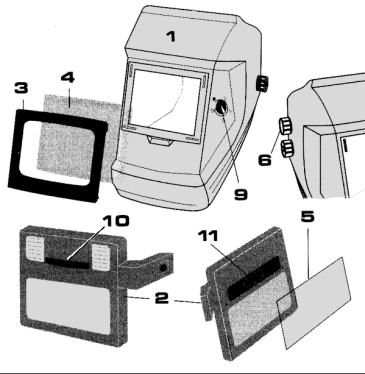

PARTS LIST

1. Welding mask
2. Shade cartridge
3. Front lens frame
4. Front cover lens
5. Inside cover lens for shade cartridge
6. eccentric knob
7. Headband with fasteners
8. Sweat band
9. Potentiometer knob
10. Sensor bar
11. Off delay knob

CE Declaration of Conformity We, the sole importer into the UK, declare that the product listed here is in conformity with the following EEC standards and directives. The construction file for this product is held by the Manufacturer and may be inspected on request by contacting Jack Sealey Ltd

Automatic Welding Helmet
Model SWH599

BS EN 175:1997 BS EN 379:1994
BS EN 169:2002

Signed by Mark Sweetman  16th July 2003



For Jack Sealey Ltd. Sole importer into the UK of Sealey Power Products

NOTE: It is our policy to continually improve products and as such we reserve the right to alter data, specifications and component parts without prior notice.

IMPORTANT: No liability is accepted for incorrect use of this equipment. **WARRANTY:** Guarantee is 12 months from purchase date, proof of which will be required for any claim. **INFORMATION:** Call us for a copy of our latest catalogue on 01284 757525 and leave your full name and address including your postcode.

SEALEY POWER WELDERS

Sole UK Distributor
Sealey Group, Bury St. Edmunds, Suffolk.

 01284 757500  01284 703534 **E-mail:** sales@sealey.co.uk

SEALEY
POWER WELDERS

Instructions For: AUTOMATIC WELDING HELMET Model: SWH599

Thank you for purchasing a Sealey Power Product. Manufactured to a high standard this product will, if used according to these instructions and properly maintained, give you years of trouble free performance.

IMPORTANT: PLEASE READ THESE INSTRUCTIONS CAREFULLY. NOTE THE SAFE OPERATIONAL REQUIREMENTS, WARNINGS AND CAUTIONS. USE THIS PRODUCT CORRECTLY AND WITH CARE FOR THE PURPOSE FOR WHICH IT IS INTENDED. FAILURE TO DO SO MAY CAUSE DAMAGE OR PERSONAL INJURY, AND WILL INVALIDATE THE WARRANTY. PLEASE KEEP INSTRUCTIONS SAFE FOR FUTURE USE.

The SWH599 Automatic Welding Helmet comes ready for use. Batteries are not necessary as operation is by means of Solar cells which automatically darkens the eye shade cartridge when the arc is struck.

1. SAFETY INSTRUCTIONS

Ensure all workshop safety rules, regulations, and conditions are complied with when using welding equipment. The helmet will not offer protection against mis-use of workshop tools, equipment, or accessories. Maintain the helmet in good condition, and protect cartridge from liquid and dirt contact. Regularly replace the protective lenses and replace any damaged or worn parts. *Use genuine parts only. Non authorised parts may be dangerous and will invalidate the warranty.* NEVER open or tamper with the shade cartridge.

WARNING! This helmet is not suitable for use with laser and gas-welding. Ensure the front cover lens and front lens frame are securely in place before use.

Select the shade level before use. Fit the helmet and adjust the head band so the helmet will sit as low and near to your face as possible. Use helmet only in temperatures ranging from -10°C (+14°F) and +70°C (+158°F). The eye protective plate in helmet is **NOT** unbreakable. Helmet will not protect you against severe impact hazards (*such as, but not limited to*) fragmenting abrasive discs/grinding wheels, stones and other grinding tools, explosive devices or corrosive fluids. The helmet will only protect the eyes and face from radiation and sparks. Remove ill fitting clothing, remove ties, watches, rings, and other loose jewellery. Maintain correct balance and footing. Ensure the floor is not slippery and wear non slip shoes. Keep children and unauthorised persons away from the working area.

WARNING! DO NOT use the helmet if damaged or you suspect it may be faulty. (Contact Service Agent). DO NOT use helmet unless you have been instructed in its use by a qualified person. DO NOT get the helmet wet or use in damp or wet locations. DO NOT leave work place with helmet in lowered position, as bright light source may darken cartridge unexpectedly. DO NOT place the helmet on a hot surface. Clean helmet (see chapter 4) smf store the helmet in a safe, dry, childproof location.

▲ DANGER! If, at any time, the face plate in the cartridge FAILS to darken when exposed to a welding spark, DO NOT USE. Remove cartridge and return to your dealer for service/inspection. Continued use of the product knowing that the auto darkening feature is not functioning may damage your eyes and cause blindness. Continued use of the helmet which is not functioning will invalidate the warranty and could prohibit a successful claim on any insurance policy.

2. SPECIFICATIONS & TECHNICAL DATA

Field of vision98 x 40mm (3.86" x 1.57").
When activated:Infinitely variable manual adjustment of shade levels DIN 9-13
When not activatedShade level DIN 4.
Response (light to dark)0.4ms at room temperature
Response (dark to light)● Position slow = 0,3 - 0,6s
..... .● Position fast = 0,1 - 0,35s
Operating temperature-10°C (+14°F) and +70°C (+158°F).
Power supplySolar cells
Water-resistantIP76 (test duration 30min. depth 1 m/3,28' (except potentiometer)).
Helmet materialHigh-impact plastic
Weight Helmet480g
..... Cartridge110g
Tig WeldingAll Amperages

3. INSTRUCTIONS FOR USE

IMPORTANT: The quick response time of the helmet eye shade will protect your eyes from ultraviolet and infrared rays, regardless of the level the shade is set to.

WARNING! you have read and understood chapter 1. safety instructions.

- 3.1. Check that the front lens cover and frame are securely in place.
- 3.2. Select the shade level you required according to the welding process you will use by referring to the "Selection Chart" for settings. Turn the potentiometer control on the side of the helmet to the number required, (fig 1).
- 3.3. Adjust the switching time (fig 2) of the shade cartridge (the time it will take for the shade to turn from light to dark and dark to light) by mean of the delay switch inside the helmet. Again adjust the time according to the welding process you will use, in order to protect your eyes against the residual light to the after glow or work materials. See technical data for response times.
- 3.4. Adjust the headband so the helmet is seated on the head as low as possible, and near your face (fig 3). Depress the headband ratchet knob at the rear (fig 4) until the headband and sweat band (fig 5) sit firmly in place, but not too tight.
- 3.5. When in lowest position, adjust angle of helmet by turning the angle knob (fig 6).
- 3.6. If necessary adjust the eye distance by loosening the locking knobs and adjusting so the shade is the same distance from both eyes. re-tighten the knobs. (fig 7).

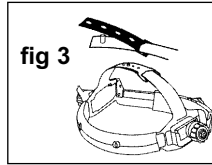
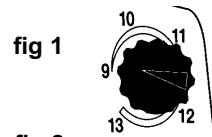

- 3.7. You are now ready to use the helmet. The shading may be adjusted during use by re-setting potentiometer control (fig 1).

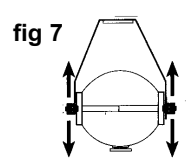
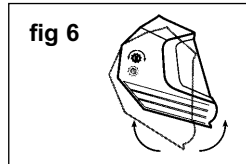
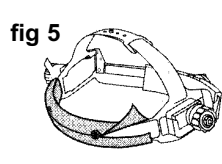
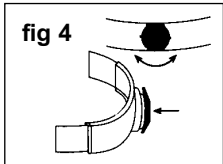

SELECTION CHART	amps																							
	0,5	2,5	10	20	40	80	125	175	225	275	350	450	1	5	15	30	60	100	150	200	250	300	400	500
					9	10		11		12		13												
							10	11		12		13												
							10	11		12		13												
			9	10		11		12		13														
						10	11	12		13														
								10	11	12	13													
									11	12	13													
		5	6	7	8	9	10																	

4. PROBLEM SOLVING

▲ DANGER! If, at any time, the face plate in the cartridge **FAILS** to darken when exposed to a welding spark, **DO NOT USE**. Remove cartridge and return to your dealer for service/inspection. Continued use of the product knowing that the auto darkening feature is not functioning may damage your eyes and cause blindness. Continued use of the helmet which is not functioning will invalidate the warranty and could prohibit a successful claim on any insurance policy.

IRREGULAR DARKENING OR DIMMING.	The headband may have been unevenly set on the two sides of the helmet (unequal distances from the eyes to the shade cartridge).	Readjust the distance of the shade.
SHADE CARTRIDGE DOES NOT DARKEN OR FLICKERS.	The sensors are soiled or obstructed. The sensor bar is tilted Front cover lens oiled or damaged. Welding current too low.	Clean Correct Clean or replace Adjust weld amps
POOR VISION	Operative lenses and/or shade cartridge soiled. Insufficient ambient light. Shade level incorrectly set.	Check clean or replace Adjust light Correct ¹
SLOW RESPONSE	Operating temperature too low	do not use at temperatures below -10° C (+14°F) .
WELDING HELMET SLIPS	Headband not adjusted correctly.	Lower the helmet and refer to chapter 3.

5. MAINTENANCE

Replacing front cover lens.

Hold front lens frame at the bottom edge and pull up. Remove old lens and insert a new one. Snap the front lens frame into place at the top first then at the bottom. Press firmly into place (fig A).

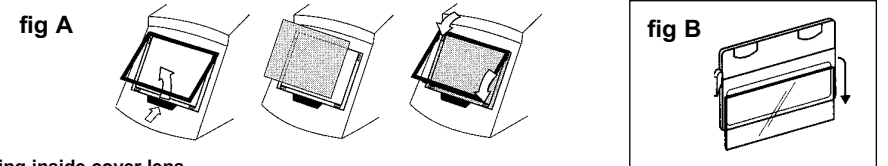

Replacing inside cover lens.

Lift lens with finger nail and then slide it out of the guideways. Replace with new lens (fig B).

Sweat Band

Regularly remove the sweat band wash and replace.

Sensor Bar

Pitch the bar downward and pull it out. Reverse the action to replace (fig C).

Changing the shade cartridge

Position the potentiometer control knob to number 9 and pull the knob out. Turn locking knobs and tilt shade cartridge out of place. Reverse procedure to insert new cartridge (fig D).

Cleaning

Clean the helmet by wiping with a soft clean cloth. Clean the cartridge surfaces regularly but do not use strong cleaning solutions.

Clean the sensors and solar cells with methylated spirit and a clean cloth and wipe dry with a lint-free cloth.

