

Thank you for purchasing a Sealey product. Manufactured to a high standard this product will, if used according to these instructions and properly maintained, give you years of trouble free performance.



IMPORTANT

BEFORE USING THIS PRODUCT, PLEASE READ THE INSTRUCTIONS CAREFULLY. MAKE CAREFUL NOTE OF SAFETY INSTRUCTIONS, WARNINGS AND CAUTIONS. THIS PRODUCT SHOULD ONLY BE USED FOR ITS INTENDED PURPOSE. FAILURE TO DO SO MAY CAUSE DAMAGE OR PERSONAL INJURY, AND WILL INVALIDATE THE WARRANTY.

(The use of symbols in this document is to attract your attention to possible danger. The symbols and warnings themselves do not eliminate any danger, nor are they substitutes for proper accident prevention measures).

1. SAFETY INSTRUCTIONS

- 1.1 ELECTRICAL SAFETY.**  **WARNING! IT IS THE USER'S RESPONSIBILITY TO ENSURE THAT:**
- All electrical equipment and appliances are safe before using. You must inspect power supply leads, plugs and all electrical connections for wear and damage. You must ensure the risk of electric shock is minimised by the installation of devices such as a "residual current device" (RCD) on the power supply. These are available from Sealey order part no: "RCD981" for socket type, and "RCD982" for plug type. **You must read and understand the following instructions concerning electrical safety.**
- 1.1.1. The **Electricity At Work Act 1989** requires all portable electrical appliances, *if used on a business premises*, to be tested with, or by, a qualified person at least once each year by using a Portable Appliance Tester (PAT).
- 1.1.2. The **Health & Safety at Work Act 1974** makes owners of electrical appliances responsible for the safe condition of the appliance, and the safety of the appliance operator. **If in any doubt about electrical safety, contact a qualified electrician.**
- 4 Ensure that cables are always protected against short circuit and overload.
- 4 Ensure that the insulation on the cables and the product is safe prior to connection with the mains supply.
- 4 Connect the fan to the correct capacity power supply and check that all fused plugs are fitted with the correct capacity fuse (3 amp).
DO NOT pull, or carry the powered appliance by its power supply lead.
- 7 DO NOT pull power plugs from sockets by the power cable.
- 7 DO NOT use worn or damage leads, plugs or connections. Immediately replace or repair by qualified persons. A U.K. 3 pin plug with ASTA/BS approval is fitted. In case of damage, cut off and fit a new plug according to the following instructions (UK only - see diagram at right).
- Ensure the unit is correctly earthed by using a three-pin plug.
 - Connect the GREEN/YELLOW EARTH wire to the EARTH terminal 'E'.
 - Connect the BROWN LIVE wire to LIVE terminal 'L'.
 - Connect the BLUE NEUTRAL wire to the NEUTRAL terminal 'N'.
- 1.2 GENERAL SAFETY**
- 3 Disconnect the fan from the mains power when not in use, and before servicing or performing other maintenance.
- 3 Place the fan in a dry area. Do not place it near wet areas such as bathtubs, hot tubs or pools. If the fan has fallen into water, immediately switch off the power supply. Do not touch the fan until the mains power supply has been switched off.
- 3 Always disconnect the fan from the power supply when moving it from one location to another.
- 3 Maintain the fan in good condition (use an authorised service agent).
- 3 Use recommended accessories only (non recommended accessories can be hazardous, and will invalidate your warranty).
- 7 DO NOT insert any objects, including body parts, into the fan grille when the fan is connected to the power supply.
- 7 DO NOT cover the grille.
- 7 DO NOT immerse the fan in water or any other liquid.
- 7 DO NOT allow children to operate the fan.
- 7 DO NOT use the fan outdoors.
- 7 DO NOT use an extension cord unless it has been approved by an electrical authority.

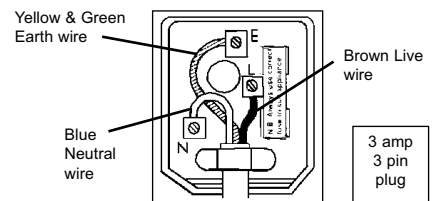

2. OPERATION

- 2.1. Assemble the fan.
- Separate the base parts and pass the power cord through the hole.
 - Attach the base parts with the cord in the centre hole.
 - Attach the base to the fan with the screws provided.
- 2.2. Place the fan in a suitable location and attach to the power supply.
- 2.3. Press the switch buttons to generate the desired speed.
- 2.4. To make the fan oscillate, push the oscillating switch, on the top of the fan, down. To stop the fan oscillating, press the switch again.
- 2.5. To adjust the direction the fan blows, turn the grille to any of five horizontal angles.
- 2.6. To use the timer, set it for the desired time (in minutes). The fan will automatically switch off when the time has expired. When not using the timer, set the switch to the 'ON' position. When the timer switch is in the 'OFF' position, the fan will not operate even by using the switch buttons (2.3).

3. MAINTENANCE

- 3.1. Use a soft tissue or cloth to clean the body. Use soapy water for tough dirt and grime. Do not use benzine thinner or other solvents.
- 3.2. Use a vacuum cleaner to clean the fan (the front guard is removed by removing the screws at the bottom then pulling up and out carefully - the rear grille assembly is removed by removing the screws at the back top and lifting the assembly out and up). Use a brush to clean difficult areas. Do not remove the fan from the case.
- 3.3. To keep the fan clean and prolong its life, do not use it in an area where oil can stain the fan (such as kitchens). Exposure to oil can damage or deteriorate the fans parts.

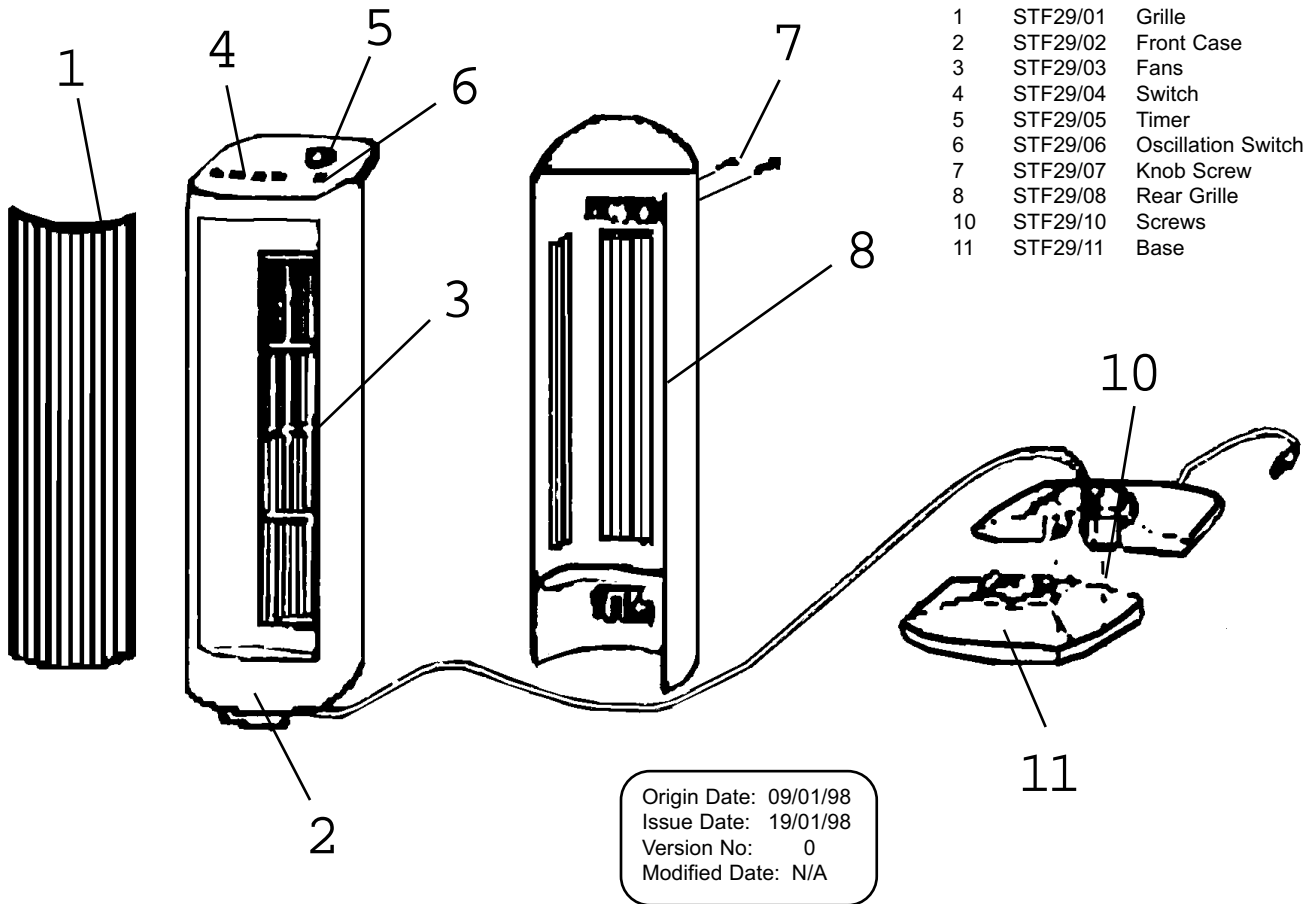

Item	Part No.	Description
1	STF29/01	Grille
2	STF29/02	Front Case
3	STF29/03	Fans
4	STF29/04	Switch
5	STF29/05	Timer
6	STF29/06	Oscillation Switch
7	STF29/07	Knob Screw
8	STF29/08	Rear Grille
10	STF29/10	Screws
11	STF29/11	Base

Origin Date: 09/01/98
Issue Date: 19/01/98
Version No: 0
Modified Date: N/A

Declaration of Conformity

We, the sole importer into the UK, declare that the product listed below is in conformity with the following EEC standards and directives.

Tower Fan Model No: STF29

89/336/EEC
Electromagnetic Compatibility

73/23/EEC
Low Voltage Directive



The construction file for this product is held by the Manufacturer and may be inspected on request by contacting Jack Sealey Ltd.

Signed by John Sealey

Date 1st January 1998

For Jack Sealey Ltd.
Sole importer into the UK of Sealey Power Products

IMPORTANT

NO RESPONSIBILITY IS ACCEPTED FOR INCORRECT USE OF THIS EQUIPMENT.

WARRANTY

GUARANTEE IS 12 MONTHS FROM PURCHASE DATE. PROOF OF PURCHASE WILL BE REQUIRED FOR ANY CLAIM.

INFORMATION

PLEASE CALL US FOR A COPY OF OUR LATEST CATALOGUE.

