

Thank you for purchasing a Sealey product. Manufactured to a high standard this item will give you years of trouble free performance if these instructions are carefully followed and the product is correctly maintained.



**IMPORTANT: PLEASE READ THESE INSTRUCTIONS CAREFULLY. NOTE THE SAFE OPERATIONAL REQUIREMENTS, WARNINGS AND CAUTIONS. USE THIS PRODUCT CORRECTLY AND WITH CARE FOR THE PURPOSE FOR WHICH IT IS INTENDED. FAILURE TO DO SO MAY CAUSE DAMAGE AND/OR PERSONAL INJURY AND WILL INVALIDATE THE WARRANTY. PLEASE RETAIN THESE INSTRUCTIONS FOR FUTURE USE.**

### 1. SAFETY INSTRUCTIONS

#### 1.1. ELECTRICAL SAFETY

**WARNING!** It is the responsibility of the owner and the operator to read, understand and comply with the following: You must check all electrical products, before use, to ensure that they are safe. You must inspect power cables, plugs, sockets and any other connectors for wear or damage. You must ensure that the risk of electric shock is minimised by the installation of appropriate safety devices. A Residual Current Circuit Breaker (RCCB) should be incorporated in the main distribution board. We also recommend that a Residual Current Device (RCD) is used. It is particularly important to use an RCD with portable products that are plugged into a supply which is not protected by an RCCB. If in any doubt consult a qualified electrician. You may obtain a Residual Current Device by contacting your Sealey dealer.

**You must also read and understand the following instructions concerning electrical safety.**

- 1.1.1. The **Electricity at Work Act 1989** requires that all portable electrical appliances, if used on business premises, are tested by a qualified electrician, using a Portable Appliance Tester (PAT), at least once a year.
- 1.1.2. The **Health & Safety at Work Act 1974** makes owners of electrical appliances responsible for the safe condition of those appliances and the safety of the appliance operators. **If in any doubt about electrical safety, contact a qualified electrician.**
- 1.1.3. Ensure that the insulation on all cables and on the appliance is safe before connecting it to the power supply. See 1.1.1. and 1.1.2. and use a Portable Appliance Tester.
- 1.1.4. Ensure that cables are always protected against short circuit and overload.
- 1.1.5. Regularly inspect power supply cables and plugs for wear or damage and check all connections to ensure that none are loose.
- 1.1.6. **Important:** Ensure that the voltage marked on the appliance matches the power supply to be used and that the plug is fitted with the correct fuse - see fuse rating at right.
- 1.1.7. **DO NOT** pull or carry the appliance by the power cable.
- 1.1.8. **DO NOT** pull the plug from the socket by the cable.
- 1.1.9. **DO NOT** use worn or damaged cables, plugs or connectors. Immediately have any faulty item repaired or replaced by a qualified electrician. When a BS 1363/A UK 3 pin plug is damaged, cut the cable just above the plug and **dispose of the plug safely**. Fit a new plug according to the following instructions (UK only) and see right.

Subject to 1.1. above, the following details the fitting of a 13 amp plug since a 13 amp supply will be adequate when starting small engines. No responsibility is accepted in the event that the product is misused and/or used on a 13 amp supply when a 30 amp supply is required.

a) Connect the **GREEN/YELLOW** earth wire to the earth terminal 'E'.

b) Connect the **BROWN** live wire to the live terminal 'L'.

c) Connect the **BLUE** neutral wire to the neutral terminal 'N'.

d) **After wiring, check that there are no bare wires, that all wires have been correctly connected, that the cable outer insulation extends beyond the cable restraint and that the restraint is tight.**

Double insulated products, which are always marked with this symbol , are fitted with live (brown) and neutral (blue) wires only. To rewire, connect the wires as indicated above - **DO NOT** connect either wire to the earth terminal.

- 1.1.10. **Products which require more than 13 amps are supplied without a plug. In this case you must contact a qualified electrician to ensure that a suitably rated supply is available. We recommend that you discuss the installation of an industrial round pin plug and socket with your electrician.**

- 1.1.11. If an extension reel is used it should be fully unwound before connection. A reel with an RCD fitted is preferred since any appliance plugged into it will be protected. The cable core section is important and should be at least 1.5mm<sup>2</sup>, but to be absolutely sure that the capacity of the reel is suitable for this product and for others which may be used in the other output sockets, we recommend the use of 2.5mm<sup>2</sup> section cable.

#### 1.2. GENERAL SAFETY

- WARNING!** Disconnect the mains power before servicing or performing any maintenance.
- ✓ Disconnect from the mains power before connecting to, or disconnecting from, the battery.
- ✓ Maintain START1224 in good condition (use an authorised service agent only).
- ✓ Keep START1224 clean for best and safest performance.
- WARNING!** Ensure that there are no sources of flammable ignition near the work area i.e. naked flames, cigarettes, flame heaters, etc., as the process produces explosive gases.
- WARNING!** Ensure that the work area is well ventilated as the gases produced are flammable.
- ✓ Locate the START1224 in a suitable work area and keep the area clean and tidy and free from unrelated materials. Ensure adequate lighting.
- ✓ Wear approved safety eye protection (standard spectacles are not adequate).
- ✓ Remove ill fitting clothing. Remove ties, watches, rings and other loose jewellery and contain long hair.
- ✓ Read the vehicle handbook to check for any specific battery charging or jump-starting information.
- ✓ Check the electrolyte fluid level in the battery is above the plates. If not, add distilled water to cover them by 5-10mm. **DO NOT** touch the battery fluid as it is corrosive.
- ✓ Clean clamps and battery terminals, removing any oxidation before connecting the START1224 to the battery.
- ✓ Ensure that the correct polarity clamp is attached to the correct terminal of the battery. **POSITIVE** is indicated by (+) and may be red, **NEGATIVE** is indicated by (-) and may be black.

If there are no identifiable symbols, you can distinguish the **NEGATIVE** battery terminal as the one which is connected from the battery directly to the vehicle body. (**For negative vehicles only, for positive Earth vehicles consult the vehicle handbook for the correct connection procedure.**)

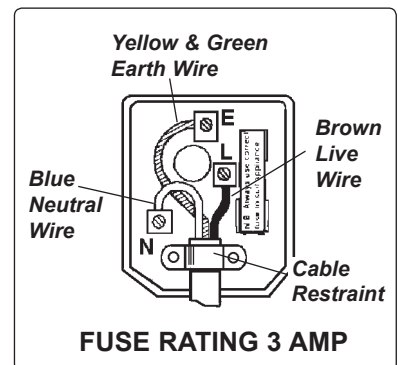

- ✓ Keep children and unauthorised persons away from the work area.
- x DO NOT connect a non-rechargeable battery.
- x DO NOT use the START1224 for any purpose other than that for which it is designed.
- x DO NOT allow untrained persons to operate the START1224.
- x DO NOT allow the START1224 terminal clamps to touch each other when the power is on. Remember that gases are produced which may ignite if sparks occur.
- x DO NOT place the START1224 inside the vehicle.
- x DO NOT get the START1224 wet or use in damp or wet locations or areas where there is condensation.
- x DO NOT operate the START1224 if it is damaged.
- x DO NOT attempt to open or modify the START1224.
- ✓ When not in use, unplug from the mains power supply and store in a safe, dry, child proof area.
- ❑ **WARNING!** Be vigilant and cautious during battery charging as the electrolyte is highly corrosive and the gases emitted are flammable and harmful to health.



## 2. SPECIFICATIONS

Heavy-duty, rechargeable starter. Portability of this unit makes it ideal for use in garages, workshops or body shops where space is limited or mains supply is not easily accessible. Features 12V output, which allows START1224 to be used as a power source or maintaining voltage in circuits while battery is being changed in vehicle. Voltmeter indicates charge status of internal battery.

Cold Cranking Amps	600A
Peak Amps	1500A
Voltage	12/24V
Auxiliary Output	12V
Cable & Clamp Length	1.8mtr
Weight	20kg

## 3. OPERATION

❑ **WARNING!** Electrical shock can cause death or injury. Avoid touching exposed conductors of electricity. The START1224 system is designed for use with vehicle or boats. You will not need a host vehicle or 230VAC power supply. You can also use this system as a portable power source of 12VDC in remote areas or emergencies.

### 3.1 To use the START1224 system to start your vehicle.

- 3.1.1 Make sure ignition switch of the vehicle to be started is not switched on.
- 3.1.2 Connect the red clamp to the positive terminal on the vehicle's battery.
- 3.1.3 Connect the black clamp to a non moving metal part of the engine, not to the negative terminal.
- 3.1.4 Turn the ignition switch of the vehicle ON. Wait for about a minute. Turn the engine over for no more than 5 to 6 seconds. If the vehicle engine does not start, wait at least for 3 minutes before retrying.

❑ **WARNING!** Never allow the red and black clamps to touch each other or a common conductor.

- 3.1.5 When engine is running, always disconnect the appliance in the following order:
  1. The black clamp (negative).
  2. The red (positive) clamp from the vehicle.
  3. The positive cable from START1224 terminal (+12V / +24V) (FIG.A Item 6-7).

NOTE! Recharge as soon as possible your START1224 system.

### ❑ IMPORTANT WARRANTY INFORMATION:

The battery pack fitted to this cordless tool is considered to be a consumable item and its ability to accept charge will reduce over time. We will warranty it against mechanical and electrical defect for a period of one year - this does not cover fair wear and tear. If the battery is not properly charged before first use, or regularly conditioned, its capacity will diminish. Under these circumstances we will not replace the battery pack even if it is less than one year old.

### 3.2 To use your START1224 system to power an appliance.

❑ **WARNING!** 12V OUTPUT ONLY!

- 3.2.1 In the event of overload the resettable safety switch triggers. To restore operation remove the cause of overload and press the button shown in FIG. A Item 10.
- 3.2.2 Lift up the cover of the cigarette lighter receptacle (FIG. A Item 4).
- 3.2.3 Insert the cigarette lighter plug from the appliance into the cigarette lighter receptacle (FIG. A Item 4).

### 3.3 RECHARGING THE START1224.

**Important!** To maintain the reliability of the battery, charge it for 12 hours before using it, every time it is used and at least every 3 months. It is possible to recharge the unit using the power supply provided (FIG. B Item 5), at 230VAC, or using a 24VDC power supply (FIG. B Item 6). It's recommended that the battery is kept fully charged at all times. If the battery is left in a low charge state it could shorten battery life. Keep in mind that the time required to recharge the battery depends on the number of previous battery jump starts. To check and see if the battery is low, press the button (FIG. A Item 8). The meter (FIG. A Item 3) will show the battery charge level. Green area of the meter indicates that it's charged.

### 3.4 To recharge using 230VAC.

❑ **WARNING!** Use the supplied power supply only and exclusively for recharging the START1224.

- 3.4.1 Plug the power charger (FIG. B Item 1) into a 230VAC outlet, and then insert the output plug (FIG. B Item 2) into the recharge receptacle (FIG. A Item 2).
- 3.4.2 Allow the Start System to recharge for about 8 hours. Check the recharge progress by pressing the red button (FIG. A Item 8). This will show the level of battery power on the volt meter (FIG. A Item 3).
- 3.4.3 This Start1224 is equipped with an automatic cut off so you can not overcharge the battery The system may remain plugged into a 230VAC outlet until needed.

### 3.5 To recharge using a 24VDC supply.

Note! Recharging with this method will not recharge the system to the same 28/29VDC voltage level as when plugging it into a 230VAC outlet.

- 3.5.1 Insert the power cord with the cigarette lighter plug (FIG. B Item 3) into the 24VDC, cigarette lighter receptacle on your vehicle.
- 3.5.2 Insert the power cord with the proper plug (FIG. B Item 4) into the recharge receptacle (FIG. A Item 2).

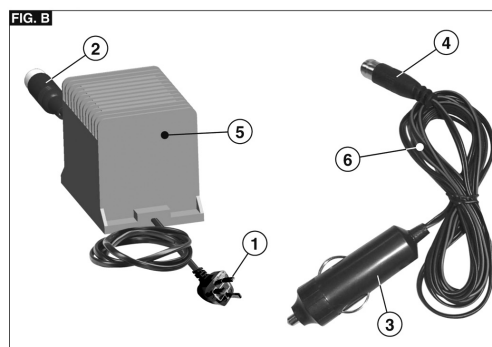
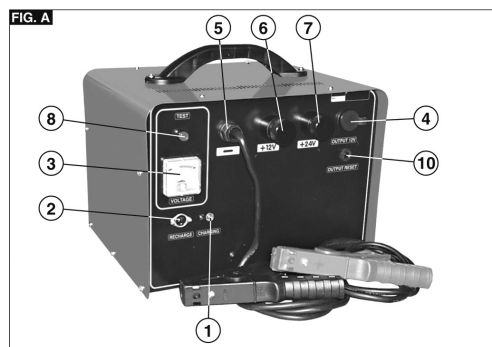



# JUMPSTART 12/24V 1500 PEAK AMPS MODEL: START1224



### Environmental Protection



Recycle unwanted materials instead of disposing of them as waste. All tools, accessories and packaging should be sorted, taken to a recycle centre and disposed of in a manner which is compatible with the environment.



When the product is no longer required, it must be disposed of in an environmentally protective way. Contact your local solid waste authority for recycling information.

### Battery Removal



- WARNING!** To avoid electric shock ensure the battery is depleted.
- 1. Remove the screws around the edge of the cover, then remove cover.
- 2. Remove the cables connected to the battery terminals. Remove the negative black cable first.

**Dispose of batteries according to local authority guidelines.**

Under the Waste Batteries and Accumulators Regulations 2009, Jack Sealey Ltd are required to inform potential purchasers of products containing batteries (as defined within these regulations), that they are registered with Valpak's registered compliance scheme.

Jack Sealey Ltd's Batteries Producer Registration Number (BPRN) is BPRN00705

**NOTE:** It is our policy to continually improve products and as such we reserve the right to alter data, specifications and component parts without prior notice.

**IMPORTANT:** No liability is accepted for incorrect use of this product.

**WARRANTY:** Guarantee is 12 months from purchase date, proof of which will be required for any claim.

**INFORMATION:** For a copy of our latest catalogue and promotions call us on 01284 757525 and leave your full name and address, including postcode.



Sole UK Distributor, Sealey Group,  
Kempson Way, Suffolk Business Park,  
Bury St. Edmunds, Suffolk,  
IP32 7AR



01284 757500



www.sealey.co.uk



01284 703534



sales@sealey.co.uk