



INSTRUCTIONS FOR:
OSCILLATING MULTI-TOOL 180W/230V
MODEL NO: **SMT180**

Thank you for purchasing a Sealey product. Manufactured to a high standard, this product will, if used according to these instructions, and properly maintained, give you years of trouble free performance.

IMPORTANT: PLEASE READ THESE INSTRUCTIONS CAREFULLY. NOTE THE SAFE OPERATIONAL REQUIREMENTS, WARNINGS & CAUTIONS. USE THE PRODUCT CORRECTLY AND WITH CARE FOR THE PURPOSE FOR WHICH IT IS INTENDED. FAILURE TO DO SO MAY CAUSE DAMAGE AND/OR PERSONAL INJURY AND WILL INVALIDATE THE WARRANTY. KEEP THESE INSTRUCTIONS SAFE FOR FUTURE USE.

1. SAFETY



Refer to instruction manual



Wear ear protection



Wear eye protection



Wear respiratory protection

1.1. ELECTRICAL SAFETY

WARNING! It is the user's responsibility to read, understand and comply with the following:

You must check all electrical equipment and appliances to ensure they are safe before using. You must inspect power supply leads, plugs and all electrical connections for wear and damage. You must ensure the risk of electric shock is minimised by the installation of appropriate safety devices. An RCCB (Residual Current Circuit Breaker) should be incorporated in the main distribution board. We also recommend that an RCD (Residual Current Device) is used with all electrical products. It is particularly important to use an RCD with portable products that are plugged into an electrical supply not protected by an RCCB. If in doubt consult a qualified electrician. You may obtain a Residual Current Device by contacting your Sealey dealer. **You must** also read and understand the following instructions concerning electrical safety.

- 1.1.1. The **Electricity At Work Act 1989** requires all portable electrical appliances, if used on business premises, to be tested by a qualified electrician, using a Portable Appliance Tester (PAT), at least once a year.
- 1.1.2. The **Health & Safety at Work Act 1974** makes owners of electrical appliances responsible for the safe condition of the appliance and the safety of the appliance operator. **If in any doubt about electrical safety, contact a qualified electrician.**
- 1.1.3. Ensure the insulation on all cables and the product itself is safe before connecting to the mains power supply. See 1.1.1. & 1.1.2. above and use a Portable Appliance Tester (PAT).
- 1.1.4. Ensure that cables are always protected against short circuit and overload.
- 1.1.5. Regularly inspect power supply, leads, plugs for wear and damage and all electrical connections to ensure that none are loose.
- 1.1.6. **Important:** Ensure the voltage marked on the product is the same as the electrical power supply to be used and check that plugs are fitted with the correct capacity fuse.
A 13 amp plug may require a fuse smaller than 13 amps for certain products, see fuse rating at right.
 - 1.1.7. **DO NOT** pull or carry the tool by its power supply lead.
 - 1.1.8. **DO NOT** pull power plugs from sockets by the power cable.
 - 1.1.9. **DO NOT** use worn or damaged leads, plugs or connections. Immediately replace or have repaired by a qualified electrician. A UK 3 pin plug with ASTA/BS approval is fitted. In case of damage, cut off and fit a new plug according to the following instructions (discard old plug safely). (UK only - see diagram at right). **Ensure the unit is correctly earthed via a three-pin plug.**
 - a) **Connect the GREEN/YELLOW earth wire to the earth terminal 'E'.**
 - b) **Connect the BROWN live wire to live terminal 'L'.**
 - c) **Connect the BLUE neutral wire to the neutral terminal 'N'.**
 - d) **After wiring, check there are no bare wires, that all wires have been correctly connected, that cable outer insulation extends beyond the cable restraint and that the restraint is tight.**

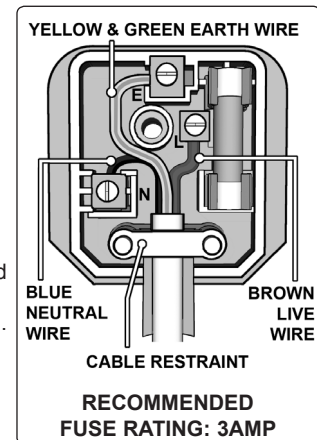

Double insulated products are often fitted with live (BROWN) and neutral (BLUE) wires only. Double insulated products are always marked with this symbol . **To re-wire, connect the brown & blue wires as indicated above. DO NOT connect the brown or blue to the earth terminal.**

- 1.1.10. Some products require more than a 13 amp electrical supply. In such a case, **NO** plug will be fitted. **You must** contact a qualified electrician to ensure a 30 amp fused supply is available. We recommend you discuss the installation of a industrial round pin plug and socket with your electrician.
 - 1.1.11. **Cable extension reels.** When a cable extension reel is used it should be fully unwound before connection. A cable reel with an RCD fitted is recommended since any product which is plugged into the cable reel will be protected. The section of the cores of the cable is important. We suggest 1.5mm² section as a minimum but to be absolutely sure that the capacity of the cable reel is suitable for this product and for others that may be used in the other output sockets, we recommend the use of 2.5mm² section cable.
- ### 1.2. GENERAL SAFETY
- ✓ Only power the tool from the mains supply.
 - ✓ Disconnect the tool from the mains supply before changing accessories, servicing or performing any maintenance.
 - ✓ Maintain tool and accessories in good condition. Check moving parts and alignment. If necessary use an authorised service agent.
 - ✓ Replace or repair damaged parts using recommended parts. Unauthorised parts may be dangerous and will invalidate the warranty.
 - ✓ Wear approved safety goggles and a dust mask if generating dust.
 - ✓ Remove ill fitting clothing. Remove ties, watches, rings and other loose jewellery and contain long hair.
 - ✓ Use the tool in a suitable work area. Keep area clean and tidy and free from unrelated materials and ensure that there is adequate lighting.
 - ✓ Prevent body contact with earthed surfaces to avoid electric shock e.g. pipes, radiators, refrigerators etc.
 - ✓ Maintain correct balance and footing.
 - ✓ Keep children and unauthorised persons away from the work area.
 - ✓ Secure unstable workpiece with a clamp, vice or other adequate holding device.

- ✓ Avoid unintentional starting. Keep the tool clean for best and safest performance.
- ✓ When not in use switch tool off and unplug it from the mains supply. Store it in the case and put in a dry, childproof area.
- x **DO NOT** over-reach. Ensure the floor is not slippery and wear non-slip shoes.
- x **DO NOT** use the tool for a task it is not designed to perform.
- x **DO NOT** operate tool where there are flammable liquids or gases.
- x **DO NOT** get the tool wet or use in damp or wet locations.
- x **DO NOT** carry the tool by the cable.
- x **DO NOT** hold unsecured work in your hand.
- x **DO NOT** leave the tool running unattended.
- x **DO NOT** operate the tool if any parts are missing or damaged as this may cause failure and/or personal injury.
- x **DO NOT** operate the tool when you are tired or under the influence of alcohol, drugs or intoxicating medication.

2. INTRODUCTION

One tool suitable for multiple tasks such as sanding, scraping and cutting various materials. Single speed with 180W motor and sealed bearings. Includes sanding discs, backing pad, offset cutting blade and offset scraper all supplied in a convenient storage case. Full range of additional accessories available.

3. SPECIFICATION

Model No: **SMT180**
 Motor Power: 180W
 Supply:230V
 No Load Speed:2300rpm
 Noise Power: 93dBA
 Noise Pressure: 82dBA
 Vibration: 3.78m/s²
 Uncertainty: 1.89m/s²
 Weight: 1.2kg
 Accessories: 1 x Offset Cutting Blade,
 1 x Offset Scraper,
 4 x Sanding Discs,
 1 x Triangle Backing Pad.

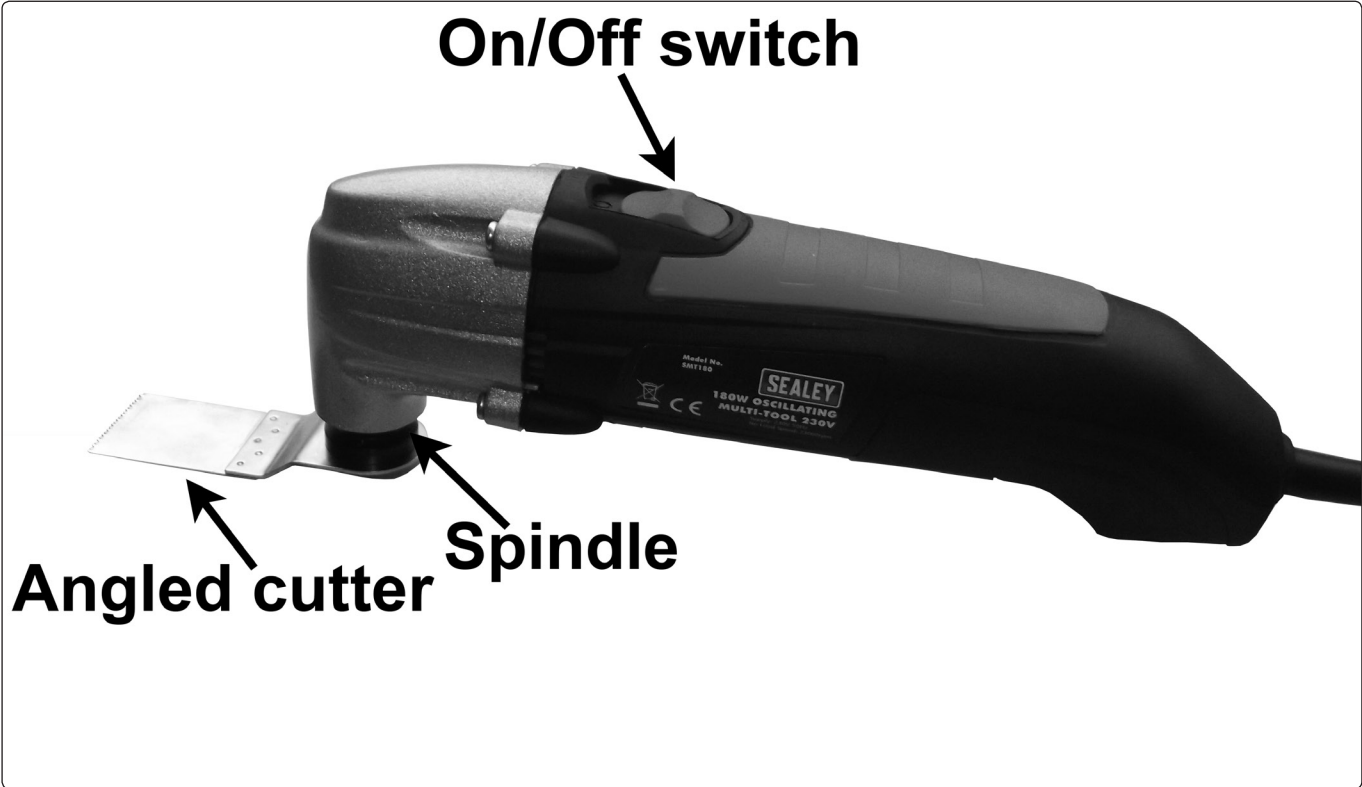

4. OPERATION

4.1. Tool set up

- **WARNING! To prevent injury from accidental operation turn the power switch of the tool off and unplug the tool from its electrical outlet before adjusting the tool or adding accessories.**

4.1.1. Turn the power switch off and unplug the tool.

4.1.2. Place the attachment over the spindle, shoulder facing away from the tool. Line up the holes on the attachment with the pins on the spindle shoulder.

Note: The Angled Cutter Blade should only be used in the straight ahead position and not an angled position, see fig.1.

4.1.3. Slide the small washer, then the large washer onto the cap screw. Make sure the cupped side of the large washer is toward the tool. While holding the attachment over the pins on the tool, thread the cap screw in place, see fig.2.

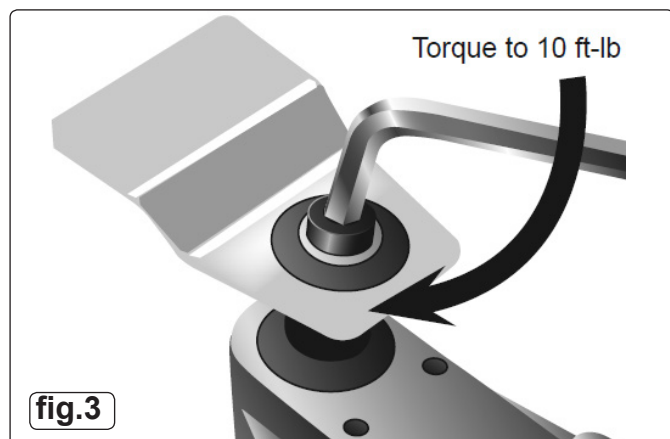
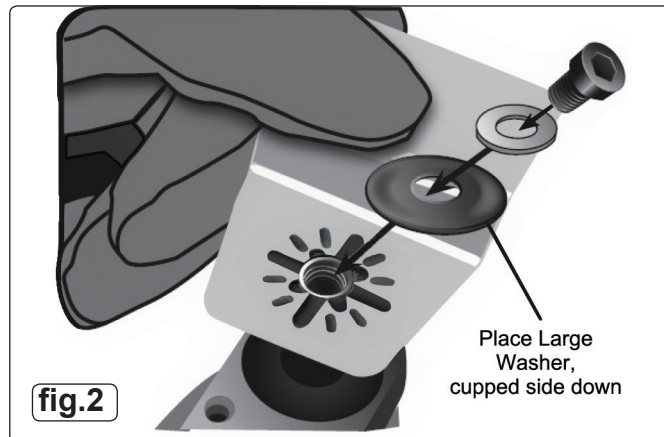
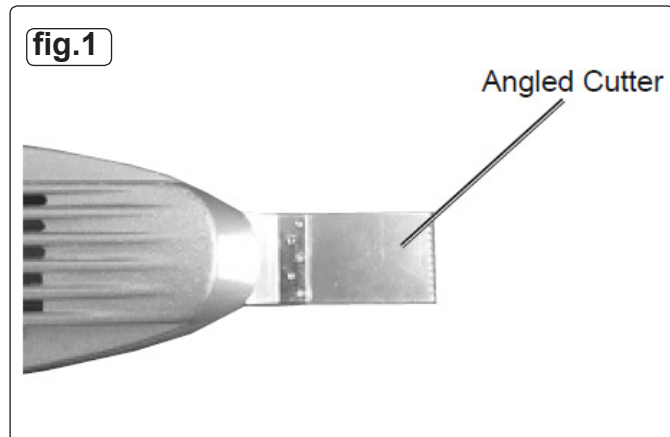

4.1.4. Tighten the cap screw onto the spindle using the provided hex key, torque to approximately 10 ft-lb.

4.1.5. After securing, the attachment should not move on the spindle. If it can move with the power off, remount it, making sure that the holes on the attachment line up with the pins on the spindle. Tighten the cap screw securely.

4.2. Work area set up

4.2.1. Choose a work area that is clean and well-lit. The work area must not allow access by children or pets. To prevent distraction and injury.

4.2.2. Route the mains cable along a safe route to reach the work area without creating a tripping hazard or exposing the mains cable to possible damage. The mains cable must reach the work area with enough extra length to allow free movement while working.

4.3. Operation

4.3.1. Pull the On/Off switch back to its off position. Then plug the mains cable in.

4.3.2. To turn on the tool, slide the On/Off switch forward. **DO NOT** allow contact between the angled cutter, scraper or other accessory and workpiece until the tool is running at full speed.

4.3.3. Avoid contact with foreign objects such as metal screws and nails when sanding, scraping, or cutting.

4.3.4. **DO NOT** apply excessive pressure on the tool. Allow the tool to do the work.

4.3.5. When finished, turn off the tool and allow it to completely stop before setting it down. Then unplug the tool from its electrical outlet.

4.3.6. Prior to storing the tool, remove the attachment and wipe it clean. Store the Tool in a clean, dry, safe location out of reach of children and other unauthorized persons.

5. MAINTENANCE

- **WARNING! To prevent injury from accidental operation, turn the On/Off switch of the tool off and unplug the tool from its electrical outlet before performing any inspection, maintenance or cleaning procedures.**

- **WARNING! To prevent serious injury from tool failure, DO NOT use damaged equipment. If abnormal noise or vibration occurs, have the problem corrected before further use.**

5.1. Maintenance

5.1.1. Before each use, inspect the general condition of the Tool. Check for loose screws, misalignment or binding of moving parts, cracked or broken parts, damaged electrical wiring, and any other condition that may affect its safe operation.

5.1.2. Inspect accessories, sanding sheets should not be dull or contain excessive debris build up. The angle scraper and cutting blade should be clean and sharp.

5.1.3. After use clean external surfaces with a clean cloth.

5.1.4. If the tool has decreased performance, have the unit serviced and the carbon brushes replaced by a qualified service technician.



Environmental Protection

Recycle unwanted materials instead of disposing of them as waste. All tools, accessories and packaging should be sorted, taken to a recycling centre and disposed of in a manner which is compatible with the environment.



WEEE Regulations

Dispose of this product at the end of its working life in compliance with the EU Directive on Waste Electrical and Electronic Equipment (WEEE). When the product is no longer required, it must be disposed of in an environmentally protective way. Contact your local solid waste authority for recycling information.

Parts support is available for this product. To obtain a parts listing and/or diagram, please log on to www.sealey.co.uk, email sales@sealey.co.uk or telephone 01284 757500.

NOTE: It is our policy to continually improve products and as such we reserve the right to alter data, specifications and component parts without prior notice.

IMPORTANT: No liability is accepted for incorrect use of this product.

WARRANTY: Guarantee is 12 months from purchase date, proof of which will be required for any claim.



Sole UK Distributor, Sealey Group,
Kempson Way, Suffolk Business Park,
Bury St. Edmunds, Suffolk,
IP32 7AR



01284 757500



01284 703534



www.sealey.co.uk



sales@sealey.co.uk

WARNING! – Risk of Hand Arm Vibration Injury.

This tool may cause Hand Arm Vibration Syndrome if its use is not managed adequately.

This tool is subject to the vibration testing section of the Machinery Directive 2006/42/EC.

This tool is to be operated in accordance with these instructions.

Measured vibration emission value (a): 3.78m/s²

Uncertainty value (k):. 1.89m/s²

Please note that the application of the tool to a sole specialist task may produce a different average vibration emission. We recommend that a specific evaluation of the vibration emission is conducted prior to commencing with a specialist task.

A health and safety assessment by the user (or employer) will need to be carried out to determine the suitable duration of use for each tool.

NB: Stated Vibration Emission values are type-test values and are intended to be typical.

Whilst in use, the actual value will vary considerably from and depend on many factors.

Such factors include; the operator, the task and the inserted tool or consumable.

NB: ensure that the length of leader hoses is sufficient to allow unrestricted use, as this also helps to reduce vibration.

The state of maintenance of the tool itself is also an important factor, a poorly maintained tool will also increase the risk of Hand Arm Vibration Syndrome.

Health surveillance.

We recommend a programme of health surveillance to detect early symptoms of vibration injury so that management procedures can be modified accordingly.

Personal protective equipment.

We are not aware of any personal protective equipment (PPE) that provides protection against vibration injury that may result from the uncontrolled use of this tool. We recommend a sufficient supply of clothing (including gloves) to enable the operator to remain warm and dry and maintain good blood circulation in fingers etc. Please note that the most effective protection is prevention, please refer to the Correct Use and Maintenance section in these instructions. Guidance relating to the management of hand arm vibration can be found on the HSC website www.hse.gov.uk - Hand-Arm Vibration at Work.