



# INSTRUCTIONS FOR: PROFESSIONAL SPRAY GUN CLEANING TANK

Model: **SM2369**

Thank you for purchasing a Sealey product. Manufactured to a high standard this product will, if used according to these instructions and properly maintained, give you years of trouble free performance.

**IMPORTANT: PLEASE READ THESE INSTRUCTIONS CAREFULLY. NOTE THE SAFE OPERATIONAL REQUIREMENTS, WARNINGS AND CAUTIONS. USE THIS PRODUCT CORRECTLY AND WITH CARE FOR THE PURPOSE FOR WHICH IT IS INTENDED. FAILURE TO DO SO MAY CAUSE DAMAGE OR PERSONAL INJURY AND WILL INVALIDATE THE WARRANTY. PLEASE KEEP INSTRUCTIONS SAFE FOR FUTURE USE.**

## 1. SAFETY INSTRUCTIONS

- WARNING! Ensure Health & Safety, local authority, general workshop practice regulations are adhered to when using equipment.**
  - WARNING! Installation site must be equipped with suitable fire extinguishers (water must not be used) and escape routes.**
  - WARNING! Disconnect the air supply from the tank before changing accessories, servicing or performing any maintenance.**
- Maintain the tank in good condition (use an authorised service agent).  
 Replace or repair damaged parts. Use genuine parts only. Non-authorised parts may be dangerous and will invalidate the warranty. Locate the tank in an adequate working area. Ensure the tank stands on a firm level surface. Keep area clean and tidy and free from unrelated materials. Ensure the area is well ventilated and has adequate lighting.
- WARNING! Ensure correct air pressure is maintained and not exceeded. Recommended pressure 8-9 bar (115-130psi).**
- Keep air hose away from heat, oil and sharp edges. Check air hose for wear before each use, and ensure that all connections are secure.
- WARNING! This tank is recommended for use only with solvents.**
- Use only recommended solvents as a cleaning agent, do not pour any other type of cleaning fluid into the tank. Keep the tank clean. Remove and clean the suction filter regularly for best performance.
- WARNING! DO NOT SMOKE and keep sources of ignition, such as heaters, lamps, etc. away from the unit, together with flammable or combustible materials, as there is an explosion risk.**
  - WARNING! Wear approved safety eye protection, mask and gloves. If solvent gets on skin or in eyes wash thoroughly with water and take any other action as required by the solvent instructions.**
- Remove ill fitting clothing, ties, watches, rings and other loose jewellery, contain long hair, and wear appropriate protective clothing. Maintain correct balance and footing. Ensure the floor is not slippery and wear non-slip shoes. Keep non-essential persons away from the working area.
- In case of fire in tank, do not attempt to move the unit or remove spray guns.  
 DO NOT use the tank without the fume extraction flue attached, and ensure the flue removes the fumes to outside the building.  
 DO NOT use the tank for any purpose other than for which it is designed.  
 DO NOT operate the tank if any parts are missing or damaged as this may cause failure or possible personal injury.  
 DO NOT over-fill the tank.  
 DO NOT direct air from the air hose at yourself or others.  
 DO NOT operate the tank when you are tired, under the influence of alcohol, drugs or intoxicating medication.  
 When cleaning is complete, ensure all controls are in the 'off' position and that the air supply is turned off.
- WARNING! It is operator's responsibility to ensure that there is no uncontrolled discharge of any fluids used with this unit and that appropriate arrangements have been made for correct disposal of waste in accordance with government/local authority regulations.**

## 2. INTRODUCTION & SPECIFICATION

The SM2369 is a compact unit suitable for busy medium sized body shop use. The tank is robustly manufactured from galvanised steel and features an automatic fume extraction system, a stainless steel wash tank and a diaphragm pump which delivers a volume of solvent sufficient to clean two guns and pots in each washing cycle. The unit offers timed automatic enclosed wash, manual wash and rinse and is suitable for cleaning gravity and suction fed guns.

### SPECIFICATION

- Operating pressure . . . . . 6 - 10 bar
- Air consumption/extraction nozzle . . . . . 12m<sup>3</sup>/h (7cfm)
- Cleans . . . . . 2 pots + 2 guns
- Width x depth x height . . . . . 650 x 670 x 1390mm
- Extraction stack diameter . . . . . Ø150mm
- Weight . . . . . 60kg

## 3. AIR SUPPLY

- 3.1. Ensure that the timer (fig.1.12) is set to zero and the three control valves (fig1.14/15/17) are 'Off' before connecting to the air supply.
- 3.2. You will require an air pressure of more than 6 bar (85psi) and an available air volume of more than 7cfm to operate the unit.
  - WARNING! Ensure air supply is clean and does not exceed 10 bar. Too high an air pressure and unclean air will shorten the product life due to excessive wear, and may be dangerous causing possible damage and personal injury.**
- 3.3. Drain the air supply tank daily. Water in the air line will damage the unit.
- 3.4. Clean the air supply filter weekly. For recommended hook-up, see diagram to right.
- 3.5. Line pressure should be increased to compensate for unusually long air hoses (over 8 metres). The minimum hose internal diameter should be 10mm and fittings must have the same internal dimension.
- 3.6. Keep hose away from heat, oil and sharp edges. Check hoses for wear, and make certain that all connections are secure.
- 3.7. The air inlet connection is 1/4" BSP.

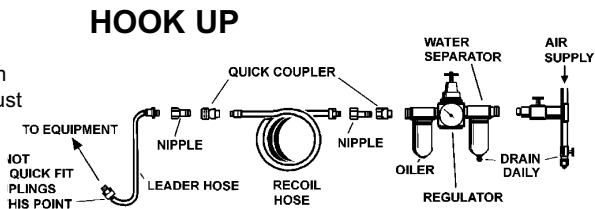

## 4. INSTALLATION

Unpack the product and check there are no damaged or missing parts. If there is a problem contact your supplier immediately.

- 4.1 Position unit in a well ventilated area on a solid level floor with good access to a suitable compressed air supply. Also consider the handling and storage of waste fluids pending appropriate disposal. Tank must be well away from heat sources and potential sparks e.g. fuse boxes, switches.
- 4.2 Using the cable supplied, connect the earth stud (fig.1.1) to a suitable grounding point.
- 4.3 Connect air gun hose (supplied) to air outlet (20) and equip the free end with an air line coupling.
- 4.4 Connect the compressed air supply to the inlet (2).
- 4.5 Fit the 150mm diameter flue over the unit's air extraction outlet (3). Ensure the first 1m of flue is vertical, thereafter the flue may curve to the designated ventilation outlet on the outside of the building.
- 4.6 Connecting the solvent drums.
  - WARNING! Ensure you follow the safety instructions and any instructions on the solvent drum. Wear approved safety gloves, goggles, mask, and suitable clothing.**
- 4.6.1 Transfer 5 litres from a new 25 litre solvent drum (4) into a second clean, empty drum (or other suitable container) (5) to be used as the 'clean rinse' supply.
- 4.6.2 Place the suction filter (6) into the 25 litre drum (4), ensuring it reaches the bottom.
- 4.6.3 Place the two outlet drain hoses (7/8) into the top of the same drum.
- 4.7 Place the two brass-ended 'clean rinse' pick-up pipes (9/10) into the 'clean rinse' drum (5).
- 4.8 Position both solvent drums in the right hand side of the cabinet with the 'clean rinse' drum to the rear. A tray (11) is provided to ease drum insertion and removal and to retain any solvent spillage.

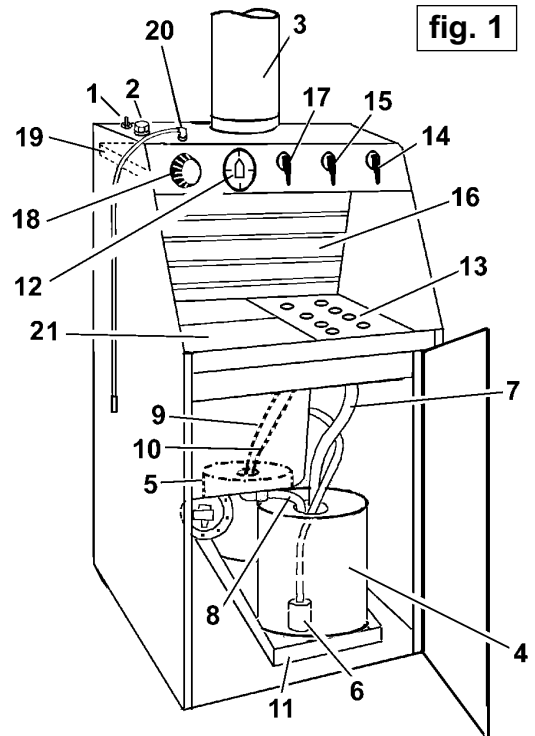

## 5. OPERATING INSTRUCTIONS

- WARNING! Ensure you follow the safety instructions. Wear approved safety gloves, goggles, mask, and suitable clothing.**
- WARNING! Before using the washer always touch a suitable earthing point to dissipate any electrostatic charge you may have.**
- WARNING! To maximise fume extraction always ensure that the lower cabinet door is closed before opening the lid.**

### 5.1. PREPARING TANK & ITEMS FOR CLEANING

- 5.1.1. Turn air supply on.
- 5.1.2. Turn on main pump by setting timer (fig.1.12) and confirm it runs at 40 to 50 strokes per minute. If necessary correct pump speed by adjusting screw (A).
- 5.1.3. Check the spray gun to be cleaned, empty and store any excess paint for future use. For best results clean immediately after use, having removed as much residual paint as possible.
- 5.1.4. Open cleaning tank (fig.1.21) and place paint cup/pot over the top of nozzle (fig.2.T) and pot cover in stand (fig.2.H). Place stand over second nozzle (fig.2.T).
- 5.1.5. To open the spray gun for cleaning, fit trigger clip (fig.3.A) and use plug (fig.3.B) to block gun air inlet port.
- 5.1.6. Place the spray gun into the tank as follows:
  - a) If suction gun, fit directly onto taper nozzle (fig.2.Z).
  - b) If gun is a gravity or pressure type use extended nozzle (fig.2.V).
- 5.1.7. Close the tank cover and the unit lid ready to start the cleaning operation.

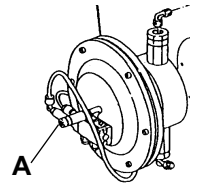

### 5.2. AUTOMATIC CLEANING

- 5.2.1. Ensure washer cover and unit lid are closed and then set timer to maximum to start pump. The pump will automatically stop when the timer reaches zero.
- 5.2.2. The pump will draw solvent up through the filter in the bottom of the 25 litre drum and expel an atomized spray through the nozzles in the cleaning tank. Solvent will drain through the outlet hose from the bottom of the tank back into the drum.
- 5.2.3. When the timer stops the lid and cover may be opened and the cleaned spray equipment removed.

**NOTE:** If during cleaning the lid and the washer cover are opened, the cleaning process will automatically stop and the fumes will be extracted through the unit's extraction flue. Close cover and lid for cleaning to continue.

DO NOT store guns in tank.

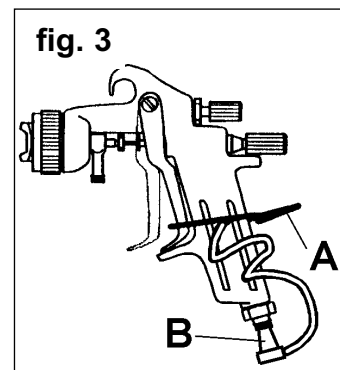
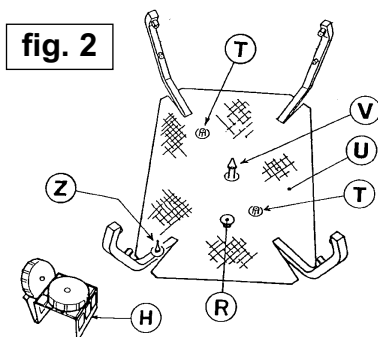

### 5.3. MANUAL 'CLEAN RINSE'

- WARNING! Ensure you follow the safety instructions. Wear approved safety gloves, goggles, mask, and suitable clothing.**
- WARNING! To maximise fume extraction always ensure that the lower cabinet door is closed before opening the lid.**

5.3.1. On completion of automatic wash open unit lid (fume extraction system will start automatically) and washer cover and move guns etc. from washer to drainer (fig.1.13).

5.3.2. Manual rinse can now be carried out using clean fluid from the clean fluid pump (14) and/or the atomizer (15). Clean solvent will flow from the 'clean rinse' container (5), out of the pump and atomizer outlets and through the drainer to the 25 litre dirty fluid drum (4).

**NOTE:** Ensure that the solvent in the 'clean rinse' container is clean. DO NOT top up with used solvent.

### 5.4. WHEN CLEANING IS COMPLETE.

Remove all items from the cleaning tank and store accordingly. DO NOT store guns in tank. Turn the air supply off, close the tank lid, wipe up any spillage, and wipe any soil marks from the unit.

- WARNING! It is operators responsibility to ensure that there is no uncontrolled discharge of any fluids used with this unit and that appropriate arrangements have been made for correct disposal of waste in accordance with government/local authority regulations.**

## 6. GUN TESTING

- 6.1. Connect gun to air hose self-sealing connector.
- 6.2. Switch on air supply and raise unit lid - normal extraction will start. Place test card in front of rear grille (fig.1.16)
- 6.3. Switch on air supply to gun (17) - initiates additional extraction. Air pressure to gun may be adjusted using regulator (18).
- 6.4. Gun may now be test sprayed towards card with the excess paint being removed by the higher than normal extraction rate.

## 7. SOLVENT CHANGE & MAINTENANCE

- WARNING! It is operators responsibility to ensure that there is no uncontrolled discharge of any fluids used with this unit and that appropriate arrangements have been made for correct disposal of waste in accordance with government/local authority regulations.**
- WARNING! Disconnect the air supply from the unit before changing accessories, servicing or performing any maintenance.**
- WARNING! Wear approved safety gloves, goggles, mask, and suitable clothing.**

### 7.1 SOLVENT REPLACEMENT

The number of guns a 25 litre drum of solvent can clean will depend upon the amount of residual paint which is left in spray equipment. We recommend however that the solvent is changed on a regular basis to provide optimum machine performance.

- 7.1.1. Operate extraction (fig.1.17), with lid closed, to remove fumes from drum storage area **before** opening lower door.
- 7.1.2. Remove drain hoses and filter from drum. Store the used solvent in accordance with regulations.
- 7.1.3. Clean drum tray, returning any spillage in tray to drum for disposal.
- 7.1.4. Clean the filter before re-use.
- 7.1.5. Insert the filter and drain hoses into a new solvent drum as in section 4.
- 7.1.6. The clean rinse drum may be re-used. Check to ensure it is clean and top up with 5 litres from new 25 litre container. Wipe up any spillage immediately.

### 7.2. MAINTENANCE

- 7.2.1. Clean the inside of the wash tank and the sump below the drainer just before changing the solvent. Remove wash tank grille (fig.2.U) by lifting with handle (fig.2.R).
- 7.2.2. Keep pick-up filter clean by rinsing in solvent and blowing out with an air line.
- 7.2.3. Change or clean the extraction filter (fig.1.19) every three months, or more frequently if heavily used.
- 7.2.4. Regularly check that the lid latch effectively retains the lid when open.
- 7.2.5. Regularly check that the automatic spray cut-out works when the tank cover is opened.
- 7.2.6. Regularly check to ensure there are no obstructions to the extraction flue.
- 7.2.7. Regularly check that the unit is correctly earthed.
- 7.2.8. Every 3 to 4 months remove air supply line and pour a small amount of air-tool lubricant into fitting (fig.1.2).
- 7.2.9. Keep the outside of the unit clean.

**PROFESSIONAL SPRAY GUN CLEANING TANK  
MODEL SM2369**

93/68/EEC CE Marking Directive  
98/37/EC Machinery Directive (S.I 1992/3073)

**Declaration of Conformity** We, the sole importer into the UK, declare that the product listed here is in conformity with the following standards and directives



Signed by Mark Sweetman

2nd August 1999

The construction file for this product is held by the Manufacturer and may be inspected on request by contacting Jack Sealey Ltd.

For Jack Sealey Ltd. Sole importer into the UK of Sealey Power Products.

**NOTE:** It is our policy to continually improve products and as such we reserve the right to alter data, specifications and component parts without prior notice.

**IMPORTANT:** No liability is accepted for incorrect use of this product.

**WARRANTY:** Guarantee is 12 months from purchase date, proof of which will be required for any claim.

**INFORMATION:** For a copy of our catalogue call us on 01284 757525 and leave your full name, address and postcode.



Sole UK Distributor,  
**Sealey Group**, Bury St. Edmunds, Suffolk.



01284 757500



01284 703534

**E-mail:** sales@sealey.co.uk