

Thank you for purchasing a Sealey product. Manufactured to a high standard this product will, if used according to these instructions and properly maintained, give you years of trouble free performance.

**! IMPORTANT: PLEASE READ THESE INSTRUCTIONS CAREFULLY. NOTE THE SAFE OPERATIONAL REQUIREMENTS, WARNINGS, AND CAUTIONS. USE THIS PRODUCT CORRECTLY, AND WITH CARE FOR THE PURPOSE FOR WHICH IT IS INTENDED. FAILURE TO DO SO MAY CAUSE DAMAGE AND/OR PERSONAL INJURY AND WILL INVALIDATE THE WARRANTY.**

## 1. SAFETY INSTRUCTIONS

### 1.1 ELECTRICAL SAFETY

**⚠ WARNING!** It is the responsibility of the owner and the operator to read, understand and comply with the following: You must check all electrical products, before use, to ensure that they are safe. You must inspect power cables, plugs, sockets and any other connectors for wear or damage. You must ensure that the risk of electric shock is minimised by the installation of appropriate safety devices. A Residual Current Circuit Breaker (RCCB) should be incorporated in the main distribution board. We also recommend that a Residual Current Device (RCD) is used. It is particularly important to use an RCD with portable products that are plugged into a supply which is not protected by an RCCB. If in any doubt consult a qualified electrician. You may obtain a Residual Current Device by contacting your Sealey dealer.

You must also read and understand the following instructions concerning electrical safety.

- 1.1.1 The Electricity at Work Act 1989 requires that all portable electrical appliances, if used on business premises, are tested by a qualified electrician, using a Portable Appliance Tester (PAT), at least once a year.
- 1.1.2 The Health & Safety at Work Act 1974 makes owners of electrical appliances responsible for the safe condition of those appliances and the safety of the appliance operators. If in any doubt about electrical safety, contact a qualified electrician.
- 1.1.3 Ensure that the insulation on all cables and on the appliance is safe before connecting it to the power supply. See 1.1.1 and 1.1.2 and use a Portable Appliance Tester.
- 1.1.4 Ensure that cables are always protected against short circuit and overload.
- 1.1.5 Regularly inspect power supply cables and plugs for wear or damage and check all connections to ensure that none is loose.
- 1.1.6 Important: Ensure that the voltage marked on the appliance matches the power supply to be used and that the plug is fitted with the correct fuse - see fuse rating at right.
- 1.1.7 DO NOT pull or carry the appliance by the power cable.
- 1.1.8 DO NOT pull the plug from the socket by the cable.
- 1.1.9 DO NOT use worn or damaged cables, plugs or connectors. Immediately have any faulty item repaired or replaced by a qualified electrician. When a BS 1363/A UK 3 pin plug is damaged, cut the cable just above the plug and dispose of the plug safely. Fit a new plug according to the following instructions (UK only).
  - a) Connect the GREEN/YELLOW earth wire to the earth terminal 'E'.
  - b) Connect the BROWN live wire to the live terminal 'L'.
  - c) Connect the BLUE neutral wire to the neutral terminal 'N'.
  - d) After wiring, check that there are no bare wires, that all wires have been correctly connected, that the cable outer insulation extends beyond the cable restraint and that the restraint is tight. Double insulated products, which are always marked with this symbol are fitted with live (brown) and neutral (blue) wires only. To rewire, connect the wires as indicated above - DO NOT connect either wire to the earth terminal.
- 1.1.10 Products which require more than 13 amps are supplied without a plug. In this case you must contact a qualified electrician to ensure that a suitably rated supply is available. We recommend that you discuss the installation of an industrial round pin plug and socket with your electrician.
- 1.1.11 If an extension reel is used it should be fully unwound before connection. A reel with an RCD fitted is preferred since any appliance plugged into it will be protected. The cable core section is important and should be at least 1.5mm<sup>2</sup>, but to be absolutely sure that the capacity of the reel is suitable for this product and for others which may be used in the other output sockets, we recommend the use of 2.5mm<sup>2</sup> section cable.

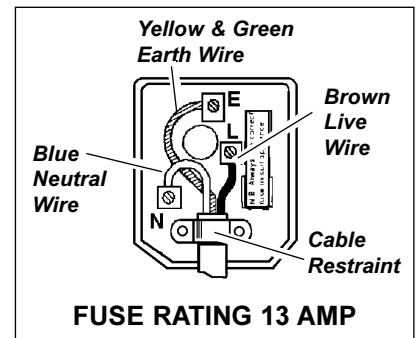

### 1.2 GENERAL SAFETY

- ✓ Disconnect the grinder from the mains power before changing accessories, servicing or performing any maintenance.
- ✓ Maintain grinder and discs in good condition. Check moving parts and alignment. If necessary use an authorised service agent.
- ✓ Replace or repair damaged parts. Use genuine parts only. Unapproved parts may be dangerous and will invalidate the warranty.
- ⚠ **WARNING!** Always work with the grinder safety guard in place.
- ✓ The grinding wheel or disc must only be changed by persons holding an appropriate grinding wheel certificate.
- ✓ Wear approved safety goggles, ear defenders, appropriate dust mask (if grinder generates dust) and safety gloves.
- ✓ Remove ill fitting clothing. Remove ties, watches, rings, and other loose jewellery, and contain long hair.
- ✓ Use grinder in a suitable work area, keep area clean, tidy and free from unrelated materials, and ensure adequate lighting.
- ✓ Maintain correct balance and footing. DO NOT over-reach and ensure the floor is not slippery. Wear non-slip shoes.
- ✓ Use only approved grinding discs, and only use the normal grinding surface. Never use the side or upper surface of disc for cutting.
- ✓ Check grinding disc to ensure it is not split, cracked or damaged in anyway. See chapter 4. If in doubt do not use the disc.
- ✓ Grinding discs must be securely attached before use, but not over tightened.
- ✓ Secure unstable workpiece with a clamp, vice or other adequate holding device, and ensure the grinder is gripped with both hands.
- ✓ Keep non essential persons away from the working area. Use screens if necessary.
- x DO NOT operate the grinder if any parts are missing or the grinder is damaged.
- x DO NOT use the grinder for a task it is not designed to perform.
- x DO NOT operate grinder where there are flammable liquids or gasses.
- ⚠ **WARNING!** DO NOT grind any materials containing asbestos.
- x DO NOT get the grinder wet or use in damp or wet locations.
- x DO NOT switch the grinder on whilst the disc is in contact with the workpiece.

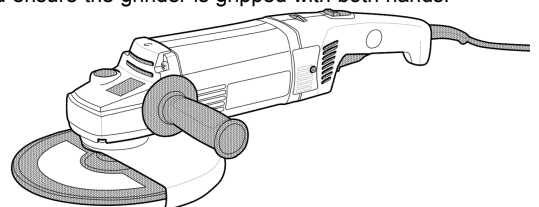

- x DO NOT cover the grinder air vents. To do so will overheat the machine.
- x DO NOT touch the workpiece immediately after grinding as it will be very hot.
- x DO NOT use the grinder as a fixed tool, and DO NOT try to cool the grinding discs with water or other lubricants.
- x DO NOT hold unsecured work in your hand, and DO NOT touch the grinding disc whilst operating, or whilst plugged into the mains power.
- x DO NOT leave the grinder running unattended and DO NOT lay the grinder down whilst running.
- x DO NOT operate the grinder when you are tired or under the influence of alcohol, drugs or intoxicating medication.
- ✓ When not in use switch grinder off, remove plug from power supply and store in safe, dry, childproof area.

**DANGER OF FIRE/EXPLOSION HAZARD**

- ❑ **WARNING!** The grinding process can produce streams of sparks (especially when grinding metal) which are a potential source of ignition.
- x **DO NOT** use the grinder where there are flammable liquids, solids or gases.
- x **DO NOT** allow grinder sparks to make contact with the operator's clothing or any other fabric such as cleaning rags. Fabrics contaminated with inflammable materials such as petrol, oil, grease, paint and solvents are a particular fire hazard.
- ✓ **To reduce the risk of clothing catching fire the operator should wear wool or cotton outer garments treated with a fire retardant in preference to man-made fibres.**

**Risk of Hand Arm Vibration Injury**

Angle Grinder Model No. SGE230 when operated in accordance with these instructions and tested in accordance with EN 28662-2: 1994 results in the following vibration emission declared in accordance with BS EN12096: 1996.

Measured vibration emission value: .....3.1m/s<sup>2</sup>

Uncertainty: .....1.2m/s<sup>2</sup>

**These values are suitable for comparison with emission levels of other tools that have been subject to the same test. This tool may cause hand-arm vibration syndrome if its use is inadequately managed. Recommended Measures to reduce risk of hand-arm vibration syndrome:**

This item represents a low Hand Arm Vibration risk to users. The calculated maximum usage period exceeds 8 hours. We recommend appropriate safety equipment is utilised and regular breaks for the operator are employed to reduce any residual risk of fatigue or repetitive strain injury.

**2. PACKAGE CONTENT & SPECIFICATION**

Remove items from packing and identify parts against fig 1. Check to ensure they are in good order. If any part is damaged contact your supplier immediately.

**CONTENTS**

1. Main body
2. Safety guard
3. Guard clamping washer
4. Screws x 3
5. Bolt x 1
6. Washer x 1
7. Bolt spanner
8. Disc flange
9. Joint ring (inserted into item 8).
10. Disc securing ring.
11. Pin wrench
12. Handle

**SPECIFICATION**

Power ..... 2100Watt  
 No-load speed ..... 6,500rpm  
 Maximum grinding disc size ..... 230mm  
 Spindle thread ..... M14  
 Unit weight ..... 4.1kg

fig 1

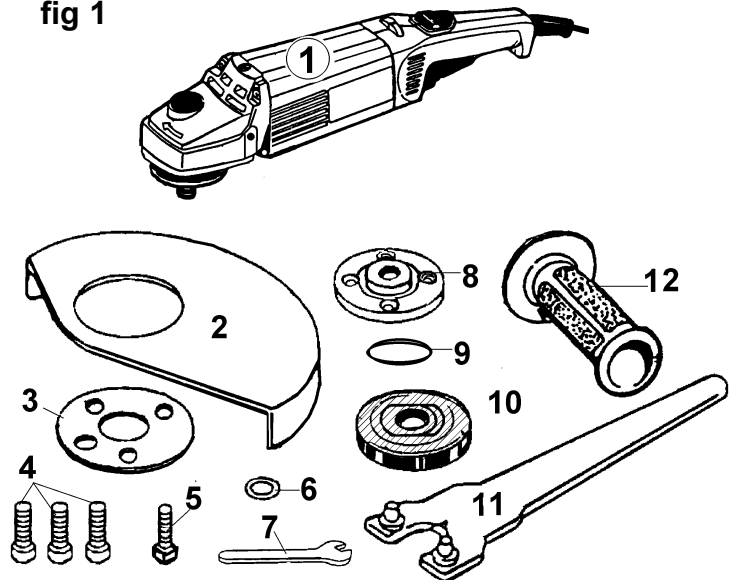

**3. ASSEMBLY**

- ❑ **WARNING!** Ensure the grinder is unplugged from the mains power supply before assembling.

**3.1 ATTACHING/POSITIONING THE GUARD**

The guard (fig 2.1) may be positioned at any angle according to the grinding task required.

- 3.1.1 Position the guard onto the collar (ensure the notch lines up with the slot - fig 2.2), then position to allow maximum working performance whilst providing maximum personal protection for the operator.
- 3.1.2 Lock the guard in place by tightening the quick release lever (fig 2.3).

**3.2 ASSEMBLE GRINDING DISC (Only to be performed by person holding grinding wheel certificate)**

- 3.2.1 Lay the grinder on its back and place the disc flange (fig 5.8) on the centre spindle (fig 3) ensuring the joint ring (fig 5.9) is facing upward. Engage the disc flange (fig 5.8) with the spindle drive flats.
- 3.2.2 Place grinding disc on the spindle.
- 3.2.3 Screw disc securing ring (fig 5.10) with flange facing in if disc is more than 5mm thick, or facing out if disc is less than 5mm thick (figs 3 & 4).
- 3.2.4 Stop the spindle from turning by pushing in and holding stop button (fig 5.C).
- 3.2.5 Lock the grinding disc into place by tightening the disc securing ring (fig 5.10) with the pin wrench (fig 5.11).
- 3.2.6 When complete, release the locking button and check that it has sprung back to its initial position.

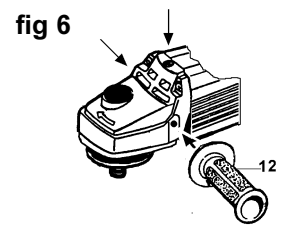
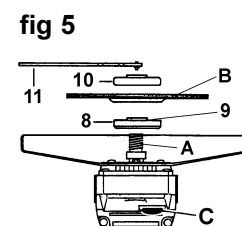
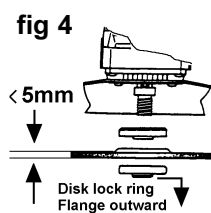
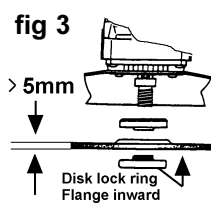
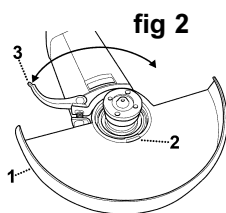

**3.3 HAND GRIP**

Hand grip will allow better control and safety. Fit the hand grip (fig 6.12) by screwing into the left, right or top of the grinder body.

## 4. GRINDING DISCS

- ❑ **WARNING! DO NOT USE DISCS THAT ARE DAMAGED, OR SUSPECTED OF DAMAGE.**  
Before using a grinding disc ensure there are no fissures or cracks. Once mounted on the grinder test the disc before use by facing the grinder in a safe direction (point away from yourself, others and vulnerable items) and run for a short time.
- ▲ **DANGER! Using a damaged disc may cause further damage and/or personal injury.**  
Grinding and cutting discs used in association with this machine shall be of an adequate speed rating and be suitable for the job in hand. The discs shall be made in accordance with British Standard 4481: Part 1 1989. Only persons holding a grinding wheel certificate are authorised to change grinding discs and wheels.

## 5. OPERATING INSTRUCTIONS

- ❑ **WARNING! Ensure grinder is unplugged from the mains power supply before changing accessories.**

### 5.1 PREPARATION

- 5.1.1 Attach grinding disc according to 3.2 and position handle grip to suit the task.
- 5.1.2 Ensure the disc safety guard is correctly fitted.
- 5.1.3 Plug grinder into the mains power supply.

### 5.2 GRINDER ON/OFF SWITCH

A safety switch (fig 7.A) is incorporated to stop the grinder from starting should the ON/OFF switch (fig 7.B) be pressed in error.

- 5.2.1 Once plugged into the mains power supply start the grinder by depressing the safety switch (fig 7.A) then depress the On/Off trigger (fig 7.B) and the grinder will start.

- ❑ **WARNING! When the grinder first starts it will kick to the right, you must ensure therefore that the tool is securely gripped in both hands. Especially important is the position you choose to secure the front handle grip in order to maintain stability.**

- 5.2.2 To switch machine off release the ON/OFF trigger (fig 7.B). the machine will stop and the safety switch will reset itself.
- 5.2.3 For continuous running, press safety switch (fig 7.A) and trigger (fig 7.B). Let go of trigger (fig 7.B) whilst continuing to press (fig 7.A). You may now let go of A and the grinder will continue to operate until the ON/OFF trigger (B) is pressed once again.

- ❑ **WARNING! Before grinding ensure you wear approved safety goggles, ear defenders, appropriate dust mask if grinder generates dust and safety gloves, and that all other safety instructions in chapter 1 are followed carefully.**

### 5.3 GRINDING

The key to effective operating is controlling the pressure and surface contact between the disc and the workpiece.

- ❑ **WARNING! DO NOT switch the grinder on whilst the disc is in contact with the workpiece. Bring the rotating disc to the workpiece.**

- 5.3.1 Allow the disc to reach full speed before starting to grind.
- 5.3.2 Grind flat surfaces at an angle of between 10 to 20 degrees to the workpiece. Too great an angle will cause a concentration of pressure in one small area resulting in gouging or burning of the surface.
- 5.3.3 When grinding is complete allow the workpiece to cool. DO NOT touch the material you have been grinding as the surface will be hot.
- 5.3.4 Unplug the grinder from the mains power supply, clean and store in a safe, dry, childproof area.

fig 7

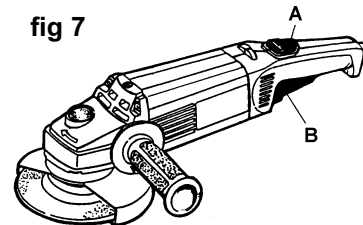

## 6. MAINTENANCE

- ❑ **WARNING! Ensure the grinder is disconnected from the mains power supply before attempting any maintenance.**

### 6.1 CLEANING

Keep the grinder ventilation slots (fig 8.A) clean and free from obstructions. If available, blow compressed air into the vents to clear any internal dust (safety goggles must be worn when undertaking this process). Keep the outer case of the grinder clean and free from grease.

DO NOT wash with water or use solvents or abrasives.

### 6.2 CHANGING THE BRUSHES

- 6.2.1 Remove the brush caps (items 55 & 56 on parts diagram).
- 6.2.2 Release the tension spring from the carbon brush and slide out of the holder.
- 6.2.3 Disconnect the brush spade connection from the terminal.
- 6.2.4 Refitting brushes is a reversal of the above procedure.

fig 8

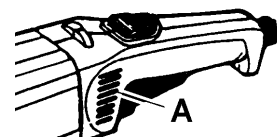

**NOTE:** It is our policy to continually improve products and as such we reserve the right to alter data, specifications and component parts without prior notice. **IMPORTANT:** No liability is accepted for incorrect use of this equipment. **WARRANTY:** Guarantee is 12 months from purchase date, proof of which will be required for any claim. **INFORMATION:** For a copy of our latest catalogue and promotions call us on 01284 757525 and leave your full name and address, including postcode.

**Declaration of Conformity** We, the sole importer into the UK, declare that the product listed here is in conformity with the following standards and directives.

**230MM 2100W ANGLE GRINDER**  
**Model: SGE230**  
98/37/EC Machinery Directive  
73/23/EEC Low Voltage Directive  
89/336/EEC EMC Directive  
93/68/EEC CE Marking Directive



The construction file for this product is held by the Manufacturer and may be inspected, by a national authority, upon request to Jack Sealey Ltd.

For Jack Sealey Ltd.  
Sole importer into the UK  
of Sealey Power Tools.

Signed by Mark Sweetman

A handwritten signature in black ink.

28th February 2005

**SEALEY POWER TOOLS**

Sole UK Distributor, Sealey Group, Bury St. Edmunds, Suffolk.



01284 757500



01284 703534



www.sealey.co.uk



sales@sealey.co.uk