



# 300W HOT AIR REWORK STATION

MODEL NO: **SD007**

Thank you for purchasing a Sealey product. Manufactured to a high standard, this product will, if used according to these instructions, and properly maintained, give you years of trouble free performance.

**IMPORTANT:** PLEASE READ THESE INSTRUCTIONS CAREFULLY. NOTE THE SAFE OPERATIONAL REQUIREMENTS, WARNINGS & CAUTIONS. USE THE PRODUCT CORRECTLY AND WITH CARE FOR THE PURPOSE FOR WHICH IT IS INTENDED. FAILURE TO DO SO MAY CAUSE DAMAGE AND/OR PERSONAL INJURY AND WILL INVALIDATE THE WARRANTY. KEEP THESE INSTRUCTIONS SAFE FOR FUTURE USE.



Refer to instructions



Indoor use only



Hot surfaces

## 1. SAFETY

### 1.1. ELECTRICAL SAFETY

- **WARNING!** It is the user's responsibility to check the following:
  - Check all electrical equipment and appliances to ensure that they are safe before using. Inspect power supply leads, plugs and all electrical connections for wear and damage. Sealey recommend that an RCD (Residual Current Device) is used with all electrical products. You may obtain an RCD by contacting your local Sealey stockist.
  - If the product is used in the course of business duties, it must be maintained in a safe condition and routinely PAT (Portable Appliance Test) tested.
  - Electrical safety information:** it is important that the following information is read and understood.
- 1.1.1. Ensure that the insulation on all cables and on the appliance is safe before connecting it to the power supply.
- 1.1.2. Regularly inspect power supply cables and plugs for wear or damage and check all connections to ensure that they are secure.
- 1.1.3. **Important:** Ensure that the voltage rating on the appliance suits the power supply to be used and that the plug is fitted with the correct fuse - see fuse rating in these instructions.
  - × **DO NOT** pull or carry the appliance by the power cable.
  - × **DO NOT** pull the plug from the socket by the cable.
  - × **DO NOT** use worn or damaged cables, plugs or connectors. Ensure that any faulty item is repaired or replaced immediately by a qualified electrician.
- 1.1.4. This product is fitted with a BS1363/A 3 pin plug.
  - If the cable or plug is damaged during use, switch the electricity supply and remove from use. Ensure that repairs are carried out by a qualified electrician.
  - Replace a damaged plug with a BS1363/A 3 pin plug. If in doubt contact a qualified electrician.
  - A) Connect the GREEN/YELLOW earth wire to the earth terminal 'E'.
  - B) Connect the BROWN live wire to the live terminal 'L'.
  - C) Connect the BLUE neutral wire to the neutral terminal 'N'.
  - Ensure that the cable outer sheath extends inside the cable restraint and that the restraint is tight. Sealey recommend that repairs are carried out by a qualified electrician.

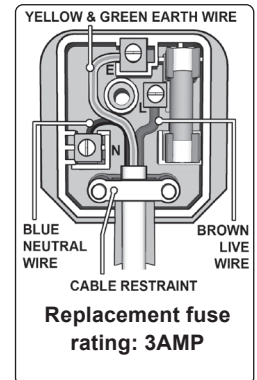

## 2. INTRODUCTION

300W Hot air rework station with automatic cooling system. LED digital display, showing current temperature and status. MCU confirms fast heat up, accurate & stable control on temperature. Temperature Range: 100-500°C. Suitable for desoldering work on various components such as SOIC, CHIP, QFP, PLCC and BGA. Includes three nozzles.

## 3. SPECIFICATION

MODEL NO:.....SD007  
 Electrical Plug Type:.....3-Pin BS  
 Frequency:.....50Hz  
 Power:.....300W  
 Temperature Range ..... 100-500°C(212-932°F)

## 4. OPERATION

- 4.1. **ATTACHING AND REMOVING THE NOZZLE**
  - × **DO NOT** press the Nozzle or pull on the edge of the Nozzle with pliers.
  - 4.1.1. Push the nozzles into position. Note: Try to use nozzles with a larger diameter.
  - **WARNING!** Wait for nozzle to completely cool before removing it.
- 4.2. **OVERHEAT PROTECTION**
  - 4.2.1. Power will automatically be off when the unit exceeds a certain temperature. Once the temperature has dropped to a safety level, power will automatically be turned on.
- 4.3. Plug in mains socket.
- 4.4. Turn on the power switch, set the air flow rate and temperature and put the unit on the rack.
- 4.5. Put the nozzle on the pins of the Integrated Circuit, so that the hot air can melt the solder tin on the Integrated Circuit pin, then use

the tweezers to remove the Integrated Circuit.

4.6. After use, turn off the power switch, remove the plug from the power supply and allow to cool before storing in a safe place out of children's reach.

4.7. The display and temperature setting

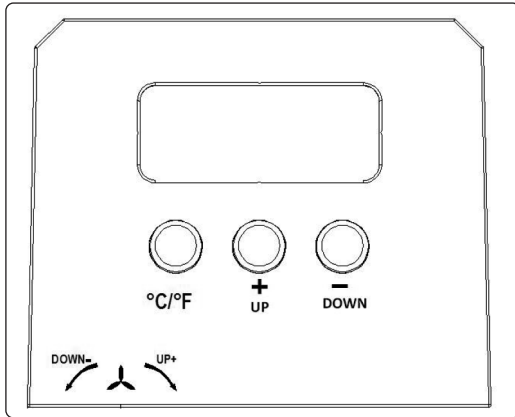

4.7.1. Press the button "+(UP)" or "-(DOWN)" to adjust the temperature.

Short press, the set-point will change  $\pm 1^\circ$

Long press, the set-point will change quickly and reach your target temperature.

4.7.2. "°C/ °F" is the transfer button between °C/ °F

The default unit is °C, press the "°C/ °F" button to make change between °C and °F.

4.7.3. The air flow rate can be adjusted by the knob under the fan symbol.

rotate the knob to the DOWN - side, the air flow slows down;

you rotate the knob to the UP + side, the air flow goes up;

4.7.4. This unit has a sleep function.

When you put the air pump on the rack, the item will stop heating, And the display shows "SLP" ( means SLEEP), when you pick up the air pump , the item will get back to the set temperature.

#### 4.8. WASHING

4.8.1. When de-solder is completed, wash away the flux.



#### ENVIRONMENT PROTECTION

Recycle unwanted materials instead of disposing of them as waste. All tools, accessories and packaging should be sorted, taken to a recycling centre and disposed of in a manner which is compatible with the environment. When the product becomes completely unserviceable and requires disposal, drain any fluids (if applicable) into approved containers and dispose of the product and fluids according to local regulations.



#### WEEE REGULATIONS

Dispose of this product at the end of its working life in compliance with the EU Directive on Waste Electrical and Electronic Equipment (WEEE). When the product is no longer required, it must be disposed of in an environmentally protective way. Contact your local solid waste authority for recycling information.

**Note:** It is our policy to continually improve products and as such we reserve the right to alter data, specifications and component parts without prior notice.

**Important:** No Liability is accepted for incorrect use of this product.

**Warranty:** Guarantee is 12 months from purchase date, proof of which is required for any claim.

Sealey Group, Kempson Way, Suffolk Business Park, Bury St Edmunds, Suffolk. IP32 7AR



01284 757500



01284 703534



sales@sealey.co.uk



www.sealey.co.uk