



RECHARGEABLE PRESSURE SPRAYER 2L

MODEL NO: **SCSG2R.V2**

Thank you for purchasing a Sealey product. Manufactured to a high standard, this product will, if used according to these instructions, and properly maintained, give you years of trouble free performance.

IMPORTANT: PLEASE READ THESE INSTRUCTIONS CAREFULLY. NOTE THE SAFE OPERATIONAL REQUIREMENTS, WARNINGS & CAUTIONS. USE THE PRODUCT CORRECTLY AND WITH CARE FOR THE PURPOSE FOR WHICH IT IS INTENDED. FAILURE TO DO SO MAY CAUSE DAMAGE AND/OR PERSONAL INJURY AND WILL INVALIDATE THE WARRANTY. KEEP THESE INSTRUCTIONS SAFE FOR FUTURE USE.



Refer to instructions



Wear eye protection



Wear protective gloves



Wear protective clothing



Wear a mask



Wear respiratory protection

1. SAFETY

- ✓ Only use the sprayer for its intended purpose.
- ✓ Familiarise yourself with the applications, limitations and potential hazards of this product.
- ✓ Replace or repair damaged parts. Use recommended parts only. Unauthorised parts may be dangerous and will invalidate the warranty.
- ✓ Always inspect and prepare the sprayer before use according to the instructions contained in this manual.
- ✗ **DO NOT** use the sprayer if it is damaged, altered, modified, in poor condition, leaking fluids or has any missing components.
- ✗ **DO NOT** alter the sprayer in any way.
- ✗ **DO NOT** use the sprayer for spraying flammable materials.
- **WARNING!** Ensure you are fully aware of all the potential hazards of the material being sprayed. Read and understand the warnings and instructions on the container or the supplied manufacturers information.
- ✗ **DO NOT** spray any material where the hazards are not known.-consult MSDS safety details of sprayed liquid.
- ✓ Ensure that the spray containers cannot easily be knocked over during filling.
- ✓ Mark fluid containers with hazard labels to show its chemical contents, even if its water.
- ✓ It is highly recommended that individual fluid containers should be used only for one type of specific agent.
- ✓ Keep any fluid containers in a well ventilated, lockable store.
- ✓ Keep children and unauthorised persons away from the working area, especially during the spraying operation.
- ✓ Maintain the sprayer in good condition and keep clean to maintain safest performance.
- ✓ Ensure that the fluid containers cannot easily be knocked over when transferring unused fluid back into it.
- ✓ Keep the sprayer turned off.
- ✓ Keep the fluid reservoir tank firmly closed to prevent any spillage.
- ✓ Be aware of wind direction whilst spraying. Spray from upwind to downwind to prevent direct chemical contact with your body.
- ✗ **DO NOT** spray when the wind speed is in excess of 4mph.
- ✗ **DO NOT** over apply pesticide. Only apply at the manufacturer's recommended rate. Excess pesticide can be hazardous to humans, wild life, damage plants and contaminate soil and water sources.
- ✗ **DO NOT** eat, drink, rub your eyes, or touch any part of your bare skin whilst handling fluids or when spraying. If chemical(s) come into contact with skin, immediately wash thoroughly with soap and water.
- ✗ **DO NOT** spray near open flames or other sources of heat.
- ✗ **DO NOT** smoke or use an open flame anywhere near the sprayer or around stored fluids.
- ✓ Maintain correct balance and footing. Ensure the floor is not slippery and wear non-slip shoes.
- ✗ **DO NOT** operate the sprayer when you are tired or under the influence of alcohol, drugs or intoxicating medication.
- ✓ Always clean up any spills immediately as per fluid manufacturers instructions.
- ✗ **DO NOT** spray at people, animals or protected insect species.
- ✓ Select the appropriate chemical which offers the best solution to your pest or weed problem.
- **WARNING!** When mixing chemicals, thoroughly read and understand the manufacturers instructions.
- **WARNING!** Inappropriately mixed chemicals may harm people and damage crops or plants.
- ✓ Always mix chemicals prior to adding the solution to the sprayers tank reservoir.
- ✓ Ensure the sprayers tank reservoir is filled prior to use. Operating the sprayer with an empty tank may damage the pump.
- **WARNING!** If the spraying stops running, or an abnormal sound is emitted immediately switch off.
- **WARNING!** Wear appropriate PPE (Personal Protective Equipment). To avoid inhalation and/or skin or eye contact with the chemical wear, protective goggles, protective mask, rubber gloves, long sleeved waterproof jacket, long trousers and Wellington boots.
- ✓ Operators, whose physical, sensory or mental capabilities prevents them from safely using the sprayer, must be under the supervision of a person who has a thorough knowledge and experience of the sprayer and the appropriate regulations.
- ✗ **DO NOT** allow children or untrained persons to operate the sprayer.
- ✗ **DO NOT** Overfill or tilt the bottle to the point where the liquid covers the air inlet as the pump/motor will still run but the unit will stop dispensing and can cause possible damage to the unit.
- **WARNING! The warnings, cautions and instructions discussed in this instruction manual cannot cover all possible conditions and situations that may occur. It must be understood that common sense and caution are factors which cannot be built into this product, but must be applied by the operator.**

2. INTRODUCTION

Suitable for use with most detergents, pesticides and non-solvent based fluids. Electric motor powered by integrated 3.6V 1.5Ah Li-ion battery with 80mins run time. Convenient screw top for storing the USB charging cable. Adjustable nozzle with mist and jet spray patterns. 2L Working capacity with level indicator. USB charging cable supplied.

3. SPECIFICATION

Model No	SCSG2R.V2
Battery	3.6V 1500mAh Li-ion
Charging Time	210mins
Nett Weight	0.59kg
Operating Time	80mins
Total Capacity	2.2L
Working Capacity	2L

4. FEATURES

ITEM	DESCRIPTION
1	Cap to house USB Charging Cable
2	Control handle
3	Fluid tank reservoir
4	Nozzle
5	Power switch
6	Spray pipe
7	USB charging cable
8	Water pipe

5. OPERATION

NOTE: Ensure all Safety Instructions in Section 1 are read and understood and carried out before use and save the instructions and warnings for future reference.

5.1. CHARGE BATTERY

5.1.1. Charging port is located in the bottom of handle assembly. Charging cable is stored in screw top, fig.1. Charging indication fig.2

5.2. POWER SWITCH

- WARNING!** To prevent sudden spraying ensure that the trigger lever is in the stop position and the power switch is in the OFF position.

5.2.1. Grip the handle and rotate the vessel to separate (fig.1).

5.2.2. **NOTE:** While charging the sprayer will not operate.

5.3. FILLING THE TANK

- WARNING!** When filling the tank wear appropriate PPE.
- WARNING! DO NOT** fill tank in a poorly ventilated area.
- WARNING!** Ensure that all chemical mixtures are thoroughly dissolved prior to use.
- WARNING!** Take extreme care when handling chemicals. Wear appropriate PPE. Wash thoroughly away any chemicals that comes into contact with bare skin. - consult MSDS
- WARNING!** Chemicals are harmful. Always read and fully understand the manufacturer's instructions before use.

5.3.1. Fill to a maximum of 2 litre (observe the graduated scale moulded into the vessel).

5.3.2. Re-attach vessel keeping vertical, rotate until hand tight against neck seal.

5.3.3. To turn the sprayer on, press down the I (ON) on the power switch (fig.1.).

5.3.4. To turn the sprayer off, press down the O (OFF) on the power switch (fig.1).

5.3.5. The spray pattern may be changed by rotating the adjustable nozzle.

5.4. SPRAY ADJUSTMENT

5.4.1. To adjust the intensity of the spraying turn the adjustment button clockwise to increase and anticlockwise to decrease

- × **DO NOT** operate the sprayer with an empty tank. Turn OFF immediately.

- WARNING!** Prolonged continuous use of the sprayer will drain the battery and may cause damage to the pump. Switch OFF the sprayer whenever possible.

- WARNING!** If the sprayer starts to make abnormal noises and/or the spray splutters this indicates that the tank is empty. Switch OFF immediately.

6. MAINTENANCE

6.1. **DO NOT** attempt any maintenance or repairs that are not included in this manual.

- × **DO NOT** use solvents to clean sprayer.

6.2. AFTER USE MAINTENANCE

6.2.1. Dispose of any residual liquid from the sprayer tank, by returning it back to it's original container. Clean up any spills immediately as per fluid manufactures instructions.

6.2.2. Wash out the tank with clean water and after cleaning, pour the water into a suitable container.

6.2.3. Wipe away any remaining moisture with a dry cloth.

NOTE: Dispose of any contaminated water properly according to local regulations.

6.3. Wash out the sprayer as section and ensure that the sprayer is completely free from moisture.

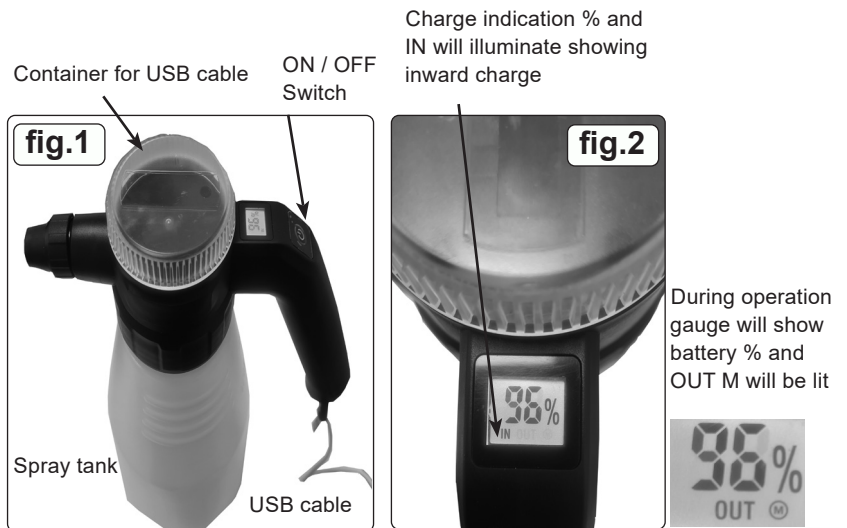

6.4. Store the sprayer in a child free, safe, clean, dry indoor location that is away from direct sunlight, has good ventilation and does not freeze.

WARNING! Frozen liquids that remain in the sprayer may cause breakdown or damage to the pump during operation.

7. TROUBLESHOOTING

PROBLEM		POSSIBLE CAUSE	SOLUTION
Motor (pump) will not work	Switch set at OFF	The switch is set to OFF	Set switch to ON
	Switch set at ON	No battery charge	Recharge the battery.
		Wiring connector is disconnected	Repair at authorised Sealey service centre
		Wiring break	Repair at authorised Sealey service centre
		ON-OFF switch broken	Repair at authorised Sealey service centre
		Motor (pump) not working	Repair at authorised Sealey service centre
Pump is working but no spray is coming out	Blocked nozzle	Clean or replace	
	Chemical tank is empty	Refill with required liquid	
	Blocked piping	Repair at authorised Sealey service centre	
	Broken or cracked piping	Repair at authorised Sealey service centre	
	Disconnected or broken piping	Repair at authorised Sealey service centre	
	Blocked piping	Repair at authorised Sealey service centre	
	Broken or cracked piping	Repair at authorised Sealey service centre	
	Disconnected or broken piping	Repair at authorised Sealey service centre	
	Blocked control handle strainer	Remove and clean	
Abnormal sound when sprayer is switched ON	Broken pump drive coupling	Repair at authorised Sealey service centre	
	Blocked nozzle	Clean or replace	



BATTERY REMOVAL

Under the Waste Batteries and Accumulators Regulations 2009, Jack Sealey Ltd are required to inform potential purchasers of products containing batteries (as defined within these regulations), that they are registered with Valpak's registered compliance scheme. Jack Sealey Ltd's Batteries Producer Registration Number (BPRN) is BPRN00705.



WEEE REGULATIONS

Dispose of this product at the end of its working life in compliance with the EU Directive on Waste Electrical and Electronic Equipment (WEEE). When the product is no longer required, it must be disposed of in an environmentally protective way. Contact your local solid waste authority for recycling information.



ENVIRONMENT PROTECTION

Recycle unwanted materials instead of disposing of them as waste. All tools, accessories and packaging should be sorted, taken to a recycling centre and disposed of in a manner which is compatible with the environment. When the product becomes completely unserviceable and requires disposal, drain any fluids (if applicable) into approved containers and dispose of the product and fluids according to local regulations.



REGISTER YOUR PURCHASE HERE

Note: It is our policy to continually improve products and as such we reserve the right to alter data, specifications and component parts without prior notice.

Important: No Liability is accepted for incorrect use of this product.

Warranty: Guarantee is 12 months from purchase date, proof of which is required for any claim.

Sealey Group, Kempson Way, Suffolk Business Park, Bury St Edmunds, Suffolk. IP32 7AR



01284 757500



sales@sealey.co.uk



www.sealey.co.uk