

Thank you for purchasing a Sealey product. Manufactured to a high standard, this product will, if used according to these instructions, and properly maintained, give you years of trouble free performance.

IMPORTANT: PLEASE READ THESE INSTRUCTIONS CAREFULLY. NOTE THE SAFE OPERATIONAL REQUIREMENTS, WARNINGS & CAUTIONS. USE THE PRODUCT CORRECTLY AND WITH CARE FOR THE PURPOSE FOR WHICH IT IS INTENDED. FAILURE TO DO SO MAY CAUSE DAMAGE AND/OR PERSONAL INJURY AND WILL INVALIDATE THE WARRANTY. KEEP THESE INSTRUCTIONS SAFE FOR FUTURE USE.



Refer to instruction manual



Wear eye protection



Wear ear protection



Wear a mask



Wear protective gloves

1. SAFETY

- WARNING!** Ensure that Health & Safety, local authority and general workshop practice regulations are adhered to when using this equipment. See the notes at the end of the instructions regarding prolonged exposure to vibration.
- ✓ Familiarise yourself with the applications, limitations and potential hazards peculiar to the nibbler.
- WARNING!** Disconnect the nibbler from the air supply before changing accessories, servicing or performing any maintenance.
- ✓ Maintain the nibbler in good condition (use an authorised service agent).
- ✓ Replace or repair damaged parts. *Use genuine parts only. Unauthorised parts may be dangerous and will invalidate the warranty.*
- ✓ Keep the work area clean, uncluttered and ensure that there is adequate lighting.
- ✓ Keep the nibbler clean for best and safest performance.
- WARNING!** Always wear approved eye or face protection when operating the nibbler.
- ✓ Maintain correct balance and footing. Ensure the floor is not slippery and wear non-slip shoes.
- ✓ Remove ill fitting clothing. Remove ties, watches, rings and other loose jewellery and contain, and/or tie back, long hair.
- ✓ Keep the nibbler away from your body and at a safe distance from others.
- ✓ Keep children and unauthorised persons away from the work area.
- ✓ Secure unstable workpiece with a clamp, vice or other adequate holding device.
- ✓ Ensure that spent punchings are disposed of correctly and do not cause a hazard.
- WARNING!** Ensure that the correct air pressure is maintained and not exceeded.
- ✓ Keep air hose away from heat, oil and sharp edges. Check air hose for wear before each use and ensure all connections are secure.
- ✗ **DO NOT** use the nibbler for any purpose other than that for which it is designed.
- ✗ **DO NOT** operate the nibbler if any parts are damaged or missing.
- ✗ **DO NOT** carry the nibbler operating the trigger, by the hose or yank the hose from the air supply.
- ✗ **DO NOT** get the nibbler wet or use in damp or wet locations or areas where there is condensation.
- ✗ **DO NOT** allow untrained persons to operate the nibbler.
- ✗ **DO NOT** operate the nibbler when you are tired or under the influence of alcohol, drugs or intoxicating medication.
- ✗ **DO NOT** direct air from the air hose at yourself or others.
- ✓ When not in use disconnect from the air supply and store in a safe, dry, childproof area.
- WARNING! – RISK OF HAND ARM VIBRATION INJURY**
This tool may cause Hand Arm Vibration Syndrome if its use is not managed adequately.
This tool is subject to the vibration testing section of the Machinery Directive 2006/42/EC.
This tool is to be operated in accordance with these instructions.
This tool has been tested in accordance with: EN ISO 28927-7: 2009 & BS EN ISO 15744:2008.
Declaration and verification of Vibration Emission figures are in accordance with EN 12096: 1997
Measured vibration emission value (a): 8.73 m/s²
Uncertainty value(k):3.33 m/s²
Please note that the application of the tool to a sole specialist task may produce a different average vibration emission. We recommend that a specific evaluation of the vibration emission is conducted prior to commencing with a specialist task.
A health and safety assessment by the user or employer will need to be carried out to determine the suitable duration of use for each tool.
NB: Stated Vibration Emission values are type-test values and are intended to be typical.
Whilst in use, the actual value will vary considerably and depend on many factors, such as the operator, task, inserted tool/consumable.
NB: ensure that the length of leader hoses is sufficient to allow unrestricted use, as this also helps to reduce vibration.
The state of maintenance of the tool itself is also an important factor, a poorly maintained tool will also increase the risk of Hand Arm Vibration Syndrome.

1.1. HEALTH SURVEILLANCE

We recommend a programme of health surveillance to detect early symptoms of vibration injury so that management procedures can be modified accordingly.

1.2. PERSONAL PROTECTIVE EQUIPMENT

We are not aware of any personal protective equipment (PPE) that provides protection against vibration injury that may result from the uncontrolled use of this tool. We recommend a sufficient supply of clothing (including gloves) to enable the operator to remain warm and dry and maintain good blood circulation in fingers etc. Please note that the most effective protection is prevention, please refer to the Correct Use and Maintenance section in these instructions. Guidance relating to the management of hand arm vibration can be found on the HSC website www.hse.gov.uk - Hand-Arm Vibration at Work.

2. INTRODUCTION

Composite cover moulded around lightweight aluminium alloy housing reduces effects of chill on operator's hands and provides added control. Air motor with quality bearings for smooth and powerful operation. Exhaust outlet adjusts 360°, keeping airflow away from operator. Suitable for cutting intricate shapes in steel up to 1.5mm thick. Punch and die may be rotated through 360° to aid access and obtain maximum consumable life.

3. SPECIFICATION

Model No:..... SA649
 Air Consumption: 4cfm
 Consumable Parts: SA649.41 - Replacement Punch
 SA649.43 - Replacement Die
 Free Speed: 3200spm
 Inlet Size: 1/4" BSP
 Maximum Cutting Capacity: 1.5mm (Steel)
 Noise Power/Pressure: 97/86dB(A)
 Operating Pressure: 90psi
 Vibration/Uncertainty: 8.73/3.33m/s²

4. AIR SUPPLY

NOTE: The recommended air system is shown in fig.1.

- ✓ Ensure that the air pressure is set correctly (90psi).
- ❑ **WARNING!** Ensure that the air supply is clean and does not exceed 90psi. Too high an air pressure and/or unclean air will shorten the life of the nibbler due to accelerated wear, and may cause damage and/or personal injury.
- ✓ Drain the compressor air tank daily. Water in the air line will damage the riveter.
- ✓ Clean the compressor air inlet filter screen weekly.
- ✓ Line pressure should be increased to compensate for unusually long air hoses (over 8 metres).
- ✓ The minimum hose bore should be 10mm and fittings must have the same inside dimensions.
- ✓ Keep hoses away from heat, oil and sharp edges.
- ✓ Check hoses for wear, and make certain that all connections are secure.

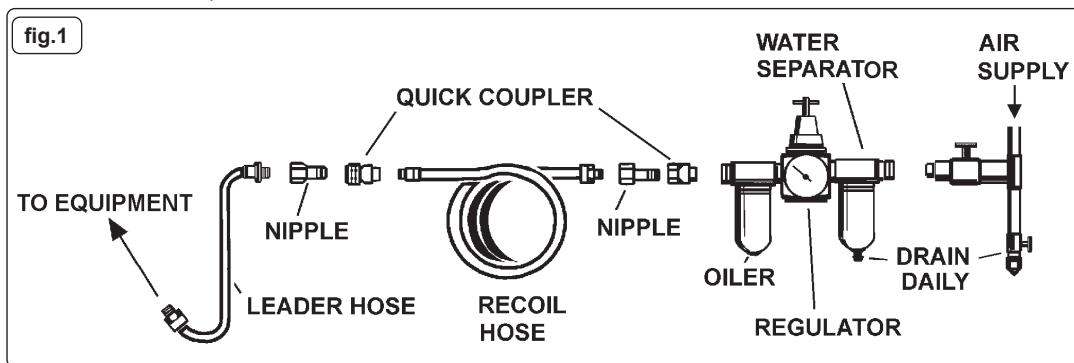

5. OPERATION

NOTE: Numbers refer to attached parts list.

- ❑ **WARNING!** Ensure you read, understand and apply the Section 1 safety instructions. This tool is designed for nibbling sheet metal, primarily in workshops and garages. We do not recommend it for any other use or materials.

5.1. CHANGING THE PUNCH AND/OR DIE

- 5.1.1. Disconnect nibbling tool from the air line.
- 5.1.2. Note the orientation of the die Ø7 hole revealing the waisted part of the punch. This hole faces the feed direction of the nibbler.
- 5.1.3. Grip the nibbler head (37) in a soft jaw vice.
- 5.1.4. With a 28mm A/F spanner undo the barrel nut (item 44).
- 5.1.5. Remove the die, which has four grooves in the mounting flange. These grooves enable four nibbler positions at 90° intervals.
- 5.1.6. Remove the punch by unscrewing the set screw (42) with a 9mm A/F spanner.
- 5.1.7. Inspect the punch and die for wear, replace or renew by reversing removal procedure.
- 5.1.8. Apply grease liberally to both punch and die when fitting and anticipate the nibbling direction.

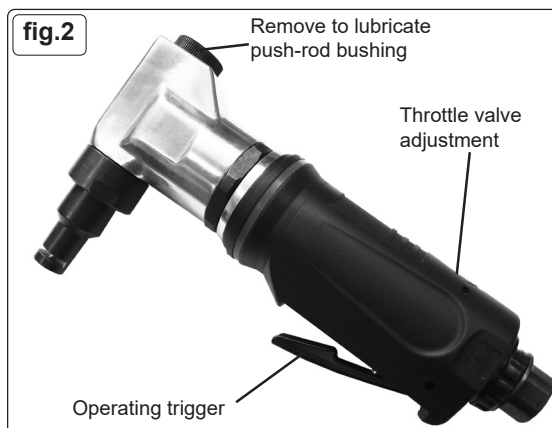

5.2. OPERATING INSTRUCTIONS

- 5.2.1. Disconnect the nibbling tool from the air line.
- 5.2.2. If required, to improve access to the workpiece, the die can be rotated in 90° intervals through 360°.
- 5.2.3. Ensure that the workpiece is marked out and secure.
- 5.2.4. Connect the air line to the nibbler.
- 5.2.5. Start the nibbler by depressing the trigger and introduce the nibbler die slot to the sheet metal to be shaped.
- 5.2.6. Apply light pressure only to move the tool in the desired direction through the metal.
- 5.2.7. The design shave depth is 0.6mm per stroke and the punch is Ø4.4mm, shearing efficiency can be affected using the adjustable throttle valve situated in the moulded handle and shown in fig.3.
- 5.2.8. Exhaust air can be directed away from the user by rotating the exhaust baffle shown in fig.3.

6. MAINTENANCE

- WARNING!** Disconnect the nibbler from the air supply before changing the punch and die, servicing or performing maintenance.
- ✓ Replace or repair damaged parts using genuine parts only.
- WARNING!** Nonauthorised parts may be dangerous and will invalidate the warranty.
- 6.1. If the air system does not have an oiler, lubricate the air nibbler daily with a few drops of the air tool oil, dripped into the air inlet before use. To order air tool oil use Sealey part Nos. ATO/500 or ATO1000.
- 6.2. Loss of power or erratic action may be due to the following:
 - a). Excessive drain on the air line. Moisture or restriction in the air pipe. Incorrect size or type of hose connectors. To remedy, check the air supply and follow instructions in section 4.
 - b). Grit or gum deposits in the nibbler may also reduce performance. If your model has an air strainer (located in the area of the air inlet), remove the strainer and clean it. Flush the nibbler out with gum solvent oil or an equal mixture of SAE No 10 oil and kerosene. Allow to dry before use. If you continue to experience problems, contact your local Sealey service agent.
- 6.3. For a full service contact your local Sealey service agent.
 - ✓ When not in use, disconnect from air supply, clean nibbler and store in a safe, dry, childproof location.



ENVIRONMENT PROTECTION

Recycle unwanted materials instead of disposing of them as waste. All tools, accessories and packaging should be sorted, taken to a recycling centre and disposed of in a manner which is compatible with the environment. When the product becomes completely unserviceable and requires disposal, drain any fluids (if applicable) into approved containers and dispose of the product and fluids according to local regulations.



REGISTER YOUR
PURCHASE HERE

Note: It is our policy to continually improve products and as such we reserve the right to alter data, specifications and component parts without prior notice.

Important: No Liability is accepted for incorrect use of this product.

Warranty: Guarantee is 36 months from purchase date, proof of which is required for any claim.

Sealey Group, Kempson Way, Suffolk Business Park, Bury St Edmunds, Suffolk. IP32 7AR



01284 757500



sales@sealey.co.uk



www.sealey.co.uk