



INSTRUCTIONS FOR

# 1" AIR IMPACT WRENCH (SUPER HEAVY DUTY)

## Model: SA291

Thank you for purchasing a Sealey Product. Manufactured to a high standard this product will, if used according to these instructions and properly maintained, give you years of trouble free performance.

**⚠ IMPORTANT: PLEASE READ THESE INSTRUCTIONS CAREFULLY. NOTE THE SAFE OPERATIONAL REQUIREMENTS, WARNINGS AND CAUTIONS. USE THIS PRODUCT CORRECTLY AND WITH CARE FOR THE PURPOSE FOR WHICH IT IS INTENDED. FAILURE TO DO SO MAY CAUSE DAMAGE AND/OR PERSONAL INJURY AND WILL INVALIDATE THE WARRANTY. PLEASE KEEP INSTRUCTIONS SAFE FOR FUTURE USE.**

### 1. SAFETY INSTRUCTIONS

- ✓ Follow all workshop safety rules, regulations and conditions when using wrench.
- ❑ **WARNING!** Disconnect from air supply before changing accessories or servicing.
- ✓ Maintain the wrench in good condition and replace any damaged or worn parts. *Use genuine parts only. Unauthorised parts may be dangerous and will invalidate the warranty.*
- ❑ **WARNING!** Check correct air pressure is maintained and not exceeded. We recommend 90psi.
- ✓ Keep air hose away from heat, oil and sharp edges. Check air hose for wear before each use and ensure that all connections are secure.
- ✓ Only use impact sockets which are specifically designed for use with an impact wrench.
- ✓ Wear approved safety eye/face shield, ear defenders and hand protection.
- ❑ **WARNING!** Due to the possible presence of asbestos dust from brake linings, when working around vehicle brake systems we recommend you wear suitable respiratory protection.
- ✓ Maintain correct balance and footing. Ensure the floor is not slippery and wear non-slip shoes.
- ✓ Keep children and non essential persons away from the working area.
- x DO NOT use the wrench for a task it is not designed to perform.
- ❑ **WARNING! DO NOT** use wrench if damaged or thought to be faulty. (Contact Service Agent).
- x DO NOT use wrench unless you have been instructed in its use by a qualified person.
- x DO NOT carry the wrench by the air hose, or yank the hose from the air supply.
- x DO NOT operate wrench if you are tired or under the influence of alcohol, drugs or intoxicating medication.
- x DO NOT carry wrench with your finger on the power trigger in order to avoid unintentional starting.
- x DO NOT direct air from the air hose at yourself or others.
- ✓ When not in use disconnect from air supply and store in a safe, dry, childproof location.

### 2. INTRODUCTION & SPECIFICATIONS

Manufactured in Japan and suitable for heavy commercial tyre shop, fleet and workshop use. Features air/torque device, to control power output, and reverse action. Long pattern anvil gets into deep wheel dishes. Supplied with side handle.

Drive size . . . . . 1"	Operating pressure . . . . . 90psi
Working max torque . . . . . 1200lb.ft	Air inlet size . . . . . 1/2" BSP
Air consumption . . . . . 21cfm	Weight . . . . . 14.2kg

### 3. PREPARING WRENCH FOR USE

#### 3.1. Air Supply

Recommended hook-up procedure is shown in fig 1.

- 3.1.1. Ensure wrench air valve (or trigger) is in the "off" position before connecting to the air supply.
- 3.1.2. You will require an air pressure of 90psi, and an air flow according to specification.
- 3.1.3.  **WARNING!** Ensure the air supply is clean and does not exceed 90 psi while operating the wrench. Too high an air pressure and unclean air will shorten the product life due to excessive wear and may be dangerous, causing damage and/or personal injury.
- 3.1.4. Drain the air tank daily. Water in the air line will damage the wrench.
- 3.1.5. Clean air inlet filter weekly.
- 3.1.6. Line pressure should be increased to compensate for unusually long air hoses (over 8 metres). The minimum hose diameter should be 1/2" I.D. and fittings must have the same inside dimensions.
- 3.1.7. Keep hose away from heat, oil and sharp edges. Check hose for wear, and make certain that all connections are secure.

#### 3.2. Couplings.

Vibration may cause failure if a quick change coupling is connected directly to the wrench. To overcome this, connect a leader hose to the wrench. A quick change coupling may then be used to connect the leader hose to the air line recoil hose. See fig 1 & 2.

fig 1

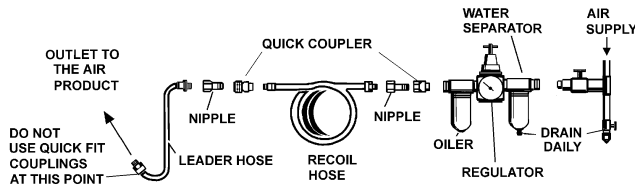
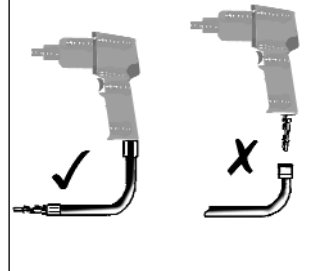

fig 2



### 4. OPERATING INSTRUCTIONS

**WARNING!** Ensure you read, understand and apply safety instructions before use.

- 4.1. Only use impact sockets which are specifically designed for use with a impact wrench.
- 4.2. Connect the wrench to the air hose as in chapter 3.
- 4.3. Place the socket over the subject fixing and depress the trigger to operate the wrench.
- 4.4. To change wrench direction, rotate the control nut left or right.
- 4.5. The air flow is also regulated by turning the control nut.

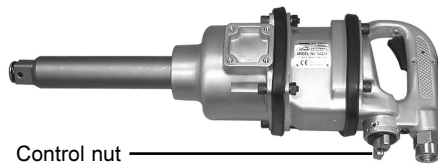

DO NOT use any additional force upon the wrench in order to remove a fixing.  
DO NOT allow wrench to free run for an extended period of time as this will shorten its life.

### 5. MAINTENANCE

- WARNING!** Disconnect wrench from air supply before changing accessories, servicing or performing maintenance. Replace or repair damaged parts. *Use genuine parts only. Unauthorised parts may be dangerous and will invalidate the warranty.*
- 5.1. If the air supply does not have an oiler, lubricate the wrench daily with a few drops of Sealey air tool oil dripped into the air inlet.
- 5.2. Clean the wrench after use. DO NOT use worn, or damaged sockets.
- 5.3. Loss of power or erratic action may be due to the following:
  - a) Excessive drain on the air line. Moisture or restriction in the air pipe. Incorrect size or type of hose connectors. To remedy check the air supply and follow instructions in chapter 3.
  - b) Grit or gum deposits in the wrench may also reduce performance. If your model has an air strainer (located in the area of the air inlet), remove the strainer and clean it. Flush the wrench out with gum solvent oil or an equal mixture of SAE No 10 oil and paraffin. Allow to dry before use.
- 5.4. For a full service contact your local Sealey service agent.
- 5.5. When not in use, disconnect from air supply, clean wrench and store in a safe, dry, childproof location.

#### Risk of Hand Arm Vibration Injury

1" SUPER HEAVY DUTY AIR IMPACT WRENCH. SA291 when operated in accordance with these instructions and tested in accordance with EN 28662-2: 1994 results in the following vibration emission declared in accordance with BS EN12096: 1996.

Measured vibration emission value: . . . . .3.0m/s<sup>2</sup>

Uncertainty: . . . . .1.2m/s<sup>2</sup>

**These values are suitable for comparison with emission levels of other tools that have been subject to the same test.**

**This tool may cause hand-arm vibration syndrome if its use is inadequately managed.**

**Recommended Measures to reduce risk of hand-arm vibration syndrome:**

This item represents a low Hand Arm Vibration risk to users. The calculated minimum usage period exceeds 8 hours. We recommend appropriate safety equipment is utilised and regular breaks for the operator are employed to reduce any residual risk of fatigue or repetitive strain injury.

### Declaration of Conformity

**CE** We, the sole importer into the UK, declare that the product listed here is in conformity with the following standards and directives. The construction file for this product is held by the Manufacturer and may be inspected, by a national authority, upon request to Jack Sealey Ltd.

**SUPER HEAVY DUTY AIR IMPACT WRENCH**

**Model: SA291**

98/37/EC Machinery Directive

93/68/EEC Marking Directive

Signed by Mark Sweetman

7th September 2004

For Jack Sealey Ltd. Sole importer into the UK of Sealey Power Tools.

**NOTE:** It is our policy to continually improve products and as such we reserve the right to alter data, specifications and component parts without prior notice. **IMPORTANT:** No liability is accepted for incorrect use of this equipment.

**WARRANTY:** Guarantee is 12 months from purchase date, proof of which will be required for any claim.

**INFORMATION:** For a copy of our latest catalogue and promotions call us on 01284 757525 and leave your full name and address, including postcode.

<b>SEALEY</b> Professional TOOLS	Sole UK Distributor Sealey Group, Bury St. Edmunds, Suffolk.	01284 757500	Web address: <a href="http://www.sealey.co.uk">www.sealey.co.uk</a>
		01284 703534	E-mail: <a href="mailto:sales@sealey.co.uk">sales@sealey.co.uk</a>