



PARTS LIST FOR:
**RETRACTABLE GARDEN
HOSE REEL 15MTR**

MODEL: **RWH15**



INSTRUCTIONS FOR:
**RETRACTABLE GARDEN
HOSE REEL 15MTR**

MODEL: **RWH15**

Thank you for purchasing a Sealey Product. Manufactured to a high standard this product will, if used according to these instructions and properly maintained, give you years of trouble free performance.

IMPORTANT: PLEASE READ THESE INSTRUCTIONS CAREFULLY. NOTE THE SAFE OPERATIONAL REQUIREMENTS, WARNINGS AND CAUTIONS. USE THIS PRODUCT CORRECTLY AND WITH CARE FOR THE PURPOSE FOR WHICH IT IS INTENDED. FAILURE TO DO SO MAY CAUSE DAMAGE AND/OR PERSONAL INJURY AND WILL INVALIDATE THE WARRANTY. PLEASE KEEP INSTRUCTIONS SAFE FOR FUTURE USE.

1. SAFETY INSTRUCTIONS

- ✓ Familiarise yourself with the application and limitations of the hose reel, as well as the specific hazards.
- ❑ **WARNING!** Disconnect the hose reel from the water supply before changing accessories, servicing or performing any maintenance.
- ✓ Maintain the hose reel in good condition (use an authorised service agent).
- ✓ Replace or repair damaged parts. *Use recommended parts only. Unauthorised parts may be dangerous and will invalidate the warranty.*
- ✓ Locate and fix the hose reel in a suitable working area. Do not position the hose in direct sunlight, or in areas of extreme heat or cold. Ensure there is adequate lighting.
- ❑ **WARNING!** Ensure maximum pressure is not exceeded.
- ✓ Keep extended hose away from heat, oil and sharp edges. Check hose for wear before each use, and ensure all connections are secure.
- ✓ Keep the unwound hose at a safe distance from the working area and free from oily surfaces.
- ✓ Maintain correct balance and footing. Ensure the floor is not slippery and wear non-slip shoes.
- ✓ Remove ill fitting clothing. Remove ties, watches, rings, and other loose jewellery and contain and/or tie back long hair.
- ✓ Keep children and unauthorised persons away from the working area.
- ✗ **DO NOT** operate the hose reel if any parts are damaged or missing as this may cause failure and/or personal injury.
- ✗ **DO NOT** exceed the rated capacity of the hose reel.
- ✗ **DO NOT** use the hose reel for any purpose other than that for which it is designed.
- ✗ **DO NOT** yank the hose from the water supply.
- ✗ **DO NOT** operate the hose reel when you are tired or under the influence of alcohol, drugs or intoxicating medication.
- ✗ **DO NOT** direct water from the water hose at yourself or others.
- ✓ When not in use ensure the water supply is turned off and tools disconnected. Disconnect from the water supply and retract the hose into case.

2. INTRODUCTION & SPECIFICATION

Durable composite case with wall/ceiling mounted bracket. Fitted with 15mtr Ø13mm PVC garden hose with spray/jet nozzle. Supplied with 1.2mtr leader hose with quick coupler and tap connector. Positive latching mechanism automatically locks hose at desired length. Safety switch locks drum securely in both directions.

Length:15mtr Size:Ø13mm

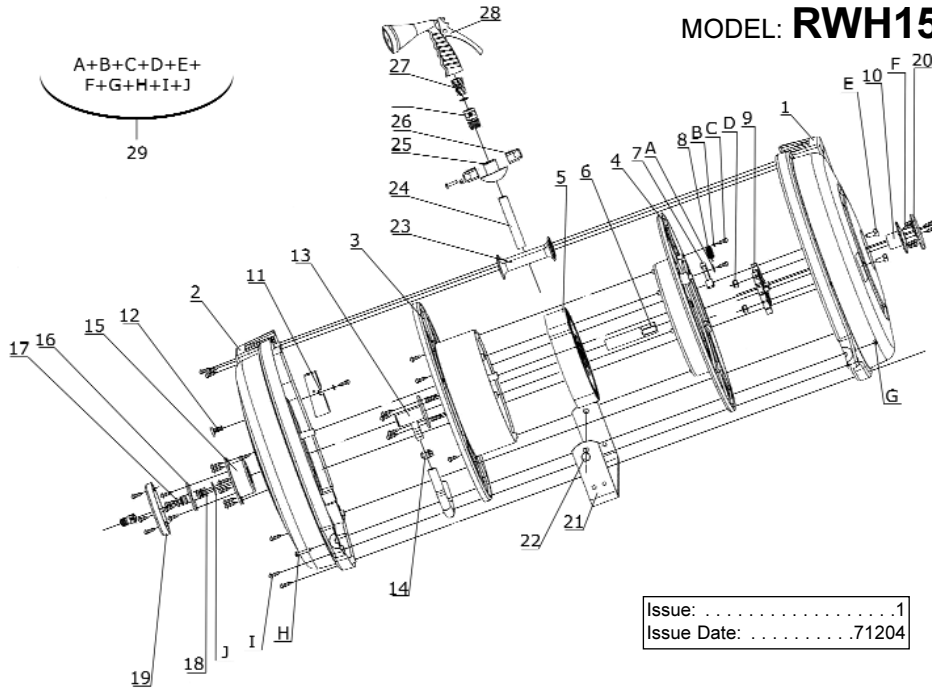

ITEM	PART NO.	DESCRIPTION	ITEM	PART NO.	DESCRIPTION
01.	RWH15.01	OUTER CASING (RIGHT)	16.	RWH15.21	SWIVEL SPOOL
02.	RWH15.02	OUTER CASING (LEFT)	17.	RWH15.22	FITTING
03.	RWH15.03	DRUM (LEFT)	18.	RWH15.23	O-RING
04.	RWH15.04	DRUM (RIGHT)	19.	RWH15.24	COVER (LEFT)
05.	RWH15.05	SPRING	20.	RWH15.25	COVER (RIGHT)
06.	RWH15.06	AXLE	21.	RWH15.26	BRACKET
07.	RWH15.07	RATCHET PAWL	22.	RWH15.27	PIN
08.	RWH15.09	DOG SPRING	23.	RWH15.29	ROLLER
09.	RWH15.11	LOCKING RING	24.	RWH15.30	HOSE Ø3/8" X 15MTR
10.	RWH15.15	SPRING, ADJUSTABLE BUSHING	25.	RWH15.31	BALL STOP
11.	RWH15.16	STOP BLOCK	26.	RWH15.32	HOSE CLIP
12.	RWH15.17	SCREW	27.	RWH15.37	FITTING FOR SPRAY GUN
13.	RWH15.18	SWIVEL BODY	28.	RWH15.38	SPRAY GUN
14.	RWH15.19	HOSE CLIP	29.	RWH15.RK	REPAIR KIT
15.	RWH15.20	BUSHING			

NOTE: It is our policy to continually improve products and as such we reserve the right to alter data, specifications and component parts without prior notice. **IMPORTANT:** No liability is accepted for incorrect use of this equipment. **WARRANTY:** Guarantee is 12 months from purchase date, proof of which will be required for any claim. **INFORMATION:** For a copy of our latest catalogue and promotions call us on 01284 757525 and leave your full name and address, including postcode.

SEALEY POWER PRODUCTS Sole UK Distributor, Sealey Group, Bury St. Edmunds, Suffolk.
 01284 757500 01284 703534 E-mail: sales@sealey.co.uk
 Web: www.sealey.co.uk

3. MOUNTING/ASSEMBLY

⚠ WARNING! Ensure the hose is disconnected from the water supply. Do not position the hose in direct sunlight or in areas of extreme heat or cold.

- 3.1 For overhead ceiling mounting:
 - 3.1.1 Install reel at least 10 feet above the floor.
- 3.2 You will need to purchase appropriate fixings for mounting the reel.
 - 3.2.1 The reel base has 3 x 10.5mm (13/32") drilled holes for mounting on a suitable flat surface.
 - 3.2.2 Using the three holes in the base, mount the reel in the desired location. Be sure to use appropriate fixings and tighten securely.
- 3.2.3 Use PTFE tape to seal the inlet hose to the tap, by wrapping the PTFE around the thread on the tap nozzle and screwing the hose inlet on securely (fig 1).
- 3.2.4 Use the quick-release mechanism to attach the inlet hose to the hose reel inlet (fig 2).
- 3.2.5 Now the nozzle for use can be attached to the hose reel outlet using the quick-release mechanism.

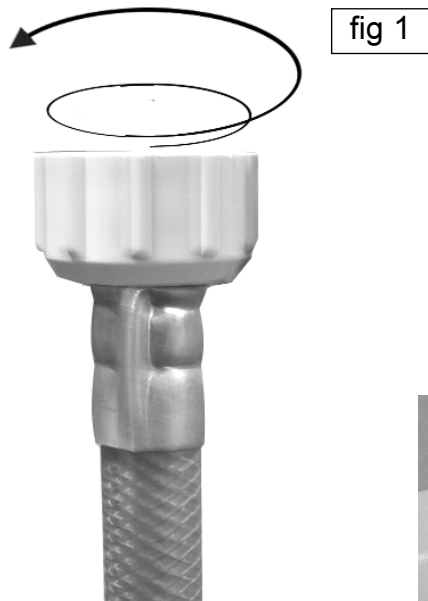

fig 1

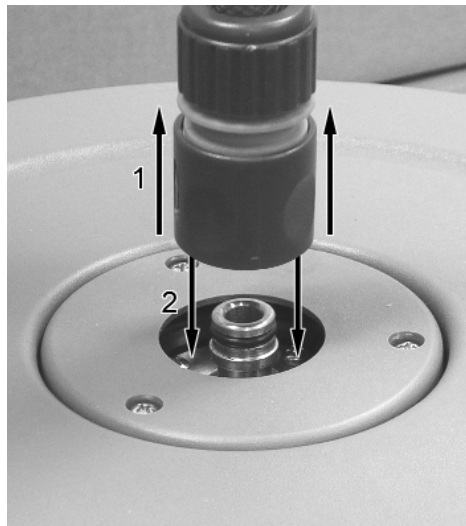

fig 2

4. OPERATION

- 4.1 **ADJUSTING THE SPRAY**
 - 4.1.1 To adjust the spray mode simply twist the collar of the spray-gun until the desired spray lines up with the embossed arrow situated on the top of the spray-gun. The different spray modes are as follows: Jet, Shower, Cone, Mist, Flat, Erect.
- 4.2 **EXTENDING THE HOSE**
 - 4.2.1 Simply pull the hose to the desired length.
 - 4.2.2 Flip the lock switch (fig 3), which is located on the side of the hose reel, so that it is in the "lock" position.
- 4.3 **RETRACTING THE HOSE**
 - 4.3.1 Push the lock switch back to the unlocked position and assist the reeling in of the hose.
- 4.4 **ADJUSTING THE RETURN SPRING TENSION**
 - 4.4.1 Remove the screws on cover (20) and lift cover.
 - 4.4.2 Then proceed to remove screws on the spring access panel (9) and tighten/loosen the hex nut to the desired setting.
 - 4.4.3 Replace all screws and check that they are secure before continuing.

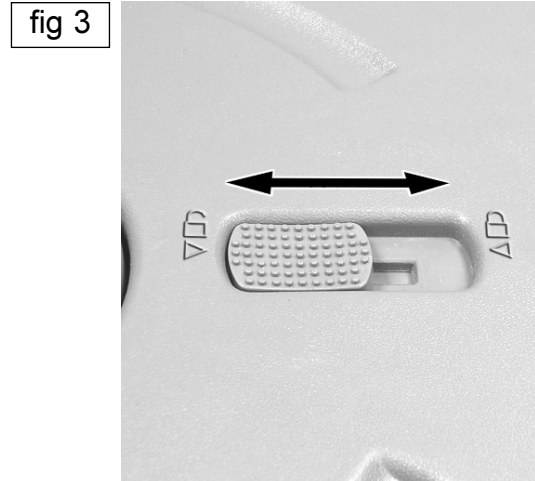

fig 3

5. MAINTENANCE & STORAGE

- ⚠ **WARNING! Before attempting maintenance or inspection drain any water remaining in the hose.** To ensure reliable operation, clean the hose and casing regularly. **DO NOT** spray or wet the product, but clean with a cloth and warm water. **DO NOT** use solvents or detergents, as these may permanently damage the item.
- STORAGE:** Should you wish to store the hose, ensure it is clean and dry. Place the item in a dark, safe, dry, childproof location, where the temperature will remain reasonably stable. **DO NOT** store in a nylon, or plastic, bag as this will encourage condensation.