



# SUPERSNAP® BODY REPAIR KIT

## Models: RE83/10/SK

Thank you for purchasing a Sealey product. Manufactured to a high standard this product will, if used according to these instructions and properly maintained, give you years of trouble free performance.

**IMPORTANT: PLEASE READ THESE INSTRUCTIONS CAREFULLY. NOTE THE SAFE OPERATIONAL REQUIREMENTS, WARNINGS AND CAUTIONS. USE THE PRODUCT CORRECTLY AND WITH CARE FOR THE PURPOSE FOR WHICH IT IS INTENDED. FAILURE TO DO SO MAY CAUSE DAMAGE AND/OR PERSONAL INJURY AND WILL INVALIDATE THE WARRANTY. PLEASE KEEP INSTRUCTIONS SAFE FOR FUTURE USE.**

Only fully trained and qualified persons should use this equipment. These instructions are not a substitute for user receiving full supervised training by a qualified person. It is important the user understands the applications, limitations and potential hazards of the product.

### 1. SAFETY INSTRUCTIONS

- ❑ **WARNING!** Ensure Health & Safety, local authority and general workshop practice regulations are adhered to when using this equipment.
- ✓ Familiarise yourself with application, limitations and potential hazards of the repair kit.
- ❑ **WARNING!** No part of this unit or any accessory relating to the repair kit is designed for lifting loads. It is intended only as a pushing device and must be used as such, with care.
- ❑ **WARNING!** Disconnect the repair kit from the hydraulic pump before servicing or performing any maintenance on the unit.
- ✓ Maintain repair kit in good order. Replace/repair with *genuine parts only*. *Unapproved parts may be dangerous and will invalidate the warranty.*
- ✓ Use qualified person to lubricate and maintain the hydraulic pump. DO NOT use brake fluid to top up hydraulic unit. Use Sealey hydraulic oil only.
- ✓ Keep the repair kit clean for best and safest performance.
- ❑ **WARNING!** Ensure you know how much load you are pushing. Never exceed the maximum pushing capacity.
- ✓ Use only with the supplied Sealey hydraulic pump and accessories. Wrong equipment may damage unit and invalidate your warranty.
- ✓ The kit accessories may be used with other popular makes of kit.
- ✓ Ensure there is positive engagement of repair kit accessories to the vehicle body before pushing.
- ✓ Maintain correct balance and footing. Ensure the floor is not slippery and wear non-slip shoes.
- ✓ If working on an 'off centre' load, pump with care. If you feel undue resistance, stop and re-adjust the set-up.
- ❑ **WARNING!** Keep your hands, body and clothing away from the repair kit and accessories when in use. Take any necessary precautions to protect your personal safety whilst using the repair kit.
- ✓ Ensure the hydraulic hose is not bent or kinked but is laid out correctly.
- ✓ Keep non-essential persons away from the operating area. Be aware of the locations of other persons assisting you.
- ✓ When releasing tension from the load be sure to undo the hydraulic valve VERY slowly.
- x DO NOT operate the repair kit if any parts are damaged or missing, as this may cause failure and/or personal injury.
- ❑ **WARNING!** DO NOT use repair kit as a lifting device of any type. DO NOT use for any purpose other than for which it is designed.
- x DO NOT over extend the ram as the plunger may be forced out of the ram end.
- x DO NOT heat accessories as this may weaken them.
- x DO NOT modify accessories for use with this kit.
- ✓ When not in use, place dust cap in end of hydraulic hose and store the kit, in the case, in a safe, dry, childproof location.

### 2. CONTENT

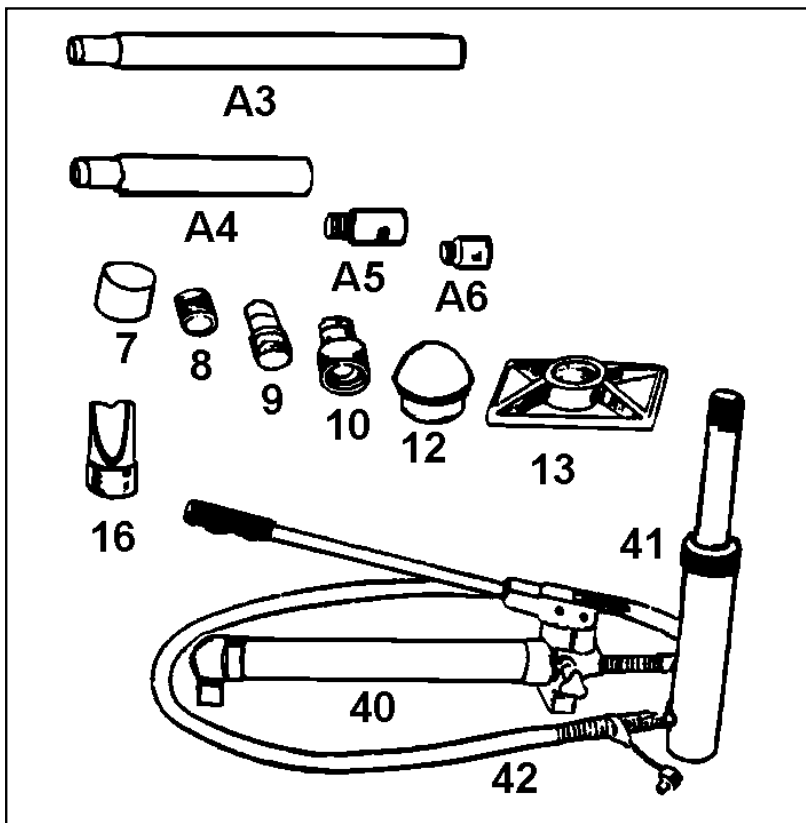

ITEM	PART NO.	DESCRIPTION
A3	610/A3	19" SUPERSNAP® TUBING
A4	610/A4	11" SUPERSNAP® TUBING
A5	610/A5	5" TUBE ADAPTOR
A6	610/A6	3" TUBE ADAPTOR
7	610/7	SERRATED SADDLE
8	610/8	MALE CONNECTOR
9	610/9	MALE ADAPTOR
10	610/10	FEMALE ADAPTOR
12	610/12	3-1/4" RUBBER HEAD
13	610/13	FLAT BASE
16	610/16	WEDGE HEAD
40	610/40	10 TON HYDRAULIC UNIT
41	610/41	RAM
42	610/42	HOSE

### 3. INTRODUCTION

Kit features snap together pipe work for speed and threaded attachments for strength. Connecting parts are zinc or cadmium plated for long, rust-free life. Components are manufactured from high quality steel and finished with red supergloss paint.

#### IMPORTANT:

Only fully trained and qualified persons should use this equipment. It is very important that the user understands the applications, limitations and potential hazards of the product.

#### VEHICLE DAMAGE INTRODUCTION

Before using the repair kit, you must determine the extent of vehicle damage. The technician will check all parts and determine if there is any broken, torn, crumpled, wrinkled, crushed, twisted or bent metallic parts. Measurements should be taken to see how far out of alignment the vehicle may be. It is important to determine correct dimensions by referring to the manufacturer's frame dimension charts and specifications. Remember, do not commence pushing until you are sure when to stop. Take time to examine and determine damage correctly. Comprehensive planning will save you time when you are actually using this equipment.

### 4. INSTRUCTIONS FOR USE

To provide maximum versatility a combination of pump accessories may be used.

Illustrated below are the main attachment variations

Ensure the task you are undertaking falls within the capacity of the pump and accessories you are using.

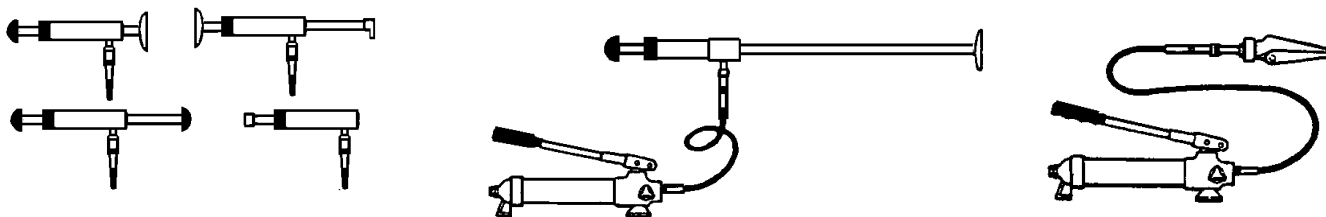

**WARNING!** Ensure you have read and understood section 1 safety instructions.

- 4.1. The pump may be used in any position from horizontal to vertical. When not horizontal ensure the hose end of the pump is down.
- 4.2. To use the pump, close valve (fig 1.A) by turning the knob clockwise and pump the handle up and down to apply the load.
- 4.3. To release pump pressure, turn knob anti-clockwise (B).

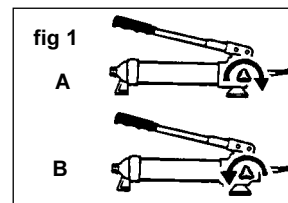

### 5. MAINTENANCE

**IMPORTANT:** Only fully qualified personnel should attempt maintenance or repair to the hydraulic system.

#### 5.1. Pump oil level

Release pressure and disconnect the ram from the pump.

Hold pump in an upright position.

Remove filler plug and add hydraulic oil until it is level with the full mark (fig 2).

**WARNING:** DO NOT use brake fluid, or any fluid other than hydraulic jack fluid, as this may cause serious damage to the pump/ram and will invalidate the warranty! Use only Sealey hydraulic oil.

#### 5.2. General

Before each use check for broken, cracked, bent, or loose parts, or any visible damage to welds, ram, pump, hose and accessories. If any suspect item is found remove from service and take necessary action to remedy the problem.

Replace/repair with *genuine parts only*. *Unapproved parts may be dangerous and will invalidate the warranty.*

Keep all parts of the kit clean.

fig 2



**IMPORTANT: NO RESPONSIBILITY IS ACCEPTED FOR INCORRECT USE OF THE PUMP AND/OR RAM.**

Hydraulic products are only repaired by local service agents. We have service/repair agents in all parts of the UK.

**DO NOT RETURN PUMP OR RAM TO US.** Please telephone us on 01284 757500 to obtain the address and 'phone number of your local agent. If product is under guarantee please contact your dealer.

#### De-commissioning Hydraulic Pump/Ram

Should the pump or ram become completely unserviceable draw off the oil into an approved container and dispose of the product and the oil according to local regulations.

#### Declaration of Conformity

We, the sole importer into the UK, declare that the product listed below is in conformity with the following standards and directives.

10 TON SUPERSNAP® BODY REPAIR KIT  
Models: RE83/10/SK  
98/37/EC Machinery Directive



The construction file for this product is held by the Manufacturer and may be inspected, by a national authority, upon request to Jack Sealey Ltd.

Signed by Mark Sweetman

29th March 2001

For Jack Sealey Ltd.  
Sole importer into the UK  
of Sealey Power Products.

**NOTE:** It is our policy to continually improve products and as such we reserve the right to alter data, specifications and component parts without prior notice.

**IMPORTANT:** No liability is accepted for incorrect use of product. **WARRANTY:** Guarantee is 12 months from purchase date, proof of which will be required for any claim. **INFORMATION:** For a copy of our latest catalogue and promotions call us on 01284 757525 and leave your full name and address, including postcode.



Sole UK Distributor,  
Sealey Group,  
Bury St. Edmunds, Suffolk.



01284 757500



01284 703534

**E-mail:** sales@sealey.co.uk