

Thank you for purchasing a Sealey product. Manufactured to a high standard this product will, if used according to these instructions and properly maintained, give you years of trouble free performance.



**IMPORTANT: PLEASE READ THESE INSTRUCTIONS CAREFULLY. NOTE THE SAFE OPERATIONAL REQUIREMENTS, WARNINGS AND CAUTIONS. USE THE PRODUCT CORRECTLY AND WITH CARE FOR THE PURPOSE FOR WHICH IT IS INTENDED. FAILURE TO DO SO MAY CAUSE DAMAGE AND/OR PERSONAL INJURY AND WILL INVALIDATE THE WARRANTY. PLEASE KEEP INSTRUCTIONS SAFE FOR FUTURE USE.**

### 1. SAFETY INSTRUCTIONS

- ✓ Familiarise yourself with the application, limitations and hazards of the rack.
- ✓ Maintain the rack in good condition (use authorised replacement parts).
- ✓ Keep the rack clean for best and safest performance.
- ✓ Locate the rack in a suitable work area.
- ☐ **WARNING!** Use the rack on level and solid ground, preferably concrete.
- ✗ **DO NOT** overload the rack.
- ✗ **DO NOT** climb on the rack.
- ✗ **DO NOT** use the rack for any purpose other than for which it is designed.
- ✗ **DO NOT** use the rack if any parts are damaged or missing as this may cause failure and/or personal injury.
- ✓ Keep the work area clean, uncluttered and ensure that there is adequate lighting.
- ✓ Keep children and unauthorised persons away from the work area.
- ☐ **WARNING: The warnings, cautions and instructions discussed in this manual cannot cover all possible conditions and situations that may occur. It must be understood that common sense and caution are factors which cannot be built into this product, but must be applied by the operator.**

### 2. INTRODUCTION

Double-sided rack for safe and tidy workshop storage of painted bumpers. Prevents inadvertent damage to paint finish during storage. Four pairs of height adjustable support arms for maximum capacity and flexibility. Fitted with four castors, two with brake, for maximum manoeuvrability and safe positioning.

### 3. ASSEMBLY INSTRUCTIONS

- 3.1. Take the two side base tubes (6) and lay them parallel on top of the base tube (1). Place the two T plates (9) at the centre of the foot bars aligning the holes, fix with a screw and nut.
- 3.2. Slot in the upright tubes (8) into the brackets and fix with screws, washers and nuts.
- 3.3. Slide the four large bumper support bars (12) onto the bottom bars, two on each bar. Secure them by screwing the knobs tight.
- 3.4. On one side slot the handle on (10), slide it over the bottom bar and tighten with knob (11).
- 3.5. Insert the upright tubes (14) into the upright tubes (8) and fix with a screw, washer and a nut in each hole.
- 3.6. As in step 4.3 slot the smaller 4 bumper support bars (15) over the top bar and tighten with the knobs.
- 3.7. Secure the frame of the rack by fixing the cylindrical cross bar (17) to the top bars, fix with a screw and washer on each end.
- 3.8. Slide on the foam covers onto the bumper support bars.
- 3.9. Attach castors (5) using two washers and locking nut (4) at the end of each foot bar, two of the castors have brakes - put these adjacent to each other.

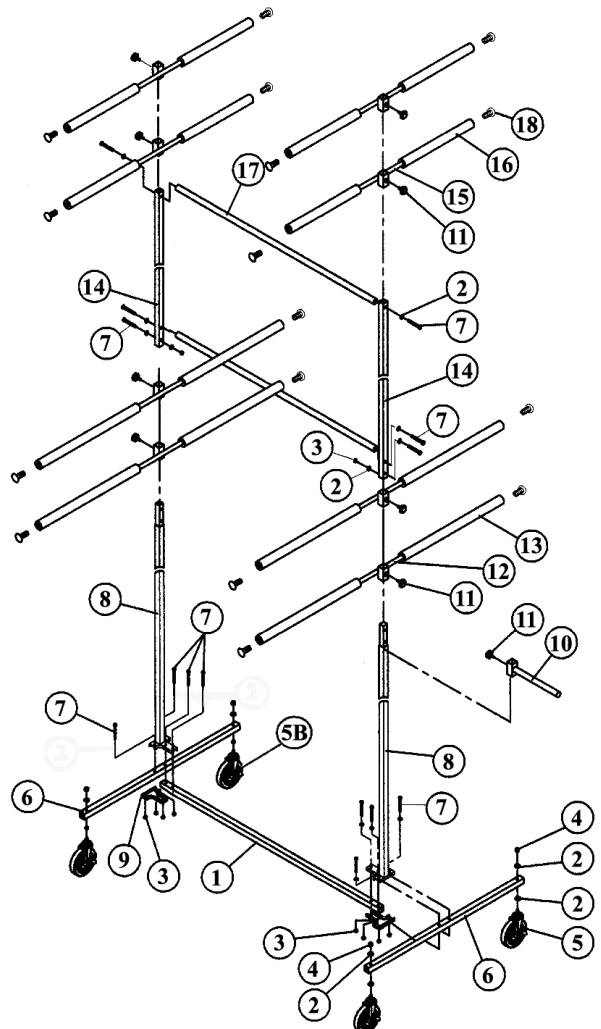

**NOTE:** It is our policy to continually improve products and as such we reserve the right to alter data, specifications and component parts without prior notice.

**IMPORTANT:** No liability is accepted for incorrect use of this product.

**WARRANTY:** Guarantee is 12 months from purchase date, proof of which will be required for any claim.

**INFORMATION:** For a copy of our latest catalogue and promotions call us on 01284 757525 and leave your full name and address, including postcode.