

SEALEY

FOLDING ENGINE CRANE 2 TONNE

MODEL NO: PH20.V5

Thank you for purchasing a Sealey product. Manufactured to a high standard, this product will, if used according to these instructions, and properly maintained, give you years of trouble free performance.

IMPORTANT: PLEASE READ THESE INSTRUCTIONS CAREFULLY. NOTE THE SAFE OPERATIONAL REQUIREMENTS, WARNINGS & CAUTIONS. USE THE PRODUCT CORRECTLY AND WITH CARE FOR THE PURPOSE FOR WHICH IT IS INTENDED. FAILURE TO DO SO MAY CAUSE DAMAGE AND/OR PERSONAL INJURY AND WILL INVALIDATE THE WARRANTY. KEEP THESE INSTRUCTIONS SAFE FOR FUTURE USE.



Refer to instruction manual



Wear protective gloves



Wear protective footwear

1. SAFETY

- ✓ **Keep** crane, lifting slings, support and beams in good working order and condition. Follow the inspection requirements as described in Section 6, Maintenance. *Take immediate action to repair or replace damaged parts by contacting your supplier.*
 - ✓ Ensure that all accessory lifting devices are suitably certified. If crane is damaged, remove from service immediately.
 - ✓ Ensure the surface on which the crane is used is level, firm and capable of supporting the weight of the crane with maximum load - we recommend concrete. Never use the crane on tarmac or other soft surfaces, as the crane may sink in.
 - ✓ Ensure the crane legs and arms are locked before use.
 - ✓ Keep children and unauthorised persons away from the working area.
 - ✓ Keep working area clean and tidy, free from unrelated materials and ensure that there is adequate lighting.
 - ✓ Ensure that load does not exceed the maximum lifting capacity of the crane. Overloading the crane is dangerous. Where appropriate, use only the lifting points recommended by the manufacturer of the item to be lifted, e.g. vehicle engine.
 - ✓ Before lifting the load ensure that the crane jib is in the lowest practical position, that there are no obstacles which may snag the load whilst it is being lifted and that the area above the jib is clear.
 - ✓ To avoid injury, be fully aware of your own and other persons locations in relation to the lifting, and lowering, of the load.
 - ✓ Keep a sound footing and balance, and ensure the floor is not slippery, and wear non-slip footwear.
 - ✓ Ensure jib extension locking bolt and nut are in position before lifting.
 - ✓ Ensure the centre of gravity always remains inside the crane base.
 - ✗ **DO NOT** harness the load at an angle or use any attachments not verified as fit for purpose.
 - ✗ **DO NOT** allow the load to swing during lifting.
 - ✗ **DO NOT** allow the load to drop suddenly. Lower load with care, ensuring that you are fully aware of the condition of the surface onto which the load is to be placed.
 - ✗ **DO NOT** load crane beyond its rated capacity for each specified jib extension position as indicated on the beam fig.2. The capacity of the crane reduces as the jib is extended.
 - ✗ **DO NOT** position any part of your body beneath the load.
 - ✗ **DO NOT** use the crane to move or transport a load other than for repositioning. The crane is a lifting device only.
 - ✗ **DO NOT** apply any sideways pressure to any part of the crane during lifting or when a load is suspended.
 - ✗ **DO NOT** attempt to adjust the safety valve, which has been set and sealed by the manufacturer.
 - ✗ **DO NOT** use this product to perform a task for which it is not designed.
 - ✗ **DO NOT** use whilst under the influence of drugs, alcohol or intoxicating medication.
 - ✗ **DO NOT** climb on the crane.
 - ✓ When not in use fold the crane down and store in a safe, dry, childproof area.
 - ✓ This crane is designed for lifting within a garage or workshop environment.
 - ✓ Ensure you have read and understood the safety instructions at the beginning of this section before you operate the crane.
- WARNING!** Failure to heed safety and warning instructions may result in damage and/or personal injury and will invalidate the warranty.
- NOTE:** Ensure you have read and understood the safety instructions at the beginning of this section before you operate the crane.



2. INTRODUCTION

Lifts 2000kg at 860mm jib extension. Six heavy-duty castor wheels. Folds for easy storage, freeing valuable workshop space when not in use. Pump access from the side for safe handling of heavy loads. Delivered in knock-down form for reduced freight cost. This item is heavy. Extra assistance must be provided at the delivery point to help its safe delivery.

3. SPECIFICATION

Model No	PH20.V5
Height Jib Down	1460mm
Height Legs Folded	1565mm
Height of Frame	185mm
Length of Jib Position 1	860mm
Length of Jib Position 2	1020mm
Length of Jib Position 3	1180mm
Length of Jib Position 4	1340mm
Length	1750mm
Lifting Capacity in Position 1	2000kg
Lifting Capacity in Position 2	1500kg

Lifting Capacity in Position 3	1000kg
Lifting Capacity in Position 4	500kg
Max. Lift Ht at Jib Position 1	1820mm
Max. Lift Ht at Jib Position 2	1940mm
Max. Lift Ht at Jib Position 3	2080mm
Max. Lift Ht at Jib Position 4	2210mm
Nett Weight	79.65kg
Rear Width	850mm
Width Front Frame	1055mm
Width Inside Front Frame	915mm

4. ASSEMBLY

NOTE: All parts are to be left loose during assembly and tightened before use.

- 4.1. Assembly procedure is as follows. (Numbers in brackets refer to the parts diagram - please refer to this for appropriate positioning).
- 4.2. Attach wheels (22) to the appropriate points on the base (29) using bolts, washers, lock washers and nuts (2,3,4,5).
- 4.3. Attach wheels (23-small wheels) to appropriate points on base (29) using bolts, washers and lock washers (1,3,4).
- 4.4. Attach wheels (22) to appropriate points on the legs (30) using bolts, washers, lock washers and nuts (2,3,4,5).
- 4.5. Slot the legs (30) into the base (29) and secure with pins (6), to secure these.
- 4.6. Attach the post (26) to the front of the base (29) using bolts, washers, lock washers and nuts (10,7,8,9).
- 4.7. Attach supports (27) to the base (29) using bolts, washers, lock washers and nuts (10,7,8,9).
- 4.8. Attach the tops of the supports (27) to the post (26) using bolt, washer, lock washer and nut (10,7,8,9).
- 4.9. Attach the base of the hydraulic unit (28) to the lower fixing point of the post (26) using bolt, washer, lock washer and nut (11,12,13,14).
- 4.10. Attach the boom (25) to the top of the post (26) using bolt, washer, lock washer and nut (15,18,19,20).
- 4.11. Attach the piston head of the hydraulic unit (28) to appropriate point on the boom (25) using bolt, washer, lock washer and nut (17,12,13,14).
- 4.12. Slot the boom extension (24) into the boom (25) and secure using pin (16). Be sure to select the correct extension for the weight to be lifted.
- 4.13. Attach the hook and chain (31) to the boom using bolt, washer, lock washer and nut (21,7,8,9).
- 4.14. Open the release valve of the ram by turning anticlockwise using the groove in the pump handle (32) provided. Pump the ram 10-20 times. This is necessary to flush the hydraulic system and purge any air that may be present.
- 4.15. Pull the jib up slightly, close the release valve (turn clockwise) and pump the handle. The jib should now raise. Pump the jib all the way up and then lower it slowly by opening the release valve. This is to confirm that the oil level is correct. Close the release valve.
- 4.16. The crane is now ready for use. Ensure it is not damaged in any way. Should you experience any problems, contact your supplier immediately.
- 4.17. **INSPECTION AND EXAMINATION OF CRANE BEFORE USE.**
 - 4.17.1. Before each use of the crane, perform an inspection for leaks, damage, loose or missing parts.
 - 4.17.2. The workshop crane must be examined immediately if it has been subject to an abnormal load or shock. It is recommended that such an examination is made by an authorised service agent.
 - 4.17.3. The owner and/or operator must be aware that repair of this equipment will require specialised knowledge and facilities. It is recommended that an annual examination of the workshop crane is made by an authorised service agent. Unauthorised parts may be dangerous and will invalidate the warranty.

NOTE: See the Definition of 'Inspection' and 'Examination' below.

INSPECTION:

Inspect the crane for defects and check the operation of controls, limiting and indicating devices without loading the crane.

This check does not normally require any part of the crane to be dismantled other than removal or opening of covers or housings.

EXAMINATION:

Verification that the crane can safely continue in service including a functional test of all safety devices i.e. limiting, indicating equipment, brakes, clutches, safety valves etc to verify that they operate within the required tolerances. An examination is more thorough than an inspection.

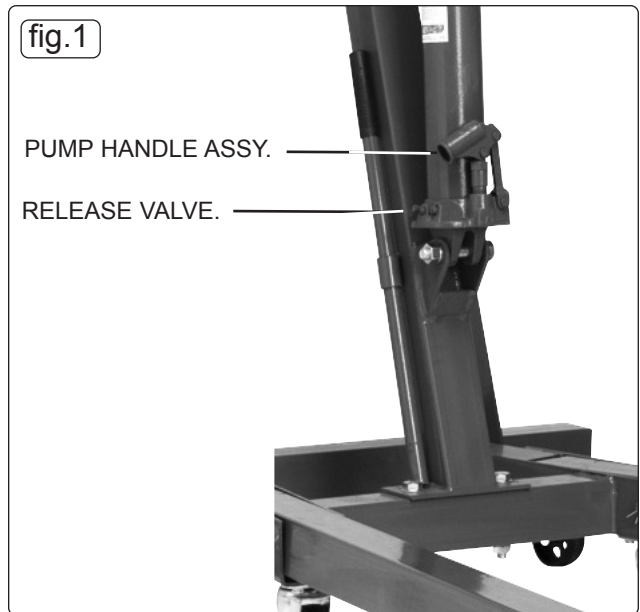
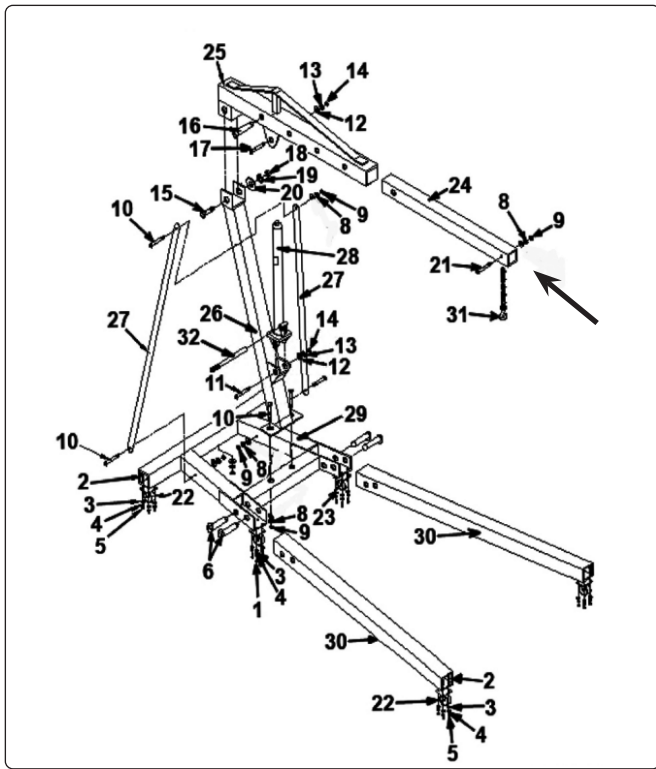

5. OPERATION

(Refer to Section 6.2 regarding inspection before each and every use, also that the leg pins are inserted before operating).

- 5.1. Use the pump handle recess to tighten the release valve, turning firmly clockwise (fig.1).
- 5.2. Place handle into pump socket and pump the handle, the jib will raise. Continue to pump until the jib reaches the height at which the load can be secured.
- 5.3. Connect the crane hook to the load using a suitable sling or support beam. Be aware of the load weight, and check that it is within the capacity of the crane (at the jib extension you are using) and the sling or support beam. When removing engines ensure the weight to be lifted is known. Use only the lifting points recommended by the vehicle manufacturer.
- 5.4. Lift only from directly above the load.
 - WARNING! DO NOT LIFT THE LOAD AT AN ANGLE!**
- 5.5. To lower load, position handle on release valve at base of ram and turn very slowly anti-clockwise avoiding any sudden movement.
 - WARNING! DO NOT** allow the load to drop suddenly.
- 5.6. The crane is not a transportation device but may be used to reposition the load being worked on. To do so, lower load and jib with care, to the lowest possible point before attempting to move. **DO NOT** try to move crane in a sideways direction. The crane is not designed to support the load indefinitely. When the load has been repositioned, lower the load onto a secure and appropriate working base, being fully aware of your own and other persons locations in relation to the lowering load.
- 5.7. When load has been secured, remove lifting sling, support beam etc. and place crane in a safe location with lifting beam fully lowered.

6. MAINTENANCE

NOTE: The crane MUST be kept clean and dry and must be maintained in accordance with these instructions. Safety functions should be checked before each use.

6.1. LUBRICATION.

6.1.1. Oil all working parts monthly.

NOTE: See fig.3 for top up point on hydraulic unit.

6.2. The ram is filled with oil and should only require occasional topping up.

* **DO NOT** use brake fluid, as this will damage the hydraulic seals. Proceed as follows:

6.2.1. Use only good quality hydraulic jack oil available from your Sealey supplier.

* **DO NOT OVERFILL** as this will cause failure. Fill to the edge of the hole in the upright position.

6.2.2. After filling with hydraulic oil, pump the crane up to its full height and pour off any excess oil.

7. STORAGE

7.1. FOLDING THE ASSEMBLY

7.2. Close the boom.

7.3. Lower beam.

7.4. Remove leg pins and fold in legs.

7.5. Lock legs into folded position with the securing pins.

7.6. **THE OWNER AND/OR OPERATOR SHALL STUDY THESE INSTRUCTIONS AND RETAIN THEM FOR FUTURE USE**

7.7. UNDERSTANDING INSTRUCTIONS AND WARNINGS

The owner and/or operator shall understand the operating instructions and warnings before operating the crane.

- WARNING!** Information must be emphasised and understood. If the operator is not fluent in English, the product instructions and warnings must be read to, and discussed with, the operator in the operator's native language by the owner, making sure the operator understands the contents.

7.8. **DAMAGED CRANES**

Any crane which appears to be damaged, badly worn, or operates abnormally **MUST BE REMOVED FROM SERVICE!** It is recommended that necessary repairs be made by an authorised service agent.

7.9. **END OF SERVICE**

Through years of normal wear, the crane will eventually become unserviceable. When this happens ensure the hydraulic oil is drained off and disposed of in accordance with local authority regulations.



ENVIRONMENT PROTECTION

Recycle unwanted materials instead of disposing of them as waste. All tools, accessories and packaging should be sorted, taken to a recycling centre and disposed of in a manner which is compatible with the environment. When the product becomes completely unserviceable and requires disposal, drain any fluids (if applicable) into approved containers and dispose of the product and fluids according to local regulations.



REGISTER YOUR PURCHASE HERE

Note: It is our policy to continually improve products and as such we reserve the right to alter data, specifications and component parts without prior notice. Please note that other versions of this product are available. If you require documentation for alternative versions, please email or call our technical team on technical@sealey.co.uk or 01284 757505.

Important: No Liability is accepted for incorrect use of this product.

Warranty: Guarantee is 12 months from purchase date, proof of which is required for any claim.

Sealey Group, Kempson Way, Suffolk Business Park, Bury St Edmunds, Suffolk. IP32 7AR

01284 757500

sales@sealey.co.uk

www.sealey.co.uk