

Thank you for purchasing a Sealey Product. Manufactured to a high standard this product will, if used according to these instructions and properly maintained, give you years of trouble free performance.



**IMPORTANT:** PLEASE READ THESE INSTRUCTIONS CAREFULLY. NOTE THE SAFE OPERATIONAL REQUIREMENTS, WARNINGS AND CAUTIONS. USE THIS PRODUCT CORRECTLY AND WITH CARE FOR THE PURPOSE FOR WHICH IT IS INTENDED. FAILURE TO DO SO MAY CAUSE DAMAGE AND/OR PERSONAL INJURY AND WILL INVALIDATE THE WARRANTY. KEEP THESE INSTRUCTIONS FOR FUTURE USE.

### 1. SAFETY INSTRUCTIONS

#### 1.1. GENERAL

- ✓ Keep the PC700 clean and in good condition.
- ✓ Replace or repair damaged parts. *Use recommended parts only. Unauthorised parts may be dangerous and will invalidate the warranty.*
- ✓ Keep children and non-essential persons away from the work area.
- x **DO NOT** leave the PC700 operating unattended.
- x **DO NOT** use the PC700 for a task it is not designed for.
- x **DO NOT** operate the PC700 when you are tired or under the influence of alcohol, drugs or intoxicating medication.
- x **DO NOT** operate the PC700 if any parts are missing or damaged, as this may cause failure and/or personal injury.
- ☐ **WARNING!** Sparks inside motor can ignite flammable vapours or dust. To avoid fire or explosion do not vacuum, or use near, flammable or combustible liquids or gases.
- x **DO NOT** vacuum anything that is burning or smoking such as cigarettes, matches or hot ashes.
- x **DO NOT** vacuum toxic materials to avoid health hazards from vapours or dusts.
- ✓ Keep the PC700 and all accessories where they will not be subjected to heat or flame. To avoid injury, shock, or fire, never use a damaged vacuum, cleaner or power cable.
- x **DO NOT** put any object into openings.
- x **DO NOT** use with any opening blocked.
- ✓ Keep free of dust, lint, hair, and anything that may reduce air flow. Keep hair, loose clothing, fingers away from openings and moving parts.
- x **DO NOT** use without filter in place.
- ✓ When not in use disconnect from supply and store in a safe, dry, childproof location.

#### 1.2 ELECTRICAL SAFETY. ☐ **WARNING!** It is the user's responsibility to read, understand and comply with the following:

You must check all electrical equipment and appliances to ensure they are safe before using. You must inspect power supply leads, plugs and all electrical connections for wear and damage. You must ensure the risk of electric shock is minimised by the installation of appropriate safety devices. An RCCB (Residual Current Circuit Breaker) should be incorporated in the main distribution board. We also recommend that an RCD (Residual Current Device) is used with all electrical products. It is particularly important to use an RCD with portable products that are plugged into an electrical supply not protected by an RCCB. If in doubt consult a qualified electrician. You may obtain a Residual Current Device by contacting your Sealey dealer. **You must** also read and understand the following instructions concerning electrical safety.

- 1.2.1 The **Electricity At Work Act 1989** requires all portable electrical appliances, if used on business premises, to be tested by a qualified electrician, using a Portable Appliance Tester (PAT), at least once a year.
- 1.2.2 The **Health & Safety at Work Act 1974** makes owners of electrical appliances responsible for the safe condition of the appliance and the safety of the appliance operator. **If in doubt about electrical safety, contact a qualified electrician.**
- 1.2.3 Ensure the insulation on all cables and the product itself is safe before connecting to the mains power supply. See 1.1.1. & 1.1.2. above and use a Portable Appliance Tester (PAT).
- 1.2.4 Ensure that cables are always protected against short circuit and overload.
- 1.2.5 Regularly inspect power supply, leads, plugs for wear and damage and power connections to ensure that none is loose.
- 1.2.6 **Important:** Ensure the voltage marked on the product is the same as the electrical power supply to be used, and check that plugs are fitted with the correct fuse. **See fuse rating right.**
- 1.2.7 **DO NOT** pull or carry the powered appliance by its power supply lead.
- 1.2.8 **DO NOT** pull power plugs from sockets by the power cable.
- 1.2.9 **DO NOT** use worn or damage leads, plugs or connections. Immediately replace or have repaired by a qualified electrician. A U.K. 3 pin plug with ASTA/BS approval is fitted. In case of damage, cut off and fit a new plug according to the following instructions (discard old plug safely).

(UK only - see diagram at right). **Ensure the unit is correctly earthed via a three-pin plug.**

- a) **Connect the GREEN/YELLOW earth wire to the earth terminal 'E'.**
- b) **Connect the BROWN live wire to live terminal 'L'.**
- c) **Connect the BLUE neutral wire to the neutral terminal 'N'.**
- d) **After wiring, check that there are no bare wires, that all wires have been correctly connected, that the cable outer insulation extends beyond the cable restraint and that the restraint is tight.**

Double insulated products are fitted with live (BROWN) and neutral (BLUE) wires only. Double insulated products are always marked with this symbol ☐. **To re-wire, connect the brown & blue wires as indicated above. DO NOT connect the brown or blue to the earth terminal.**

- 1.2.10 **Cable extension reels.** When a cable extension reel is used it should be fully unwound before connection. A cable reel with an RCD fitted is recommended since any product which is plugged into the cable reel will be protected. The section of the cores of the cable is important and should be at least 1.5mm<sup>2</sup>, but to be absolutely sure that the capacity of the cable reel is suitable for this product and for others that may be used in the other output sockets, we recommend the use of 2.5mm<sup>2</sup> section cable.

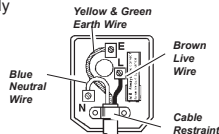

**FUSE RATING**  
THIS PRODUCT MUST BE  
FITTED WITH A  
13 AMP FUSE

## 2. DESCRIPTION

Mains powered, portable vacuum cleaner with powerful suction. Ideal for small jobs in the home or workshop and for complete in-car cleaning. Features blower adaptation enabling dirt to be removed from areas that normal nozzles cannot access. Complete with upholstery brush, crevice tool, blower adaptor nozzle and shoulder strap. Includes easily removed collection chamber and 4.5mtr mains cable with plug.

Supply: 230V  
 Motor Power: 700W  
 Dust Capacity: 0.5ltr  
 Weight: 1.7kg

Fig.1

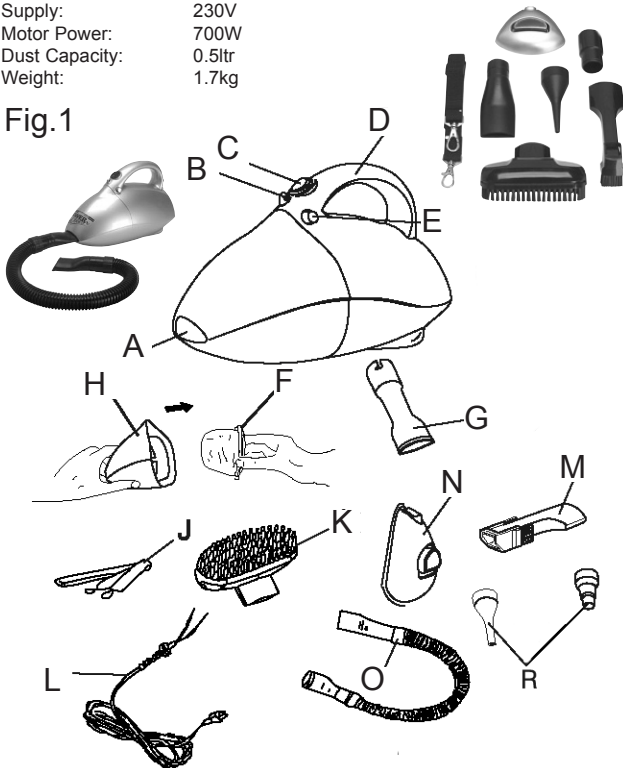

Fig.1

Item	Description.
A.	Suction Inlet
B.	Shoulder Strap Mount
C.	On/Off Power Switch
D.	Handle
E.	Dust Collector Release Button
F.	Filter
G.	Connecting Attachment
H.	Dust Collector
J.	Shoulder Strap
K.	Upholstery Brush
L.	Power Cord
M.	Crevice Nozzle
N.	Blower Cover
O.	Flexible Hose
R.	Blower Adaptors

Fig.2



## 3. OPERATION

### 3.1 To vacuum.

- 3.1.1 Select the appropriate tool for the job and attach it to the dust collector, a simple push fit (Fig.2).
- 3.1.2 To use the flexible hose, push the narrow end of the hose into the suction hole, then attach the desired attachment to the end of the flexible hose as shown in Fig.3.
- 3.1.3 Press the On/Off switch to "I" and proceed to vacuum.
- 3.1.4 Upon completion of vacuuming simply switch off, "O" the On/Off switch.
- 3.1.5 To empty dust collector, position the PC700 over a suitable waste receptacle.
- 3.1.6 Hold the PC700 with the dust collector pointing downward.
- 3.1.7 Press down on the release button (fig 1.E) and separate the motor from the dust collector carefully (Fig.4) to avoid spilling the contents.
- 3.1.8 Remove the filter from the dust collector (fig 4).
- 3.1.9 Empty dust collector contents into the receptacle. The plastic dust collector may be rinsed in warm soapy water but must be dried thoroughly before use.
- 3.1.10 To clean the filter, brush or shake the dirt out over a suitable receptacle. If necessary wash the filter in warm soapy water and dry thoroughly afterwards. This will be necessary after considerable use as the filter will restrict the airflow and performance of the PC700 if it becomes blocked.

Fig.3

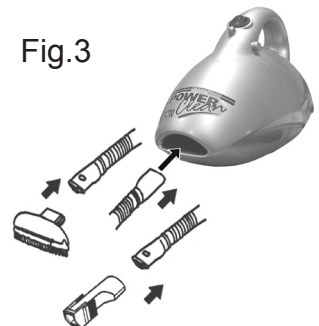
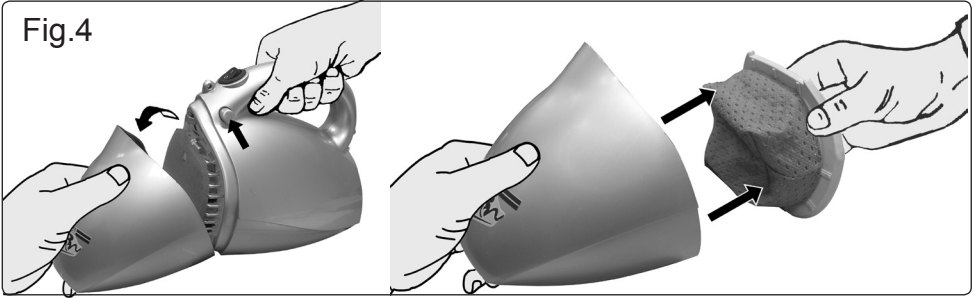

Fig.4



- 3.1.11 Re-assemble the PC700 by re-inserting filter before hooking the projection on the bottom of the motor housing into the corresponding notch in the dust collector housing and swivel upwards until it latches audibly.
- 3.1.12 To clean the rear filter press the release lock on the top of the rear blower cover and remove it. Withdraw the foam filter and shake it clean, if necessary it may be washed in a little soapy water and dried before replacing.

**3.2 Blower.**

- 3.2.1 Remove the standard cover at the rear of PC700 as in section 3.1.12.
- 3.2.2 Replace with blower cover fig.1N & fig.5.
- 3.2.3 Attach the desired blower attachments as shown in fig.5.
- 3.2.4 When you have finished with the blowing function, replace the blower cover with the standard rear cover.

**3.3 Shoulder Strap.**

- 3.3.1 The PC700 comes complete with an adjustable shoulder strap.
- 3.3.2 To fit the shoulder strap simply clip the strap to the mounting points at front and rear of handle (Fig.1B).

Fig.5

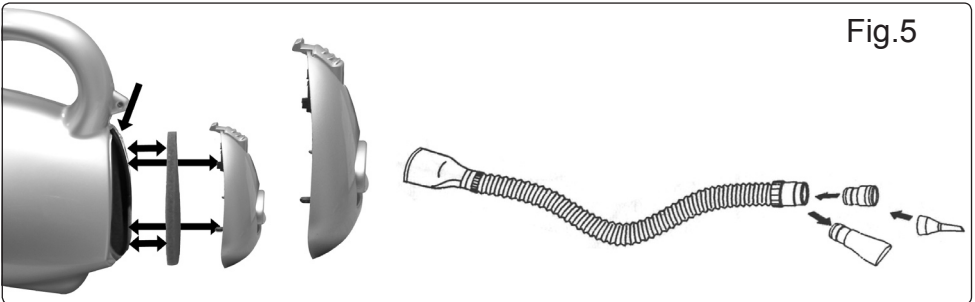

**Environmental Protection.**



Recycle unwanted materials instead of disposing of them as waste. All tools, accessories and packaging should be sorted, taken to a recycle centre and disposed of in a manner which is compatible with the environment.

When the product is no longer required, it must be disposed of in an environmentally protective way.

**NOTE:** It is our policy to continually improve products and as such we reserve the right to alter data, specifications and component parts without prior notice.  
**IMPORTANT:** No liability is accepted for incorrect use of this product.  
**WARRANTY:** Guarantee is 12 months from purchase date, proof of which will be required for any claim.  
**INFORMATION:** For a copy of our latest catalogue and promotions call us on 01284 757525 and leave your full name and address, including postcode.



Sole UK Distributor, Sealey Group,  
Kempson Way, Suffolk Business Park,  
Bury St. Edmunds, Suffolk,  
IP32 7AR



01284 757500



www.sealey.co.uk



01284 703534



sales@sealey.co.uk