

SEALEY

35L WET & DRY INDUSTRIAL VACUUM CLEANER PLASTIC DRUM M CLASS FILTRATION SELF-CLEAN & AUTO START MODEL NO: PC35110V

Thank you for purchasing a Sealey product. Manufactured to a high standard, this product will, if used according to these instructions and maintained properly, give you years of trouble free performance.

IMPORTANT: PLEASE READ THESE INSTRUCTIONS CAREFULLY. NOTE THE SAFE OPERATIONAL REQUIREMENTS, WARNINGS & CAUTIONS. USE THE PRODUCT CORRECTLY AND WITH CARE FOR THE PURPOSE FOR WHICH IT IS INTENDED. FAILURE TO DO SO MAY CAUSE DAMAGE AND/OR PERSONAL INJURY AND WILL INVALIDATE THE WARRANTY. KEEP THESE INSTRUCTIONS SAFE FOR FUTURE USE.



Refer to instruction manual

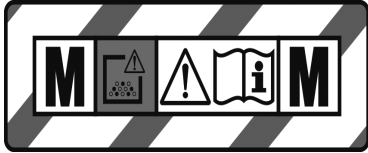

Vacuum cleaners of dust category M according to IEC/EN 60335-2-69 for dry vacuuming of hazardous dusts with an exposition limit value ≥ 0.1 mg/m³



Wear protective clothing



Wear a P-2 respirator when changing bags, filter or cartridges

1. SAFETY

1.1. ELECTRICAL SAFETY

- ❑ **WARNING!** It is the responsibility of the owner and the operator to read, understand and comply with the following:
You must check all electrical products, before use, to ensure that they are safe. You must inspect power cables, plugs, sockets and any other connectors for wear or damage. You must ensure that the risk of electric shock is minimised by the installation of appropriate safety devices. A Residual Current Circuit Breaker (RCCB) should be incorporated in the main distribution board. We also recommend that a Residual Current Device (RCD) is used. It is particularly important to use an RCD with portable products that are plugged into a supply which is not protected by an RCCB. If in any doubt consult a qualified electrician. You may obtain a Residual Current Device by contacting your Sealey stockist.
- ✓ You must also read and understand the following instructions concerning electrical safety.
- 1.1.1. The **Electricity at Work Act 1989** requires that all portable electrical appliances, if used on business premises, are tested by a qualified electrician, using a Portable Appliance Tester (PAT), at least once a year.
- 1.1.2. The **Health & Safety at Work Act 1974** makes owners of electrical appliances responsible for the safe condition of those appliances and the safety of the appliance operators. If in any doubt about electrical safety, contact a qualified electrician.
- ✓ Ensure that the insulation on all cables and on the appliance is safe before connecting it to the power supply.
- ✓ Ensure that cables are always protected against short circuit and overload.
- ✓ Regularly inspect power supply cables and plugs for wear or damage and check all connections to ensure that none are loose.
- ✓ Ensure that the voltage marked on the appliance matches the power supply to be used.
- ✗ **DO NOT** pull or carry the appliance by its power supply lead.
- ✗ **DO NOT** pull the plug from the socket by the power cable.
- ✗ **DO NOT** use worn or damaged cables, plugs or connectors. Immediately have any faulty item repaired or replaced by a qualified electrician.
- ✓ Ensure the unit is correctly earthed via a three-pin 110V plug.
 - a) Connect the GREEN/YELLOW earth wire to the earth terminal 'PE'.
 - b) Connect the BROWN live wire to the live terminal 'L/+'
 - c) Connect the BLUE neutral wire to the neutral terminal.
 - d) After wiring, check that there are no bare wires, that all wires have been correctly connected, that the cable outer insulation extends past the cable restraint and that the restraint is tight.

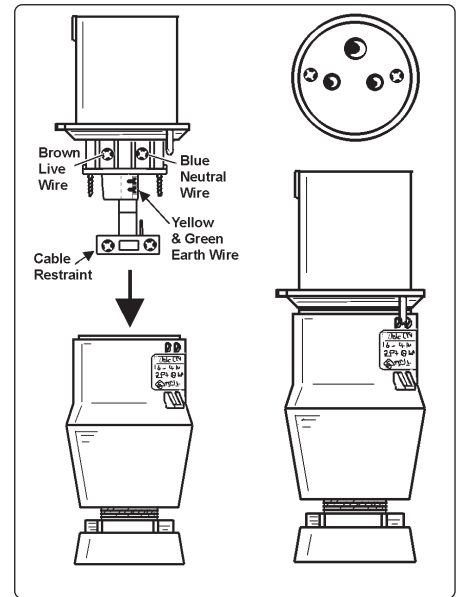

Fuse rating: 16 Amp

1.2. GENERAL SAFETY

- ✓ Safety precautions must be observed to avoid injuries and damage. Read the complete operating manual carefully. Keep this manual in a safe place so that the information is always available to ANY users of the equipment.
- ✓ Never leave the appliance switched on unattended. If the operator leaves the work area, switch the appliance off or unplug it from the power supply.
- ✗ **DO NOT** vacuum or use this vacuum cleaner near flammable liquids, gases or explosive vapours like gasoline or other fuels, lighter fluids, cleaners, oil-based paints, natural gas, hydrogen, or explosive dusts like coal dust, magnesium dust, grain dust or gun power. Sparks inside the motor can ignite flammable vapours or dust.
- ✓ This vacuum cleaner is not suitable for the vacuuming of asbestos or asbestos dust.
- ✗ **DO NOT** vacuum anything that is burning or smoking, such as cigarettes, matches, or hot ashes.
- ✓ Ensure the hose and connections are always pointed away from the users face, hair, ears and eyes during operation and never direct the nozzle towards persons or animals.
- ✓ Clear the working area of any items or possessions that do not need to be vacuumed before using equipment
- ✓ Keep mains cable away from heated surfaces.
- ✗ **DO NOT** expose to rain. Store indoors.
- ✗ **DO NOT** unplug by pulling on the mains cable. To unplug, grasp the plug, not the cable.
- ✗ **DO NOT** use with damaged cord, plug or other parts.
- ✗ **DO NOT** pull or carry by cable, use cable as handle, close a door on the cable, or pull cable around sharp edges or corners.

- ✓ If the supply cord is damaged, it must be replaced by the manufacturer, a qualified service agent or similarly qualified persons in order to avoid a hazard.
 - ✗ **DO NOT** handle the plug or vacuum cleaner with wet hands.
 - ✓ Frequently check that the float valve positioned underneath the motor is able to move freely.
 - ✗ **DO NOT** use this vacuum cleaner with a torn filter or without the filter installed.
 - ✗ **DO NOT** allow to be used as a toy. Close attention is necessary when used by or near children.
 - ☐ **WARNING!** To reduce the risk of injury from accidental starting, unplug power cord before changing or cleaning filter.
 - ☐ **WARNING!** Unplug from power supply when not in use and before carrying out maintenance.
 - ✗ **DO NOT** cover the ventilation openings. **DO NOT** vacuum with any ventilation openings blocked; keep free of dust, lint, hair or anything that may reduce air flow.
 - ✓ Keep hair, loose clothing, fingers, all parts of body away from openings and moving parts.
 - ✓ This machine is not intended for use by persons (including children) with reduced physical, sensory or mental capabilities, or lack of experience and knowledge. Children shall not play with the appliance. Cleaning and user maintenance shall not be made by children without supervision. For additional protection: It is recommended that this vacuum cleaner can be used in conjunction with residual current device (RCD) with a rated residual current of 30mA or less.
 - ✓ Only use the socket outlet on the machine for purposes specified in the instructions.
 - ✓ If foam or liquid escapes from the machine, switch off immediately.
 - ✓ Check the float valve regularly to ensure it is moving freely and examine it for signs of damage.
 - ✓ Precautions should be taken when changing attachments.
 - ✓ For user servicing, the machine must be dismantled, cleaned and serviced, as far as is reasonably practicable, without causing risk to the maintenance staff and others. Suitable precautions include decontamination before dismantling.
 - ✓ Provision must be made for local filtered exhaust ventilation where the machine is dismantled, cleaning of the maintenance area and suitable personal protection must be worn whilst carrying out these tasks.
 - ✓ Perform a technical inspection at least annually, consisting of, for example, inspection of filters for damage, air tightness of the machine and proper function of the control mechanism.
 - ✓ Besides the operating instructions and the binding accident prevention regulations valid in the country of use, observe recognized regulations for safety and proper use.
 - ✓ When dust removers are used, the rate at which air is exchanged in the room must be adequate if the exhaust air from the vacuum cleaner is blown into the room (please observe regulations valid in the country of use).
 - ✓ **Before starting work, the operating staff must be informed on:**
 - use of the vacuum cleaner
 - risks associated with the material to be picked up
 - safe disposal of the picked up material.
 - ✓ Before transporting the collection tank, close all the locks.
 - ✗ **DO NOT** tilt the cleaner if there is liquid in the collection tank.
 - ✗ **DO NOT** use a crane hook to lift the cleaner.
 - ✓ For class M machines, the outside of the machine should be decontaminated and wiped clean or treated with sealant before being taken out of a hazardous area. All the machine parts shall be regarded as contaminated when removed from the hazardous area and appropriate action taken to prevent dust dispersal.
 - ✓ If an extension reel is used it should be fully unwound before connection. A reel with an RCD fitted is preferred since any appliance plugged into it will be protected. The cable core section is important and should be at least 1.5mm², but to be absolutely sure that the capacity of the reel is suitable for this product and for others which may be used in the other output sockets, we recommend the use of 2.5mm² section cable. If an extension reel is to be used outdoors, ensure it is marked for outdoor use.
 - ☐ **WARNING! The warnings, cautions and instructions in this manual cannot cover all possible conditions and situations that may occur. It must be understood by the operator that common sense and caution are factors which cannot be built into this product, but must be applied by the operator.**
- NOTE: This appliance can be used by children aged from 8 years and above and persons with reduced physical, sensory or mental capabilities or lack of experience and knowledge if they have been given supervision or instruction concerning use of the appliance in a safe way and understand the hazards involved. Children shall not play with the appliance. Cleaning and user maintenance shall not be made by children without supervision.**

2. INTRODUCTION

High powered unit designed for use with power tools. Certified for M Class dust extraction in accordance with EU directives, which protects the operator from dust particles hazardous to health. Supplied with Ø36mm flexible hose, crevice nozzle, Multi-diameter tool adaptor, inserts for liquid collection and hard floors, power tool cord clamps, M Class bag filter, M Class cartridge filter and foam filter. Can be set to continuous suction or in synchronisation with a power tool via a 700W rated, electronically controlled outlet. Fitted with a self-cleaning filter designed to prevent filter blockages whilst in use. Fitted with four castors for manoeuvrability.

3. SPECIFICATION

Model No: **PC35110V**
 Airflow: 216m³/hr
 Drum size: 35L
 Drum Type: Plastic
 Maximum Vacuum Pressure: 240mbar
 Motor Power: 1200W
 Power Tool Capacity: 700W
 Supply: 110V
 Vacuum Accessories Diameter: Ø36mm

4. CONTENTS

4.1. CARTON CONTENT

- 4.1.1. Unpack the carton carefully.
- 4.1.2. Locate the two side clasps which hold the motor housing in place.
- 4.1.3. Undo the clasps, remove the motor housing and take out the loose items from the drum.
- 4.1.4. Check and identify each component as listed below. If anything is missing or damaged please contact your Sealey stockist immediately.

4.2. DRUM CONTENTS (FIG.1)

- | | |
|----|------------------------|
| 1 | Motor Housing. |
| 2 | Drum. |
| 3 | Ø36mm x 3m Hose. |
| 4 | Crevice Nozzle. |
| 5 | Cartridge Filter. |
| 6 | Foam Filter. |
| 7 | Category M Vacuum Bag. |
| 8 | Pick-up Tube (x2). |
| 9 | Swivel Nozzle. |
| 10 | Insert (hard floor). |
| 11 | Insert (wet floor). |
| 12 | Adaptor. |









5. ASSEMBLY

- 5.1. Ensure the electrical supply is disconnected.
 - 5.2. Undo the clasps.
 - 5.3. Lift off the motor housing assembly (fig.1).
 - 5.4. For dry vacuum cleaning use the locking cartridge filter supplied.
 - 5.5. For dry vacuum cleaning and containment use the vacuum bag supplied.
 - 5.6. For wet vacuum cleaning fit the supplied foam filter.
- NOTE: DO NOT** operate the cleaner without a filter fitted as this will damage the vacuum cleaner and invalidate your warranty.
- 5.7. Replace the motor housing onto the container.
 - 5.8. Align the motor housing with the clasps and snap closed by hooking the top of the clasp into the location in the motor housing and pressing the handles down over centre.

6. CONTROLS

6.1. FUNCTION SYMBOLS

- 6.1.1. With a power tool connected, switch "B" in position "I" and selector switch "A" is in position , the self cleaning function  is initiated. When the power tool is switched off the vacuum cleaner will continue to run for 8/10 seconds, stop, then the self cleaning filter function will run for 8/10 seconds and stop.
- 6.1.2. When the selector switch "A" is set to  the self cleaning filter function is not active, that is: vacuum and power tool only.
- 6.1.3. When the warning light "C"  illuminates, start the self cleaning filter manually  by pressing the orange switch "D".
NOTE: Continuous operation of the self cleaning system for more than 60 seconds may cause the thermal protection to trip, resetting after 20 minutes. (For fuller filter cleaning see section 9.)
- 6.1.4. If the exhaust air speed drops below 20m/sec warning light "C"  illuminates in accordance with IEC/EN60335-2-69.

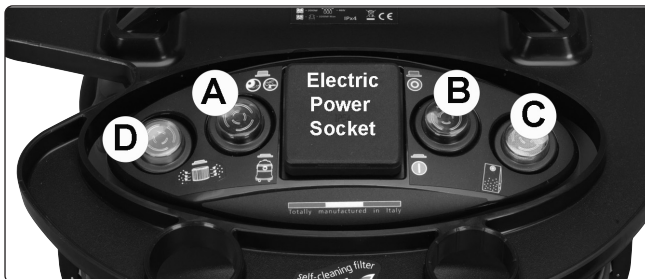



fig.2

7. DRY VACUUMING

- ❑ **WARNING! Ensure you read, understand and apply Section 1 'Safety Instructions'. Reminder: DO NOT vacuum hazardous substances, hot ashes or embers. Use of an incorrect cartridge filter will invalidate your warranty.**
Category M Cartridge Filter To vacuum dust of Class "M" the dust bag must be installed in the appliance. To vacuum Class "M" dust **ALWAYS** use the filter element.
Ensure the machine is unplugged from the power supply.
- 7.1. Remove the motor housing and with the raised rim uppermost fit the filter cartridge tube down over the filter basket and push fully home. Place the locking disc onto the top of the filter and turn the locking bar until the latch drops into the slot in the top of the filter cage. Continue turning clockwise until the filter is fully locked down.
 - 7.2. Reposition the motor housing onto the drum body, and clip in place.
 - 7.3. Insert the larger end of the flexible hose into the front inlet on the container and lock in place. Push the required attachment, when applicable, onto the free end of the hose.
 - 7.4. Plug into the power supply.
 - 7.5. With the selector switch "A" in position , switch "B" to the 'On' (position 'I'). See 6.1.1 for introduction of a power tool.

7.6. When you have completed vacuuming, press the switch "B" to 'Off' (position 'O').

fig.3

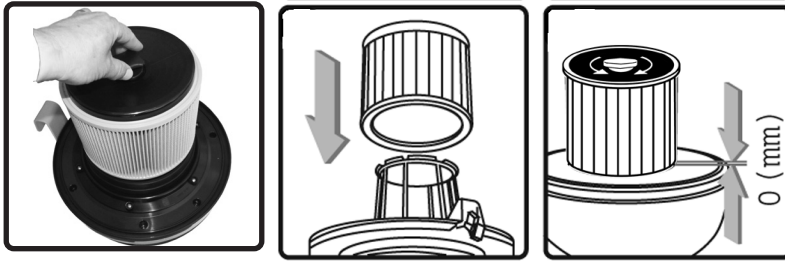
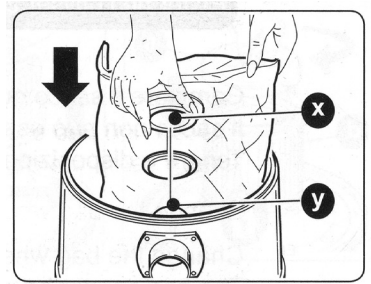



fig.4



- ❑ **WARNING!** Ensure you read, understand and apply Section 1 'Safety Instructions'. **Reminder: DO NOT** vacuum hazardous substances, hot ashes or embers.
- 7.7. **Category M Containment Bag Filter** The Category M filter is **NOT** for liquids. Vacuuming liquids is only allowed where there is no chance that dust will be sucked up.
- 7.8. Ensure the machine is unplugged from the power supply.
- 7.9. Remove the motor housing. Insert the Category M bag into the drum and fit the plastic socket "x" over the drum internal "y" spigot (fig.4). Reposition the motor housing onto the drum body, and clip in place.
- 7.10. Insert the larger end of the flexible hose into the front inlet on the container drum. Push the required attachment, when applicable, onto the free end of the hose.
- 7.11. Plug into the power supply.
- 7.12. With the selector switch "A" in position , switch "B" to the 'On' (position 'I'). See 6.1.1 for introduction of a power tool.
- 7.13. When you have completed vacuuming, press the switch "B" to 'Off' (position 'O')
- 7.14. When the bag is 3/4 full or vacuuming efficiency drops, remove the bag and seal the opening with the attached plug. Dispose of the bag in accordance with local regulations. **DO NOT** re-use.
- 7.15. Avoid using the bag for sharp or damp materials.

8. WET VACUUMING

- ❑ **WARNING!** Ensure you read, understand and apply Section 1 'Safety Instructions'. **Reminder: Remove the plug from power supply before opening unit. DO NOT** vacuum solvents, explosives, inflammable and/or hazardous liquids such as petrol, oil, spirits, paint, thinners, acids etc.
- 8.1. Ensure the machine is unplugged from the power supply. Make sure the drum is clean and free from dust and dirt.
- 8.2. Remove the cartridge filter and fit a foam filter, (NOT suitable for vacuuming class "M" dust) over the filter basket. Replace the motor housing onto the container.
- 8.3. Fit the crevice nozzle to the flexible hose.
- 8.4. Ensure the switch "B" is 'Off' (position 'O') before plugging into the power supply.
- 8.5. With the selector switch "A" in position , switch "B" to the 'On' (position 'I'). See 6.1.1. for introduction of a power tool.
Note: To vacuum large quantities of liquid, from a sink or tank etc, **DO NOT** immerse the nozzle completely in the liquid, leave a gap (fig.6) at the top of the nozzle opening to allow an air inflow. The machine is fitted with a float valve which stops the suction action when the tank has reached its maximum capacity. The user will notice an increase in motor speed. When this happens, turn off the machine, disconnect from power supply, remove the head from the container and empty the liquid into a suitable receptacle or drain. To continue vacuuming, refit the head and proceed. After wet vacuuming, turn the machine off and unplug from the power supply. Empty the container, clean and dry the inside and outside before storage.
Remember! After wet vacuuming the foam filter must be removed and a cartridge filter must be fitted before dry vacuuming again.
- ❑ **WARNING! Not designed for liquid storage. Always empty liquids after use and before storing.**

fig.5

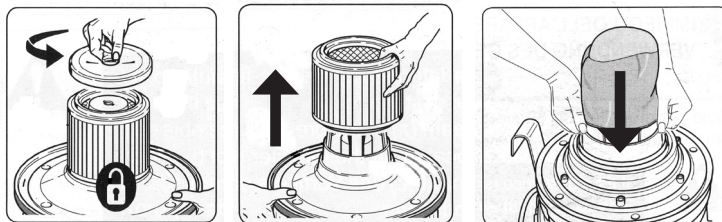
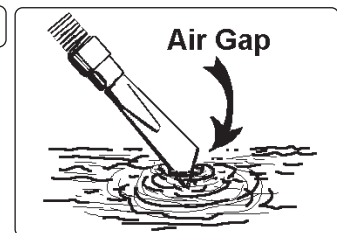

fig.6



9. FILTER CLEANING

- 9.1. Handle the filter carefully when cleaning or installing. Unlock and carefully remove the cartridge filter and inspect it for damage. A filter that has small holes or tears in it will not perform efficiently and should be replaced.
- 9.2. To clean a dry filter, tap it inside a waste bin. (The cartridge filter is designed for dry vacuuming only). Should the filter be inadvertently wetted it should be rinsed **from the inside** and allowed to air dry for 24 hours.
- 9.3. **DO NOT** use the filter wet as the filter will clog quickly and be very difficult to clean.
- 9.4. Fit a new/cleaned filter over the filter basket
- 9.5. Lock in place as described in fig.7. (0mm clearance) .

fig.7

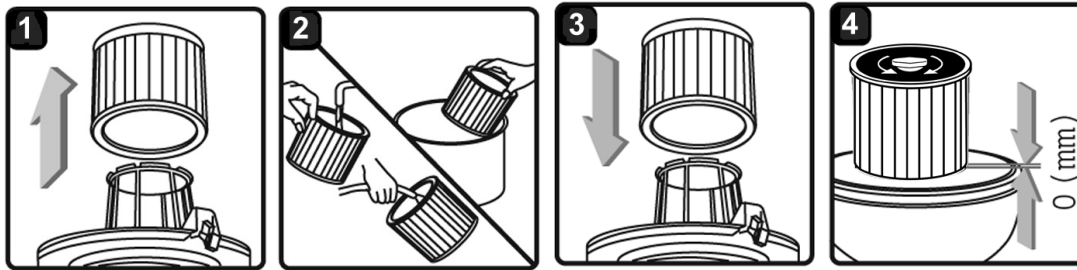

10. MAINTENANCE

- 10.1. Ensure the machine is unplugged from the power supply.
- 10.2. Disconnect the hose from the drum container.
- 10.3. Undo the clasps and remove motor housing from the drum container.
- 10.4. Clear out any dirt or debris from the drum container and hoses.
- 10.5. Frequently clean the seat where the safety float slides and inspect it periodically to check its integrity.
- 10.6. Clean the foam filter by washing it in a mild soapy solution.
- 10.7. Check the power cable to make sure that it is not damaged.

11. CONSUMABLES

Locking Cartridge Filter (Must be used for dry vacuuming): Model No: DFS35CF

Foam Filter: Model No: DFS35FF

IMPORTANT! IF THE MACHINE IS USED WITHOUT A FILTER FITTED THIS MAY CAUSE DAMAGE TO THE MOTOR AND YOUR GUARANTEE WILL BE INVALIDATED. ALWAYS KEEP A SPARE CARTRIDGE FILTER HANDY.

Category M Dust Bags: Model No. DFS35PB

12. TROUBLESHOOTING

Symptom	Possible causes	Solutions
Vacuum will not operate	No power supply	Check power supply - cable, breakers, fuses.
	Faulty power cable	Unplug and check the power cable. If damaged have it replaced by your local Sealey dealer.
	Container full	Empty container
Dust expelled from the motor cover	Cartridge filter missing or damaged	Fit cartridge filter or replace damaged filter
Reduced efficiency and increased motor/speed vibration/orange light (C)	There is a blockage in the nozzle/hose/drum inlet/ filter.	See 7.1.4.. Check nozzle, hose and container inlets and clear any blockages found. Remove filter and clean it or install new filter.



WEEE REGULATIONS

Dispose of this product at the end of its working life in compliance with the EU Directive on Waste Electrical and Electronic Equipment (WEEE). When the product is no longer required, it must be disposed of in an environmentally protective way. Contact your local solid waste authority for recycling information.



ENVIRONMENT PROTECTION

Recycle unwanted materials instead of disposing of them as waste. All tools, accessories and packaging should be sorted, taken to a recycling centre and disposed of in a manner which is compatible with the environment. When the product becomes completely unserviceable and requires disposal, drain any fluids (if applicable) into approved containers and dispose of the product and fluids according to local regulations.

Note: It is our policy to continually improve products and as such we reserve the right to alter data, specifications and component parts without prior notice.

Important: No Liability is accepted for incorrect use of this product.

Warranty: Guarantee is 12 months from purchase date, proof of which is required for any claim.

Sealey Group, Kempson Way, Suffolk Business Park, Bury St Edmunds, Suffolk. IP32 7AR



01284 757500



01284 703534



sales@sealey.co.uk



www.sealey.co.uk