



20L/30L WET & DRY VACUUM CLEANER

(LOW NOISE) 1000W/230V

MODEL NO: PC20LN, PC30LN

Thank you for purchasing a Sealey product. Manufactured to a high standard, this product will, if used according to these instructions, and properly maintained, give you years of trouble free performance.

IMPORTANT: PLEASE READ THESE INSTRUCTIONS CAREFULLY. NOTE THE SAFE OPERATIONAL REQUIREMENTS, WARNINGS & CAUTIONS. USE THE PRODUCT CORRECTLY AND WITH CARE FOR THE PURPOSE FOR WHICH IT IS INTENDED. FAILURE TO DO SO MAY CAUSE DAMAGE AND/OR PERSONAL INJURY AND WILL INVALIDATE THE WARRANTY. KEEP THESE INSTRUCTIONS SAFE FOR FUTURE USE.



Refer to
instruction
manual

1. SAFETY

1.1. ELECTRICAL SAFETY

- ❑ **WARNING!** It is the user's responsibility to check the following:
Check all electrical equipment and appliances to ensure that they are safe before using. Inspect power supply leads, plugs and all electrical connections for wear and damage. Sealey recommend that an RCD (Residual Current Device) is used with all electrical products. You may obtain an RCD by contacting your local Sealey stockist.
If the product is used in the course of business duties, it must be maintained in a safe condition and routinely PAT (Portable Appliance Test) tested.

Electrical safety information, it is important that the following information is read and understood.

Ensure that the insulation on all cables and on the appliance is safe before connecting it to the power supply.

Regularly inspect power supply cables and plugs for wear or damage and check all connections to ensure that they are secure.

Important: Ensure that the voltage rating on the appliance suits the power supply to be used and that the plug is fitted with the correct fuse - see fuse rating in these instructions.

- ✗ **DO NOT** pull or carry the appliance by the power cable.
- ✗ **DO NOT** pull the plug from the socket by the cable. Remove the plug from the socket by maintaining a firm grip on the plug.
- ✗ **DO NOT** use worn or damaged cables, plugs or connectors. Ensure that any faulty item is repaired or replaced immediately by a qualified electrician.

This product is fitted with a BS1363/A 13 Amp 3 pin plug.

If the cable or plug is damaged during use, switch the electricity supply and remove from use.

Replace a damaged plug with a BS1363/A 13 Amp 3 pin plug. If in doubt contact a qualified electrician.

Class II products are wired with live (brown) and neutral (blue) only are marked with the Class II symbol;

A) Connect the BROWN live wire to the live terminal 'L'.

B) Connect the BLUE neutral wire to the neutral terminal 'N'.

C) After wiring, check that there are no bare wires and ensure that all wires have been correctly connected.

Ensure that the cable outer sheath extends inside the cable restraint and that the restraint is tight.

- ✗ **DO NOT** connect either wire to the earth terminal.
Sealey recommend that repairs are carried out by a qualified electrician.

1.2. GENERAL SAFETY

- ❑ **WARNING!** Disconnect the cleaner from the power supply before servicing, changing accessories, or performing any maintenance.
- ✓ Use only genuine parts and accessories. Unauthorised parts and accessories may be dangerous and will invalidate your warranty.
- ✓ Maintain the cleaner in good condition. Use an authorised agent for servicing. Keep machine clean, but **DO NOT** use solvents.
- ✓ For dry vacuuming ensure the cartridge filter is firmly in place before operating the cleaner.
- ✗ **DO NOT** operate the unit without the cartridge filter in place (except when wet vacuuming).
Using the cleaner without a cartridge filter will cause machine faults and will invalidate your warranty.
- ✓ Wear protective clothing and gloves.
- ✗ **DO NOT** allow untrained persons to operate the cleaner.
- ✓ **NOTE:** This appliance can be used by children aged from 8 years and above and persons with reduced physical, sensory or mental capabilities or lack of experience and knowledge if they have been given supervision or instruction concerning use of the appliance in a safe way and understand the hazards involved. Children shall not play with the appliance. Cleaning and user maintenance shall not be made by children without supervision.
- ✗ **DO NOT** place attachments close to your face (especially eyes, ears, etc). **DO NOT** point the hose end at other persons or animals.
- ▲ **DANGER! DO NOT** vacuum hot or glowing ash, cigarette ends, inflammable, explosive, corrosive or other dangerous substances.
- ✗ **DO NOT** operate the unit without the dust bag and cartridge filter (except when wet vacuuming).
- ✗ **DO NOT** leave machine running unattended. Turn power supply OFF, and **DO NOT** leave the vicinity until motor has come to a complete stop.
- ✗ **DO NOT** operate the cleaner while under the influence of drugs, alcohol or impairing medication, or if you are tired.
- ✗ **DO NOT** use the cleaner in the rain or in very damp conditions.
- ✗ **DO NOT** use the cleaner for a task it is not designed to perform.
- ✓ When not in use, store the cleaner in a safe, dry, childproof location.

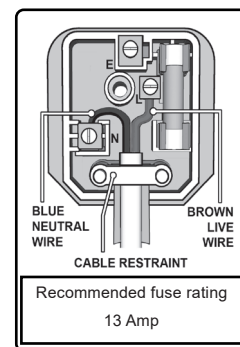

2. INTRODUCTION

High powered, lightweight, wet and dry units with blower facility. Low noise motor reducing sound down to 80db. Constructed with a high impact metal drum and four castors to aid manoeuvrability. Ideal for vehicle cleaning, home cleaning and general workshop use. Supplied with crevice and floor tools, washable cloth filter, 4m cable and 3-pin plug.

3. SPECIFICATION

Model no's.....	PC20LN/PC30LN
Airflow	90m ³ /hr
Drum size.....	20L/30L
Filter type	cartridge
Max. vacuum pressure.....	190mbar
Motor power.....	1000W
Supply.....	230V
Vacuum accessories diameter	Ø35mm

Optional accessories

Cloth filter cartridge.....	PCLNCF
Foam filter cartridge	PCLNFF
Dust bag	PC20LNDB

4. CONTENTS

- 1 On/Off
- 2 Handle
- 3 Top cover
- 4 Barrel clip
- 5 Extension tube
- 6 Crevice nozzle
- 7 Dust bag
- 8 Wet & dry brush
- 9 Hose
- 10 Cartridge filter
- 11 Sponge filter
- 12 Cable
- 13 Wheels
- 14 Wheel location hole
- 15 Base
- 16 Drain hole (PC30LN only)
- 17 Tank
- 18 Air inlet

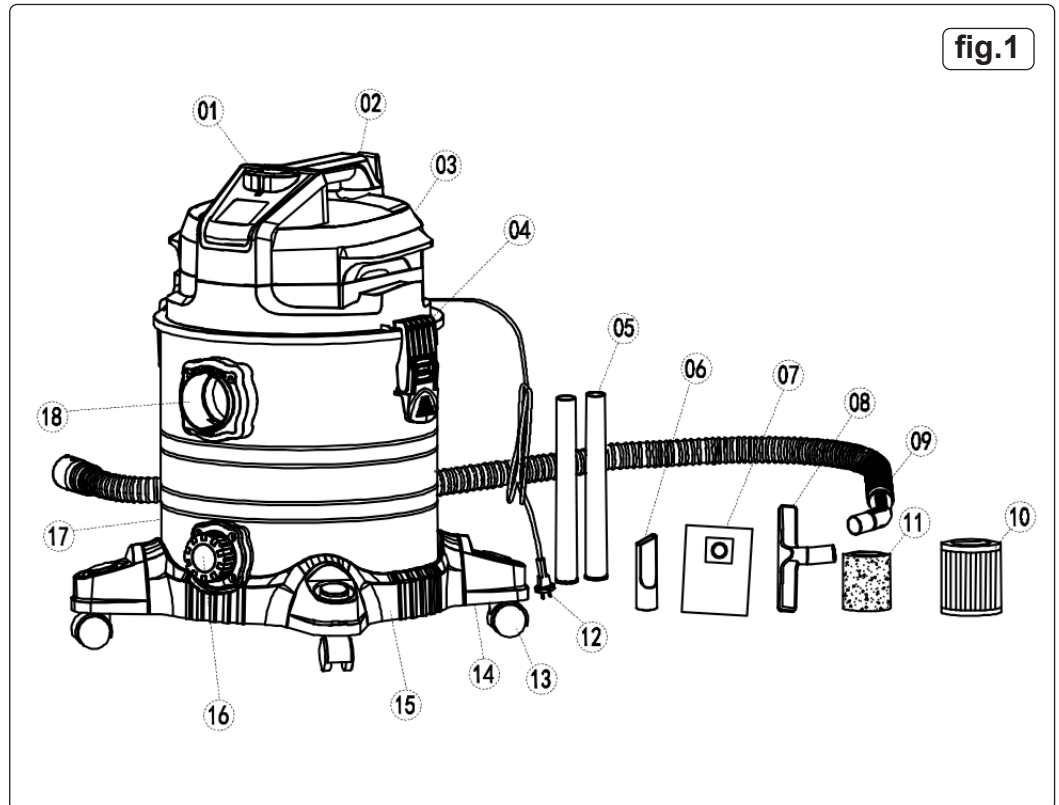
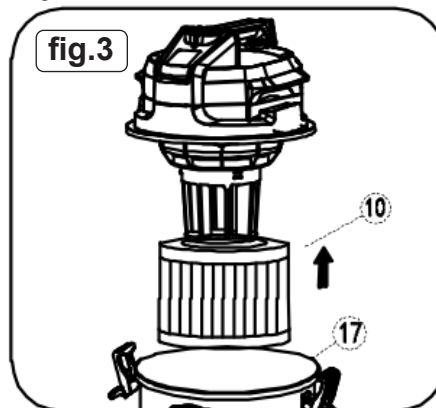
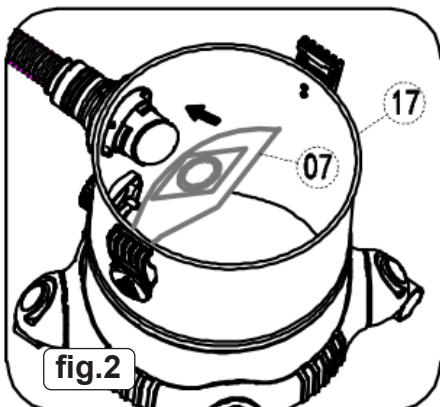

fig.1

5. ASSEMBLY

- 5.1. Push wheels into 4 holes in base.
- 5.2. Undo clips and fit dust bag, fig.2 and cartridge filter, fig.3.



- 5.3. Fit sponge filter assembly, (for wet vacuuming), fig.4.
- 5.4. Fit hose assembly, fig.5.

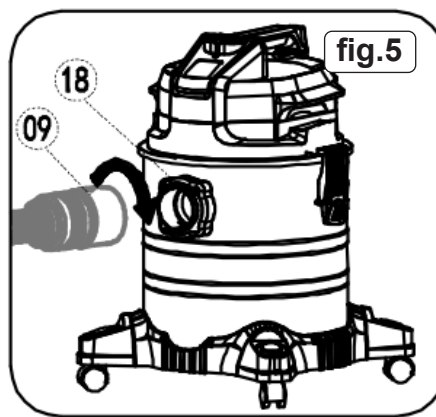
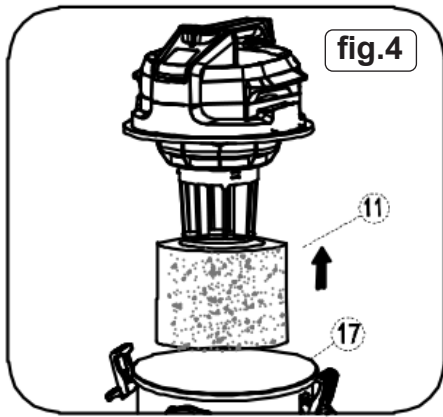

- 5.5. Tube/s and brush assembly, fig.6.
- 5.6. Blow function, fig.7.

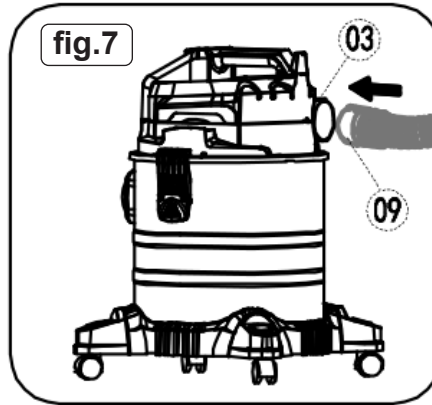
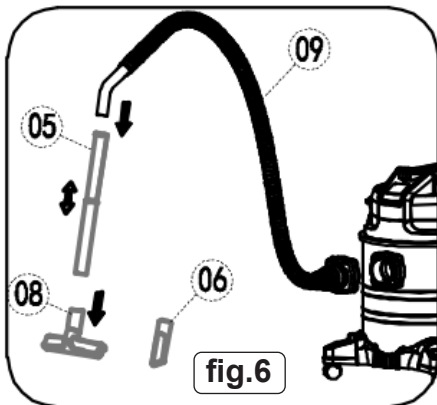

- 5.7. Cable storage, fig.8.
- 5.8. Accessory storage, fig.9.

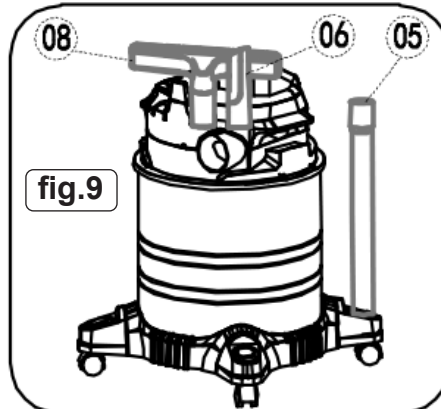
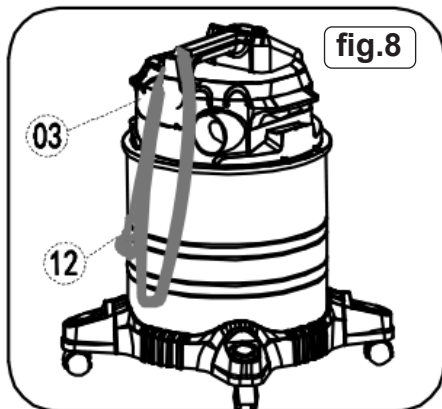

6. OPERATION

- 6.1. **DRY VACUUM**
 - 6.1.1. Unplug from mains supply. Fit paper bag, fig.2, cartridge filter, fig.3 and tube brush assembly, fig.6.
- 6.2. **WET VACUUM**
 - 6.2.1. Unplug from mains supply.
 - 6.2.2. Remove paper dust bag and cartridge filter, fig's 2 & 3. Fit sponge filter assembly, fig.4.
 - 6.2.3. Connect to mains supply. When maximum capacity is reached the machine will stop running.
 - 6.2.4. Unplug from mains supply undo clips and empty contents of tank into a suitable receptacle.
- 6.3. **BLOWER OPERATION**
 - 6.3.1. Remove from mains supply. Remove hose from suction port and attach to hose outlet on top of machine, fig.7.

7. MAINTENANCE

- 7.3.1. Ensure the machine is unplugged from the mains supply.
- 7.3.2. Disconnect the hose from the container.
- 7.3.3. Undo the clasps and remove motor head from the container.
- 7.3.4. Clear out any dirt or debris from the container and hose.
- 7.3.5. Check the power cable to make sure it has not received any damage.
- 7.3.6. Handle the filters carefully when cleaning or installing.

- 7.3.7. Wash the sponge filter with cold or luke warm water without use of detergent.
- 7.3.8. Allow to air dry
 - × **DO NOT** use heating equipment.



ENVIRONMENT PROTECTION

Recycle unwanted materials instead of disposing of them as waste. All tools, accessories and packaging should be sorted, taken to a recycling centre and disposed of in a manner which is compatible with the environment. When the product becomes completely unserviceable and requires disposal, drain any fluids (if applicable) into approved containers and dispose of the product and fluids according to local regulations.



WEEE REGULATIONS

Dispose of this product at the end of its working life in compliance with the EU Directive on Waste Electrical and Electronic Equipment (WEEE). When the product is no longer required, it must be disposed of in an environmentally protective way. Contact your local solid waste authority for recycling information.

Note: It is our policy to continually improve products and as such we reserve the right to alter data, specifications and component parts without prior notice.

Important: No Liability is accepted for incorrect use of this product.

Warranty: Guarantee is 12 months from purchase date, proof of which is required for any claim.

Sealey Group, Kempson Way, Suffolk Business Park, Bury St Edmunds, Suffolk. IP32 7AR



01284 757500



01284 703534



sales@sealey.co.uk



www.sealey.co.uk