

Thank you for purchasing a Sealey product. Manufactured to a high standard this product will, if used according to these instructions and properly maintained, give you years of trouble free performance.

**IMPORTANT: PLEASE READ THESE INSTRUCTIONS CAREFULLY. NOTE THE SAFE OPERATIONAL REQUIREMENTS, WARNINGS AND CAUTIONS. USE THE PRODUCT CORRECTLY AND WITH CARE FOR THE PURPOSE FOR WHICH IT IS INTENDED. FAILURE TO DO SO MAY CAUSE DAMAGE AND/OR PERSONAL INJURY AND WILL INVALIDATE THE WARRANTY. PLEASE KEEP INSTRUCTIONS SAFE FOR FUTURE USE.**

## 1. SAFETY INSTRUCTIONS

- ❑ **WARNING!** Ensure that Health & Safety, local authority, and general workshop practice regulations are adhered to when using this equipment.
- ✓ Use a qualified person to lubricate and maintain the lift. DO NOT use brake fluid to top up hydraulic unit. Use Sealey hydraulic oil only.
- ✓ Replace or repair damaged parts. Use genuine parts only. Unauthorised parts may be dangerous and will invalidate the warranty.
- ✓ Keep the lift clean for best and safest performance.
- ✓ Before use, ensure that the transportation plug, on the hydraulic unit, has been replaced by the air vent valve (Item P37 on Parts Diagram).
- ✓ Locate the lift in a suitable work area. Keep the area clean and tidy and free from unrelated materials. Ensure that there is adequate lighting.
- ❑ **WARNING!** Use the lift on level and solid ground, preferably concrete. Avoid tarmac since the lift may sink into the surface.
- ✓ Before loading, raise the lift off its wheels with the adjusting screws (fig 2. 5), and ensure that the unit is level.
- ✓ Maintain correct balance and footing. Ensure the floor is not slippery and wear non-slip shoes.
- ✓ Keep children and non-essential persons away from the work area.
- ✓ Never operate the lift with a tractor heavier than 400kgs. Ensure that the load is evenly distributed on the platform and secure if necessary.
- ✓ Before lifting check that there are no overhead obstructions.
- ✓ When load is raised, insert the safety bar (figs. 1 & 2 item 4) into the front arm to keep the platform from lowering.
- ✓ When work is complete, check under the platform to ensure that there are no obstructions and that it is safe to lower the unit.
- x DO NOT exceed the rated capacity of the lift.
- x DO NOT operate the lift if any parts are damaged or missing as this may cause failure and/or personal injury.
- x DO NOT place any part of your body within or under the lift during use.
- x DO NOT operate the lift when you are tired or under the influence of alcohol, drugs or intoxicating medication.
- x DO NOT use the lift for any purpose other than that for which it is designed.
- x DO NOT allow untrained persons to operate the lift.
- ✓ Store lift in a dry, childproof area when not in use.

## 2. INTRODUCTION

The MT400 is all-steel construction with heavy duty, foot operated, integral hydraulic pump and ram. Full width ramp and platform with chequer plate surface provide easy loading and positioning of the mini tractor. The unit is fitted with a safety lock to prevent accidental lowering of the platform and the base is fitted with wheels and wind-down locking pads.

## 3. ASSEMBLY INSTRUCTIONS

- 3.1. Attach lead plate (fig. 1.1) to holes in the back of the platform and use the washer and cotter pin to prevent it from slipping off.
  - 3.2. Push lifting foot pedal (figs. 1 & 2. item 2) onto the spindle of the pump piston.
  - 3.3. Push the releasing foot pedal (figs. 1 & 2. item 3) onto the spindle of the release valve. Ensure pedals are placed on valve ends at correct angles (fig. 2).
  - 3.4. Attach the guard plate (figs. 1 & 2. item 6) to the frame of the releasing foot pedal and fix with bolts provided.
- WARNING! DO NOT** use the lift without the guard plate fitted.

fig. 1

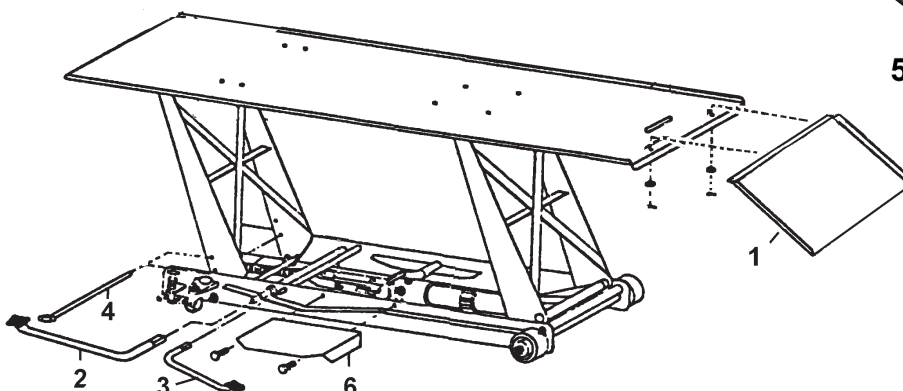
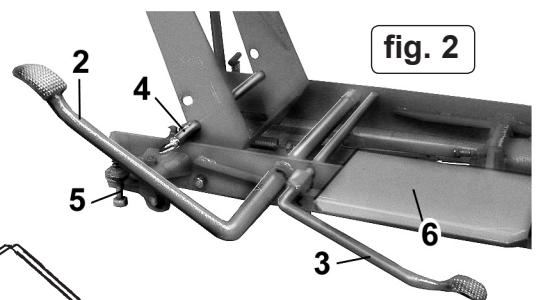

fig. 2



**SPECIFICATION:**

Maximum Capacity . . . . . 400kg  
 Height Min/Max . . . . . 150 x 785mm  
 Width/Length . . . . . 1000 x 2200mm

## 4. OPERATING INSTRUCTIONS

**IMPORTANT:** Before use, remove travel plug from the hydraulic unit and fit air vent valve (Item No. P37). Unscrew valve slightly and retain in the slacken position to allow air out.

- 4.1. Before use, ensure that the locking pads (fig. 2.5) have been wound down to prevent the lift from moving. Check that the unit is level.
- 4.2. Wheel tractor up the leading plate onto the platform.
- WARNING!** Ensure that there is adequate clearance between the bottom of the tractor and the point where the leading plate and platform meet (fig. 3). Failure to do so may cause damage to the tractor.
- 4.3. If necessary secure the tractor on the platform with straps.
- 4.4. To lift, pump foot pedal (figs. 1 & 2 item 2).
- 4.5. When raised, insert the safety bar (4) into the front arm to prevent the platform from lowering.
- 4.6. When work is complete, check under the platform to ensure that there are no obstructions and that it is safe to lower the unit.
- 4.7. Remove the safety bar (4).
- 4.8. Depress the release foot pedal (figs. 1 & 2 item 3) to lower the platform.

fig. 3

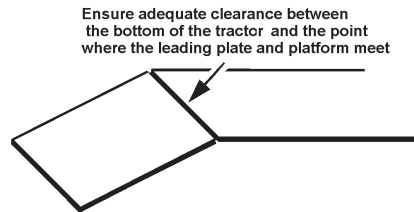

## 5. MAINTENANCE

**IMPORTANT:** Only fully qualified personnel should attempt maintenance or repair.

- 5.1. When the lift is not in use, the platform must be in the lowest position to minimise hydraulic ram and piston corrosion.
  - 5.2. Keep the lift clean and wipe off any oil or grease. Lubricate all moving parts.
  - 5.3. Before each use, ensure that components are not damaged or malfunctioning and that there are no missing parts. If any suspect item is found remove lift from service and take the necessary action to remedy the problem.  
DO NOT use the lift if it is believed to have been subjected to abnormal shock or load. Inspect and take appropriate action.
  - 5.4. Periodically check the pump piston and piston rod for signs of corrosion. Wipe exposed areas with a clean, oiled cloth.
  - 5.5. The oil cylinder is a sealed unit and must not be accessed. For service contact your authorised dealer.
- WARNING!** Only a good quality hydraulic oil, such as SEALEY HYDRAULIC JACK OIL may be used, DO NOT use brake fluid.

**IMPORTANT: NO RESPONSIBILITY IS ACCEPTED FOR THE INCORRECT USE OF THE LIFT.**

Hydraulic products are only repaired by local service agents. We have service/repair agents in all parts of the UK. **DO NOT RETURN LIFTS TO US.** Please telephone 01284 757500 to obtain the address and telephone number of your local agent. If the lift is under guarantee, please contact your dealer.

**De-commissioning:** If and when the lift becomes completely unserviceable, draw off the oil into an approved container and dispose of the lift and the oil according to local regulations.

**NOTE:** It is our policy to continually improve products and as such we reserve the right to alter data, specifications and component parts without prior notice.

**IMPORTANT:** No liability is accepted for incorrect use of this product.

**WARRANTY:** Guarantee is 12 months from purchase date, proof of which will be required for any claim.

**INFORMATION:** For a copy of our latest catalogue and promotions call us on 01284 757525 and leave your full name and address, including postcode.



Sole UK Distributor, Sealey Group,  
Kempson Way, Suffolk Business Park,  
Bury St. Edmunds, Suffolk,  
IP32 7AR

01284 757500

[www.sealey.co.uk](http://www.sealey.co.uk)

01284 703534

[sales@sealey.co.uk](mailto:sales@sealey.co.uk)