

Thank you for purchasing a Sealey product. Manufactured to a high standard this product will, if used according to these instructions and properly maintained, give you years of trouble free performance.



IMPORTANT: PLEASE READ THESE INSTRUCTIONS CAREFULLY. NOTE THE SAFE OPERATIONAL REQUIREMENTS, WARNINGS, AND CAUTIONS. USE THIS PRODUCT CORRECTLY, AND WITH CARE FOR THE PURPOSE FOR WHICH IT IS INTENDED. FAILURE TO DO SO MAY CAUSE DAMAGE AND/OR PERSONAL INJURY AND WILL INVALIDATE THE WARRANTY.

1. SAFETY INSTRUCTIONS

1.1 ELECTRICAL SAFETY

- WARNING!** It is the responsibility of the owner and the operator to read, understand and comply with the following:
You must check all electrical products, before use, to ensure that they are safe. You must inspect power cables, plugs, sockets and any other connectors for wear or damage. You must ensure that the risk of electric shock is minimised by the installation of appropriate safety devices. A Residual Current Circuit Breaker (RCCB) should be incorporated in the main distribution board. We also recommend that a Residual Current Device (RCD) is used. It is particularly important to use an RCD with portable products that are plugged into a supply which is not protected by an RCCB. If in any doubt consult a qualified electrician. You may obtain a Residual Current Device by contacting your Sealey dealer.
You must also read and understand the following instructions concerning electrical safety.
- 1.1.1 The Electricity at Work Act 1989 requires that all portable electrical appliances, if used on business premises, are tested by a qualified electrician, using a Portable Appliance Tester (PAT), at least once a year.
- 1.1.2 The Health & Safety at Work Act 1974 makes owners of electrical appliances responsible for the safe condition of those appliances and the safety of the appliance operators. If in any doubt about electrical safety, contact a qualified electrician.
- 1.1.3 Ensure that the insulation on all cables and on the appliance is safe before connecting it to the power supply. See 1.1.1 and 1.1.2 and use a Portable Appliance Tester.
- 1.1.4 Ensure that cables are always protected against short circuit and overload.
- 1.1.5 Regularly inspect power supply cables and plugs for wear or damage and check all connections to ensure that none is loose.
- 1.1.6 Important: Ensure that the voltage marked on the appliance matches the power supply to be used and that the plug is fitted with the correct fuse - see fuse rating at right.
- 1.1.7 DO NOT pull or carry the appliance by the power cable.
- 1.1.8 DO NOT pull the plug from the socket by the cable.
- 1.1.9 DO NOT use worn or damaged cables, plugs or connectors. Immediately have any faulty item repaired or replaced by a qualified electrician. When a BS 1363/A UK 3 pin plug is damaged, cut the cable just above the plug and dispose of the plug safely.
Fit a new plug according to the following instructions (UK only).
a) Connect the GREEN/YELLOW earth wire to the earth terminal 'E'.
b) Connect the BROWN live wire to the live terminal 'L'.
c) Connect the BLUE neutral wire to the neutral terminal 'N'.
d) After wiring, check that there are no bare wires, that all wires have been correctly connected, that the cable outer insulation extends beyond the cable restraint and that the restraint is tight. Double insulated products, which are always marked with this symbol  are fitted with live (brown) and neutral (blue) wires only. To rewire, connect the wires as indicated above - DO NOT connect either wire to the earth terminal.
- 1.1.10 Products which require more than 13 amps are supplied without a plug. In this case you must contact a qualified electrician to ensure that a suitably rated supply is available. We recommend that you discuss the installation of an industrial round pin plug and socket with your electrician.
- 1.1.11 If an extension reel is used it should be fully unwound before connection. A reel with an RCD fitted is preferred since any appliance plugged into it will be protected. The cable core section is important and should be at least 1.5mm², but to be absolutely sure that the capacity of the reel is suitable for this product and for others which may be used in the other output sockets, we recommend the use of 2.5mm² section cable.

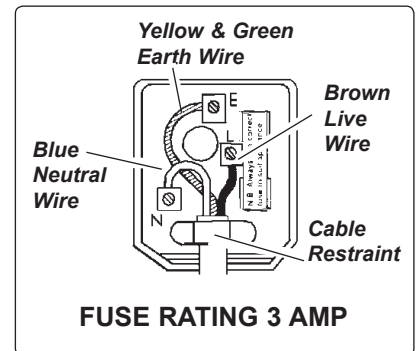

1.2 GENERAL SAFETY

- ✓ Keep the light and cables in good working order and condition and take immediate action to repair or replace damaged parts.
- ✓ Use recommended parts and accessories only. *Unapproved parts may be dangerous and will invalidate the warranty.*
- WARNING! Disconnect lamp from mains power before changing tubes or performing any maintenance.**
- ✓ Replace or repair damaged parts. *Use genuine Sealey parts only. Unauthorised parts may be dangerous and will invalidate the warranty.*
- ✓ Maintain the lamp in good condition.
- ✗ DO NOT use the lamp if damaged.
- ✗ DO NOT use lamp close to paint fumes, solvents or other flammable liquids or flammable waste, such as wipes or cleaning rags.
- ✗ DO NOT fit a fluorescent tube other than the recommended replacement. (SEALEY PART NO. ML3623T.FB / ML58230T.FB)
- ✓ When not in use switch off the lamp and remove plug from power supply.
- WARNING!** Ensure the lantern is correctly charged before initial use.
- ✗ DO NOT allow children to use the lantern.
- ✗ DO NOT use if the battery or the lantern casing is damaged.
- ✓ When not in use store the lantern in a safe, dry, childproof location.

2. INTRODUCTION

Fluorescent tubes mounted in impact resistant heads. The light units are supported on a telescopic stand with locking screw. Tripod feet can be easily disassembled, allowing compact storage when not in use. Both are supplied with 5mtr lead and are fitted with BS approved plug.

2. SPECIFICATIONS

Model No: ML36230T	Model No: ML58230T
Power: 2 x 18W	Power: 1 x 58W
Supply: 230V – 0.3A	Supply: 230V – 0.6A
Min/Max. Height: . . . 1785/2330mm	Min/Max. Height: . . . 2225/2770mm

REPLACEMENT TUBES: SEALEY PART NO. **ML3623T.FB / ML58230T.FB**

3. OPERATION

3.1 OPERATING THE LIGHT

3.1.1 To operate the light simply plug into a 230v socket, the light will illuminate automatically.

4. MAINTENANCE

- ❑ **WARNING!** Before replacing the fluorescent tubes or performing any maintenance the unit must be unplugged from the mains. Allow the tubes to cool before touching them.
- ❑ **WARNING!** Do not turn the unit on with the transparent cover removed or with the tubes removed.

4.1 CHANGING THE FLUORESCENT TUBES

- 4.1.1 Replacement tubes must be the same type and rating as the original tubes supplied.
Use Sealey replacement tubes (PART NO. **ML36230T.FB / ML58230T.FB**)
- 4.1.2 To remove the transparent cover release the securing clips by first pulling the rear of the clip forward, then unlatching the clip from the front ridge (as shown in fig 1), now carefully lift the cover off.
- 4.1.3 Each tube can be removed by rotating it in either direction until one of the connector pins appears at the top of the tube holder slot. Lift out the old tube and replace it with a new one. Push the new tube all the way into the tube holder slots at both ends and then rotate the tube a quarter of a turn in either direction.
- 4.1.4 Ensure that the tubes are correctly installed and seated before turning on.
- 4.2 **CLEANING**
- 4.2.1 Clean the unit with a damp cloth and a mild soapy solution. Do not use solvents or abrasive cleaners.

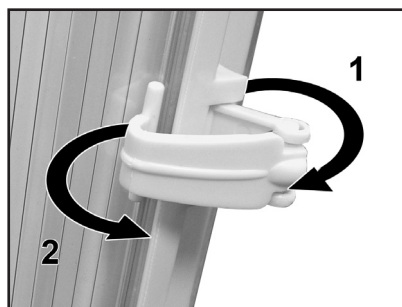
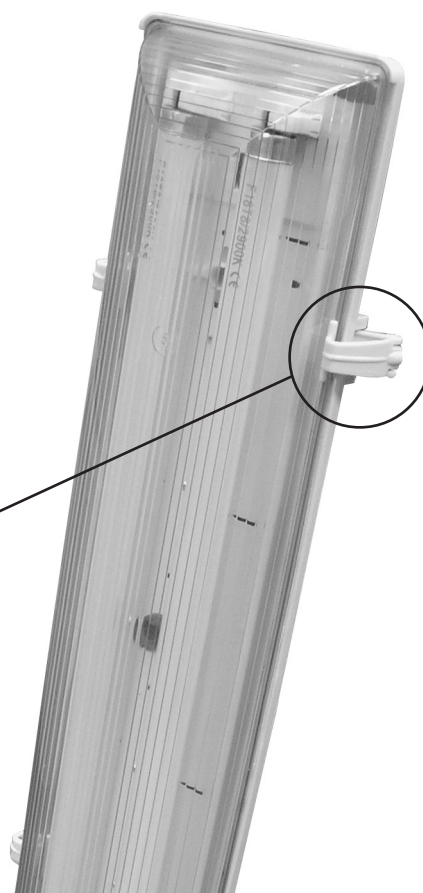

fig 1

Parts support is available for these products. To obtain a parts listing and/or diagram, please log on to www.sealey.co.uk, email sales@sealey.co.uk or phone 01284 757500.

NOTE: It is our policy to continually improve products and as such we reserve the right to alter data, specifications and component parts without prior notice.
IMPORTANT: No liability is accepted for incorrect use of this product.
WARRANTY: Guarantee is 12 months from purchase date, proof of which will be required for any claim.
INFORMATION: For a copy of our latest catalogue and promotions call us on 01284 757525 and leave your full name and address, including postcode. **CE**

SEALEY POWER PRODUCTS	Sole UK Distributor, Sealey Group, Kempson Way, Suffolk Business Park, Bury St. Edmunds, Suffolk, IP32 7AR	☎ 01284 757500 🖨 01284 703534	🌐 www.sealey.co.uk ✉ sales@sealey.co.uk
------------------------------	---	----------------------------------	--