

Thank you for purchasing a Sealey product. Manufactured to a high standard this product will, if used according to these instructions and properly maintained, give you years of trouble free performance.



**IMPORTANT: PLEASE READ THESE INSTRUCTIONS CAREFULLY. NOTE THE SAFE OPERATIONAL REQUIREMENTS, WARNINGS & CAUTIONS. USE THE PRODUCT CORRECTLY AND WITH CARE FOR THE PURPOSE FOR WHICH IT IS INTENDED. FAILURE TO DO SO MAY CAUSE DAMAGE AND/OR PERSONAL INJURY AND WILL INVALIDATE THE WARRANTY. PLEASE KEEP INSTRUCTIONS SAFE FOR FUTURE USE.**

## 1. SAFETY INSTRUCTIONS

### 1.1. ELECTRICAL SAFETY

**WARNING!** It is the responsibility of the owner and the operator to read, understand and comply with the following:  
 You must check all electrical products, before use, to ensure that they are safe. You must inspect power cables, plugs, sockets and any other connectors for wear or damage. You must ensure that the risk of electric shock is minimised by the installation of appropriate safety devices. A Residual Current Circuit Breaker (RCCB) should be incorporated in the main distribution board. We also recommend that a Residual Current Device (RCD) is used. It is particularly important to use an RCD with portable products that are plugged into a supply which is not protected by an RCCB. If in any doubt consult a qualified electrician. You may obtain a Residual Current Device by contacting your Sealey dealer.

You must also read and understand the following instructions concerning electrical safety.

- 1.1.1. The Electricity at Work Act 1989 requires that all portable electrical appliances, if used on business premises, are tested by a qualified electrician, using a Portable Appliance Tester (PAT), at least once a year.
- 1.1.2. The Health & Safety at Work Act 1974 makes owners of electrical appliances responsible for the safe condition of those appliances and the safety of the appliance operators. If in any doubt about electrical safety, contact a qualified electrician.
- 1.1.3. Ensure that the insulation on all cables and on the appliance is safe before connecting it to the power supply. See 1.1.1. and 1.1.2. and use a Portable Appliance Tester.
- 1.1.4. Ensure that cables are always protected against short circuit and overload.
- 1.1.5. Regularly inspect power supply cables and plugs for wear or damage and check all connections to ensure that none are loose.
- 1.1.6. Important: Ensure that the voltage marked on the appliance matches the power supply to be used and that the plug is fitted with the correct fuse - see fuse rating at right.
- 1.1.7. DO NOT pull or carry the appliance by the power cable.
- 1.1.8. DO NOT pull the plug from the socket by the cable.
- 1.1.9. DO NOT use worn or damaged cables, plugs or connectors. Immediately have any faulty item repaired or replaced by a qualified electrician. When a BS 1363/A UK 3 pin plug is damaged, cut the cable just above the plug and dispose of the plug safely. Fit a new plug according to the following instructions (UK only).
  - a) Connect the GREEN/YELLOW earth wire to the earth terminal 'E'.
  - b) Connect the BROWN live wire to the live terminal 'L'.
  - c) Connect the BLUE neutral wire to the neutral terminal 'N'.
  - d) After wiring, check that there are no bare wires, that all wires have been correctly connected, that the cable outer insulation extends beyond the cable restraint and that the restraint is tight.
 Double insulated products, which are always marked with this symbol  are fitted with live (brown) and neutral (blue) wires only. To rewire, connect the wires as indicated above DO NOT connect either wire to the earth terminal.
- 1.1.10. Products which require more than 13 amps are supplied without a plug. In this case you must contact a qualified electrician to ensure that a suitably rated supply is available. We recommend that you discuss the installation of an industrial round pin plug and socket with your electrician.
- 1.1.11. If an extension reel is used it should be fully unwound before connection. A reel with an RCD fitted is preferred since any appliance plugged into it will be protected. The cable core section is important and should be at least 1.5mm<sup>2</sup>, but to be absolutely sure that the capacity of the reel is suitable for this product and for others which may be used in the other output sockets, we recommend the use of 2.5mm<sup>2</sup> section cable.

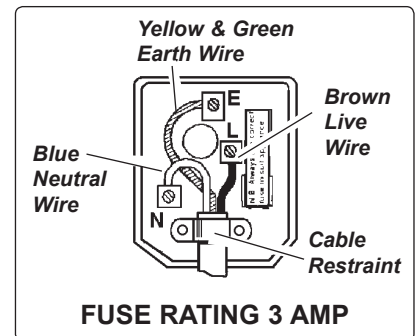

### 1.2. GENERAL SAFETY

- WARNING!** Ensure Health & Safety, local authority, and general workshop practice regulations are adhered to when using this equipment.
- ✓ Do not immerse in water.
- ✓ Ensure the lamp is disconnected from the mains before attempting to change the fluorescent tube.
- ✓ Maintain the lamp in good condition (use an authorised service agent).
- ✓ Ensure there are no flammable liquids or vapours present.
- x **DO NOT** use equipment for any purpose other than that for which it is designed.
- x **DO NOT** pull the cord to remove the plug from the power supply.
- ✓ When not in use unplug from the mains power supply and store in a safe, dry, childproof area.

## 2. INTRODUCTION

Spring loaded telescopic bracket mounts under open bonnet and 36W 1.2mtr fluorescent tube with reflector gives complete engine bay illumination. Lamp unit can be unclipped from mounting bracket and used separately. Supplied with 5mtr cable and ASTA/BS approved 3-pin plug.

## 3. OPERATION

- 3.1. To turn the lamp on, simply plug into the mains supply.
- 3.2. Attach to the underside of the car bonnet by releasing the locking clips (fig.1.), pulling the spring loaded bracket arms apart and allowing them to close around the bonnet sides, secure the clips.
- 3.3. The spring loaded bracket may also be unclipped to allow the lamp to be hung in the vertical position using the hook mount.
- 3.4. To turn off, switch off the mains switch and remove the plug from the socket.

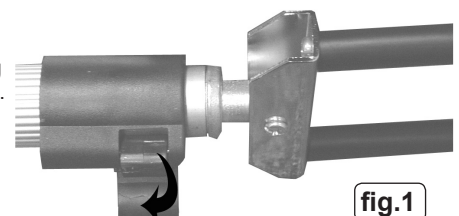

fig.1

## 4. MAINTENANCE

☐ **WARNING!** Be sure to disconnect the lamp from the mains power supply before carrying out any maintenance.

- 4.1. Keep the lamp clean.
- 4.2. Check cable for any signs of wear. If the plug and/or cable are worn/broken, remove the lamp from service immediately and have it repaired by a qualified electrician.

### 5. To replace tube or choke

- 5.1. Unplug from the mains supply.
- 5.2. Moisten a screwdriver blade with water or washing up liquid.
- 5.3. Push the blade between the guard tube (cable end) and the handle, and work the handle from the tube guard.
- 5.4. Remove the crosshead screw (fig.2) and withdraw the starter assembly and tube from the tube guard.
- 5.5. To replace the choke, twist anti clockwise and withdraw (fig.3).
- 5.6. To replace the fluorescent tube remove the end caps from both ends of the tube (fig.4).

**NOTE:** Use caution when handling a fluorescent tube and dispose of in accordance with local authority guidelines.

- 5.7. To re-assemble, reverse the dismantling procedure, taking care not to force or twist tube or starter assembly.

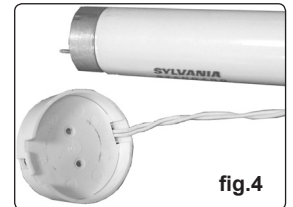
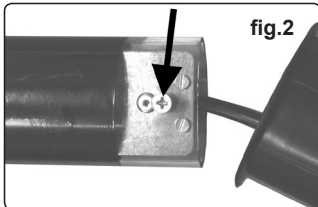

## 6. SPARE PARTS

ITEM	PART No.	DESCRIPTION
1	ML3610.01	RUBBER CAP
2	ML3610.02	RUBBER HANDLE
3	ML3610.03	OUTER PLASTIC TUBE (POLYCARBONATE)
4	ML3610.04	BULB ( FLUORESCENT TUBE 36W)
5	ML3610.05	ROTARY HOOK
6	ML3610.06	MOUNTING BRACKET

Parts Issue: 1  
Issue Date: 290404

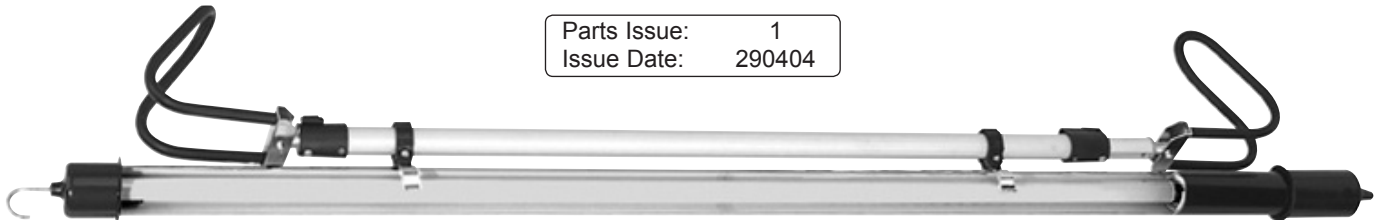

**NOTE:** It is our policy to continually improve products and as such we reserve the right to alter data, specifications and component parts without prior notice.

**IMPORTANT:** No liability is accepted for incorrect use of this product.

**WARRANTY:** Guarantee is 12 months from purchase date, proof of which will be required for any claim.

**INFORMATION:** For a copy of our latest catalogue and promotions call us on 01284 757525 and leave your full name and address, including postcode.



Sole UK Distributor, Sealey Group,  
Kempson Way, Suffolk Business Park,  
Bury St. Edmunds, Suffolk,  
IP32 7AR

☎ 01284 757500

🌐 [www.sealey.co.uk](http://www.sealey.co.uk)

☎ 01284 703534

✉ [sales@sealey.co.uk](mailto:sales@sealey.co.uk)