

Thank you for purchasing a Sealey product. Manufactured to a high standard this product will, if used according to these instructions and properly maintained, give you years of trouble free performance.



IMPORTANT: PLEASE READ THESE INSTRUCTIONS CAREFULLY. NOTE THE SAFE OPERATIONAL REQUIREMENTS, WARNINGS & CAUTIONS. USE THE PRODUCT CORRECTLY AND WITH CARE FOR THE PURPOSE FOR WHICH IT IS INTENDED. FAILURE TO DO SO MAY CAUSE DAMAGE AND/OR PERSONAL INJURY, AND WILL INVALIDATE THE WARRANTY. PLEASE KEEP INSTRUCTIONS SAFE FOR FUTURE USE.

1. SAFETY INSTRUCTIONS

1.1 GENERAL SAFETY

- WARNING!** Ensure Health & Safety, local authority, and general workshop practice regulations are adhered to when using this parts cage.
- ✓ When the cage is not in use store it in a suitable level area.
- ✓ When moving a fully loaded cage care should be taken on sloping surfaces such as ramps.
- ✓ Keep the cage clean and tidy in accordance with good workshop practice.
- ✓ Keep children and unauthorised persons away from the working area.
- x **DO NOT** use the parts cage for any purpose other than that for which it is designed.
- x **DO NOT** overload the cage with heavy items such as engines and transmissions.
- x **DO NOT** allow people to ride in the cage.

- WARNING!** The warnings, cautions and instructions discussed in this instruction manual cannot cover all possible conditions and situations that may occur. It must be understood that common sense and caution are factors which cannot be built into this product, but must be applied by the operator.

2. INTRODUCTION

Ideal for short-term storage during car repair or body shop preparation. Keeps parts, panels and components neatly and securely stored for clutter free workshop and easy location during vehicle re-assembly. Supplied with two hanging hooks for suspending various panels/components within cage.

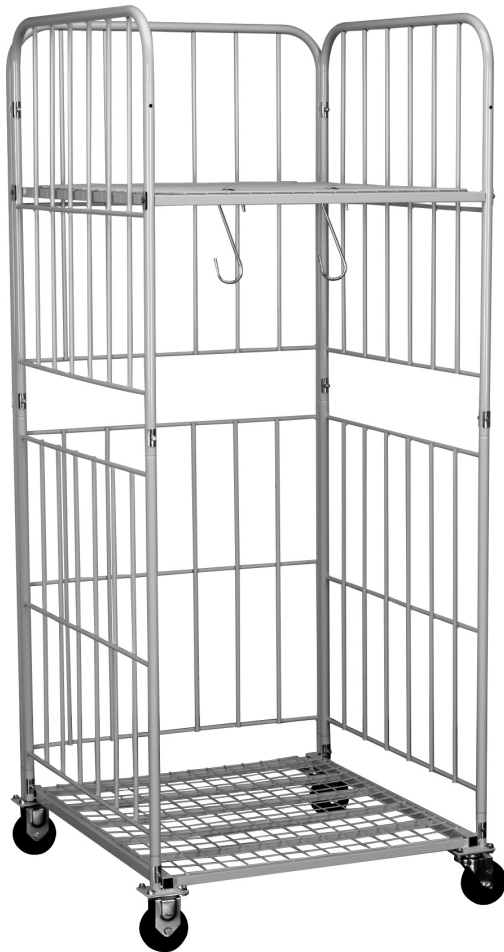

NOTE: It is our policy to continually improve products and as such we reserve the right to alter data, specifications and component parts without prior notice.

IMPORTANT: No liability is accepted for incorrect use of this product.

WARRANTY: Guarantee is 12 months from purchase date, proof of which will be required for any claim.

INFORMATION: For a copy of our catalogue and latest promotions call us on 01284 757525 and leave your full name, address and postcode.



3. PARTS & ASSEMBLY

The numbers used in the assembly instructions refer to the parts list and diagrams below.

- 3.1 Identify the under tray (1) and attach a fixed wheel (2) to each corner on one of the short sides of the mesh covered frame. Bolt each wheel to a corner plate using four 5/16" x 5/8" bolts (6) and four 5/16" lock nuts (7).
- 3.2 Attach the two castor wheels (5) to the corner plates on the other side of the frame using four 5/16" x 5/8" bolts (6) and four 5/16" lock nuts (7).
- 3.3 At the back of the under tray (1) there is a pair of short tubes welded side by side onto each corner plate. Identify the bottom back cage component (11) and insert the two reduced sections at the end of the side tubes into the short tubes on the outside edge of the under tray (1).
- 3.4 Plug the upper back cage component (14) onto the upstanding tube sections of the lower back cage (11).
- 3.5 Take the two bottom side cage components (9) and plug them into the upstanding tubes on either side of the under tray (1).

- 3.6 Take the two upper side cage components (10) and plug them onto the upstanding tube sections of the lower side cage components (9).
- 3.7 Bolt the side cage and back cage components together in the six places indicated at 'A' on the parts diagram below. Use two pad plates (3), one 1-1/2" x 1/4" bolt (13) and one 1/4" lock nut (8) at each position as shown below in diagram 'A'.
- 3.8 Continue to secure the side cage and back cage components together in the four places indicated at 'B' on the parts diagram below. Use two pad plates (3), one 1-1/2" x 1/4" bolt (4) and one 1/4" lock nut (8) at each position as shown below in diagram 'B'.
- 3.9 Fix the top shelf in position in the four places indicated at 'C' on the parts diagram below. Use one pad plate (3) and one 1-1/2" x 1/4" bolt (4) as shown below in diagram 'C'. Insert the bolt through the pad plate and through the tube and screw it into the threaded insert in the shelf.
- 3.10 Hang the hooks (15) from the shelf. The parts cage is now ready for use.

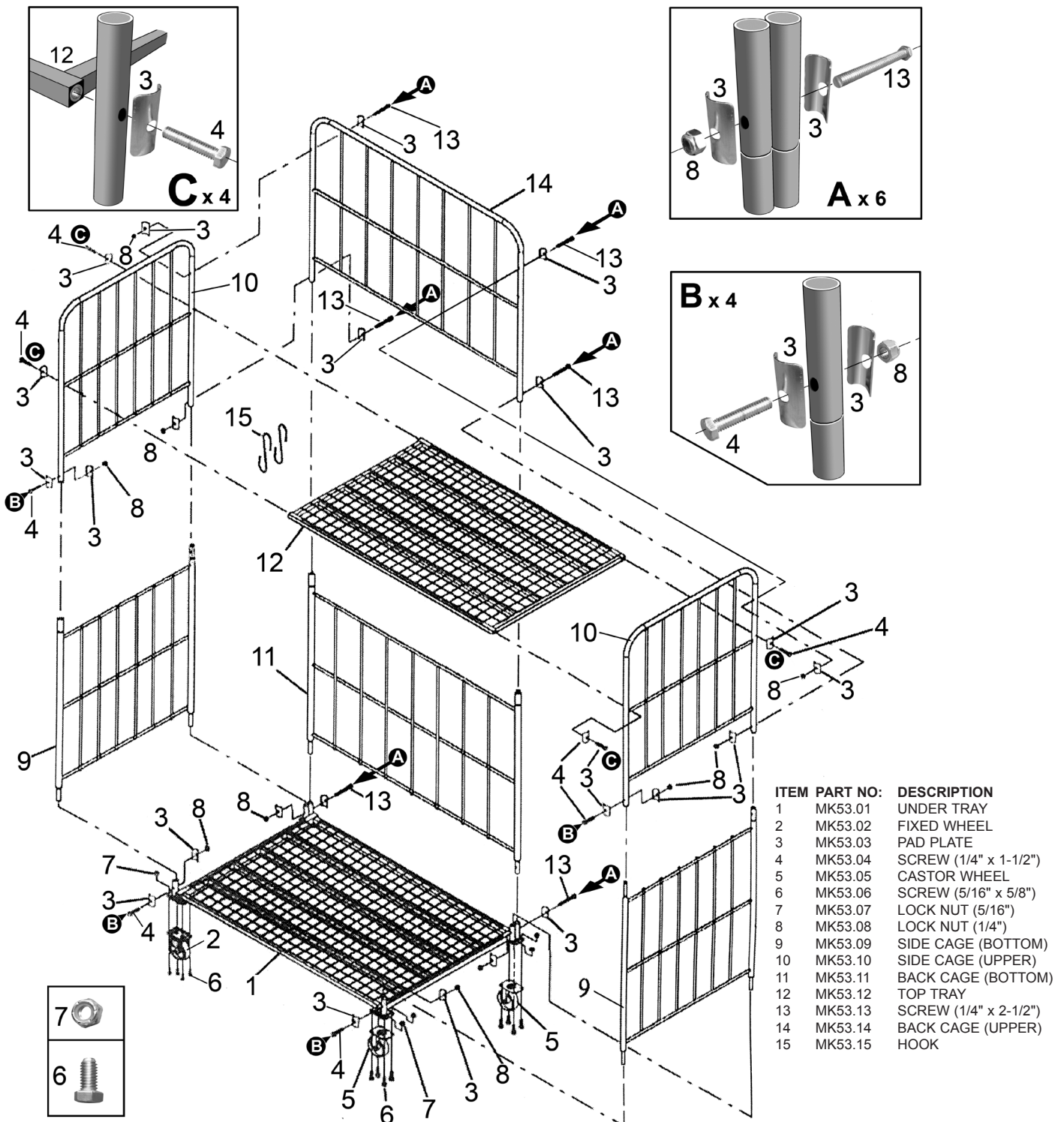

ITEM	PART NO:	DESCRIPTION
1	MK53.01	UNDER TRAY
2	MK53.02	FIXED WHEEL
3	MK53.03	PAD PLATE
4	MK53.04	SCREW (1/4" x 1-1/2")
5	MK53.05	CASTOR WHEEL
6	MK53.06	SCREW (5/16" x 5/8")
7	MK53.07	LOCK NUT (5/16")
8	MK53.08	LOCK NUT (1/4")
9	MK53.09	SIDE CAGE (BOTTOM)
10	MK53.10	SIDE CAGE (UPPER)
11	MK53.11	BACK CAGE (BOTTOM)
12	MK53.12	TOP TRAY
13	MK53.13	SCREW (1/4" x 2-1/2")
14	MK53.14	BACK CAGE (UPPER)
15	MK53.15	HOOK